

O.D.O.T. DISTRICT 2 SURVEY OFFICE (USE ONLY)

PERSONNEL

REFERENCE NO. 26

SHEET 6 OF 6

NOTES LEU

DATE 4/18/16

ROUTE SR 108

H.C. HOMAN

WEATHER SUNNY

COUNTY FULTON

R.C. LEU

TEMP. 55°

TOWNSHIP CHESTERFIELD

DWG BY NIESE

PID PAVETRAIN

SECTION 8

T 9 S R 2 E

TYPE MONUMENT MAG/WASHER

ON SURFACE - ~~BELOW~~ ON

OFFSET Q PAVEMENT 0.5' ~~LT~~ : RT

8.8' TO RT EDGE PAVEMENT

STATION: 994+61

HORZ.DATUM: NAD83(2011)

GEOID: NAVD88 2012A

GRID: NORTHING: 748212.808

EASTING: 1501740.609

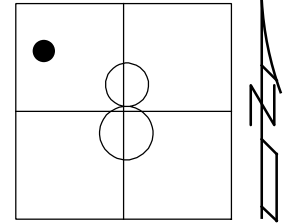

RECORD:
 FD P.K. NAIL
 5/6/04, DCH
 SET MAG/WASHER
 6/2/04, RGN
 FD MAG/WASHER
 4/15/16, DCH
 4/18/16, DCH
 FD MAG/WASHER
 REF26
 6/16/21
 9/17/21, TDN

NOTE:
 APPEARS TO BE P.C. OF CURVE
 ITS THE LAST CURVE BEFORE THE
 OHIO-MICHIGAN LINE.

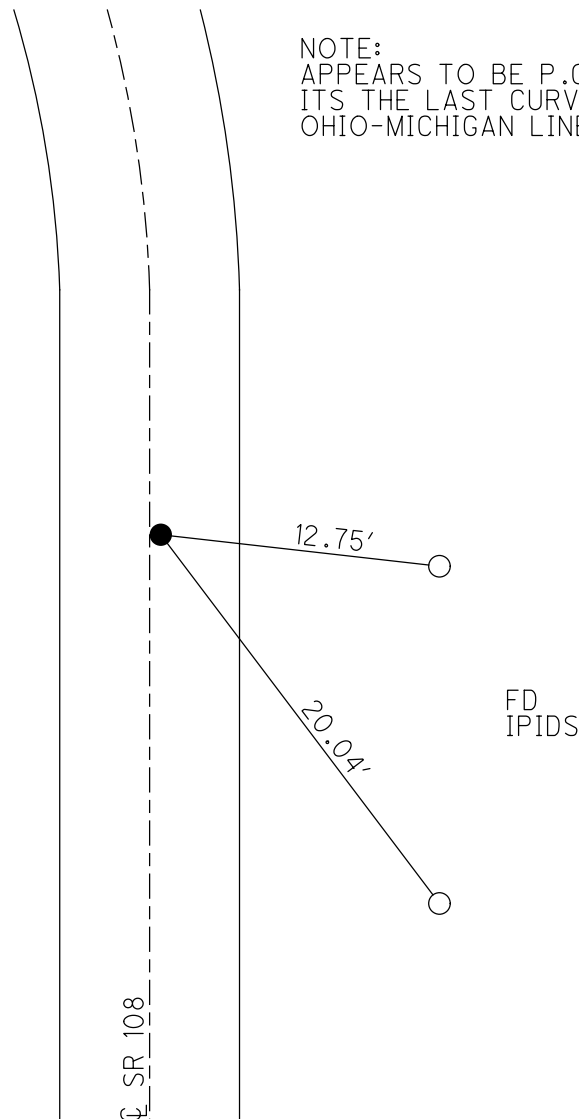

FD
 IPIDS

O.D.O.T. DISTRICT 2 SURVEY OFFICE (USE ONLY)

PERSONNEL _____ REFERENCE NO. 26 SHEET 7 OF 7
 NOTES LEU DATE 04-18-2016 ROUTE SR 108
 H.C. HOMAN WEATHER SUNNY COUNTY FULTON
 R.C. LEU TEMP. 55° TOWNSHIP CHESTERFIELD
 _____ SECTION 8
 _____ T 9 S R 2 E

TYPE MONUMENT MAG/WASHER
~~ON SURFACE~~ - BELOW ON
~~LEFT~~ - ~~Q~~ PAV'T - RIGHT 0.5'
8.8' TO RT EDGE PAVEMENT
 S.L.M. 995+21

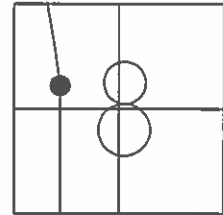

GRID: NORTHING: 748212.837 EASTING: 1501740.637

RECORD:
 FD P.K.NAIL
 5/6/04, DCH
 SET MAG/WASHER
 6/2/04, RGN
 FD MAG/WASHER
 REF26
 4/15/16, DCH

NOTE:
 APPEARS TO BE P.C. OF CURVE
 ITS THE LAST CURVE BEFORE THE
 OHIO-MICHIGAN LINE.

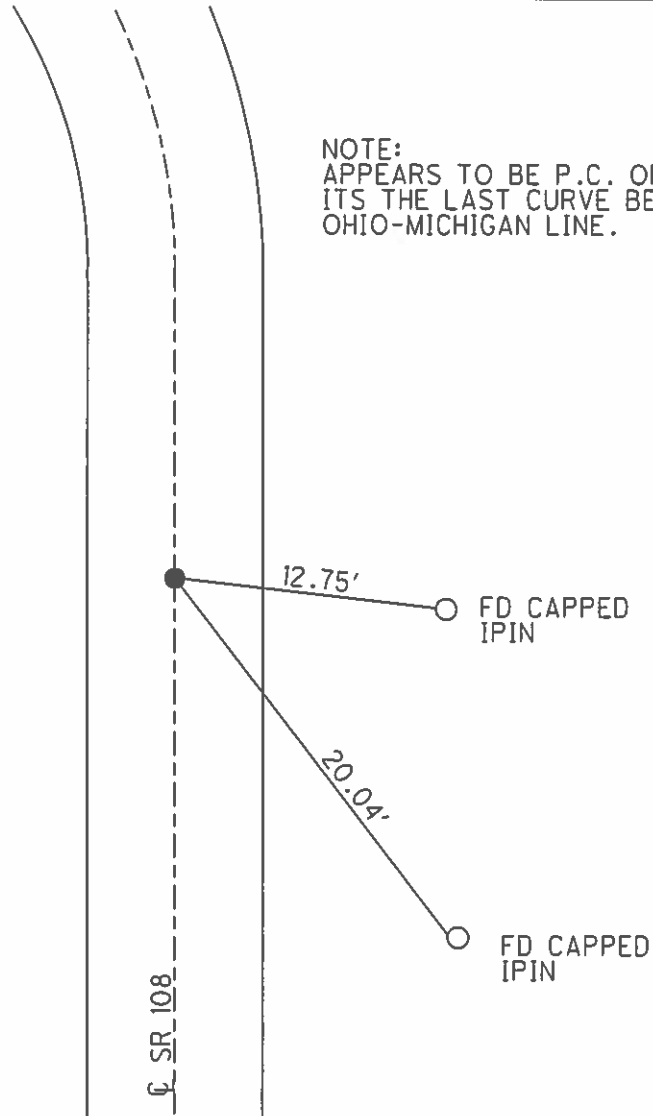

O.D.O.T. DISTRICT 2 SURVEY OFFICE

PERSONNEL

REFERENCE NO. 26

SHEET 7 OF 7

NOTES HOMAN

DATE 5-07-0

ROUTE SR 108

H.C. HOMAN

WEATHER CLOUDY

COUNTY FULTON

R.C. CANTERBURY

TEMP. 55°

TOWNSHIP CHESTERFIELD

SECTION 8

T 9 S R 2 E

TYPE MONUMENT PK NAIL

~~ON SURFACE~~ - BELOW 3"

~~LEFT - C PAV'T~~ - RIGHT 1.2' RT

8.8' TO RT EDGE PAVEMENT

S.L.M. 995+21

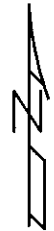
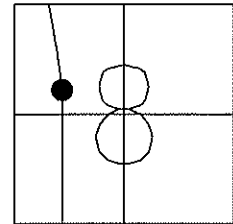

SET MAG NAIL
& WASHER
6-02-04
RGN

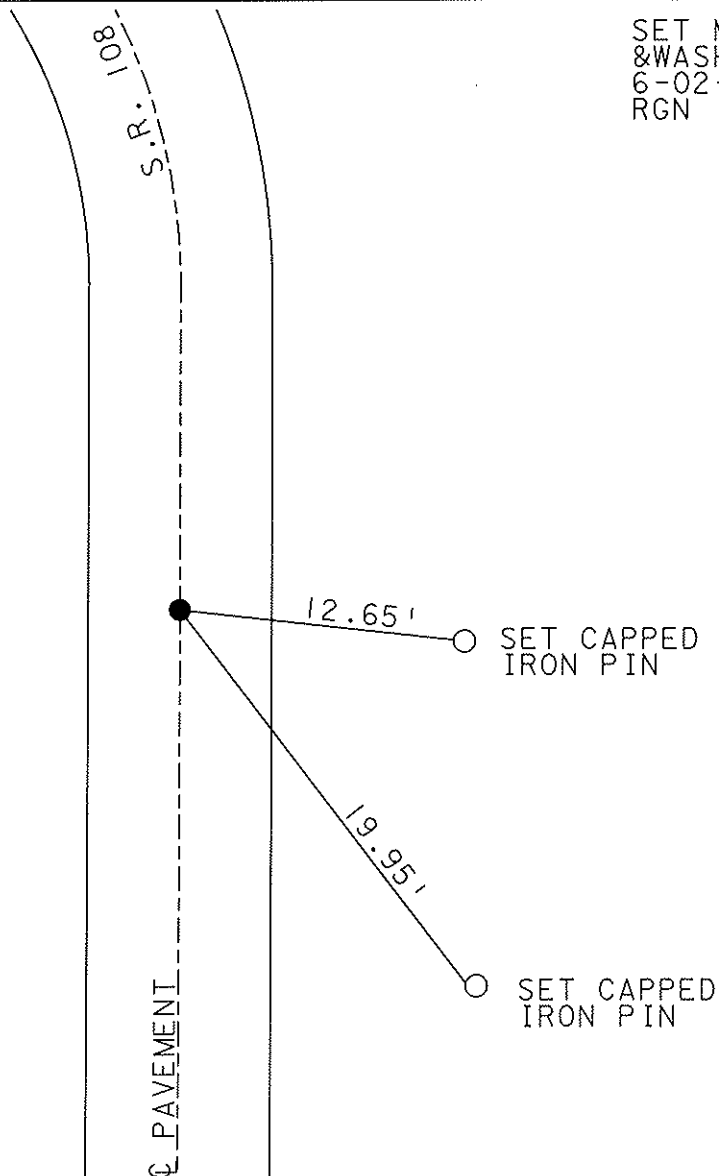

O.D.O.T. DISTRICT 2 SURVEY OFFICE

PERSONNEL _____

REFERENCE NO. 26

SHEET 6 OF 6

NOTES D. CURTIS

H.C. J. HOUSEHOLDER

DATE 6-1-88

ROUTE S.R. #108

R.C. _____

WEATHER WARM

COUNTY FULTON

TEMP. 90°±

TOWNSHIP CHESTERFIELD

SECTION 8

T _____ R _____

TYPE MONUMENT P.K. NAIL

ON SURFACE - ~~BELOW~~ ON SURFACE

LEFT- & PAV'T. - RIGHT & PAV'T

_____ TO _____ EDGE PAVEMENT

S.L.M. 995 + 29

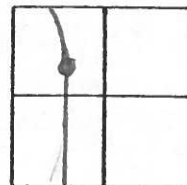

SET P.K. NAIL TO SURFACE
6-17-88

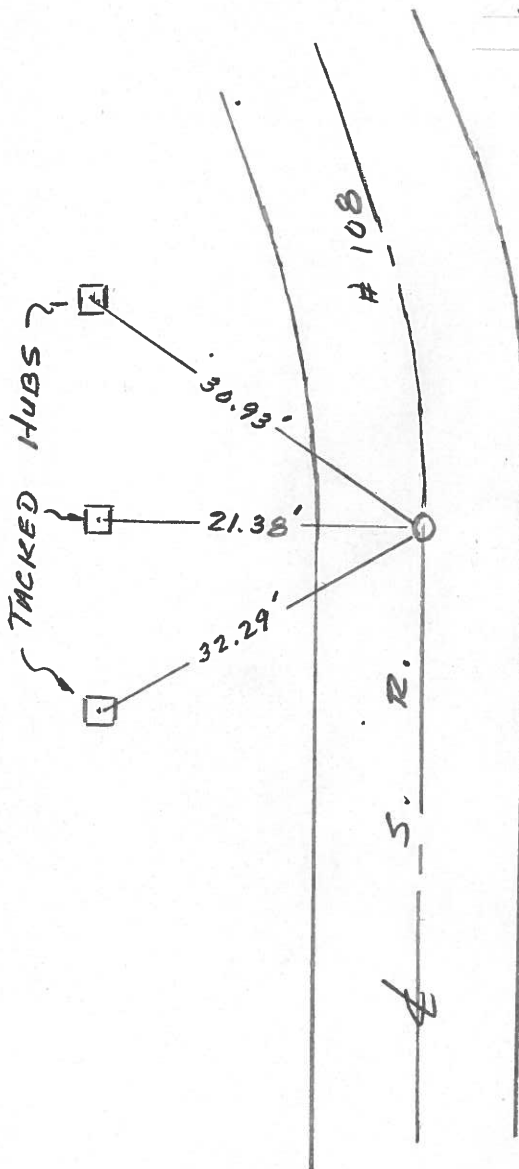

PERSONNEL	TITLE	PERSONNEL	TITLE	COUNTY	DATE	WEATHER	TEMP.
Tomsic				Fulton	April 25, 1973		
Blouse				S. R. 108			
Manata							
Imyo				SEC.			

DESCRIPTION _____ LEFT _____ CENTER LINE _____ RIGHT _____ JOB NO. _____

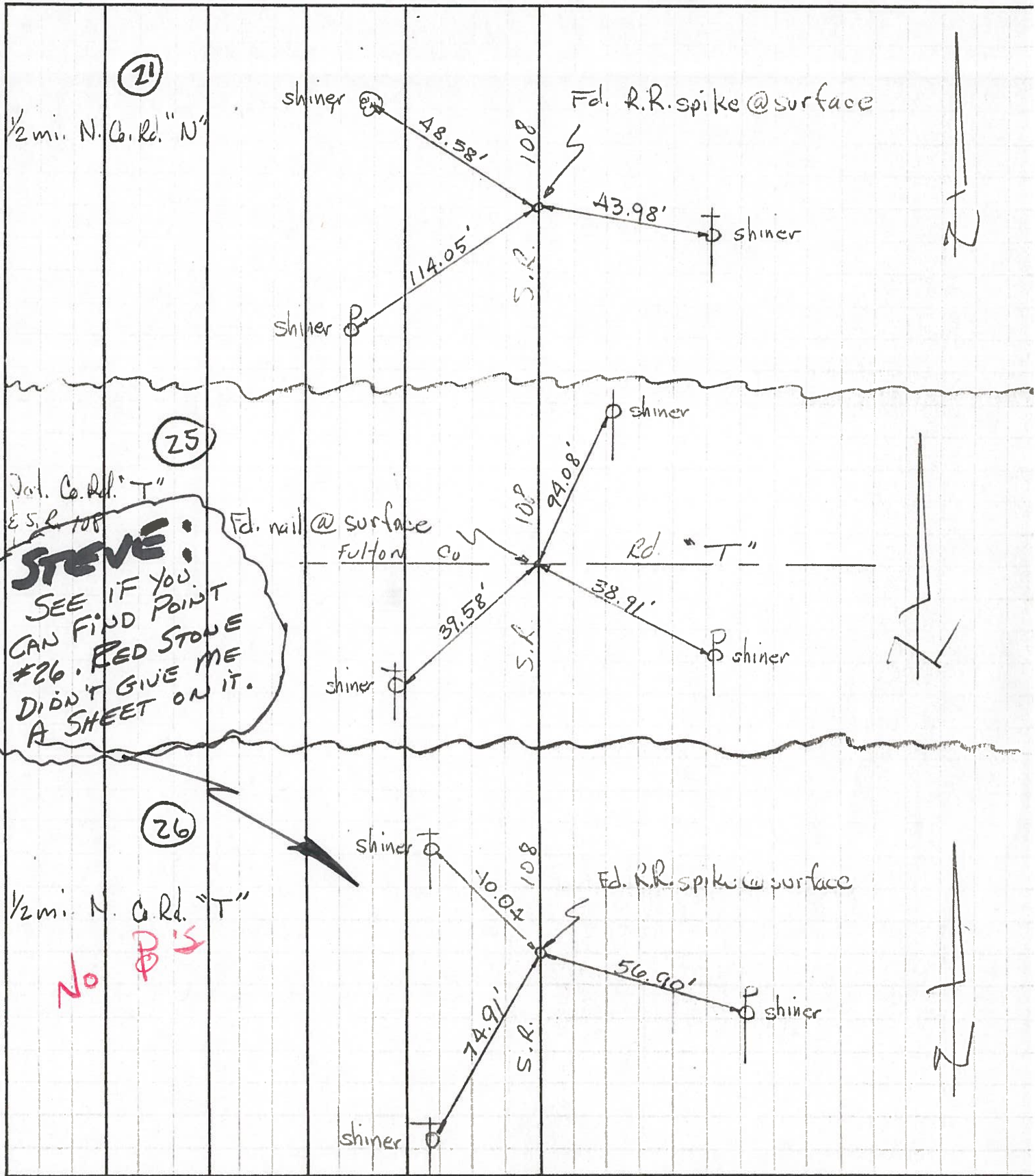

Dist. Co. Rd. "T"
E.S.R. 108

STEVE:
SEE IF YOU
CAN FIND POINT
#26. RED STONE
DIDN'T GIVE ME
A SHEET ON IT.

1/2 mi. N. Co. Rd. "T"
No P's

(21)

Shiner 12 1/2" Maple Tree

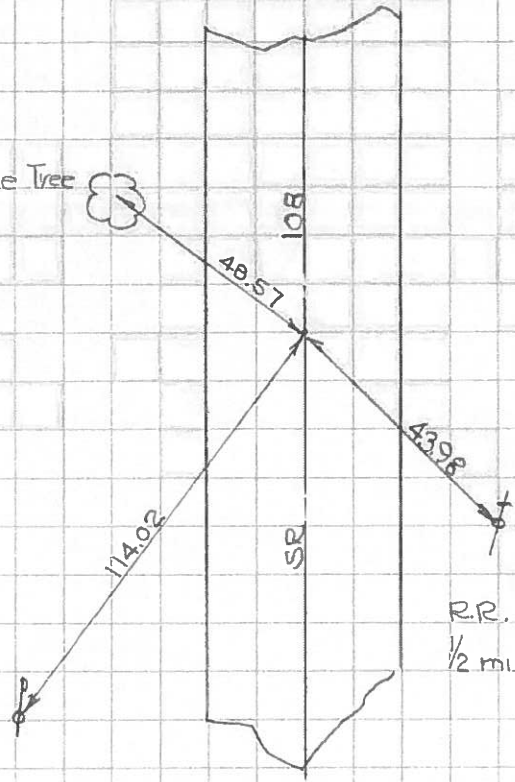

R.R. spike flush with pavement
 1/2 mile south US 20

(20)

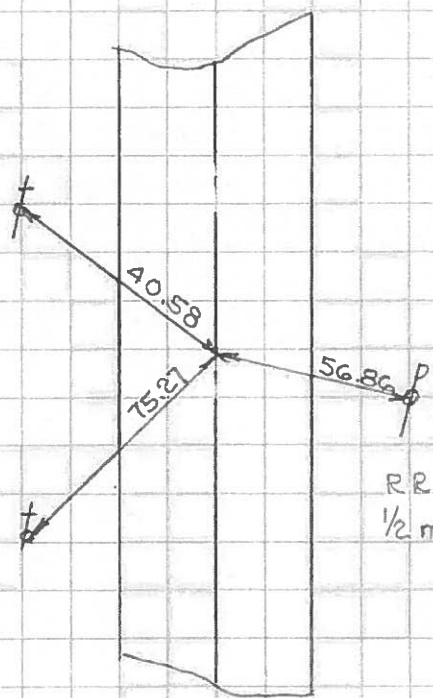

R.R. spike flush with pavement
 1/2 mi south Michigan State line