

FED. AID DISC. NO.	STATE	FED. AID PROJECT	FISCAL YEAR
	OHIO		

1
2

54 IGH 299
FULTON
SEC. C-2
COUNTY
RIGHT OF WAY PLANS

CECIL MARIE HAVENS

R.R. No. 2

DELTA OHIO

TWP-YORK SEC-12,1,36 T-6-N R-7-E

3x

EMMA KLINE

JACOB MOLAR

DAY EVERMAN

EDWARD L. WILEY

AMBROSE JONES

CHAS. SMITH

1 **A.E. + VIVIAN SPIESS**
R.R. No. 2
DELTA O.

3 **HARVEY L. RHODES**
R.R. No. 2
DELTA O.

4 **FRED + MARY MOECK**
R.R. No. 2
DELTA O.

2 **A.E. + VIVIAN SPIESS**
R.R. No. 2
DELTA O.

5 **OLIVER L. MILLER**
R.R. No. 2
DELTA O.

6 **DON EVERMAN**
R.R. No. 2
KOKOMO INDIANA.

8 **MYRA E. GUNN**
R.R. No. 2
DELTA O.

7 **EDWARD L. WILEY**
R.R. No. 2
DELTA O.

9 **C.S. SMITH**
SYLVANIA O.

10 **AMBROSE JONES**
R.R. No. 2
DELTA O.

12 **HARRY I. + BETSY TABER**
R.R. No. 3
DELTA O.

11 **EARL N. CRUIT**
LIBERTY CENTER O.

13 **CHAS. TREMAIN ESTATE**
R.R. No. 2
DELTA OHIO
EARL SCHLEGLE GUARDIAN
R.R. No. 2
DELTA O.

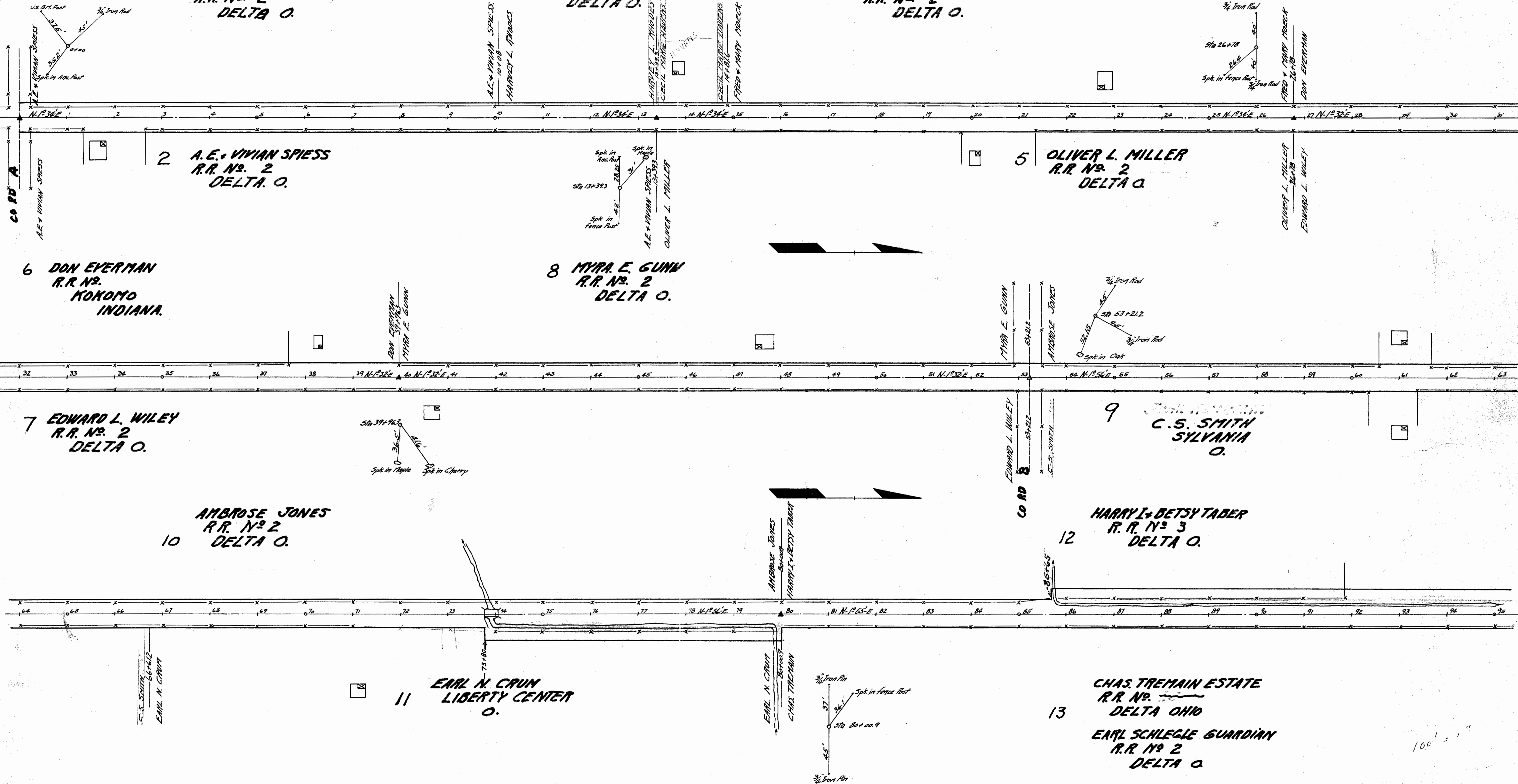

Recorded
June 1997

R109
T-1
A-22

100' = 1"

A-22

FED. AID DIST. NO.	STATE	FED. AID PROJECT	FISCAL YEAR
	OHIO		

2
2

SH. 164 299 SEC. C-2
FULTON COUNTY
RIGHT OF WAY PLANS.

Revised
June 1947

