

FULTON COUNTY HIGHWAY DEPARTMENT  
 OLD TERRITORIAL ROAD  
**LYONS - MORENCI ROAD** No 9  
 COUNTY IMP. No 37 SEC.-B  
 ROYALTON AND CHESTERFIELD TOWNSHIPS  
 1926

**CONSTRUCTION NOTES**

- Bermes, slopes and ditches shall be finished to conform to cross sections as shown for each station and put in shape for immediate seeding.
- There shall be no open ditches along yards and drives and where new grade is finished above present grade at yards and drives the slope shall continue back to conform with berme slope.
- Pipe and tile shall be placed as shown on the plans and cross sections.
- The Contractor shall connect all lateral drains with tile provided the land-owner does extra excavating and furnishes sufficient tile at the time Contractor is laying the tile under his contract. Special care shall be taken not to damage any side drains along open ditches.
- All pipe placed in side road ditches for overflow water shall be laid true to line and grade.
- The joints of all pipe laid at outlet end of tile shall be thoroughly covered with concrete.
- All material removed and not used on this improvement shall be placed in neat piles at side of road.
- All Monuments or Land Markers found by Contractor during progress of work shall not be disturbed until Engineer has established witnesses to same.
- All backfill where pipe is removed is to be thoroughly tamped.
- Joints where size of tile change, special connections, lateral connections and up-stream end of tile drains shall be thoroughly sealed and covered with concrete.
- All trees or stumps within stake lines shall be removed unless special permission, to leave same, is given by the Engineer in charge.

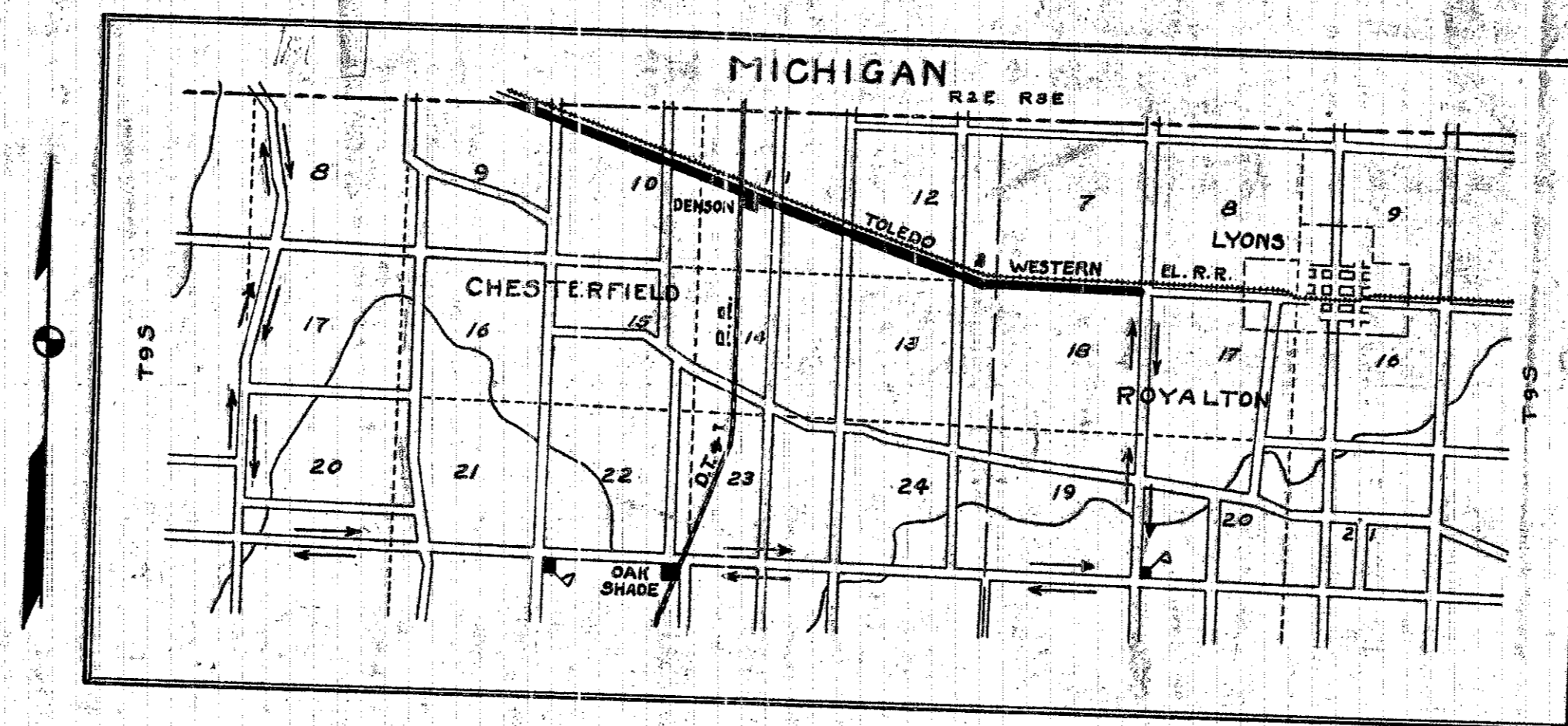

LOCATION PLAN

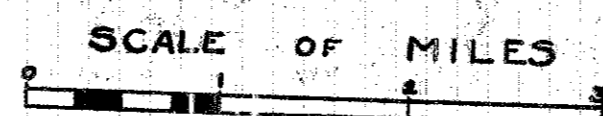

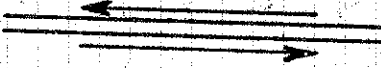
PORTION TO BE IMPROVED   
 DETOURS SHOWN THUS 

**SCALES**

PLAN	1" = 100'
PROFILE (Vertical)	1" = 10'
PROFILE (Horizontal)	1" = 100'
CROSS SECTIONS	1" = 5'

**RIGHT OF WAY**

Reference - Page one of Transcript from Lucas County.  
 Established - 1837  
 Width - 60 feet.

**INDEX**

Title Page	p. 1
Typical Cross Sections	p. 2, 14
Plans and Profile	p. 3-9, 14-16
Cross Sections	p. 3-9, 14-16
Structural Plans	p. 10-11, 17
Drain Tile Chart	p. 13, 17
Driveway Pipe Chart	p. 13, 17
Summary Quantities	p. 12, 17

**CONVENTIONAL SIGNS**

State line	-----
County line	-----
Township line	-----
Section line	-----
Property line not fenced	-----
Center line	-----
City or village line	-----
Fence	-----
Telephone or telegraph	TTTTTT
Steam railroad	-----
Electric line	-----
Trees or stumps	⊗ ⊗ ⊗ ⊗ ⊗
Drain pipe - new	-----
Drain pipe - old	-----

I hereby approve these plans and declare that the making of this improvement will require the closing to traffic of the highway and that detours will be provided as shown on the plan and estimate.

Approved: L. W. Bates County Surveyor  
 Date: 4-5 1926

We the Commissioners of Fulton County hereby approve these plans and certify that the right of way is available for the construction, maintenance and repair of the above highway

W. A. Jappan  
M. A. Patchoff  
A. Landis Ford  
 County Commissioners  
 Date: 4-30 1926

Sta. 0+00 (Beginning of Imp.)  
at State Line  
R.R. spk. on E.  
99.55' S.E. to N.W. cor. of House  
47.0' N to Line Pole marked S110 1/2

Sta. 0+00 to 7+86  
Bearing S 71°-30' E

From 0+00 to 7+50 place  
760' new 5" drain tile, to  
L of E.

From 8+10 to 14+00 place  
590' new 5" drain tile, to  
L of E.

From 14+00 to 24+00 place  
1800' new 6" drain tile, to  
L of E.

Sta. 24+85 Drive  
Take up, clean &  
relay 16'-10" U.S.P.

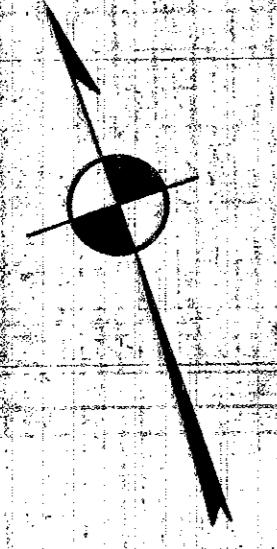

B.M. - R.R. spk. in phone pole  
25' L at sta 0+20 Elev. 807.31

B.M. - Spk. in Maple Tree S.E. cor.  
of cross-road at 7+86. Elev. 804.91

Note: Grade line shown as crown  
of finished pavement.

B.M. - R.R. spk. in Maple Tree  
on Lat 21+80. Elev. 803.92

Sta. 7+86  
10 cu. yds. stone to be spread  
every 5' thick on traveled  
roadway of approaches - 5  
cu. yds. on each side of road.

CURVE TABLE

Left	Station	Grade Elev.	Right
Edge of Pav.	780.93	163+75.08	780.93
Edge of Pav.	781.12	164+00	781.24
Edge of Pav.	781.31	164+25.08	781.44
Edge of Pav.	781.49	164+50	781.62
Edge of Pav.	781.68	164+75.08	781.81
Edge of Pav.	781.87	165+00	782.00
Edge of Pav.	781.99	165+25	782.12
Edge of Pav.	782.12	165+50	782.25
Edge of Pav.	782.24	165+75	782.37
Edge of Pav.	782.37	166+00	782.50
Edge of Pav.	782.49	166+25	782.62
Edge of Pav.	782.62	166+50	782.75
Edge of Pav.	782.74	166+75	782.87
Edge of Pav.	782.87	167+00	783.00
Edge of Pav.	782.99	167+25	783.12
Edge of Pav.	783.12	167+50	783.25
Edge of Pav.	783.24	167+75	783.37
Edge of Pav.	783.37	168+00	783.50
Edge of Pav.	783.49	168+25	783.62
Edge of Pav.	783.54	168+34.04	783.67
Edge of Pav.	783.62	168+50	783.75
Edge of Pav.	783.74	168+75	783.87
Edge of Pav.	783.79	168+84.04	783.92
Edge of Pav.	783.87	169+00	784.00
Edge of Pav.	783.89	169+25	784.02
Edge of Pav.	783.90	169+34.04	784.03

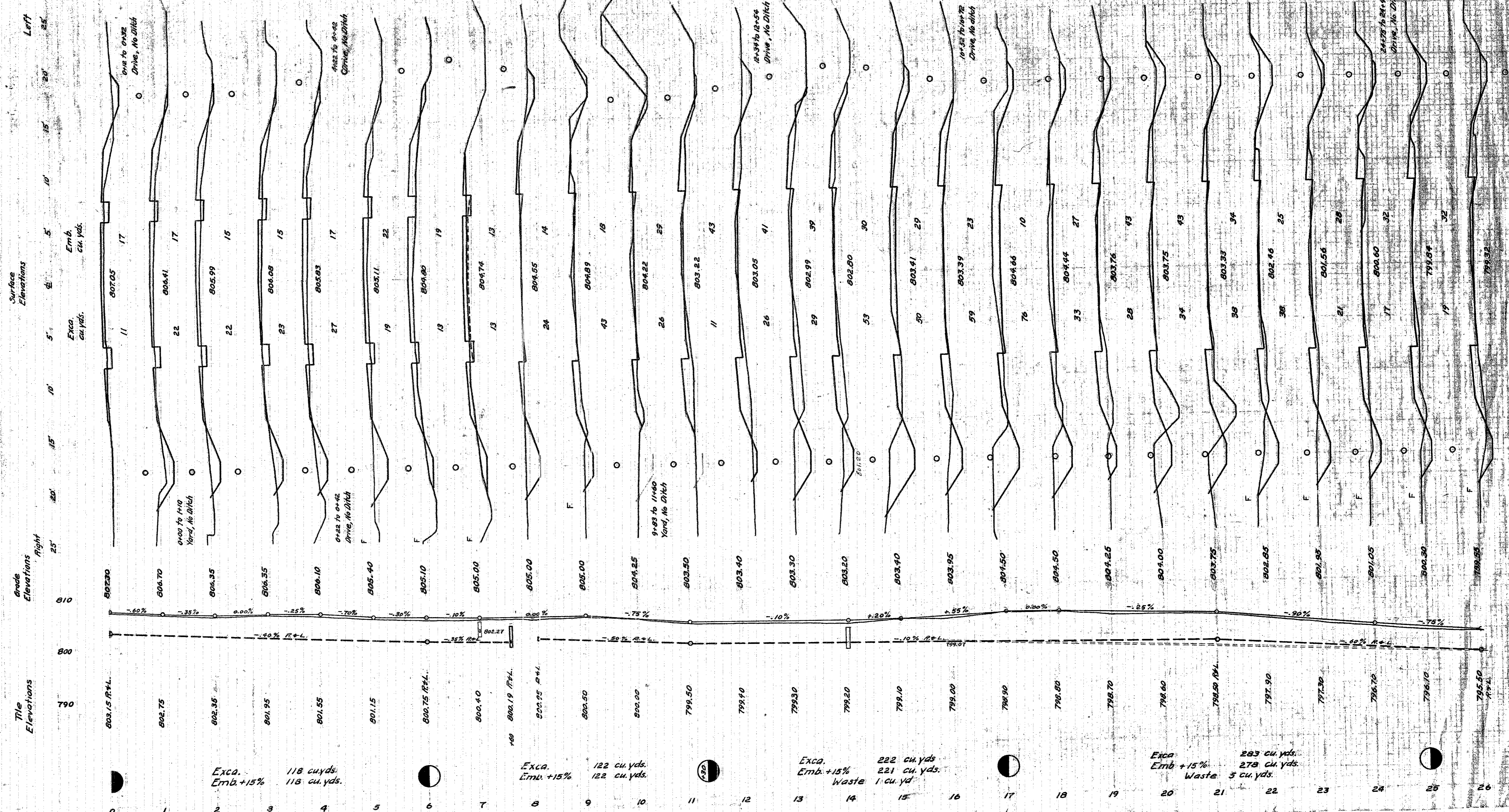

Exca. 118 cu. yds.  
Emb. +15% 118 cu. yds.

Exca. 122 cu. yds.  
Emb. +15% 122 cu. yds.

Exca. 222 cu. yds.  
Emb. +15% 221 cu. yds.  
Waste 1 cu. yd.

Exca. 283 cu. yds.  
Emb. +15% 278 cu. yds.  
Waste 5 cu. yds.

No extra pavement

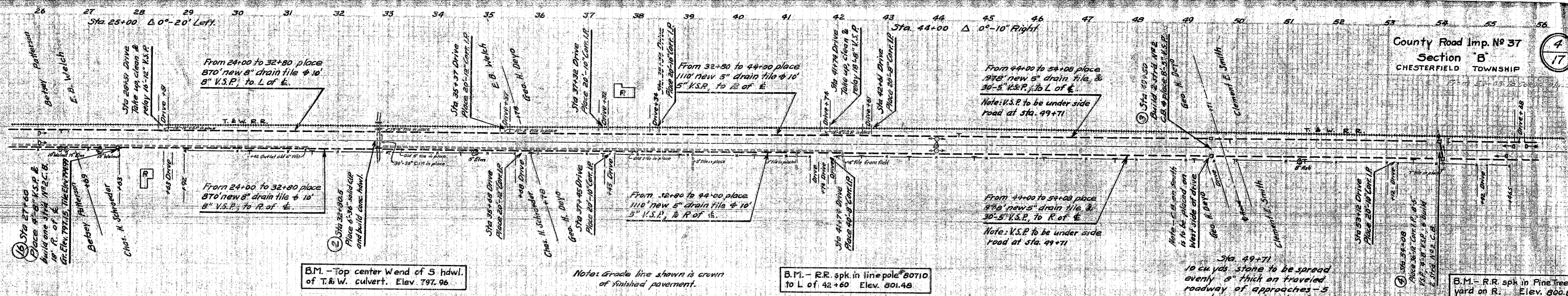

B.M. - Top center Wend of S hdwl. of T. & W. culvert. Elev. 797.96

Notes: Grade line shown is crown of finished pavement.

B.M. - R.R. spk in line-pole #80710 to L of 42+60 Elev. 801.48

Sta. 49+71  
10 cu yds. stone to be spread evenly 6" thick on traveled roadway of approaches - 5 cu yds. on each side of road

B.M. - R.R. spk in Pine tree in yard on R. Elev. 800.81

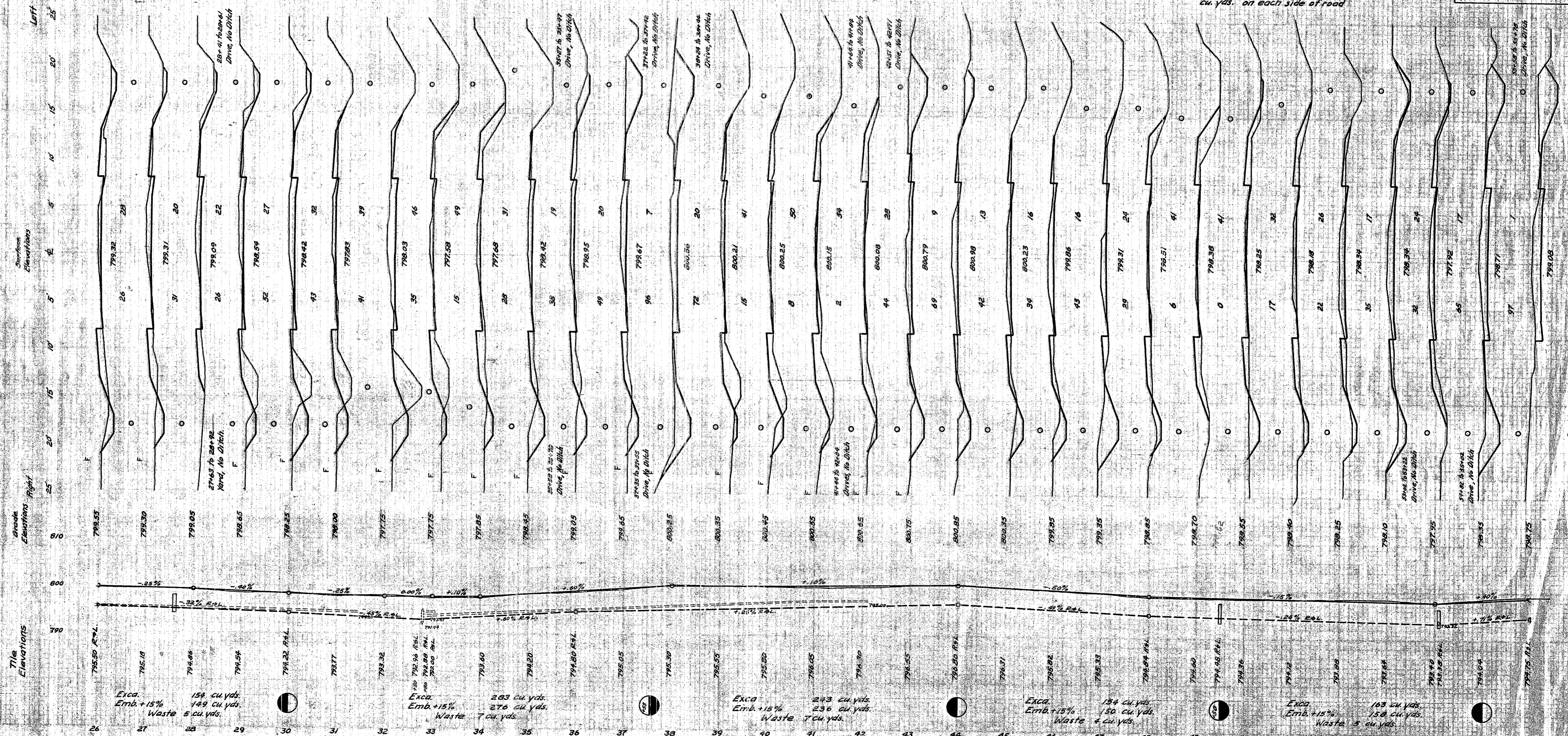

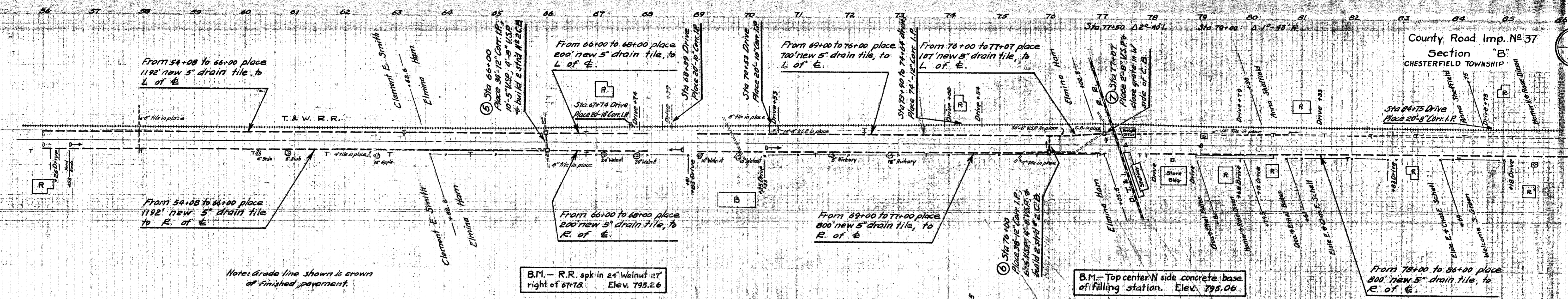

Note: grade line shown is crown of finished pavement.

B.M. - R.R. spk in 24' Walnut at right of 67+78. Elev. 795.26

B.M. - Top center N side concrete base of filling station. Elev. 795.06

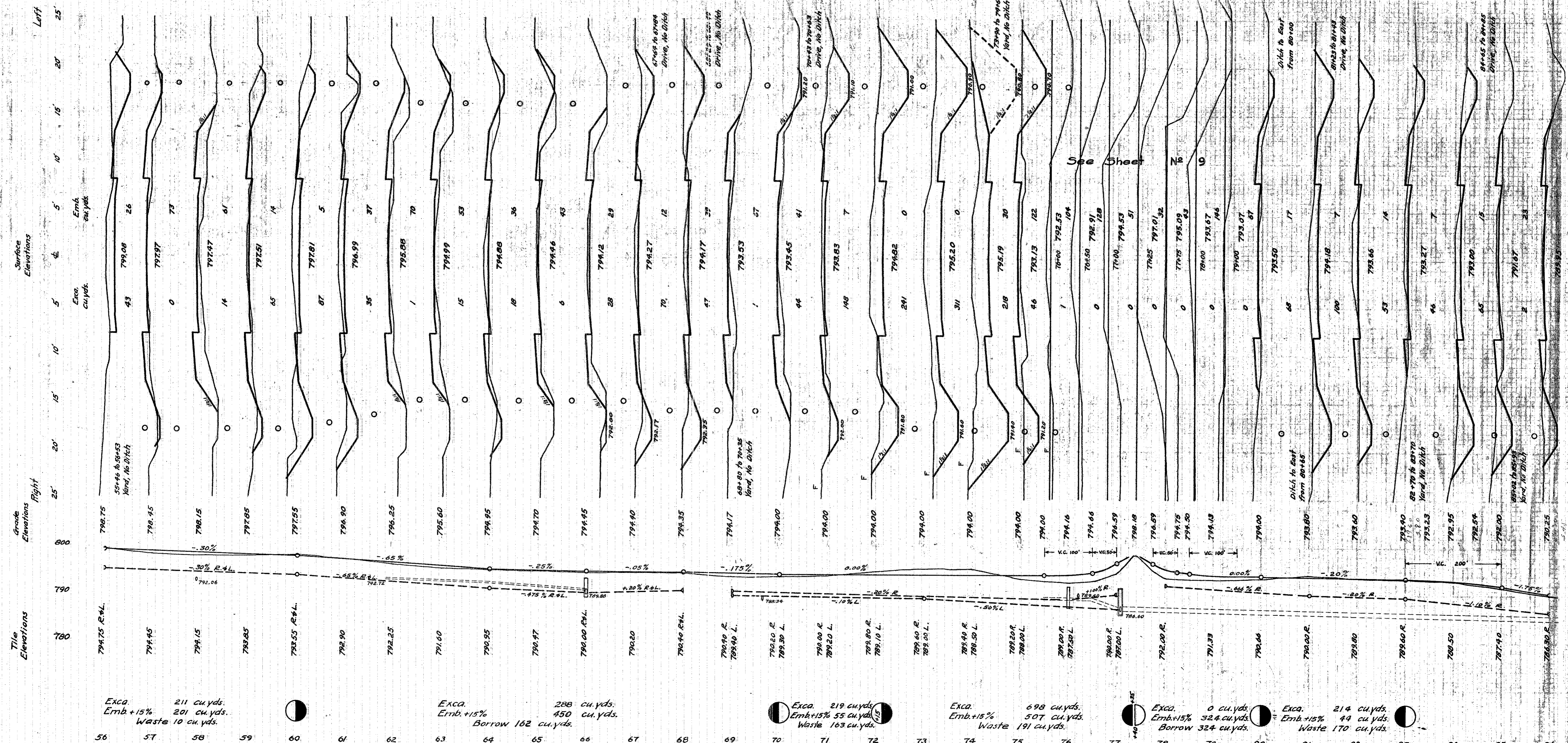

Station	Excavation (cu. yds.)	Embankment (+15%) (cu. yds.)	Waste (cu. yds.)	Borrow (cu. yds.)
56	211	20	20	
57	43	0	0	
58	14	61	0	
59	65	5	0	
60	87	35	0	
61	1	70	0	
62	15	53	0	
63	18	36	0	
64	6	43	0	
65	28	29	0	
66	70	12	0	
67	47	39	0	
68	44	41	0	
69	143	7	0	
70	241	0	0	
71	301	0	0	
72	218	30	0	
73	46	122	0	
74	1	104	0	
75	0	128	0	
76	0	51	0	
77	0	32	0	
78	0	43	0	
79	0	146	0	
80	0	67	0	
81	68	17	0	
82	100	7	0	
83	53	14	0	
84	46	7	0	
85	65	18	0	
86	2	23	0	

Excav. 211 cu. yds.  
Emb.+15% 20 cu. yds.  
Waste 20 cu. yds.

Excav. 288 cu. yds.  
Emb.+15% 450 cu. yds.  
Borrow 162 cu. yds.

Excav. 219 cu. yds.  
Emb.+15% 55 cu. yds.  
Waste 163 cu. yds.

Excav. 698 cu. yds.  
Emb.+15% 507 cu. yds.  
Waste 191 cu. yds.

Excav. 0 cu. yds.  
Emb.+15% 324 cu. yds.  
Borrow 324 cu. yds.

Excav. 214 cu. yds.  
Emb.+15% 44 cu. yds.  
Waste 170 cu. yds.

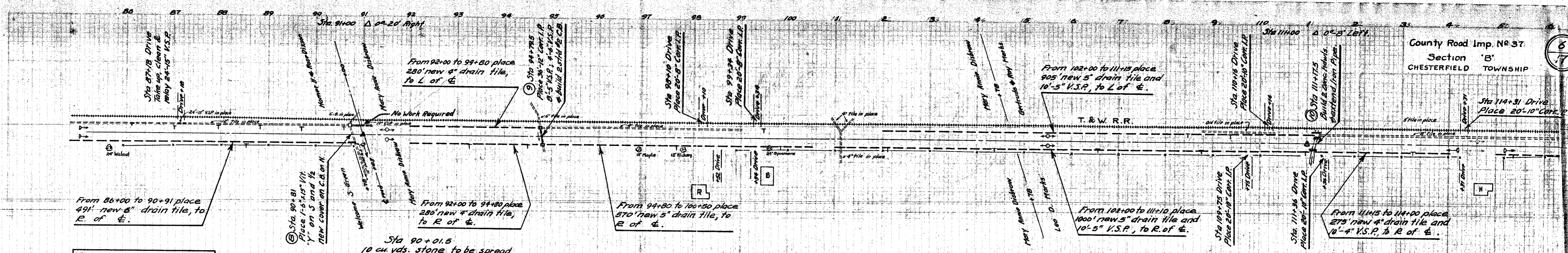

B.M. — RR. spk. in 24" Walnut  
33' R of 65+63. Elev. 792.76

Sta 90+01.5  
10 cu. yds. stone to be spread  
evenly 8' thick on traveled  
roadway of approaches — 5  
cu. yds. on each side of road.

B.M. — RR. spk. in Sycamore Tree  
30' R of 98+62. Elev. 790.08

Note: Grade line shown is crown  
of finished pavement.

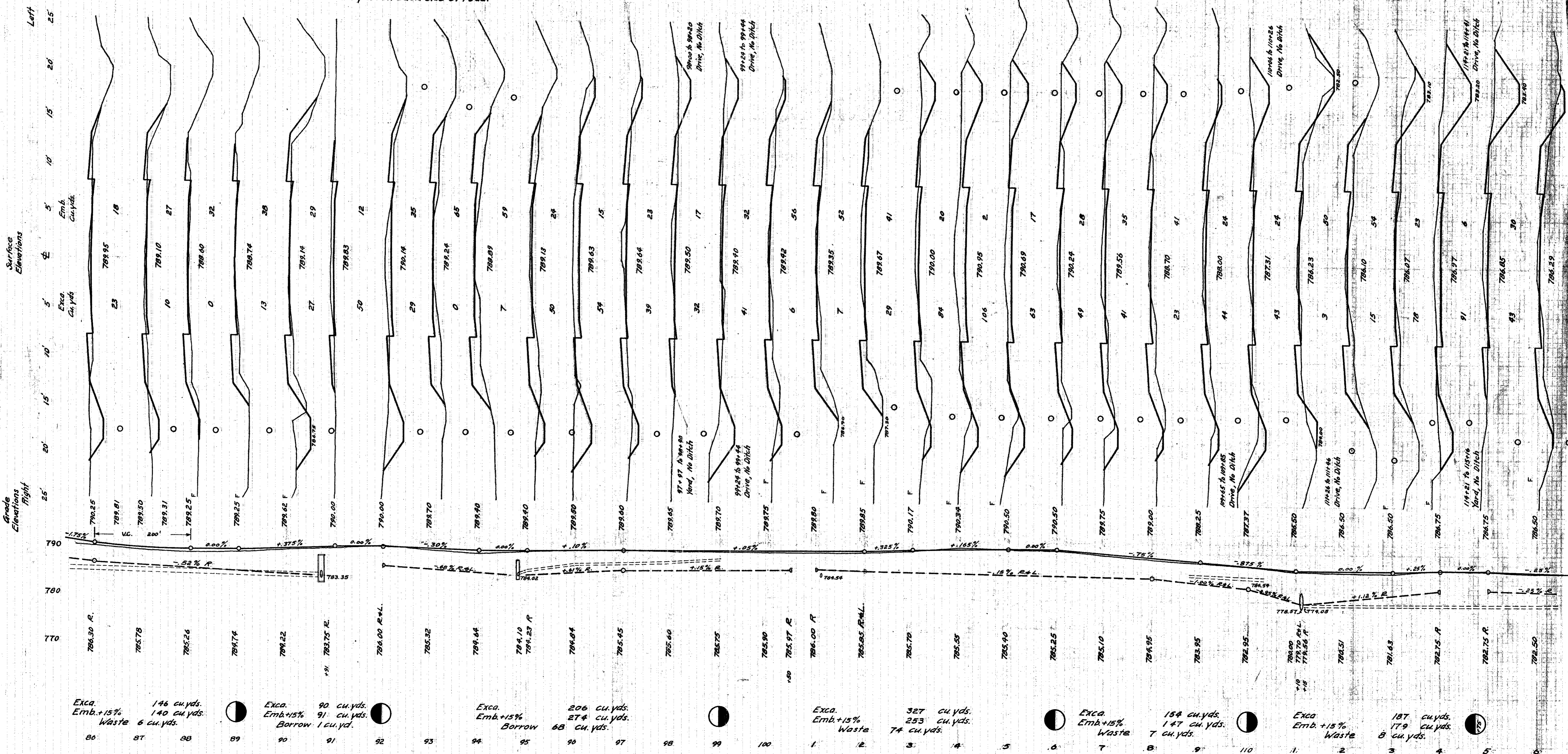

Excav. 146 cu. yds.  
Emb.+15% 140 cu. yds.  
Waste 6 cu. yds.

Excav. 90 cu. yds.  
Emb.+15% 91 cu. yds.  
Borrow 1 cu. yd.

Excav. 206 cu. yds.  
Emb.+15% 274 cu. yds.  
Borrow 68 cu. yds.

Excav. 327 cu. yds.  
Emb.+15% 253 cu. yds.  
Waste 74 cu. yds.

Excav. 154 cu. yds.  
Emb.+15% 147 cu. yds.  
Waste 7 cu. yds.

Excav. 187 cu. yds.  
Emb.+15% 179 cu. yds.  
Waste 8 cu. yds.

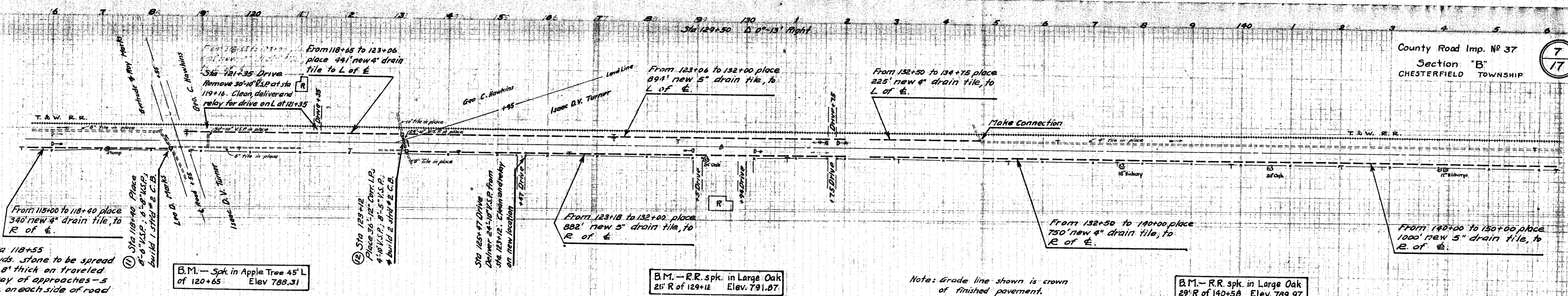

Sta 118+55  
cu. yds. stone to be spread  
only 8\"/>

B.M. - Spk. in Apple Tree 45' L  
of 120+65 Elev. 788.31

B.M. - R.R. spk. in Large Oak  
25' R of 129+12 Elev. 791.87

Note: Grade line shown is crown  
of finished pavement.

B.M. - R.R. spk. in Large Oak  
29' R of 140+50 Elev. 789.97

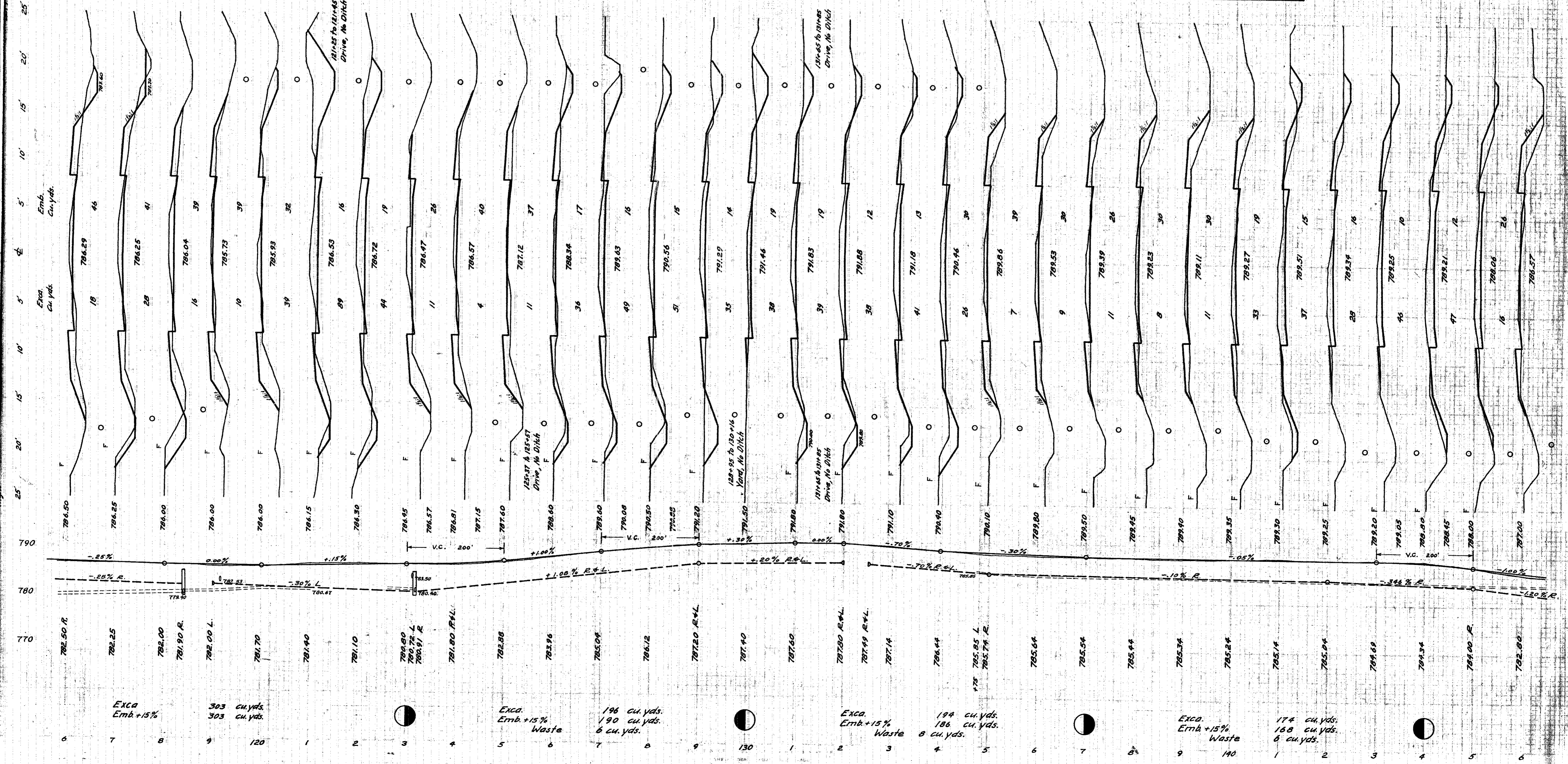

Exca. Emb.+15%  
303 cu. yds.  
303 cu. yds.

Exca. Emb.+15% Waste  
196 cu. yds.  
190 cu. yds.  
6 cu. yds.

Exca. Emb.+15% Waste  
194 cu. yds.  
186 cu. yds.  
8 cu. yds.

Exca. Emb.+15% Waste  
174 cu. yds.  
168 cu. yds.  
6 cu. yds.

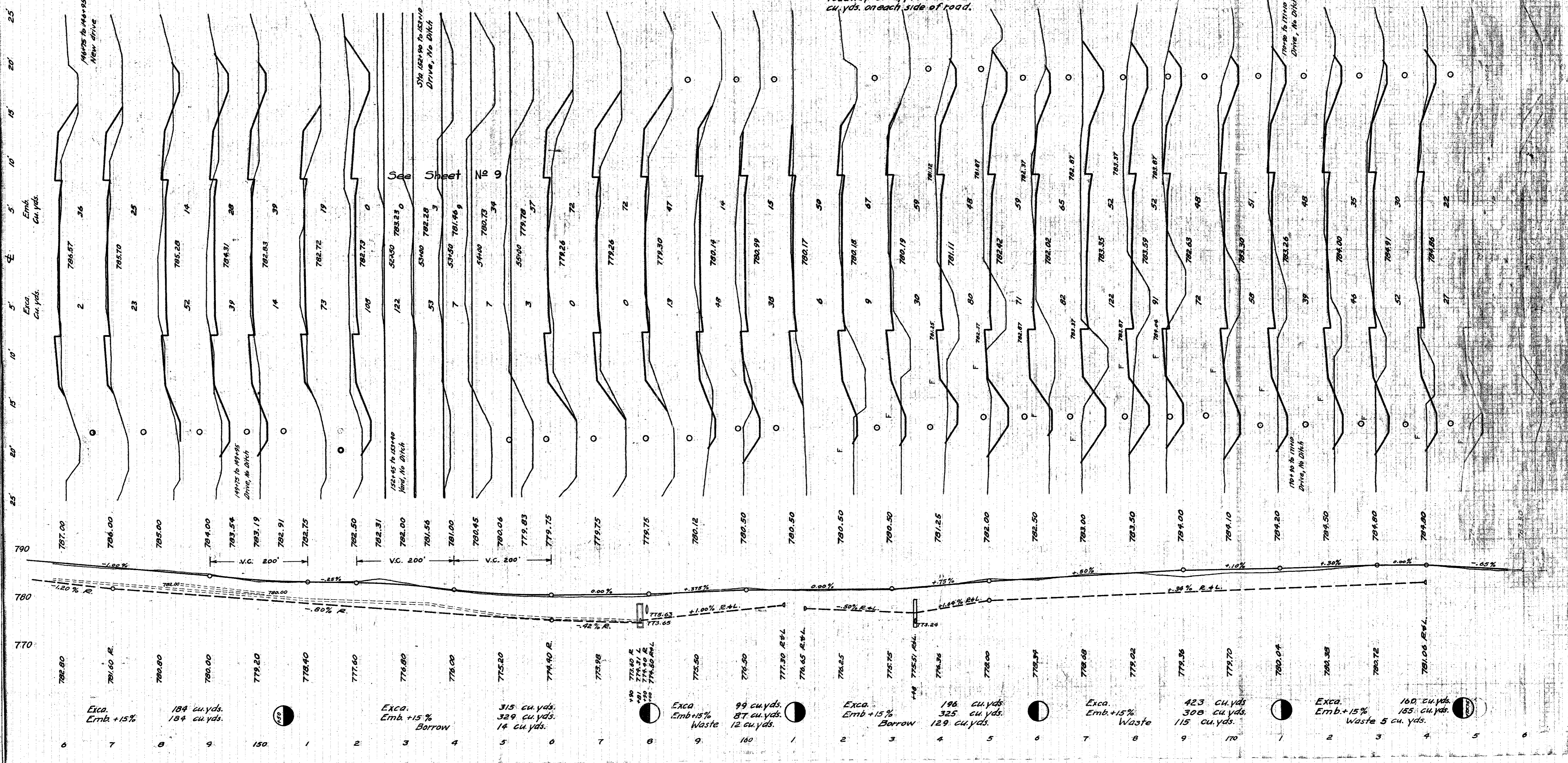
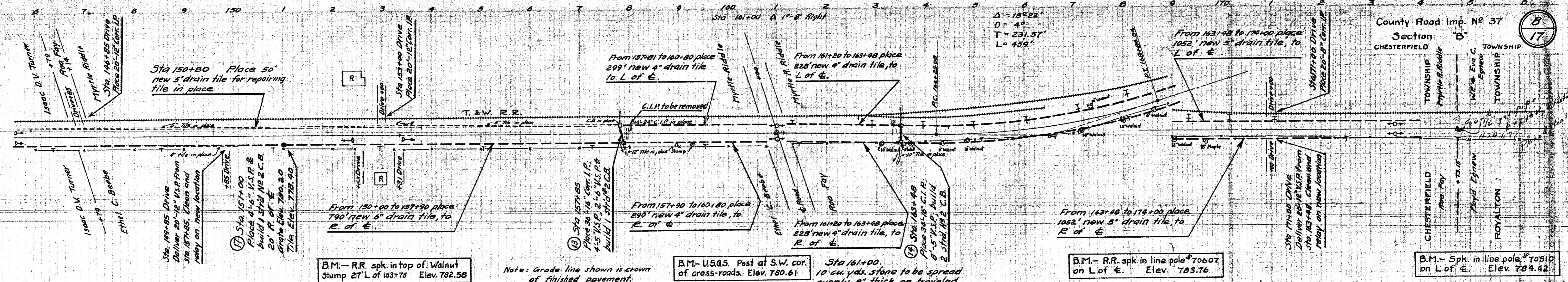

# TYPICAL SECTION FOR WIDENING AND RESURFACING

Sta 174+73.15 to Sta 227+33.2

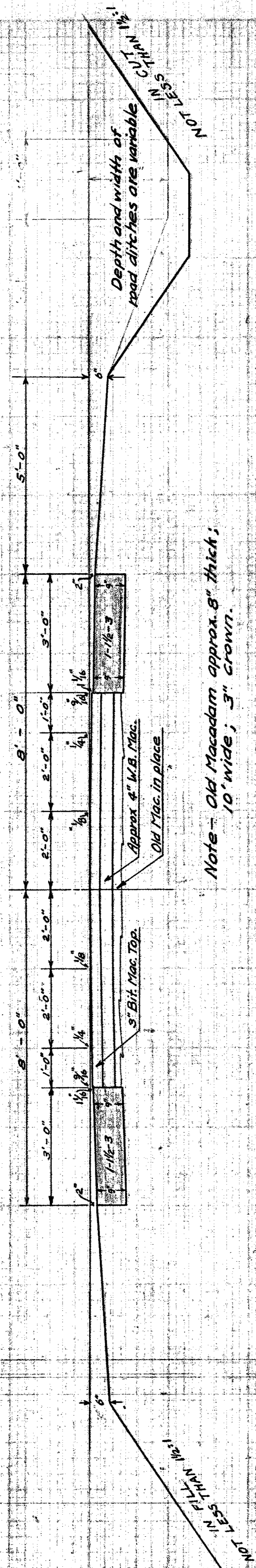

Note - Old Macadam approx. 8" thick; 10' wide; 3" crown.

Secondary form to be carried only to sufficient depth to admit of bonding concrete curb to old macadam in place and to preclude all voids along this line



DETAIL OF CONSTRUCTION JOINT TO BE USED AT END OF WORKING PERIOD

Note: The surface of the old road shall be brought to the proper grade and cross-section for a Bit Macadam Top, by scarifying and adding approximately 4" of stone which shall be thoroughly harrowed, filled, rolled and watered.

DETAIL METHOD OF CONSTRUCTION

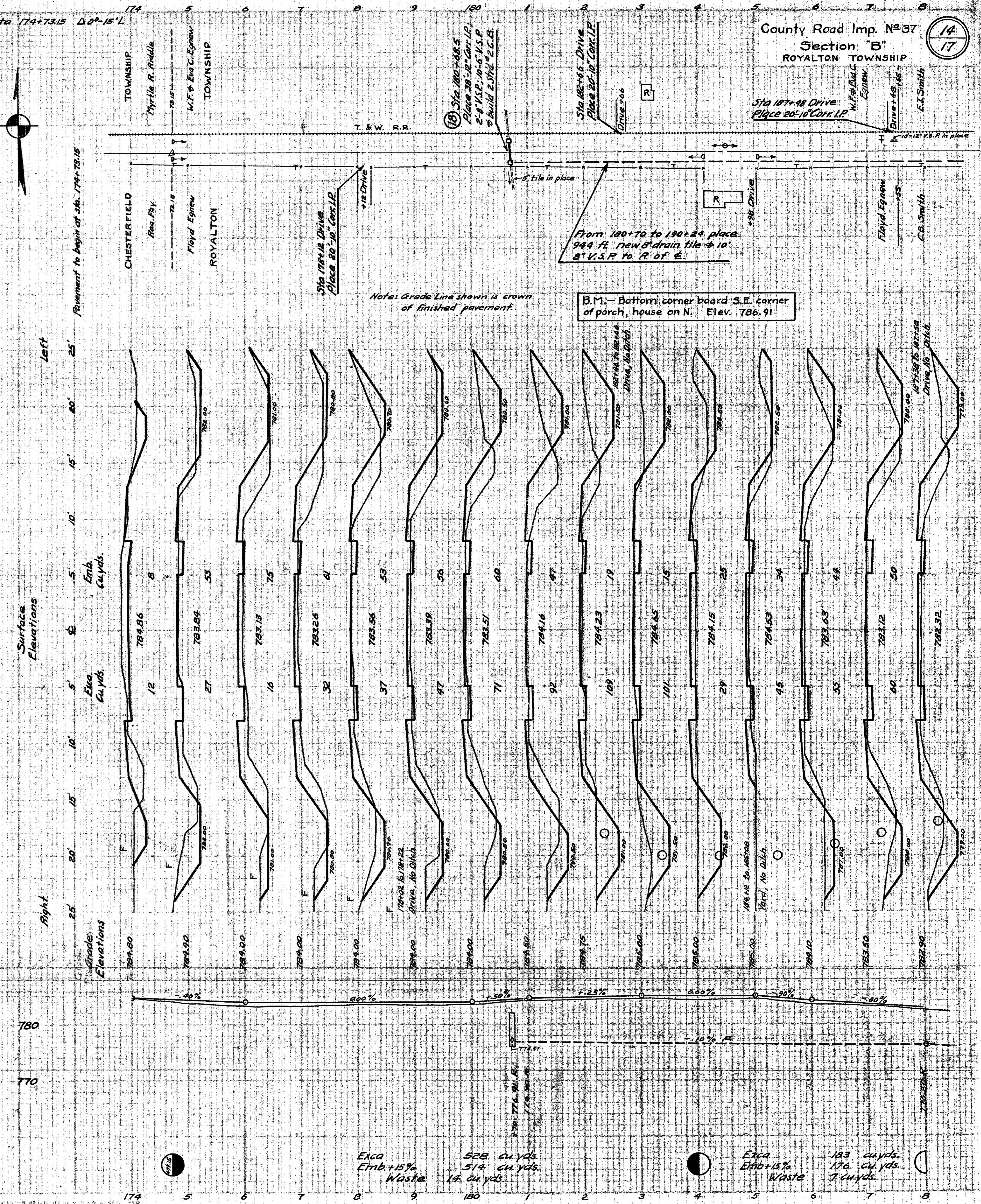

Excav. Emb +15% Waste 528 cu yds. 514 cu yds. 14 cu yds.

Excav. Emb +15% Waste 183 cu yds. 176 cu yds. 7 cu yds.

County Road Imp. No 37  
Section "B"  
ROYALTON TOWNSHIP  
Sta 187+48 Drive Place 20'-10" Cont. LP  
Sta 180+70 to 190+24 place 944 ft. new 8" drain tile 4' 10" 8" V.S.P. to R. of E.  
Sta 180+70 to 190+24 place 20'-10" Cont. LP  
Sta 180+70 to 190+24 place 20'-10" Cont. LP  
Sta 180+70 to 190+24 place 20'-10" Cont. LP

14  
17



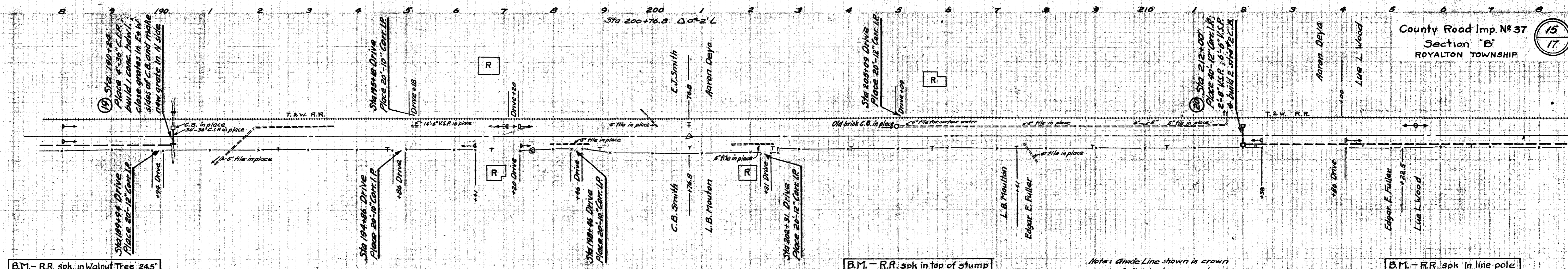

B.M. - R.R. spk. in Walnut Tree 24.5' R of 197+52 Elev. 784.06

B.M. - R.R. spk. in top of stump 30' L of 205+95 Elev. 779.62

Note: Grade Line shown is crown of finished pavement.

B.M. - R.R. spk. in line pole #70201, Lot 6 Elev. 778.58

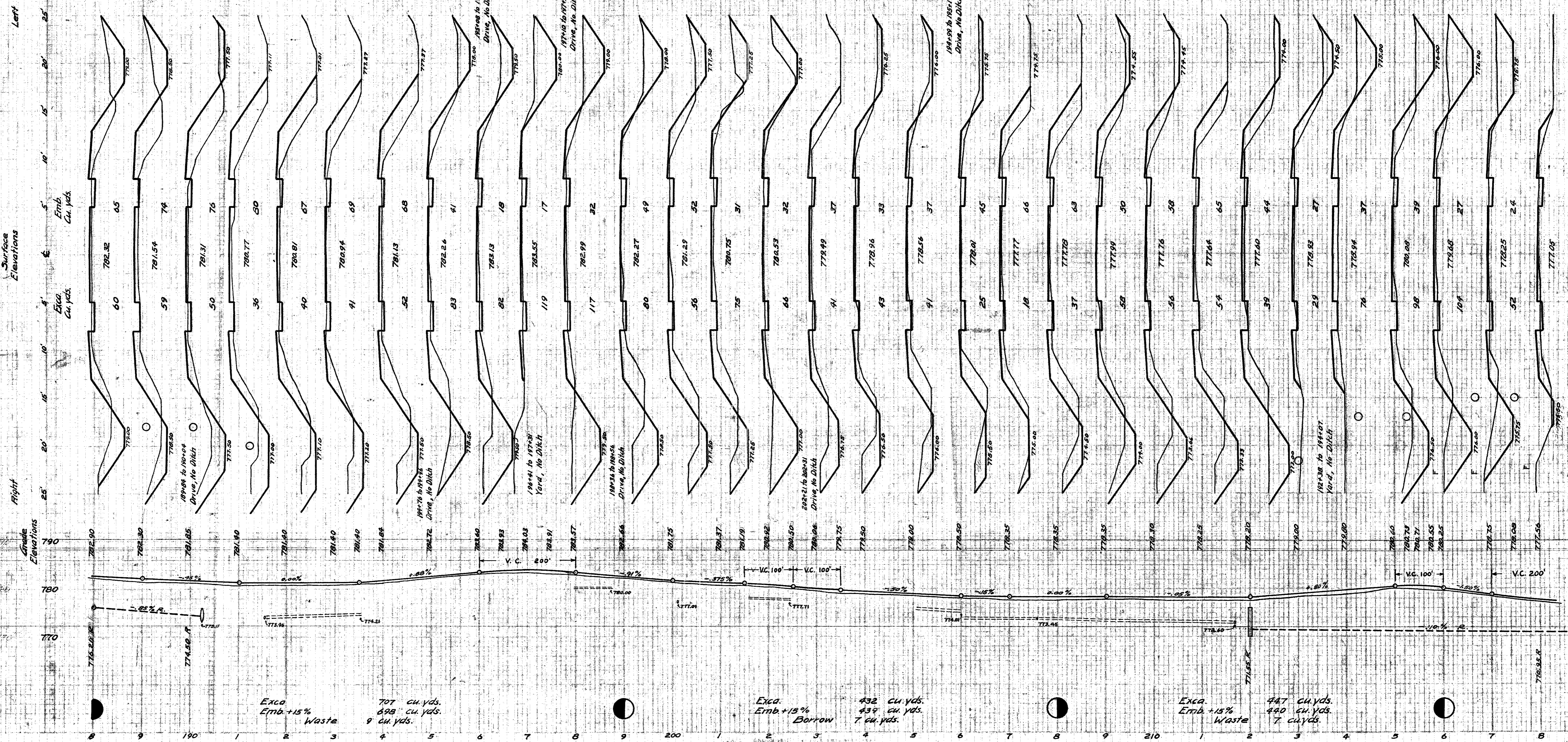

Exca. Emb. +15% Waste  
707 cu. yds.  
698 cu. yds.  
9 cu. yds.

Exca. Emb. +15% Borrow  
432 cu. yds.  
439 cu. yds.  
7 cu. yds.

Exca. Emb. +15% Waste  
447 cu. yds.  
440 cu. yds.  
7 cu. yds.

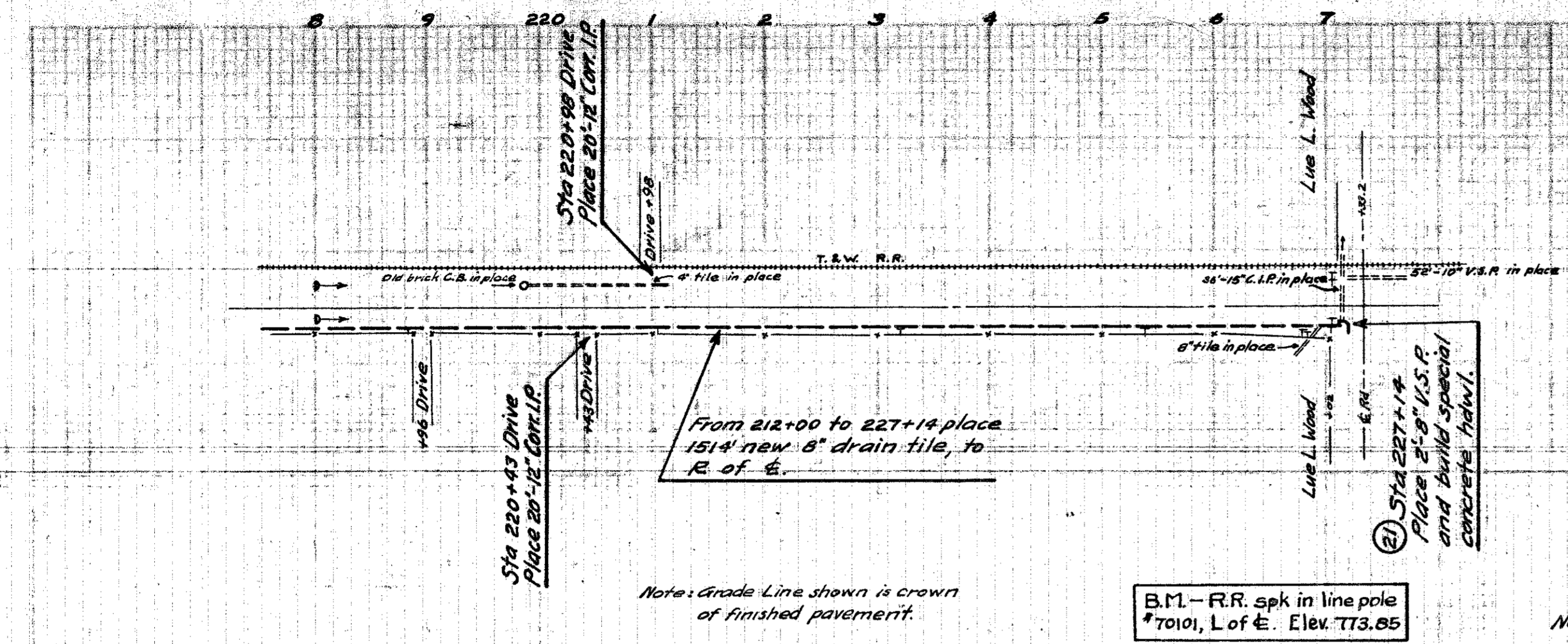

- POINTS ON CENTER LINE**
- Sta 0+00 R.R. spk on C. 99.53' S.E. to N.W. corner of house. 47.0' N. to spk. in line pole marked 5110 1/2.
  - Sta 7+86 Drag Tooth on C. Spk. in brace post 50.25' N.E. Spk. in brace post 43.39' S.W. Spk. in line pole # 90101 - 82.0' N.W.
  - Sta 25+00 Drag Tooth on C. Spk. in line pole # 80903 - 87.0' N.W. R.R. spk. in large oak 42.0' S.W. 28.1' to near edge of fish plate, 5 rail T & W.
  - Sta 44+00 Iron bolt on C. Spk. in line pole # 80709 - 62.0' N.E. Spk. in line pole # 80708 - 60' N.W. 44.25' N. to center of wall pipe.
  - Sta 74+00 Automobile Axle on C. Spk. in line pole # 80502 - 93.5' N.W. 66.8' N. to S.W. cor. of house foundation. Spk. in fence post 82.3' N.E. 38.15' to near edge 3 rail of T & W.
  - Sta 77+50 Drag Tooth on C. Spk. in line pole # 80409 - 86.0' N.W. 65.95' to center N.W. base ball of D.T. & I signal tower. 79.7' to top N.W. cor. foundation under porch on W. side of store bldg.
  - Sta 79+00 Iron Shaft on C. 64.05' S.W. to N.W. cor. of concrete base for filling station. 56.05' S.E. to N.W. cor. foundation of first house E. of store.
  - Sta 91+00 Hub on C. 49.9' N.W. to R.R. spk. in NE cor. of base of switch stand. 51.15' N. to N edge of sign post. 30.55' to center of near rail of T & W.
  - Sta 111+00 Drag Tooth on C. 21.55' N.E. to cross on NW cor. of S hdwl. 24.05' S.E. to cross on SE cor. of S hdwl. 32.20' N. to near rail of T & W.
  - Sta 129+50 Drag Tooth on C. Spk. in Pine Tree 49.00' S.E. Spk. in Large Oak Tree 46.00' S.W. 29.65' to near rail of T & W.
  - Sta 142+00 Drag Tooth on C. Spk. in line pole # 70811 - 66.0' N.E. Spk. in line pole # 70812 - 56.3' N.W. 31.75' to near rail of T & W.
  - Sta 161+00 Iron Pipe on C. 34.8' to near rail of T & W. 34.25' S.W. to U.S.G.S. B.M. Post 46.00' N. to spk. in line pole # 70702.
  - Sta 166+56.65 Hub on C. (P.I. for curve) Spk. in line pole # 70610 - 96.00' N.W. Spk. in line pole # 70609 - 103.00' N.E. Spk. in post fastened to Walnut Tree 66.65' E.
  - Sta 174+73.15 Gas Pipe Section Corner R.R. spk. in line pole # 70510 - 94.5' N.E. R.R. spk. in anch. post 46.0' N.
  - Sta 200+76.8 Gas Pipe Quarter Post R.R. spk. in Elm Tree 48.5' N.E. R.R. spk. in Maple Tree 57.0' S.W.
  - Sta 227+33.2 Gas Pipe Section Corner N end of C.I.P. 28.1' N.W. S end of C.I.P. 26.0' S.W.

