

O.D.O.T. DISTRICT 2 SURVEY OFFICE (USE ONLY)

PERSONNEL _____ REFERENCE NO. 8 AA SHEET 16 OF 50

NOTES RHOADES DATE 4/28/22 ROUTE SR 120
 H.C. O'DONNELL WEATHER SUNNY COUNTY FULTON
 R.C. RHOADES TEMP. 40° TOWNSHIP ROYALTON
 SECTION 8

DWG BY RHOADES PID 99582

T 9 N R 3 E

TYPE MONUMENT MAG NAIL

ON SURFACE - ~~BELOW~~ ON

OFFSET 1.1' RT : ~~LT~~

8.8' TO RT EDGE PAVEMENT

STATION: 253+92

HORZ. DATUM: NAD83 2011

GEOID: NAVD88 2018

GRID: NORTHING: 744437.702

EASTING: 1535570.648

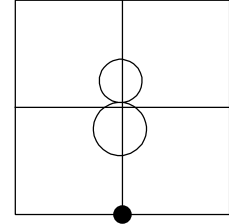

RECORD:
 FD MAG/WASHER
 5/23/11, RJL
 FD MAG NAIL
 REFAA8
 5/7/19, JLL
 4/28/22, JFO
 SET MAG/WASHER
 7/27/22, TDN

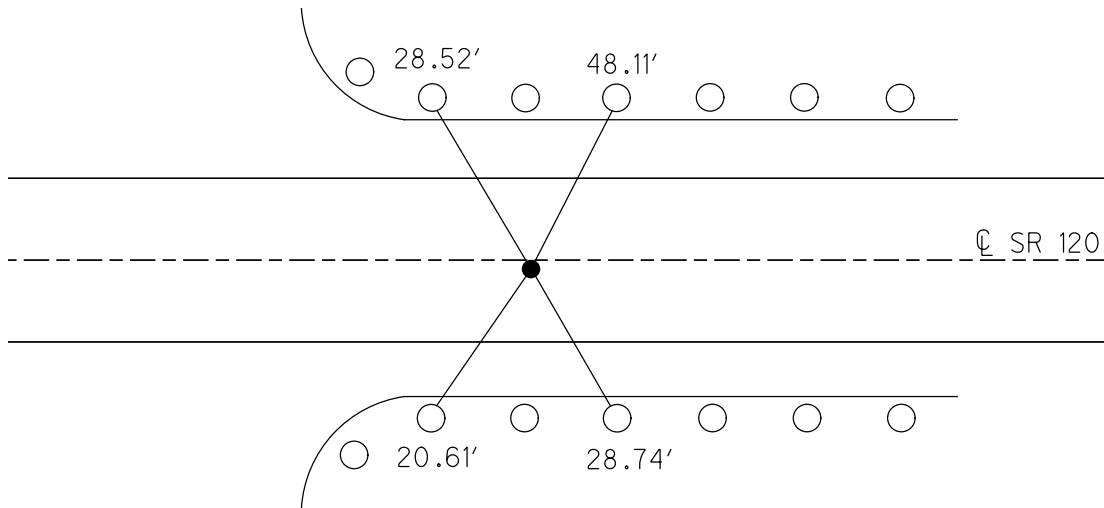

FD SHI'S IN
 G.R. POSTS

O.D.O.T. DISTRICT 2 SURVEY OFFICE

PERSONNEL

REFERENCE NO. 8 AA

SHEET 15 OF 45

NOTES FINGER

DATE 5/23/11

ROUTE SR 120

H.C. LUMBREZER

WEATHER SUNNY

COUNTY FULTON

R.C. MOSER

TEMP. 70°

TOWNSHIP ROYALTON

SECTION 8

T 9 N R 3 E

TYPE MONUMENT MAG NAIL/WASHER

ON SURFACE - ~~BELOW~~ ON

~~LEFT~~ - C PAV'T - RIGHT 1.1'

8.8' TO RT EDGE PAVEMENT

S.L.M. _____

Grid: Northing: 744437.627 Easting: 1535570.617

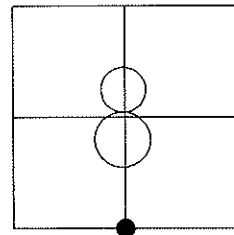

FD MAG/WASHER
GPS 5/23/11, RJL

FD SHI'S IN
G.R.POSTS

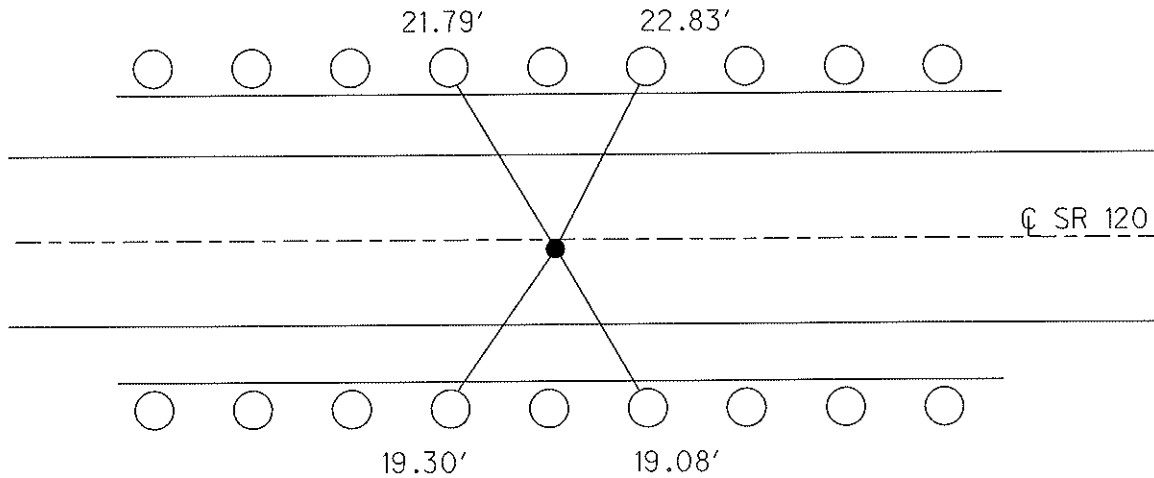

FD SHI'S IN
G.R.POSTS