

O.D.O.T. DISTRICT 2 SURVEY OFFICE (USE ONLY)

PERSONNEL \_\_\_\_\_ REFERENCE NO. 20 SHEET 47 OF 47  
 NOTES RHOADES DATE 6/23/21 ROUTE SR 120  
 H.C. AUBLE WEATHER CLOUDY COUNTY FULTON  
 R.C. NIESH TEMP. 63° TOWNSHIP AMBOY  
 DWG BY RHOADES PID 101213 SECTION 11  
 T 9 N R 4 E

TYPE MONUMENT MONBOX W/ 1" IPIN  
 ON SURFACE - ~~BELOW~~ ON \_\_\_\_\_  
 OFFSET  $\odot$  PAVEMENT 2.6' ~~±~~ : RT  
 - TO - EDGE PAVEMENT  
 STATION: 735+33.37

HORZ. DATUM: NAD83 (2011) GEOID: 2012A  
 GRID: NORTHING: 748569.372 EASTING: 1582478.112

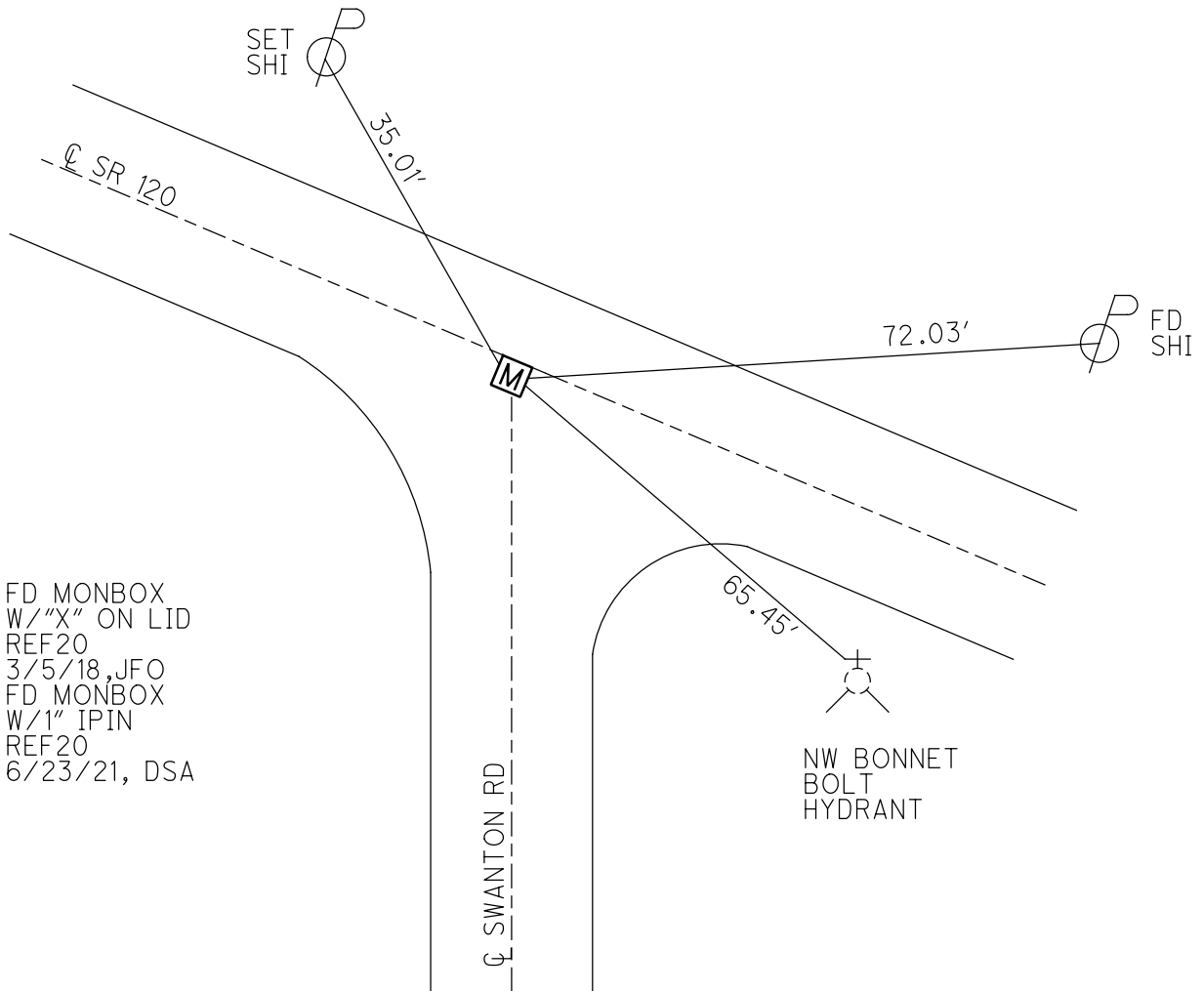
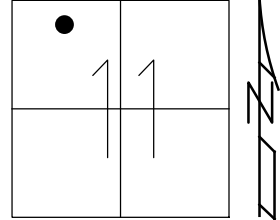

FD MONBOX  
 W/"X" ON LID  
 REF20  
 3/5/18, JFO  
 FD MONBOX  
 W/1" IPIN  
 REF20  
 6/23/21, DSA

O.D.O.T. DISTRICT 2 SURVEY OFFICE (USE ONLY)

PERSONNEL \_\_\_\_\_ REFERENCE NO. 20 SHEET 47 OF 47  
 NOTES ANDERS DATE 5/5/03 ROUTE SR 120  
 H.C. WILLIAMS WEATHER OVERCAST COUNTY FULTON  
 R.C. \_\_\_\_\_ TEMP. 55° TOWNSHIP AMBOY  
 \_\_\_\_\_ SECTION 11  
 \_\_\_\_\_ T 9 N R 4 E

TYPE MONUMENT MON.BOX  
 ON SURFACE - BELOW \_\_\_\_\_  
 LEFT - CL PAV'T - RIGHT \_\_\_\_\_  
 \_\_\_\_\_ TO \_\_\_\_\_ EDGE PAVEMENT  
 S.L.M. 734+76.89  
 GRID: NORTHING: \_\_\_\_\_ EASTING: \_\_\_\_\_

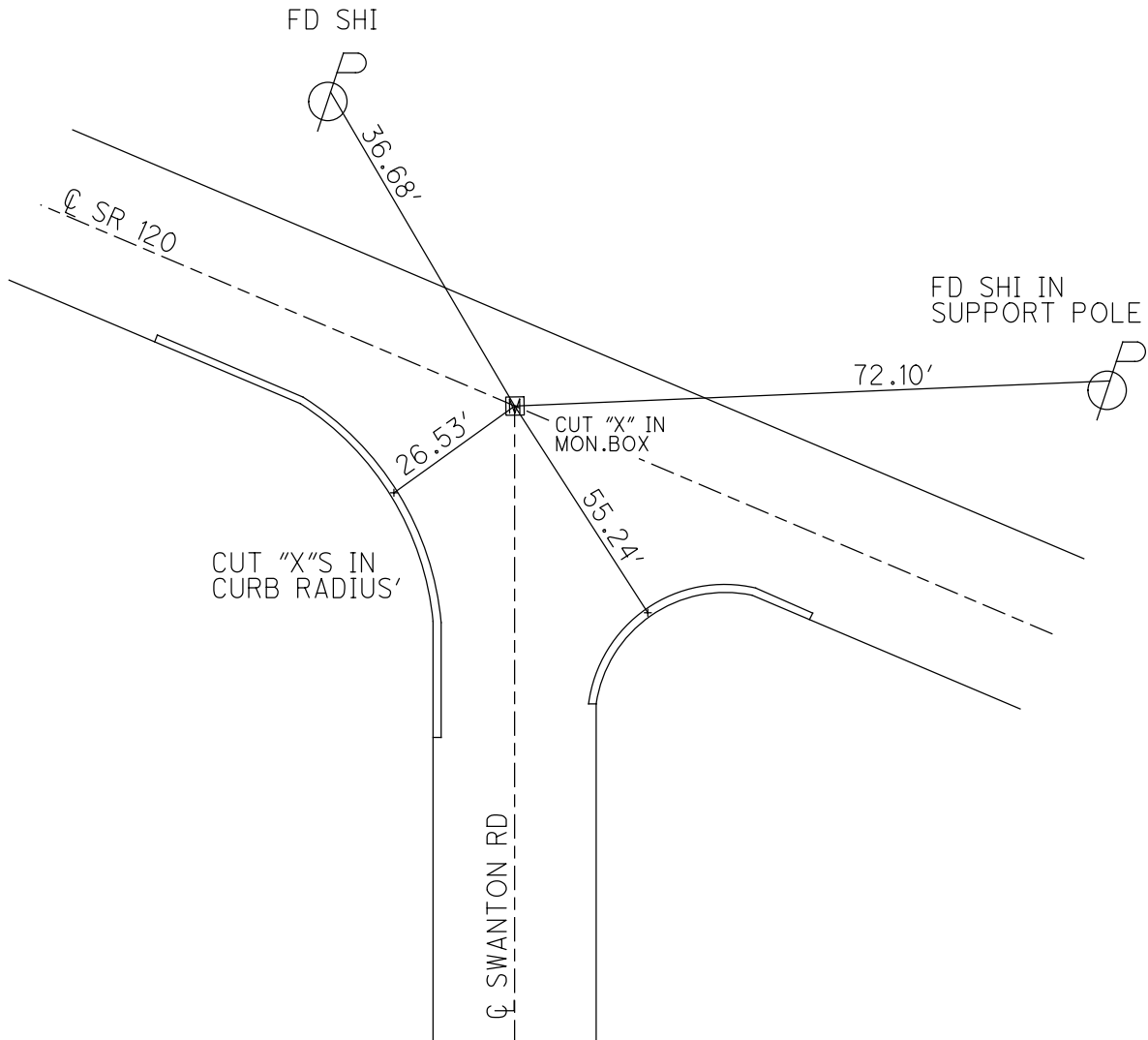
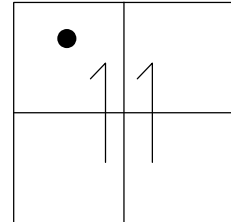

PERSONNEL	TITLE	PERSONNEL	TITLE	COUNTY	FUL	DATE	5-5-03
ANDERS				S.R.	120	WEATHER	OVERCAST/DK
WILLIAMS				SEC.		TEMP	55°
DESCRIPTION	CONTROL REFERENCES			19 + 20		JOB NO.	

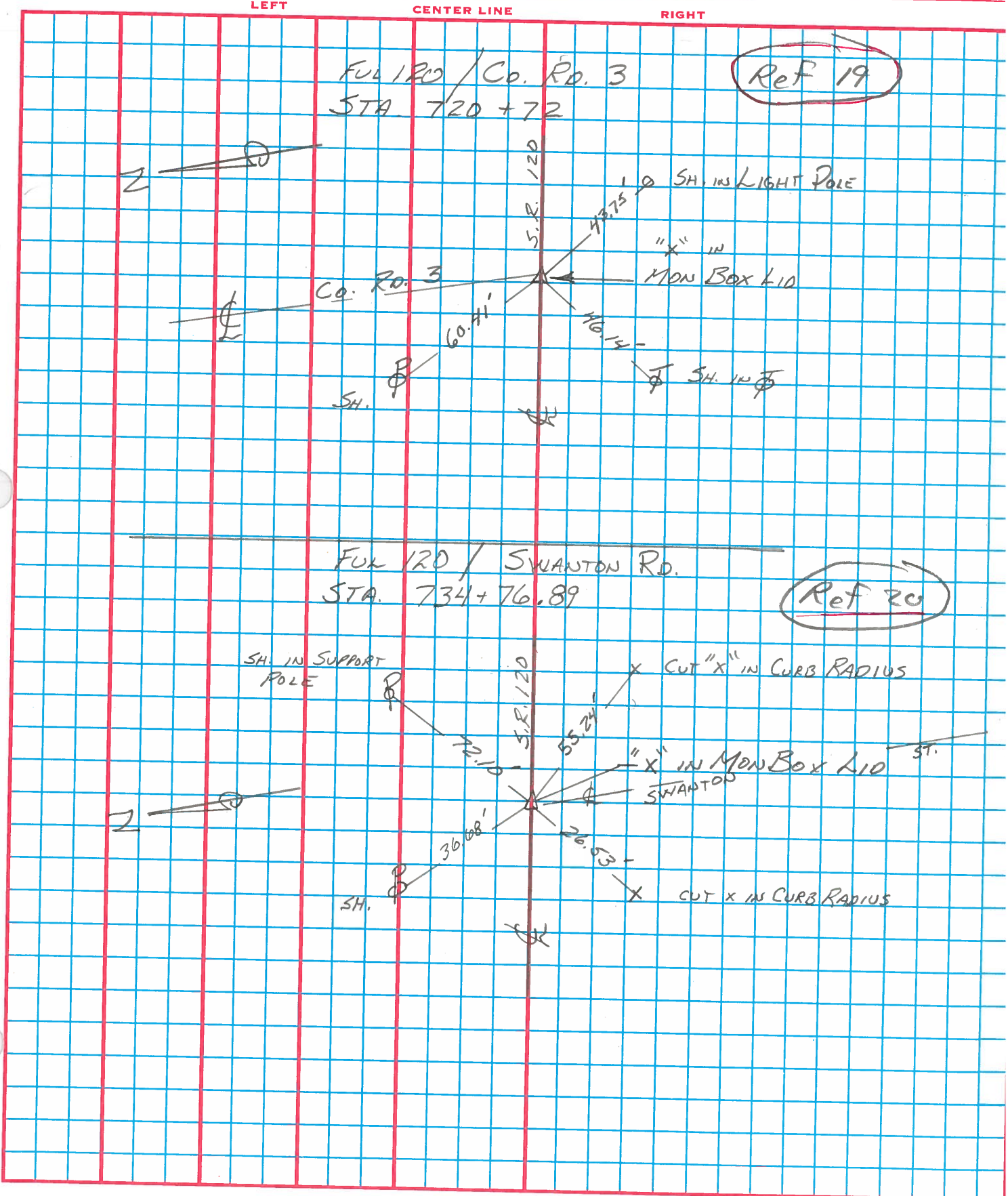

PERSONNEL	TITLE	PERSONNEL	TITLE
Tomsic			
Granata			
Vanyo			
Boyle			

COUNTY Fulton DATE July 12, 1973

S. R. 120 WEATHER \_\_\_\_\_

SEC. \_\_\_\_\_ TEMP. \_\_\_\_\_

DESCRIPTION \_\_\_\_\_ LEFT \_\_\_\_\_ CENTER LINE \_\_\_\_\_ RIGHT \_\_\_\_\_ JOB NO. \_\_\_\_\_

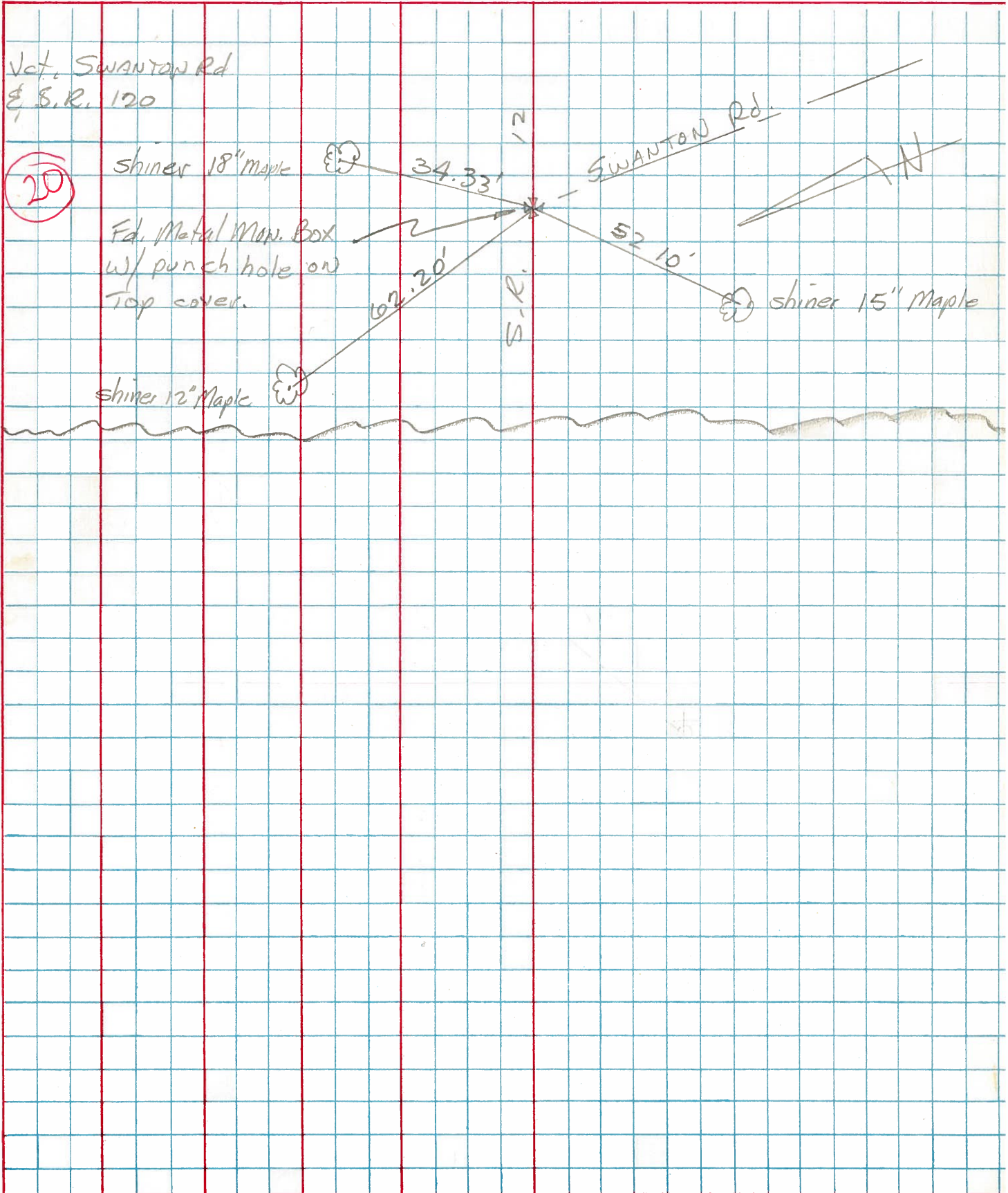



PERSONNEL	TITLE	PERSONNEL	TITLE
W. Denno			
D. Curtis			
J. Teal			

COUNTY Fulton DATE April 9, 1970

S. R. 120 WEATHER sunny - mild

SEC. \_\_\_\_\_ TEMP. 50° ±

DESCRIPTION New References To Control Points (In Metamora) JOB NO. 02816 (0)

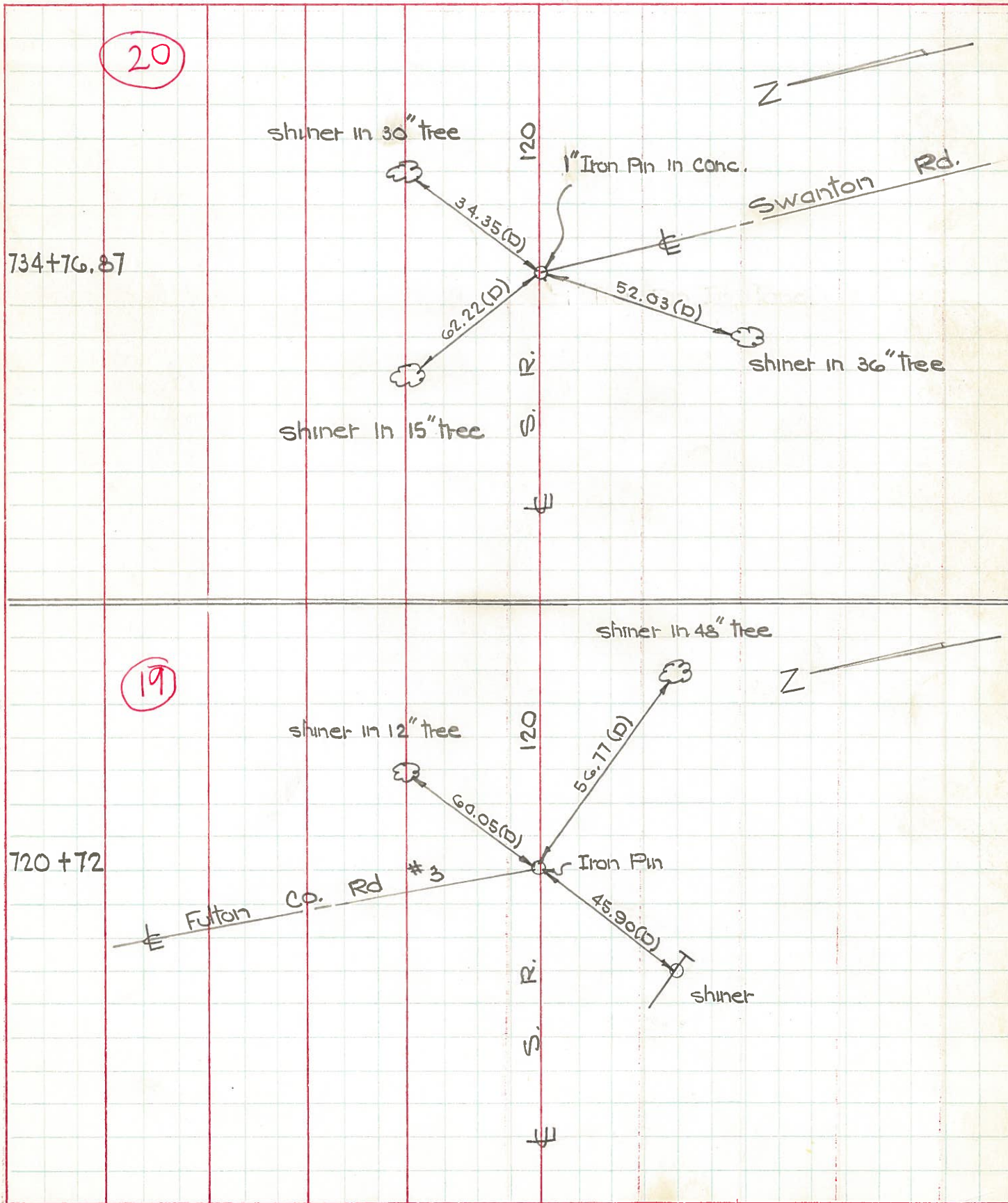



PERSONNEL	TITLE	PERSONNEL	TITLE	COUNTY	DATE	WEATHER	TEMP.
w Denno				Fulton	Aug. 26, 1968	cool	68°f
D. Curtis				S. R. 120			
J. Brindley				SEC.			
A. Vanel							

DESCRIPTION Alignment - S.R. 120 in Metamora JOB NO. 02816(0)

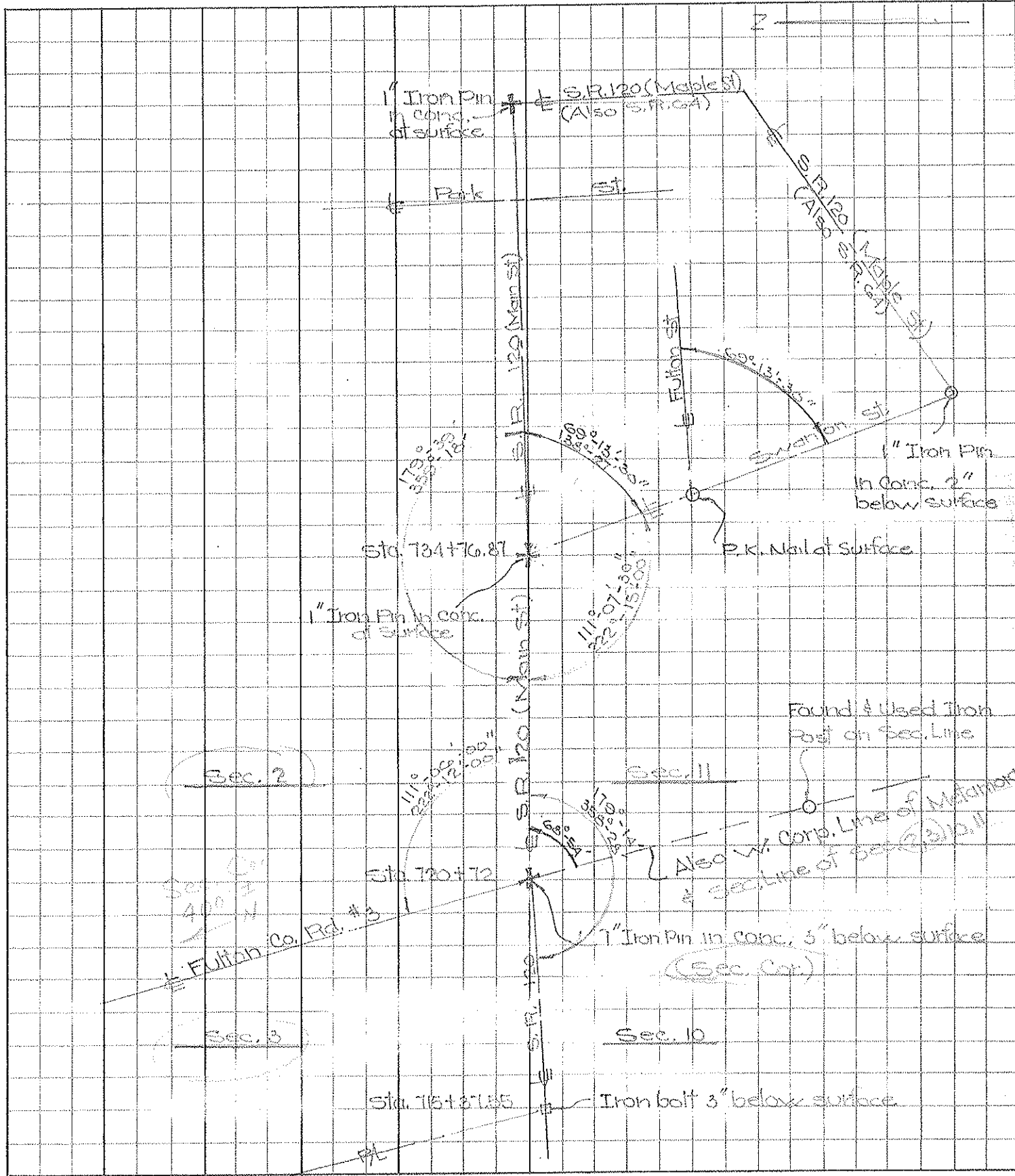

# COMPUTATION SHEET

STATE OF OHIO - DEPARTMENT OF HIGHWAYS - BUREAU OF LOCATION AND DESIGN \_\_\_\_\_ COLUMBUS, OHIO  
BY Denno - Granata - Curtis - Omev DATE June 7, 1968 NO. \_\_\_\_\_ OF \_\_\_\_\_ SHEETS  
COUNTY Fulton SECTION \_\_\_\_\_  
DIV. NO. 2 S.R. 120 U.S.R. \_\_\_\_\_ I. R. \_\_\_\_\_  
SUBJECT OF THIS SHEET Ref Monument Medamora

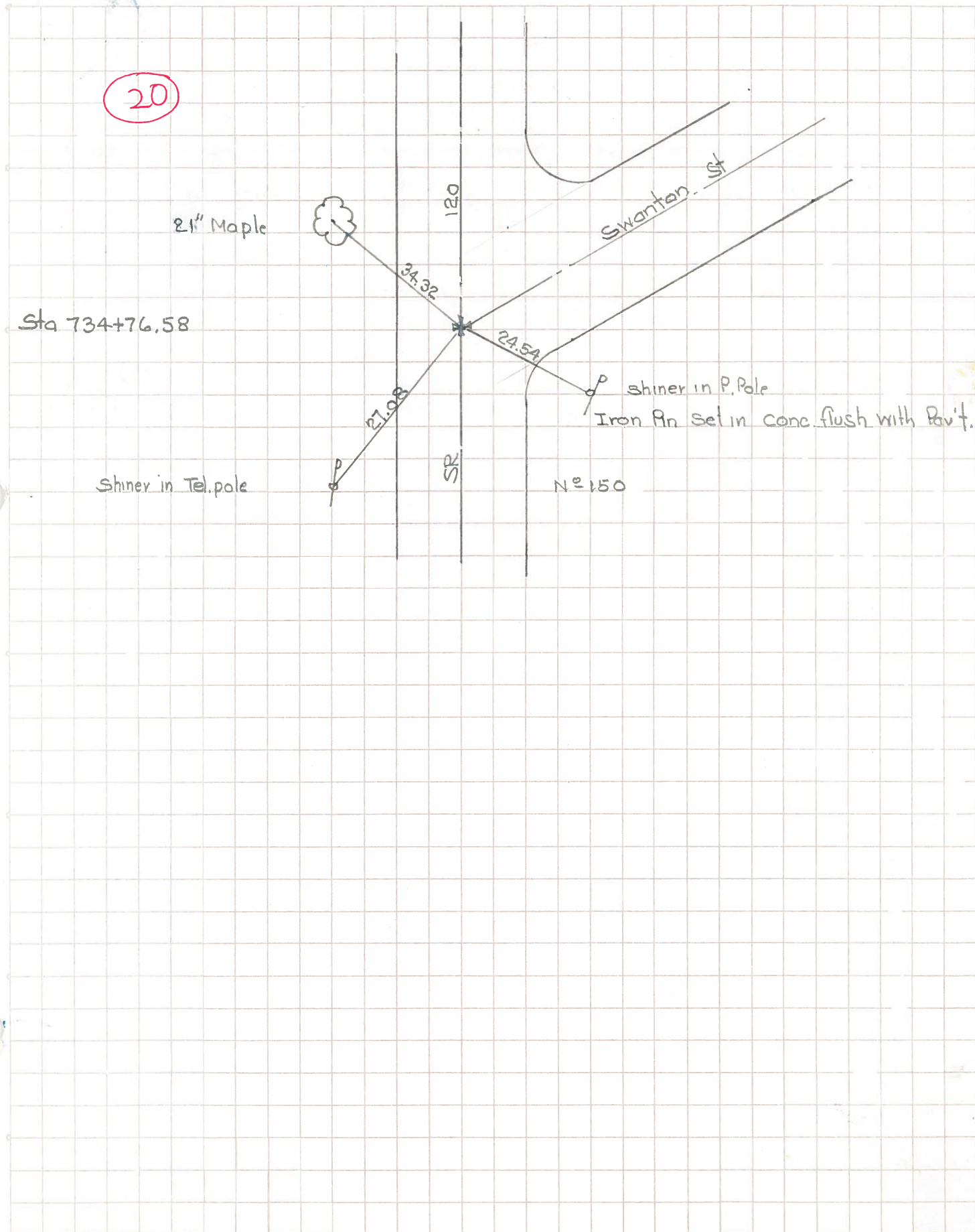



PERSONNEL	TITLE	PERSONNEL	TITLE	COUNTY	Fulton	DATE	Sept. 25, 196
W. Dennis		J. Teal		S. R.	120	WEATHER	mild
D. Curtis				SEC.		TEMP.	70° ±
D. Francis							
I. Brindley							

DESCRIPTION References To Control Points JOB NO. 02816 (a)

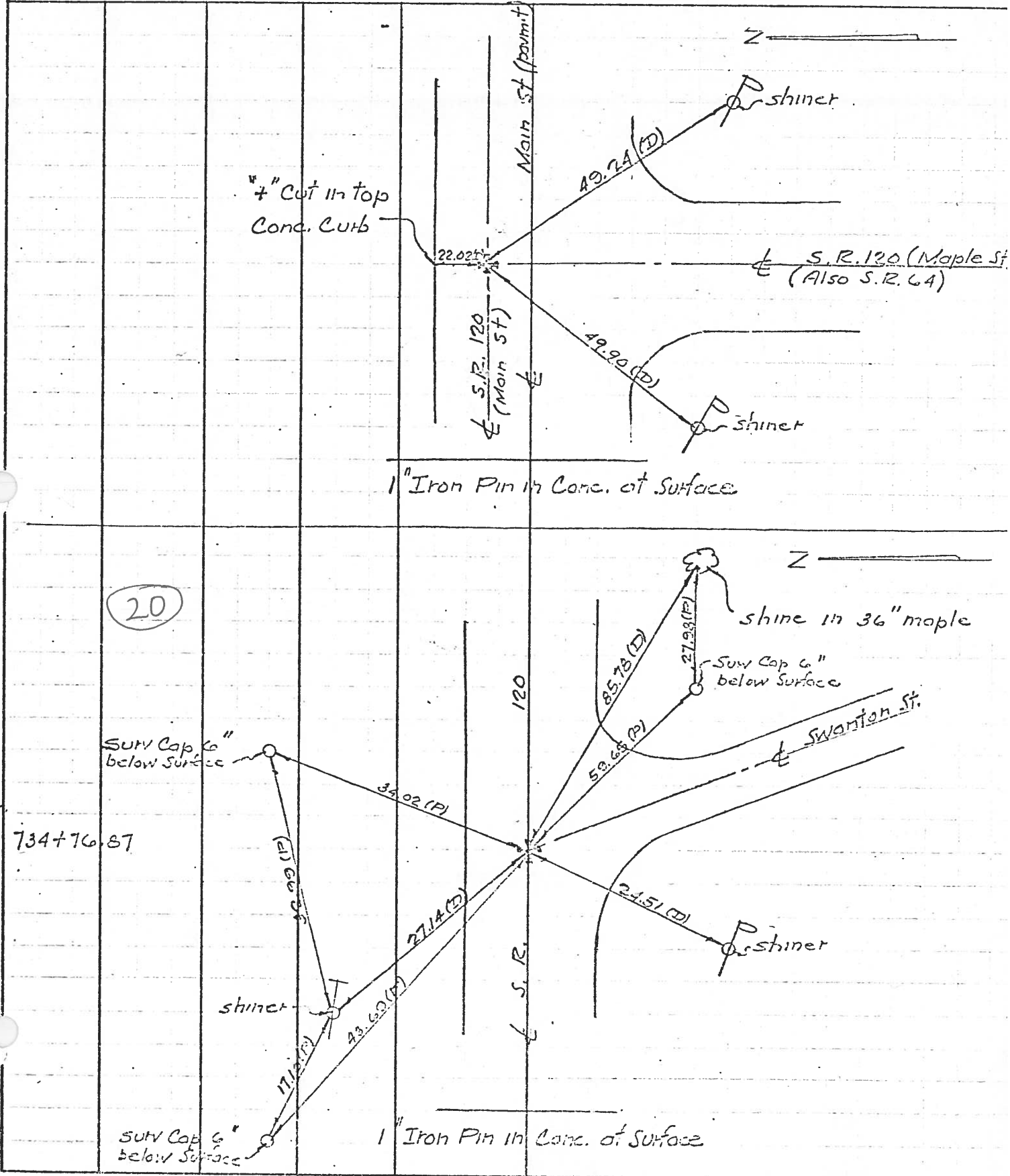



PERSONNEL	TITLE	PERSONNEL	TITLE	COUNTY	DATE
Kujawa				Fulton	12/15/52
Bock				S. R.	120
Carpenter				WEATHER	Snow
				SEC.	TEMP. 30
DESCRIPTION	Metamora			JOB NO.	02119
	LEFT	CENTER LINE	RIGHT		

