

N.R.M. 587-B

FED. AID DIST. NO.	STATE	FED. AID PROJ. NO.	FISCAL YEAR
10	OHIO	587-B	1933



S.H. 225 HENRY SEC. "DESHLER" COUNTY

STATE OF OHIO
DEPARTMENT OF HIGHWAYS
DESHLER-FINDLAY ROAD
HENRY COUNTY
S.H. NO. 225 SEC. "DESHLER"
BUREAU OF CONSTRUCTION
NET LENGTH OF PROJECT 2381.0 LIN. FT.

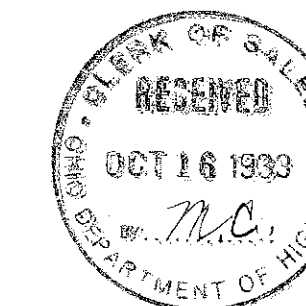

The Standard Specifications of the State of Ohio, Department of Highways together with the Supplemental Specifications for National Recovery Municipal Funds Projects in force on date of contract will govern this Improvement.

I hereby approve these plans and declare that the making of this improvement will require the closing of the highway to traffic and that a temporary road will be provided as shown on the plans and estimates.

Right-of-way for this Improvement has been provided.

Approved Best Beucher
Date 9-22-1933 Resident District Deputy Director.

Approved R.J. Nardo
Date 9-25-33 Resident Division Deputy Director.

Approved Elmer Healy
Date 10-10-33 Chief Engr. Bureau of Construction.

Approved _____
Date _____ Chief Engr. Bureau of Maintenance.

Approved _____
Date _____ Chief Engr. Bureau of Bridges.

Approved H.R. Chapman
Date 10-13-33 First Ass't Director and Chief Engr.

Approved W.D. Purdy
Date 10-13-33 Director of Highways.

Recommended for Approval _____
Date _____ Dist. Engr. Bureau of Public Roads.

Recommended for Approval _____
Date _____ Chief Engr. Bureau of Public Roads.

Approved _____
Date _____ Chief of Bureau.

CONVENTIONAL SIGNS

State Line	-----
County Line	-----
Township Line	-----
Section Line	-----
Center Line	-----
Property Line	-----
City or Village Line	-----
Fence Line	-----
Pole Line	⊙ ⊙ ⊙ ⊙ ⊙ ⊙ ⊙ ⊙ ⊙ ⊙
Steam Railroad	-----
Electric Railroad	-----
Guard Rail	-----
Drain Pipe New	-----
Drain Pipe Old	-----

INDEX OF SHEETS

Title Page	Page 1
Typical Section	2
Plan and Profile	3-4
Cross-sections	5-6
Intersection Details and Notes	7
Summary of Quantities	8

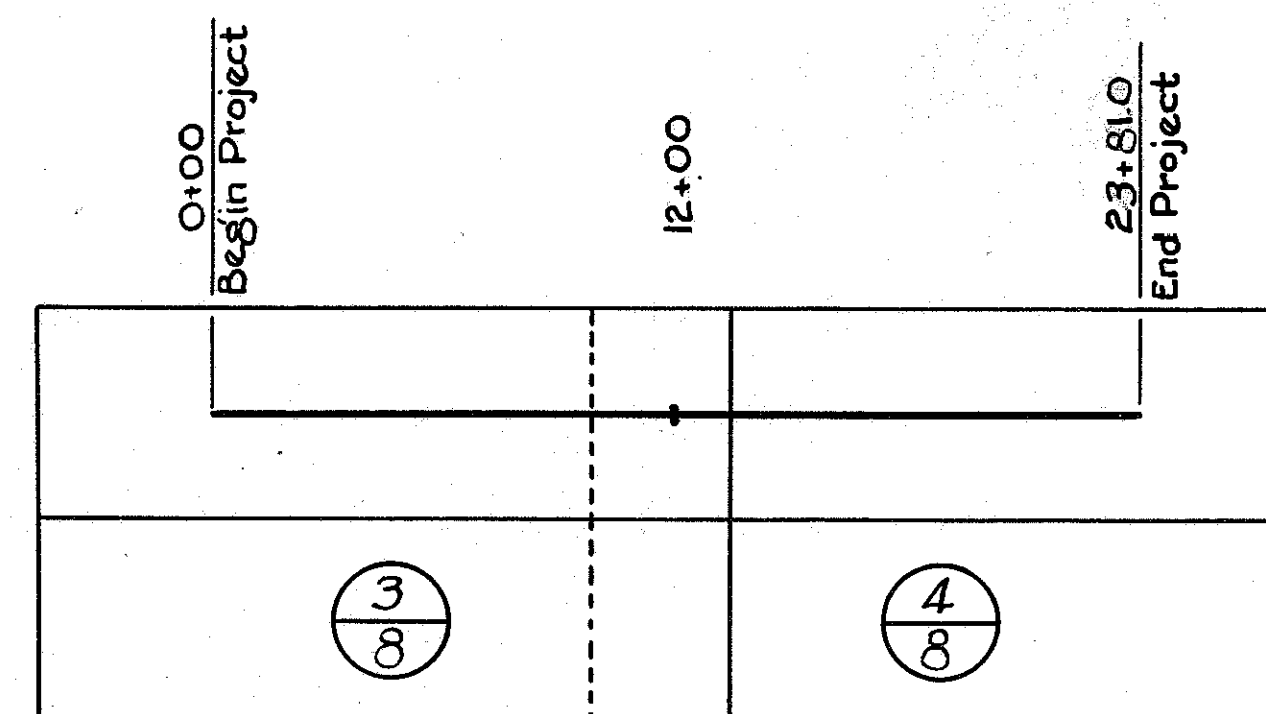

ROAD INDEX BY SHEETS
Right of way is 66'
Scale 1" = 500'

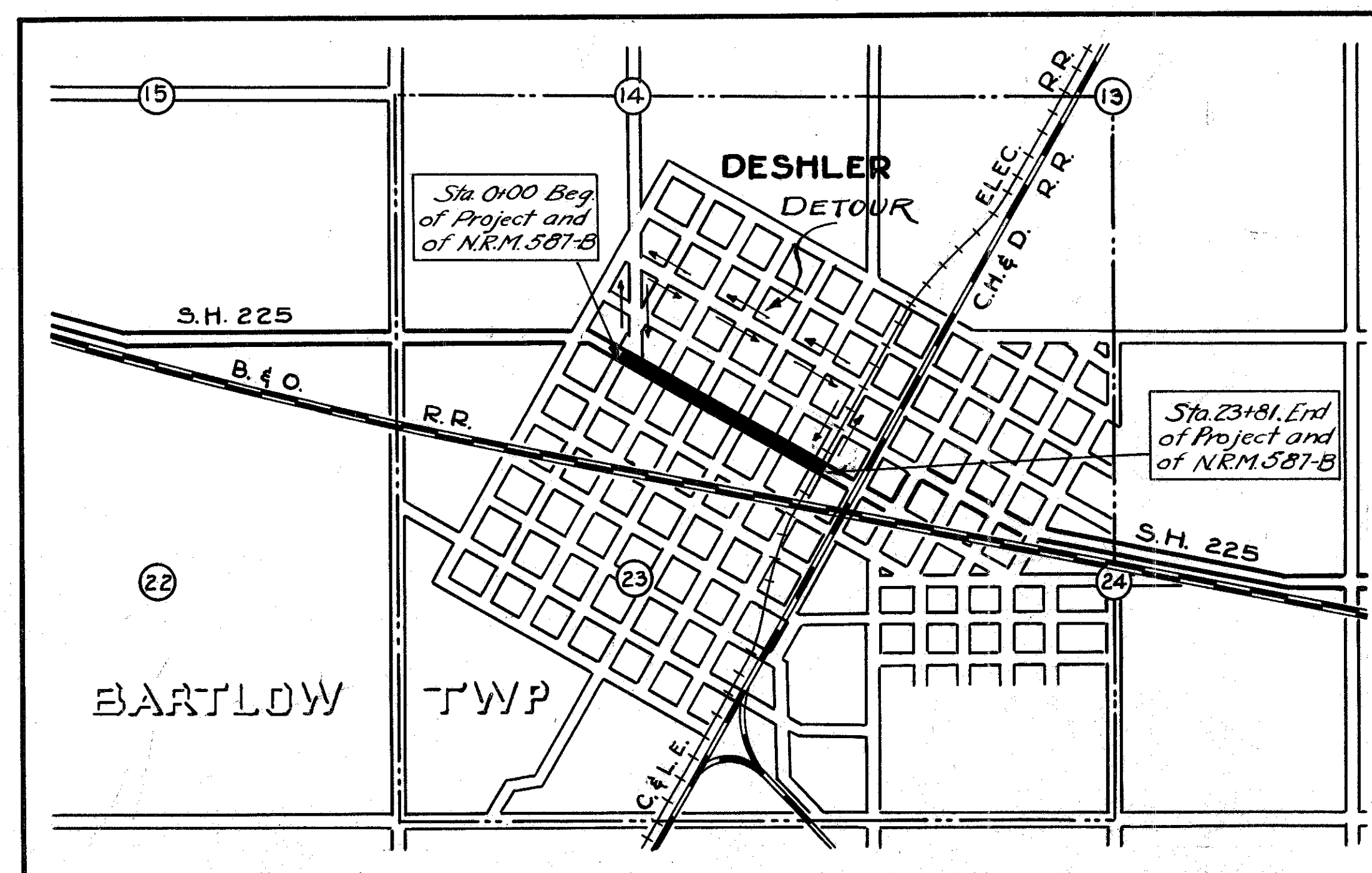

LOCATION PLAN

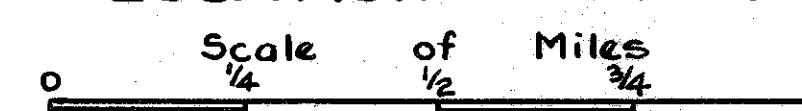

Portion to be improved
Detours shown thus
State roads
Other roads

SCALES

Plan	1" = 50'
Profile (Vertical)	1" = 10'
Profile (Horizontal)	1" = 50'
Cross-sections (Vert)	1" = 5'
Cross-sections (Horizontal)	1" = 5'

Supplemental Prints of Standard Drawings
No. B-T-50-60, T-70-J, I-12 C.C., III

APPROVED

E.C. Mowbray 9/27/33
Planning Engineer Date

Remarks: For Resurf. old 24"
Reick built with T-61 & Cons. Width
to 32 feet.

CHECKING RECORD		
Office	By	Date
Resident	W.S.T.	
Division	R.E.T.	
Central Const.	M.G.H.	10/5/33
Central Bridges		
Bureau of Public Roads		

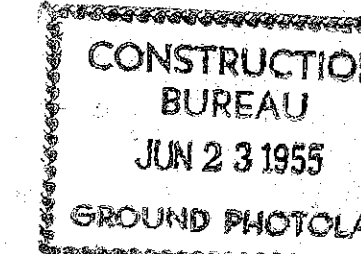

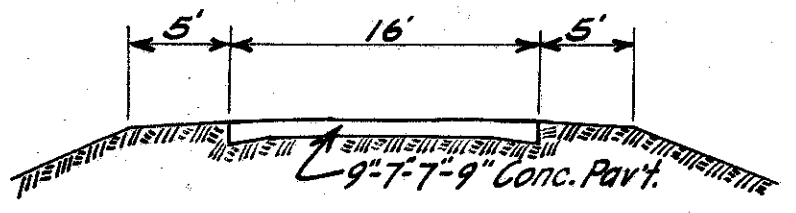

Typical Section of adjoining pavement at sta. 0-(+00) Pavement widens to 26 ft. width at sta. 0+00

Ref. No.	Station From	Station To	Tar. Conc. Binder Cu. Yds.	Concrete Pavement Cu. Yds.	Remarks
1-P	0-(30)	0+00		3.75	
2-P	0+00	0+10	3.7		
3-P	1+98.5	2+21.5		3.80	
4-P	4+35	4+72		10.10	
5-P	6+85	7+08		3.80	
6-P	9+21	9+58		10.10	
7-P	11+70.5	11+93.5		1.40	
8-P	11+70.5	11+93.5		1.90	
TOTALS			3.7	34.85	

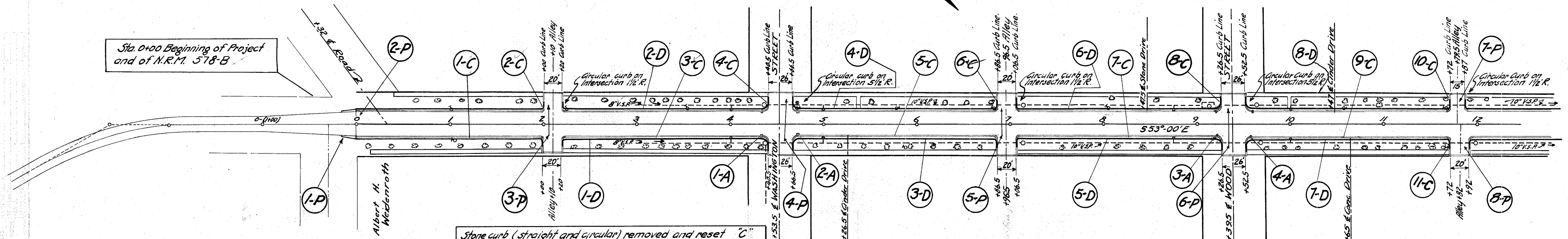

Ref. No.	Station From	Station To	Rt. or Lt.	4' Curb Drains Lin. Ft.	Curb Inlet Catch Basins Number	Remarks
1-D	2+21	4+35	Rt.	211	1	Build C.B. Sta. 4+00
2-D	2+21	4+35	Lt.	211	1	Build C.B. Sta. 4+00
3-D	4+72	6+85	Rt.	210	1	Build C.B. Sta. 5+00
4-D	4+72	6+85	Lt.	210	1	Build C.B. Sta. 5+00
5-D	7+08	9+21	Rt.	210	1	Build C.B. Sta. 8+75
6-D	7+08	9+21	Lt.	210	1	Build C.B. Sta. 8+75
7-D	9+57	11+70	Rt.	210	1	Build C.B. Sta. 10+00
8-D	9+57	11+70	Lt.	210	1	Build C.B. Sta. 10+00
TOTALS				1682	8	

Ref. No.	Station From	Station To	Lin. Ft. (Both Sides)	Remarks
1-C	0+00	1+98.5	397.0	
2-C	1+98.5	2+21.5	29.4	See intersection detail, sheet
3-C	2+21.5	4+35	427.0	
4-C	4+35	4+72	54.5	See intersection detail, sheet
5-C	4+72	6+85	426.0	
6-C	6+85	7+08	29.4	See intersection detail, sheet
7-C	7+08	9+21	426.0	
8-C	9+21	9+58	54.5	See intersection detail, sheet
9-C	9+58	11+70.5	425.0	
10-C	11+70.5	11+93.5	4.7	See intersection detail, sheet
11-C	11+70.5	11+93.5	4.7	See intersection detail, sheet
TOTALS			2298.2	

Ref. No.	Station From	Station To	Width Lin. Ft.	Area Sq. Yds.	Remarks
1-B	0+00	0+10	26	28.9	
2-B	0+10	12+00	6	793.3	3' width on each side.
3-B	1+98.5	2+21.5		35.8	See intersection detail, sheet
4-B	4+35	4+72		78.0	See intersection detail, sheet
5-B	6+85	7+08		35.8	See intersection detail, sheet
6-B	9+21	9+58		78.0	See intersection detail, sheet
7-B	11+70.5	11+93.5		13.4	See intersection detail, sheet
8-B	11+70.5	11+93.5		17.9	
TOTALS				1081.1	

Ref. No.	Station	Location	Number
1-A	4+34	Rt. & Lt.	2
2-A	4+73	Rt. & Lt.	2
3-A	9+19	Rt. & Lt.	2
4-A	9+59	Rt. & Lt.	2
TOTALS			8

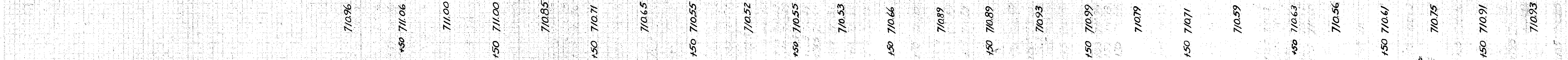

Sta. 0+00 Beginning of Project and of N.R.M. 578-B

Sta. 3+00 to sta. 6+00
8" V.S.P. Drains in place on Rt. & Lt. No work required.

Sta. 6+00 to sta. 12+00
10" V.S.P. Drains in place on Rt. & Lt. No work required.

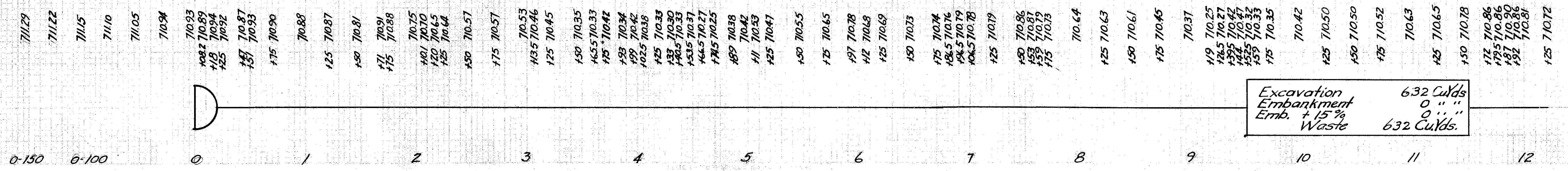

Extra Pavement "P"

Ref. No.	Station From	Station To	Tar. Conc. Binder Cu. Yds.	Concrete Pavement Cu. Yds.	Remarks
1-P	14+06.5	14+44.5		10.5	
2-P	16+56.5	16+79.5		3.8	
3-P	18+09.5	18+95		.25	
TOTALS					14.55
4-P	18+95	19+28.5		11.7	
5-P	21+42.5	21+65.5		3.8	
6-P	23+71	23+81	3.7	.57	
TOTALS					3.7

FED. AID DIST. NO.	STATE	FED. AID PROJ. NO.	FISCAL YEAR
10	OHIO	587-B	1933

S. H. NO. 225 HENRY SEC. "DESHLER" COUNTY

4/8

Existing Catch Basins Filled as per Plan "A"

Ref. No.	Station	Location	Number
1-A	14+05	Rt. & Lt.	2
2-A	14+46	Rt. & Lt.	2
3-A	18+88	Rt. & Lt.	2
TOTAL			6

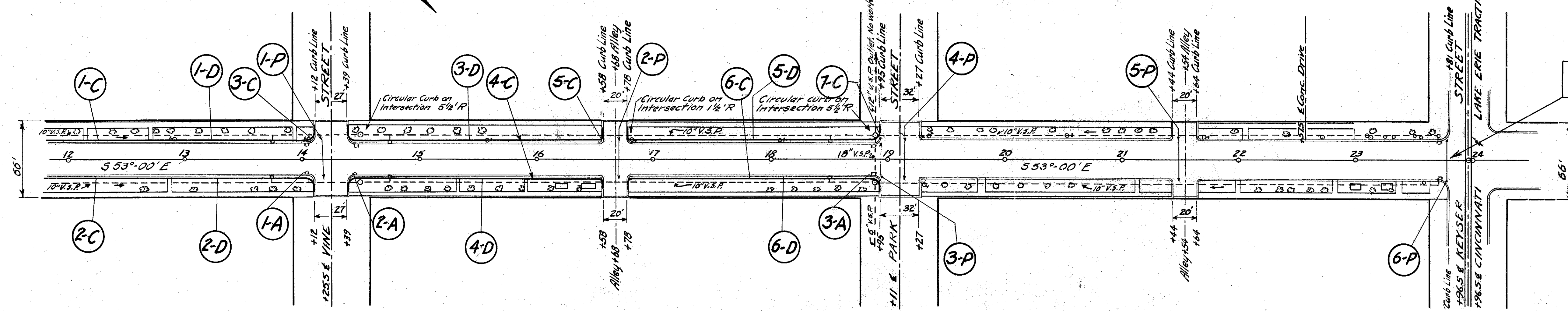

Pipe Underdrains (Curb Drains) and Catch Basins "D"

Ref. No.	Station From	Station To	Rt. or Lt.	4" Curb Drains Lin. Ft.	Curb Inlet Catch Basins Number	Remarks
1-D	11+89	14+07	Lt.	215	1	Build C.B. Sta. 13+75
2-D	11+94	14+07	Rt.	210	1	Build C.B. Sta. 13+75
3-D	14+44	16+56	Lt.	209	1	Build C.B. Sta. 14+75
4-D	14+44	16+56	Rt.	209	1	Build C.B. Sta. 14+75
5-D	16+80	18+90	Lt.	207	1	Build C.B. Sta. 18+50
6-D	16+80	18+90	Rt.	207	1	Build C.B. Sta. 18+50
TOTAL						1257

Stone Curb (straight and circular) removed and reset "C"

Ref. No.	Station From	Station To	Lin. Ft. (Both Sides)	Remarks
1-C	11+88.5	14+06.5	218.0	Curb on left side
2-C	11+88.5	14+06.5	213.0	Curb on right side
3-C	14+06.5	14+44.5	38.0	See intersection detail, sheet
4-C	14+44.5	16+56.5	424.0	
5-C	16+56.5	16+79.5	23.0	See intersection detail, sheet
6-C	16+79.5	18+89.5	420.0	
7-C	18+89.5	18+95.0	27.25	See intersection detail, sheet
TOTAL				1386.15

Removal of Brick Wearing Surface

Ref. No.	Station From	Station To	Width Lin. Ft.	Area Sq. Yds.	Remarks
	12+00	18+95	6.0	463.3	3' Width on each side
	14+06.5	14+44.5		80.9	See intersection detail, sheet
	16+56.5	16+79.5		38.8	See intersection detail, sheet
	18+89.5	18+95.0		1.5	See intersection detail, sheet
TOTALS					584.5
	18+95	23+71	12.0	634.6	6' width on each side.
	18+95	19+28.5		71.2	See intersection detail, sheet
	21+42.5	21+65.5		22.4	See intersection detail, sheet
	23+71	23+81		38.9	See intersection detail, sheet
TOTAL					1871.7

