

# O.D.O.T. DISTRICT 2 SURVEY OFFICE

PERSONNEL

REFERENCE NO. 41-A

SHEET 5 OF 14

NOTES CANTERBURY

H.C. BARNHISEL

R.C. MOSEK

DATE 8/8/01

WEATHER SUN

TEMP. +80°

ROUTE 18

COUNTY HENRY

TOWNSHIP BARTLOW

SECTION 23

T 3 N R 8 E

TYPE MONUMENT P.K. + WASHER

ON SURFACE - ~~BELOW~~ SURFACE

LEFT-~~☉~~ PAV'T. - ~~RIGHT~~ 1.0' LT. ☉

24.0' TO LT. EDGE PAVEMENT

S.L.M. 1025 + 43

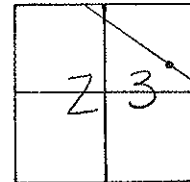

RESET PK/WASHER  
 11-27-01  
 MRC

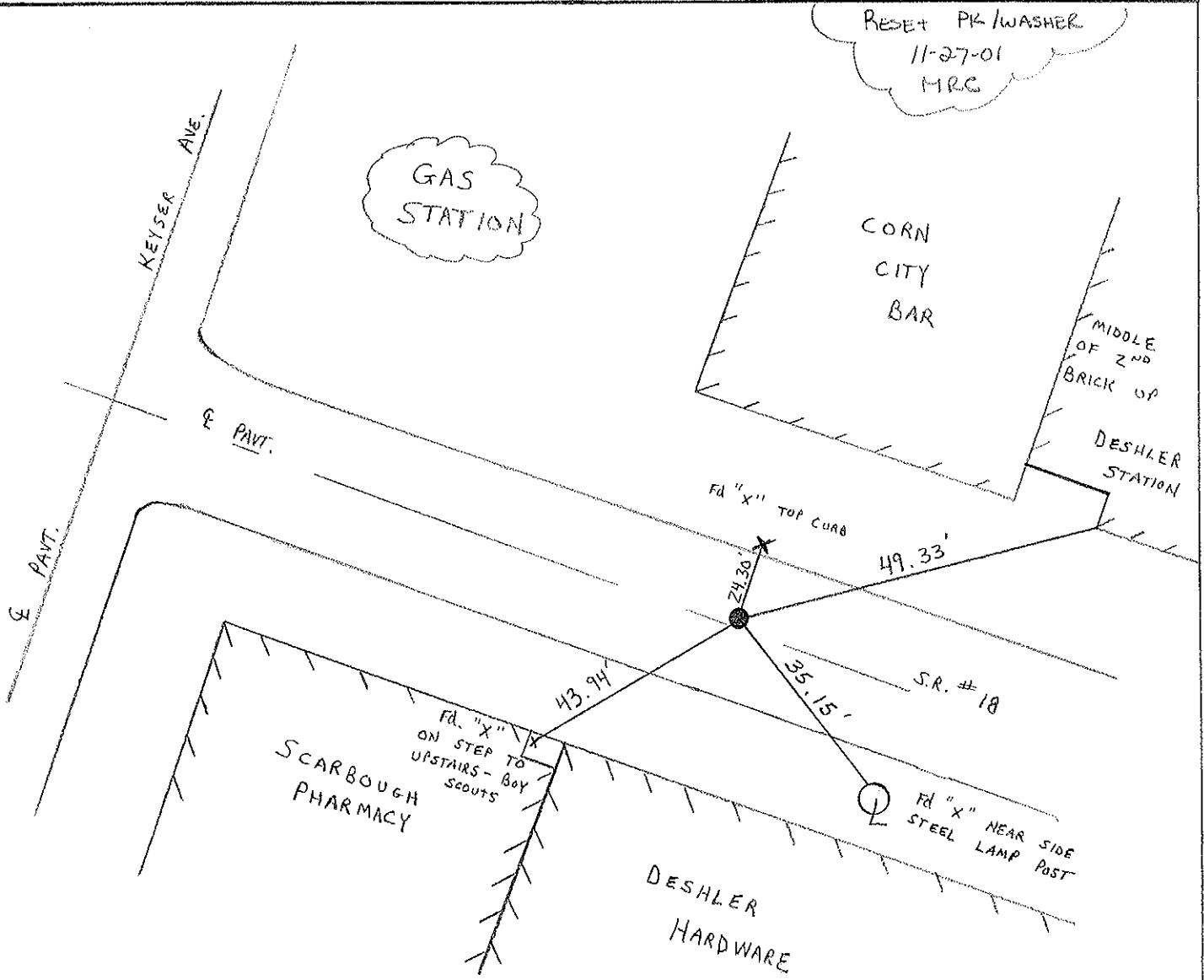

# O.D.O.T. DISTRICT 2 SURVEY OFFICE

PERSONNEL \_\_\_\_\_

REFERENCE NO. 41-A

SHEET \_\_\_\_\_ OF \_\_\_\_\_

NOTES BARNHISEL

H.C. " "

DATE 10-19-90

ROUTE 18

R.C. HOFFMAN

WEATHER cloudy

COUNTY HENRY

\_\_\_\_\_

TEMP. +43°

TOWNSHIP BARTLOW

\_\_\_\_\_

SECTION 23

T 3 N R 8 E

TYPE MONUMENT P.K. / Washer

ON SURFACE - BELOW yes

LEFT- & PAV'T. - RIGHT 10

24.0 TO LT EDGE PAVEMENT

S.L.M. 1025+43

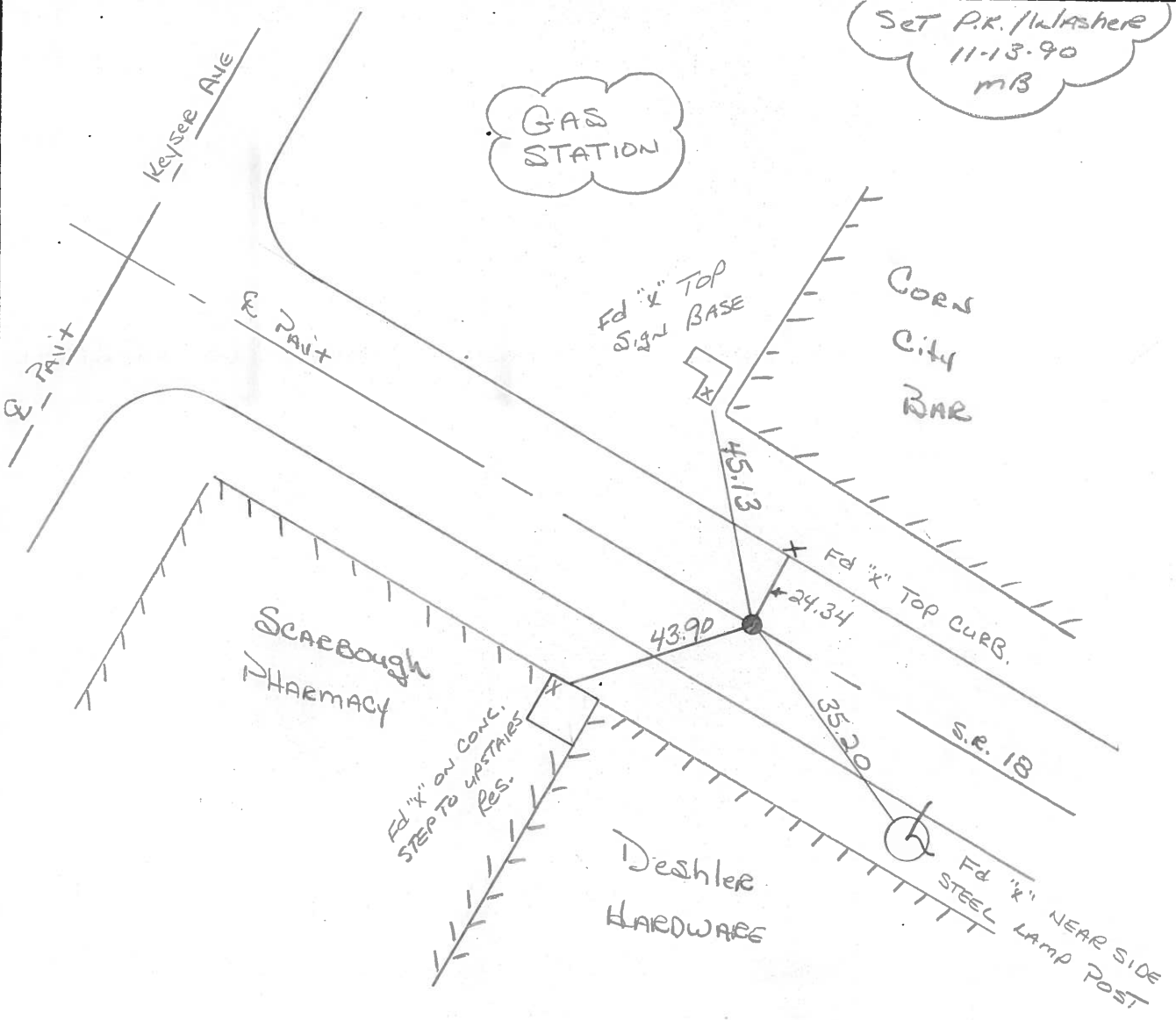
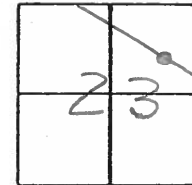

County HENRY S.R. 18

Date April 7, 83

Township BARTLOW

Weather OVERCAST

Section 23

Temp. + 45°

T3N, R8E

Personnel HOFFMAN

LOEHRKE

HOUSEHOLDER

BARNHISEL

#41-A

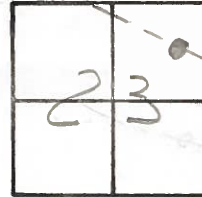

Fd P.K. @ SURFACE

SLM 1025+43

1.0' Lt of & STRIPS

Record:  
 Fd STONE 7" deep  
 5-17-73  
 ±1025+48.65

SET P.K./WASHER  
 9-20-83 C.L.

