

PERSONNEL	TITLE	PERSONNEL	TITLE	COUNTY	DATE
Tomsic				HEN.	DEC. 3, 1975
Neuser				U.S. 24	WEATHER Clear
Granata				S. R.	TEMP. 35°
Knape				SEC.	

DESCRIPTION LEFT CENTER LINE RIGHT JOB NO.

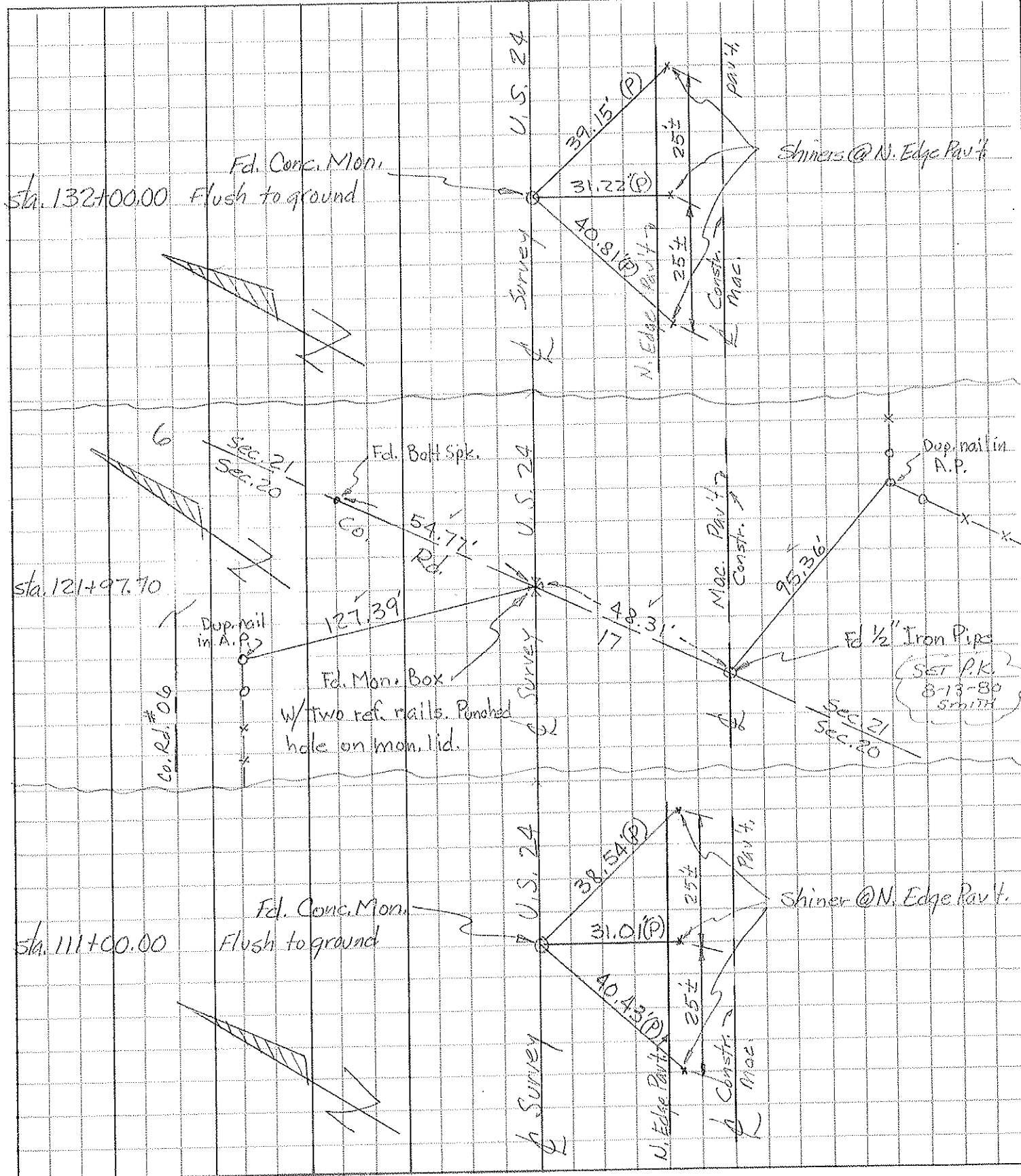

# O.D.O.T. DISTRICT 2 SURVEY OFFICE

PERSONNEL

REFERENCE NO. 6

SHEET 3 OF 4

NOTES Barnhisel

H.C. Homan

R.C. Beaumont

DATE 9-13-02

WEATHER Sunny

TEMP. +65°

ROUTE U.S. 24

COUNTY Henry

TOWNSHIP Napolean

SECTION 20+21

T 5 N R 6 E

TYPE MONUMENT  
 ON SURFACE - BELOW  
 LEFT - & Pav't. - RIGHT  
 TO RT EDGE PAVEMENT

"A"	"B"	"C"
J. Pin in mon box	P.K.	Bolt 3pk
surface	2" down	1" down
1' RT	on &	1' RT
10.2'	—	9.0'

S.L.M. mon. box 121+67

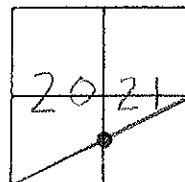

Record = mon box sta: 121+97.70  
 on & survey of U.S. 24

Reset PK/washer  
 11-13-02  
 MB

Note: everything  
 plumbed @ Box

set Shi 1' in from Ed. Pav't  
 (both Shi's)

