

O.D.O.T. DISTRICT 2 SURVEY OFFICE (USE ONLY)

PERSONNEL

REFERENCE NO. 12

SHEET 31 OF 33

NOTES TOMSIK

DATE 12/10/75

ROUTE US 24

H.C. NEUSER

WEATHER CLEAR

COUNTY HENRY

R.C. GRANATA

TEMP. 38°

TOWNSHIP NAPOLEON

DWG BY NIESE PID \_\_\_\_\_

SECTION 15

T 5 N R 6 E

TYPE MONUMENT CMON

ON SURFACE - ~~BELOW~~ ON

OFFSET ☉ PAVEMENT ON LT : RT

- TO - EDGE PAVEMENT

STATION: 252+50.10

HORZ.DATUM: \_\_\_\_\_ GEOID: \_\_\_\_\_

GRID: NORTHING: \_\_\_\_\_ EASTING: \_\_\_\_\_

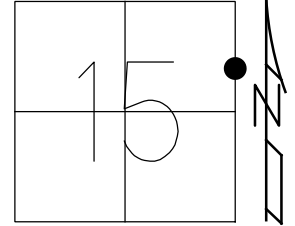

RECORD:  
FD CMON  
12/10/75, TOMSIK

NOTE:  
US 6 STA 583+26.20

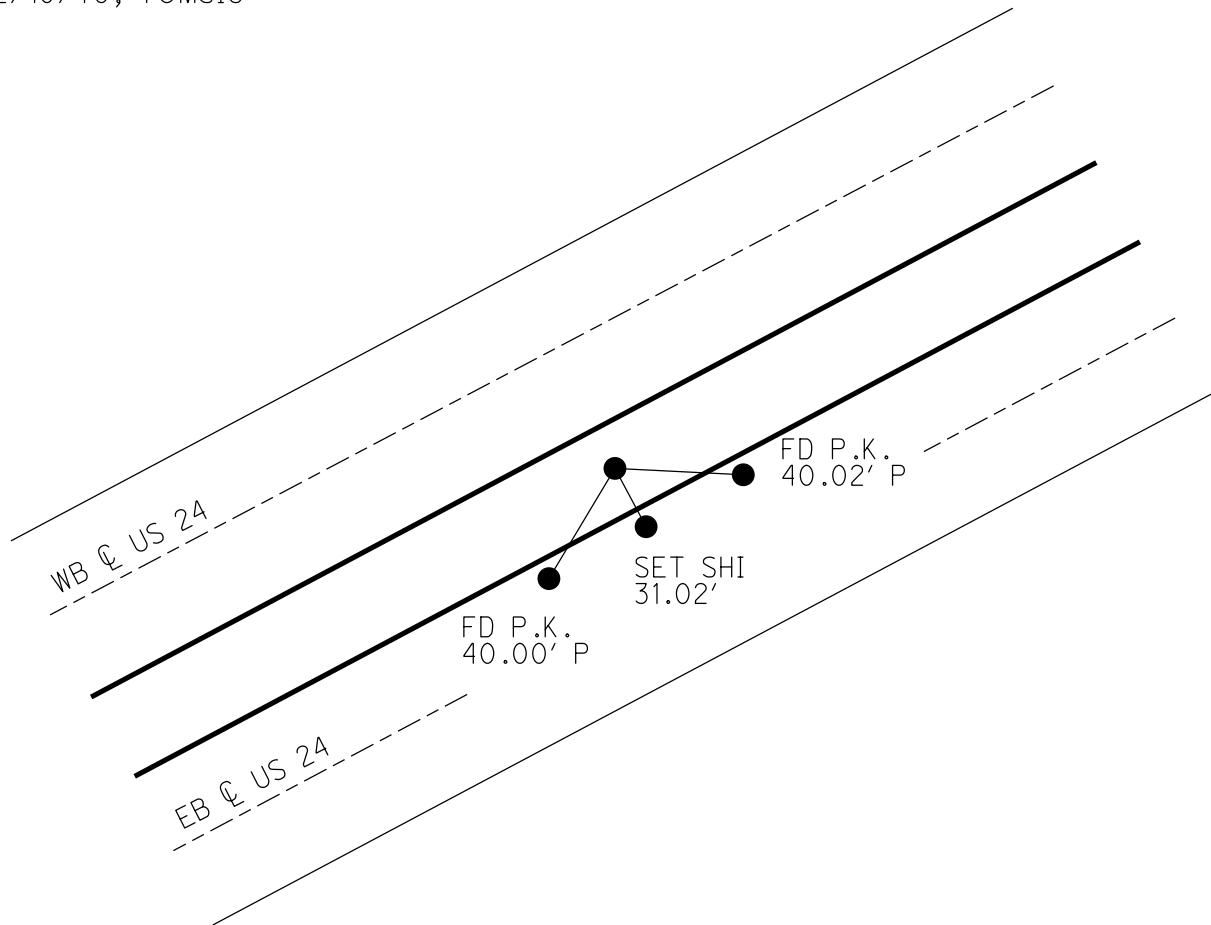

PERSONNEL	TITLE	PERSONNEL	TITLE
Tomsic			
Neuser			
Granata			

COUNTY HEN. DATE Dec. 10, 1975

S. R. U.S. 24 WEATHER P. Cloudy

SEC. \_\_\_\_\_ TEMP. 38°

DESCRIPTION \_\_\_\_\_ LEFT \_\_\_\_\_ CENTER LINE \_\_\_\_\_ RIGHT \_\_\_\_\_ JOB NO. \_\_\_\_\_

