

O.D.O.T. DISTRICT 2 SURVEY OFFICE (USE ONLY)

PERSONNEL	REFERENCE NO.	<u>10</u>	SHEET	<u>12</u>	OF	<u>42</u>
NOTES	<u>RHOADES</u>	DATE	<u>5/3/17</u>	ROUTE	<u>SR 65</u>	
H.C.	<u>O'DONNELL</u>	WEATHER	<u>CLOUDY</u>	COUNTY	<u>HENRY</u>	
R.C.	<u>HELDMAN</u>	TEMP.	<u>54°</u>	TOWNSHIP	<u>BARTLOW</u>	
				SECTION	<u>9</u>	
				T	<u>3</u>	N
				R	<u>8</u>	E

TYPE MONUMENT MAG/WASHER  
 ON SURFACE - ~~BELOW~~ ON  
 LEFT - ☉ PAV'T - ~~RIGHT~~ 7.5'  
3.0' TO LT EDGE PAVEMENT  
 S.L.M. 237+77  
 GRID: NORTHING: 573837.417 EASTING: 1572516.250

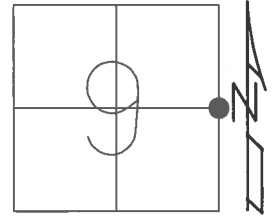

RECORD:  
 FD P.K./WASHER  
 9/12/02, DCH  
 SET MAG/WASHER  
 11/14/02, MB  
 FD P.K./WASHER  
 7/10/12, MC  
 FD MAG/WASHER  
 REF10  
 5/10/17, JFO  
 SET MAG/WASHER  
 9/22/17, JFO

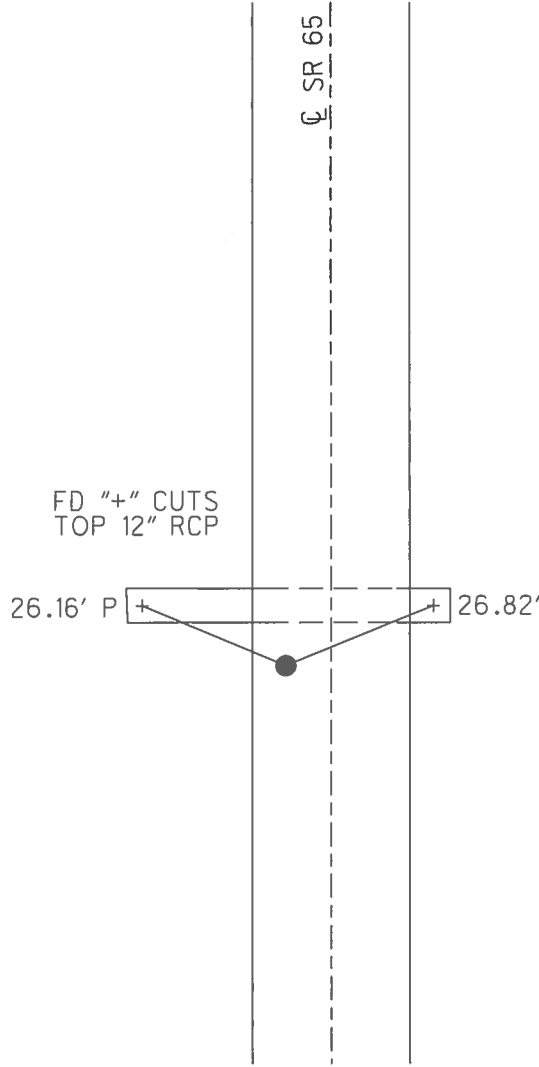

O.D.O.T. DISTRICT 2 SURVEY OFFICE (USE ONLY)

PERSONNEL	REFERENCE NO. <u>10</u>	SHEET <u>12</u> OF <u>42</u>
NOTES <u>HOMAN</u>	DATE <u>09-12-02</u>	ROUTE <u>SR 65</u>
H.C. <u>HOMAN</u>	WEATHER <u>SUNNY</u>	COUNTY <u>HENRY</u>
R.C. <u>BEAUMONT</u>	TEMP. <u>75°</u>	TOWNSHIP <u>BARTLOW</u>
		SECTION <u>9</u>
		T <u>3</u> N R <u>8</u> E

TYPE MONUMENT \_\_\_\_\_ PK/WASHER \_\_\_\_\_  
 ON SURFACE - ~~BELOW~~ \_\_\_\_\_ ON \_\_\_\_\_  
 LEFT - Q PAV'T - RIGHT \_\_\_\_\_ 6.8' \_\_\_\_\_  
3.0' TO LT. EDGE PAVEMENT  
 S.L.M. \_\_\_\_\_ 237+77 \_\_\_\_\_

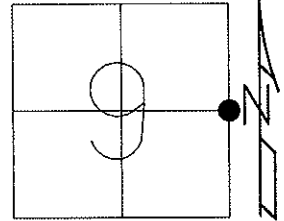

Grid: Northing: 573837.375 Easting: 1572516.201

11-14-02 RESET MAG/WASHER, MB  
 03-14-13 POINT CHIPPED OUT, MC  
 07-10-12 GPS: REF 10  
 03-14-13 GPS: FIN 10, MC

RAILROAD SPIKE SET BY HENRY CO.  
 ENGINEER'S OFFICE WAS REMOVED  
 DURING PAVING PROJECT  
 DATE: 09-12-02

"+" CUT TOP  
 OF CONC. PIPE

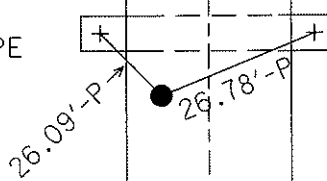

"+" CUT TOP  
 OF CONC. PIPE

Q PAVT

SR 65

# O.D.O.T. DISTRICT 2 SURVEY OFFICE

PERSONNEL \_\_\_\_\_

REFERENCE NO. 10

SHEET 11 OF 29

NOTES Homan - HC

H.C. \_\_\_\_\_

DATE 9-12-02

ROUTE 65

R.C. Beaumont

WEATHER Sunny

COUNTY HENRY

DRAWN- BARNHISEL

TEMP. +75°

TOWNSHIP BARTLOW

SECTION 9

T 3 N R 8 E

TYPE MONUMENT PK & Washer

ON SURFACE - ~~BELOW~~ yes

LEFT- & PAV'T. - ~~RIGHT~~ 6.8'

3.0' TO LT EDGE PAVEMENT

S.L.M. 237+77

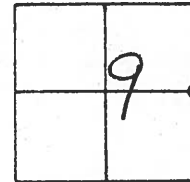

*Reset mag Nail & Washer  
11-14-02  
MB*

Mag Nail Removed,  
Railroad Spike Reset  
Date \_\_\_\_\_

"+" CUT  
TOP CONC. PIPE

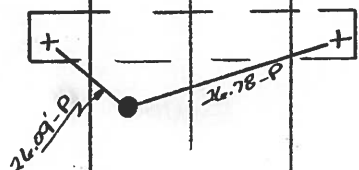

"+" CUT TOP  
CONC. PIPE

SR #65

& PAV'T

Railroad Spike Set by Henry Co.  
Engineer's Office was Removed  
During Paving Project  
Date 9-12-02

# O.D.O.T. DISTRICT 2 SURVEY OFFICE

PERSONNEL

REFERENCE NO. 10

SHEET 11 OF 18

NOTES BARNHISEL

H.C. KUSZ

R.C. BARNHISEL

OTTO

DATE 7-21-93

WEATHER SUNNY

TEMP. +80°F

ROUTE S.R. 65

COUNTY Henry

TOWNSHIP Barlow

SECTION 9

T. 3 N. R. 8 E.

TYPE MONUMENT Sm. R.R. Spk

*Removed*

~~ON SURFACE - BELOW~~ 1 1/2"

~~LEFT- & PAV'T. - RIGHT~~ 6.8

~~3.0 TO LT. EDGE PAVEMENT~~

S.L.M. 238+89 *237+77*

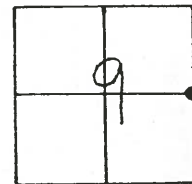

*Reset PK & WASHER  
10-13-93 M3*

*Fd PK & Washer  
9-12-02  
Sunny 75°*

*Homan HC Notes  
Beaumont RC*

*Reset Mag Nail (washer)  
11-14-02  
M3*

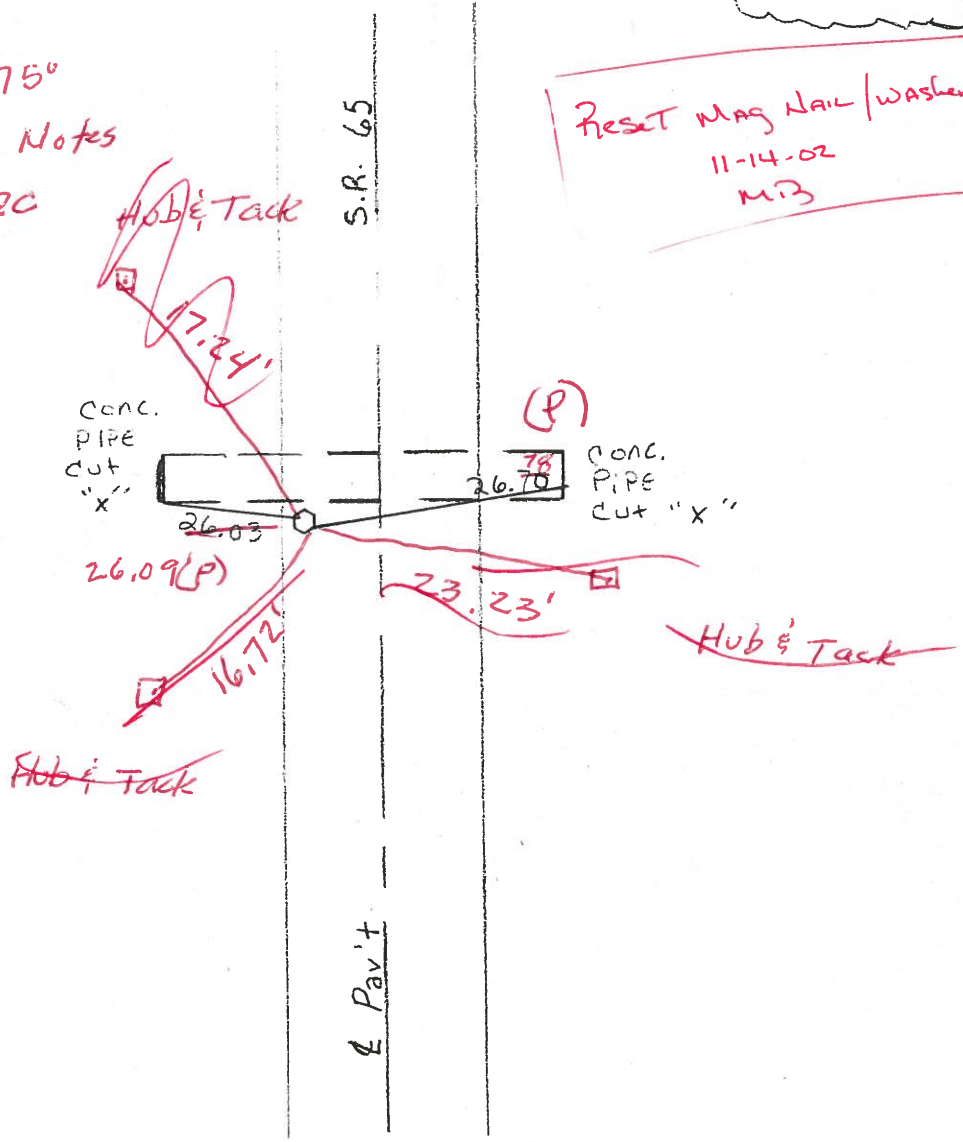

# O.D.O.T. DISTRICT 2 SURVEY OFFICE

PERSONNEL \_\_\_\_\_

REFERENCE NO. 10

SHEET \_\_\_\_\_ OF \_\_\_\_\_

NOTES LOFFMAN

H.C. BARNHISEL

R.C. LOSHKE

DATE 5-15-85

WEATHER P. Clear

TEMP. 70°

ROUTE SR 65

COUNTY HENRY

TOWNSHIP BARTLOW

SECTION 9

T 3 N R 8 E

TYPE MONUMENT R.R. SPIKE

ON SURFACE - BELOW 1 1/2"

LEFT- & PAW'T. - RIGHT 6.9'

2.1 TO LT. EDGE PAVEMENT

S.L.M. 238 + 23

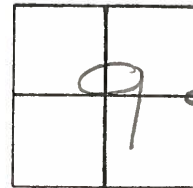

Set Sm/RR SPK  
 6-28-85  
 MDB

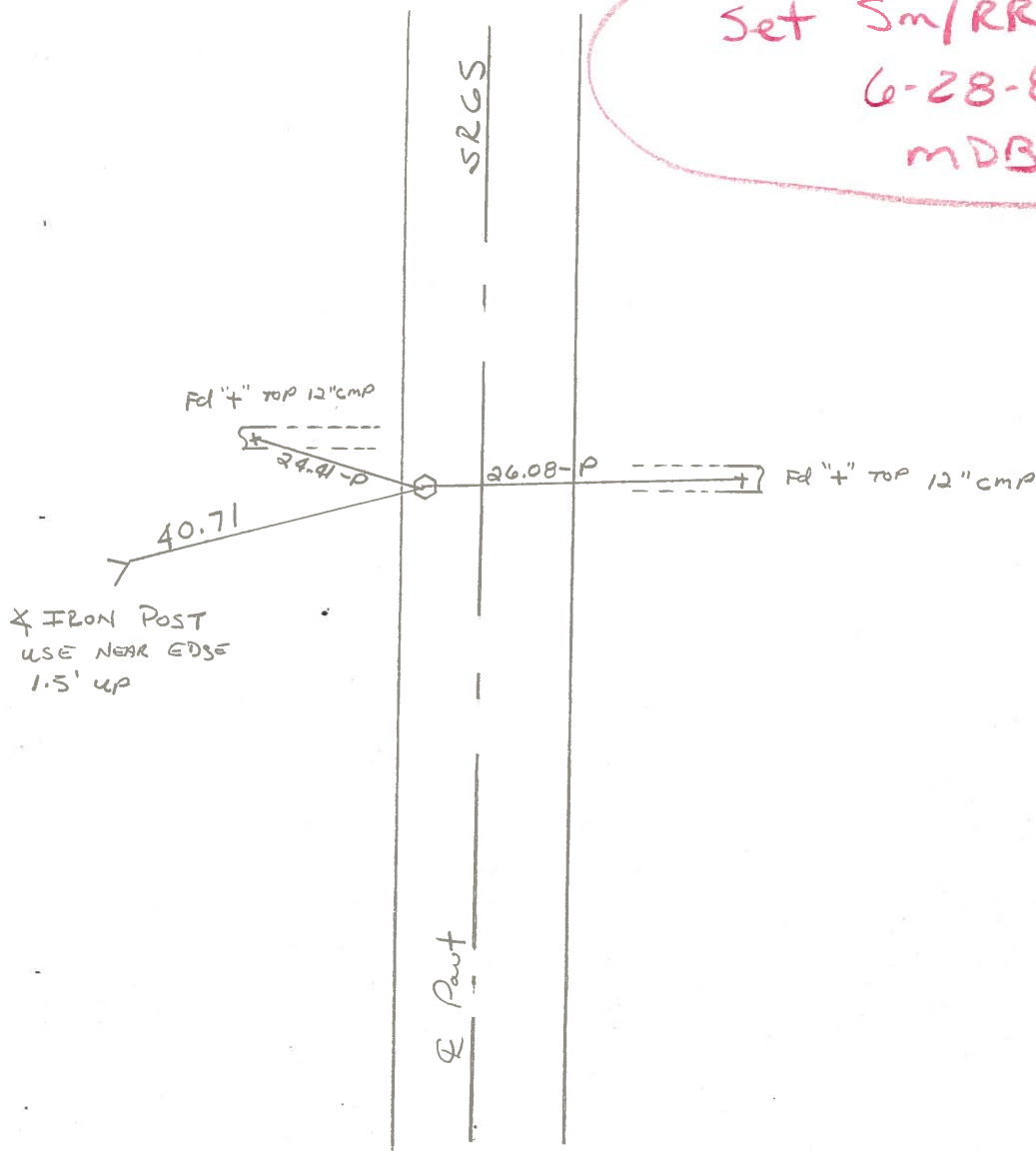

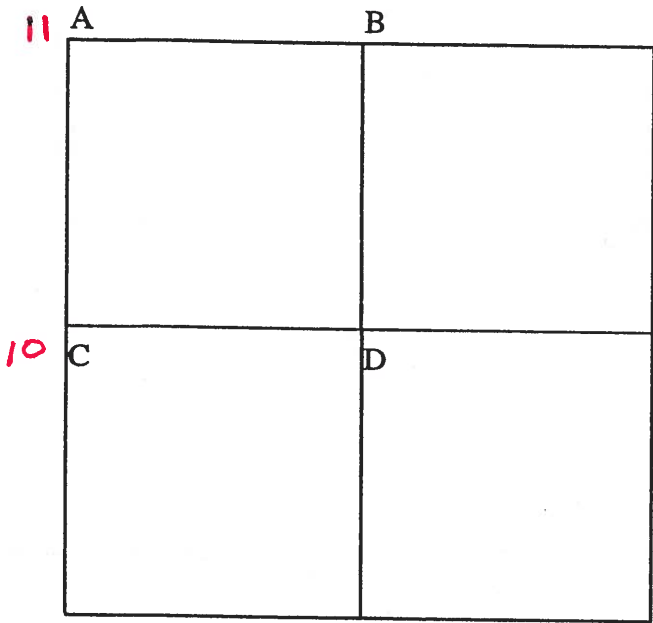

COUNTY: HENRY

TOWNSHIP: BARTLOW

T- 3 -N R- 8 -E

SECTION: 10

5/11/82 R.W., D.B., J.B.

**11** A - Found P.K. nail on surface 1' east of west edge pavement.  
 79.38' N.W. to "+" 72" R.C.P. (P)  
 51.98' N.E. to duplex NW/S power pole  
 38.44' S.E. to "+" east end conc. headwall  
 40.92' S.E. to duplex N/S power pole  
 83.33' W. to "+" 72" R.C.P. (P)

9/10/82 R.W., D.B., J.B.

B - Found stone (5" x 8" x 18"). Stone is protruding from south bank of roadside ditch. Stone is midway between, and on line between, the N.W. & N.E. corners of Section 10. Stone's location was also verified by stones located at the center of Section 10 and at the N1/4 post of Section 3.  
 130.75' W.N.W. to duplex S/S power pole  
 126.64' E.N.E. to duplex S/S power pole  
 1.56' S.W. to P.K. N. end 12" C.M.P.(P)

5/11/82 R.W., D.B., J.B.

**10** C - Found R.R. spike 2.2' east of west edge pavement.  
 40.88' W. to notch in near edge of angle iron post  
 24.40' W.N.W. to "+" west end 12" C.M.P. (P)  
 26.09' E.N.E. to "+" east end 12" C.M.P. (P)

5/12/82 R.W., D.B., J.B.

D - Found stone beside wood post.

PERSONNEL TITLE PERSONNEL TITLE  
 BURNSIDE \_\_\_\_\_  
 SMITH \_\_\_\_\_  
 BOWERS \_\_\_\_\_  
 MEAD \_\_\_\_\_

COUNTY HENRY DATE 11-12-74  
 S. R. 65 WEATHER CLOUDY-SHOWER  
 SEC. 1/4 Post SEC. 9, 10 TEMP. +43°

DESCRIPTION LOCATE SECTION CORNERS LEFT CENTER LINE RIGHT JOB NO.

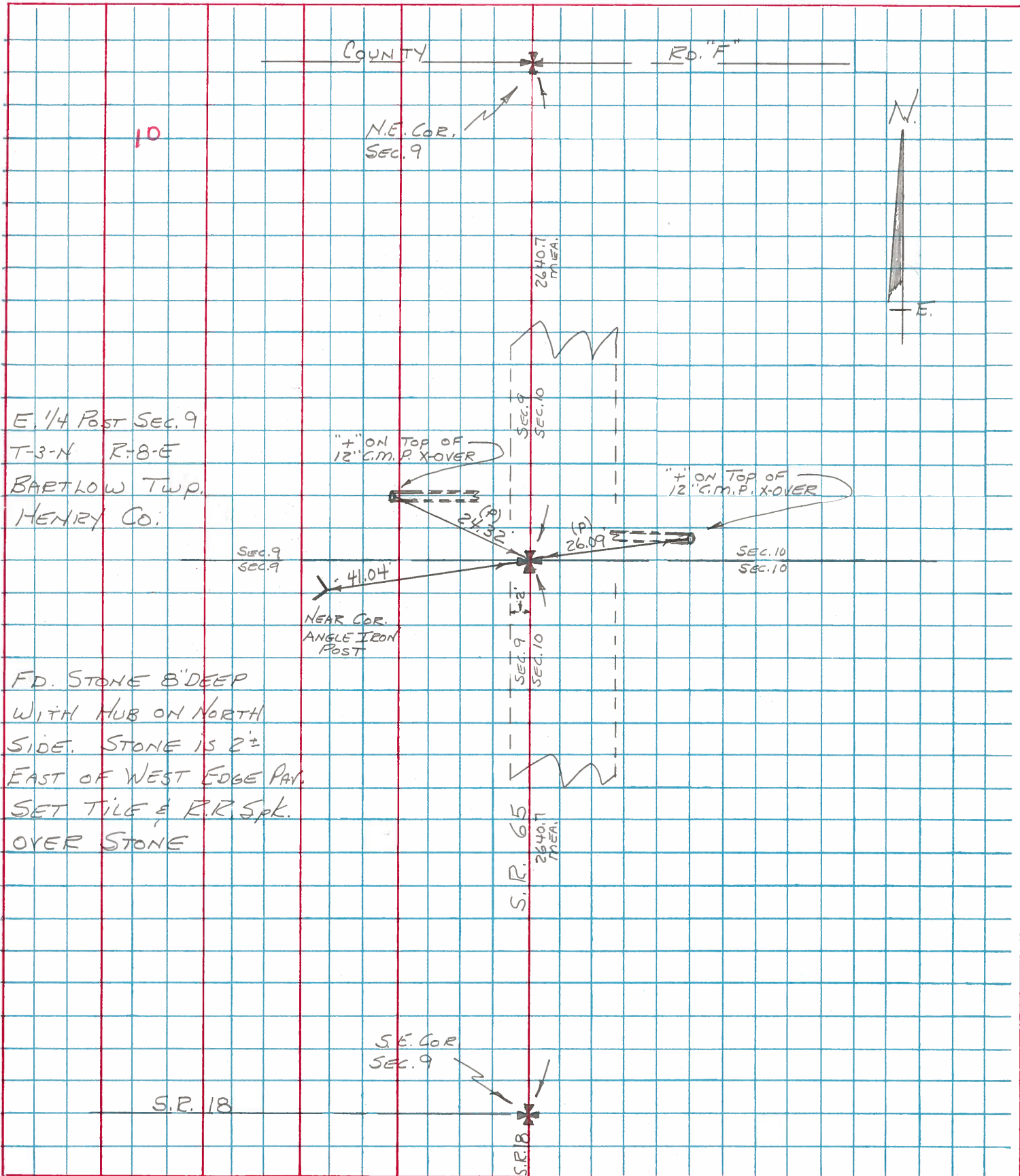

10  
 E. 1/4 Post Sec. 9  
 T-3-N R-8-E  
 BARTLOW TWP.  
 HENRY CO.

FD. STONE 8" DEEP  
 WITH HUB ON NORTH  
 SIDE. STONE IS 2"  
 EAST OF WEST EDGE PAY.  
 SET TILE & R.R. SPK.  
 OVER STONE

S.R. 18