

O.D.O.T. DISTRICT 2 SURVEY OFFICE (USE ONLY)

PERSONNEL _____ REFERENCE NO. 28 A SHEET 34 OF 42
 NOTES HUSS DATE 06-06-12 ROUTE SR 65
 H.C. HUSS WEATHER SUNNY/CLEAR COUNTY HENRY
 R.C. MC TEMP. +70° F TOWNSHIP DAMASCUS
 _____ SECTION 28
 _____ T 5 N R 8 E

TYPE MONUMENT PK/W
 ON SURFACE - ~~BELOW~~ SURFACE
 LEFT - Q PAV'T - ~~RIGHT~~ 4.4'
6.3' TO LT EDGE PAVEMENT
 S.L.M. 732+47.58

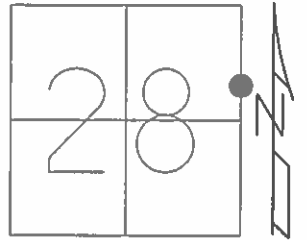

Grid: Northing: 623329.904 Easting: 1572887.077

RECORD

06-22-95 BVD
 FD. PK/W

SET PK/WASHER
 10/8/96, SAH

09-29-10 JHM
 FD. PK/W

03-15-13 MRC
 RESET MAG/W

POINT NOT COVERED
 GPS, FIN A28 (IN JOB HEN 65 1352)
 3/15/13, MC

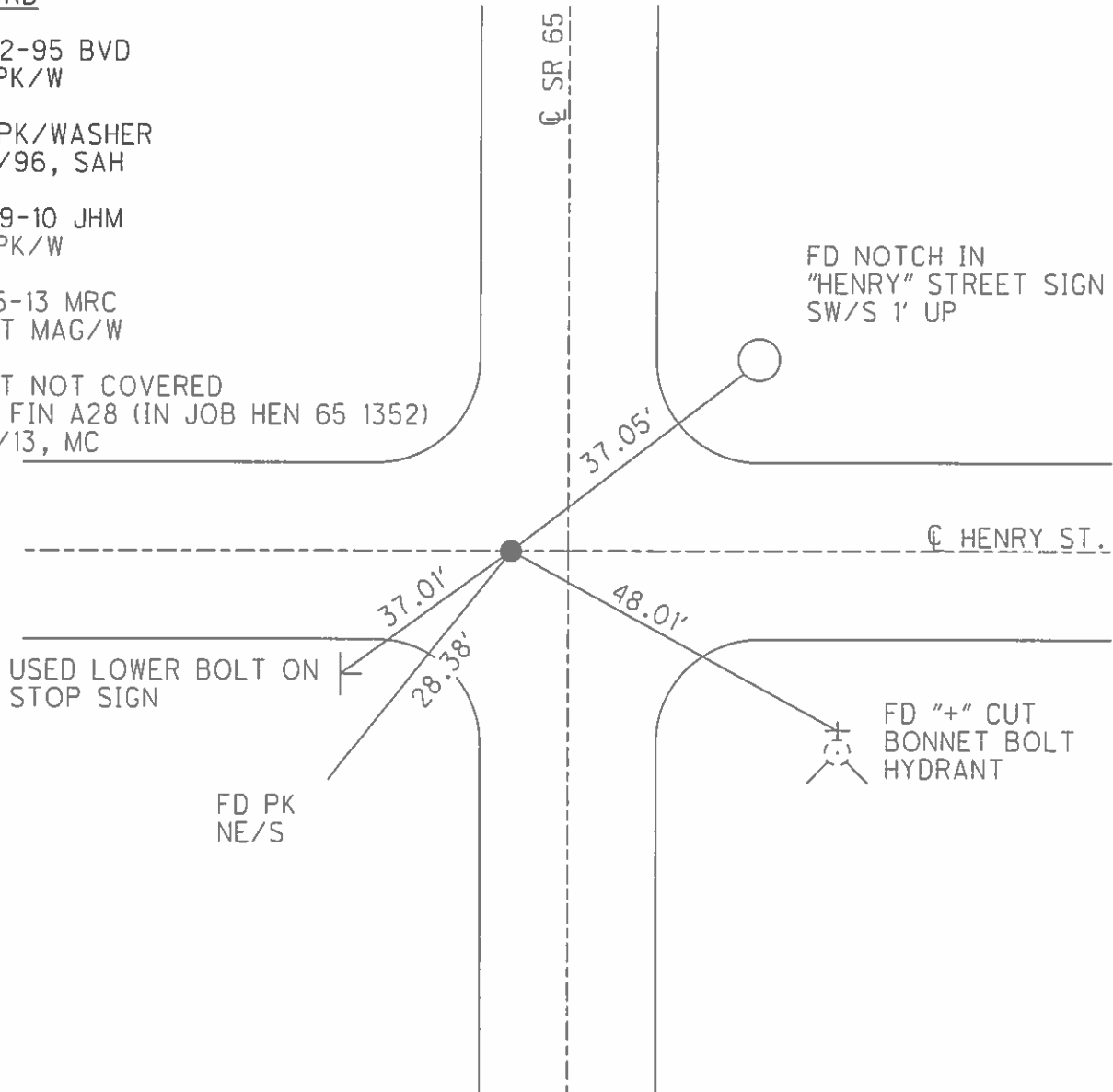

O.D.O.T. DISTRICT 2 SURVEY OFFICE

PERSONNEL

REFERENCE NO. 28-A

SHEET 2 OF 4

NOTES Huss

H.C. Van Dusen

R.C. Moser

DATE 6-22-95

WEATHER Sunny/Clear

TEMP. +91°F

ROUTE 65

COUNTY Henry

TOWNSHIP Namascus

SECTION 28

T5 N R 8 E

TYPE MONUMENT iron pin

ON SURFACE - BELOW 2"

LEFT - & PAV'T - RIGHT 5.6' ht

6.3' TO ht EDGE PAVEMENT

S.L.M. 732 + 53

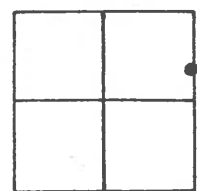

McClure
SET PR WASHER
10-8-90
SAH

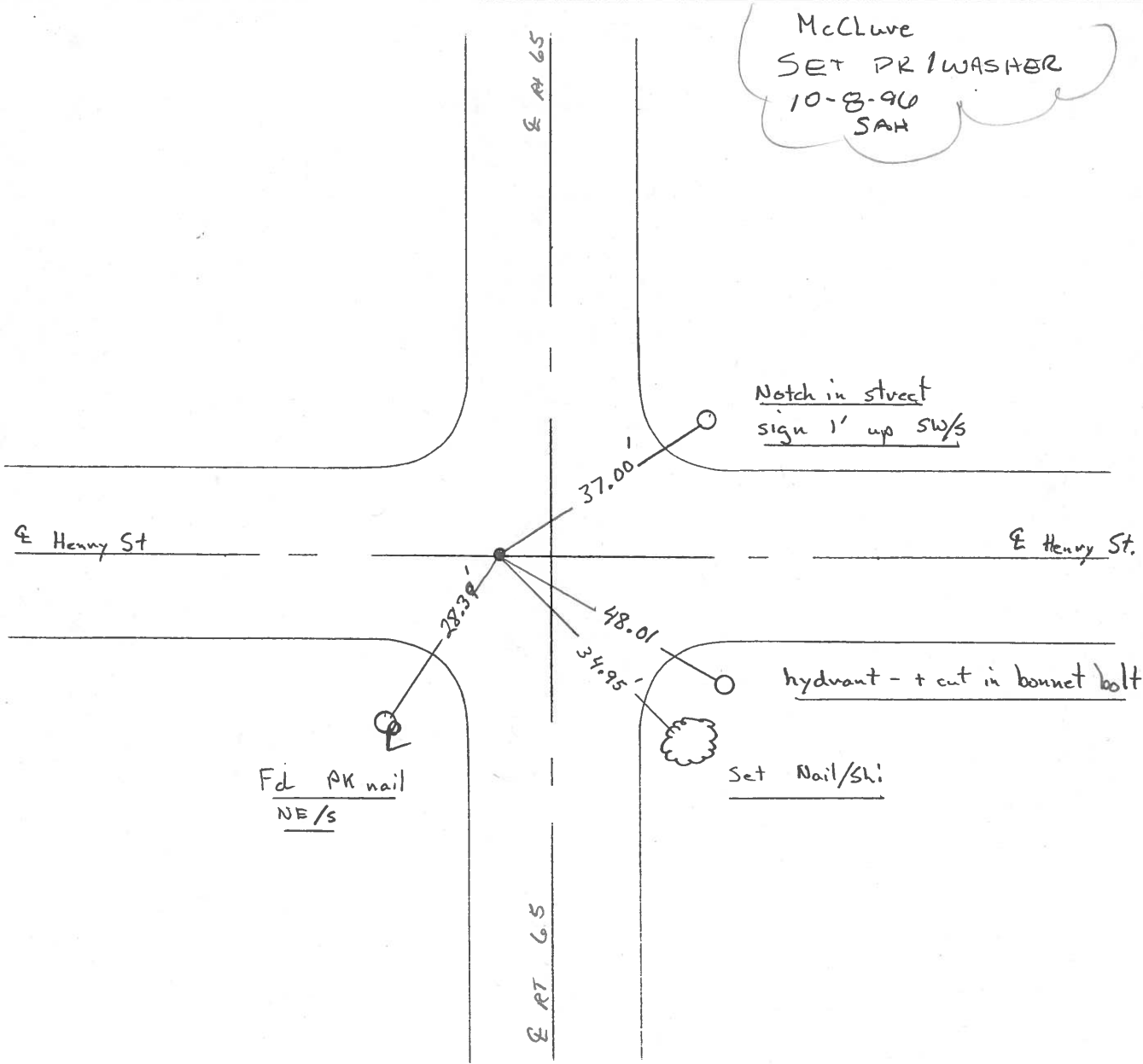

Notch in street
sign 1' up SW/s

hydrant - + cut in bonnet bolt

Set Nail/shi

Fd AK nail
NE/s