

FED. RD. DIVISION	STATE	PROJECT	
2	OHIO	STATE	

HEN 108~(5.70 ~ 6.06)  
HEN 115~7.56

# STATE OF OHIO DEPARTMENT OF HIGHWAYS

## HEN-108 (5.70 - 6.06) HEN-115~7.56

### VILLAGE OF HOLGATE HENRY COUNTY

#### CONVENTIONAL SIGNS

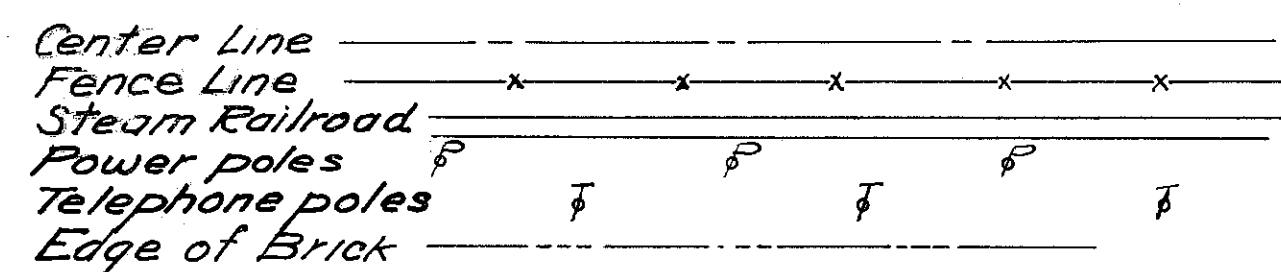

#### INDEX OF SHEETS

Title Sheet	1
Typical Sections	2
General Notes	3
Computations	3
General Summary	4
Summaries	4
Plan and Profile.	5-10

#### LINE DATA

Begin Project - HEN-108 Sta 302+10.40  
 End Project - HEN-108 Sta 324+90.5  
 Net length of Project - HEN-108 = 2280.1 Lin. ft. or 0.431 mi.

Begin Project - HEN-115 Sta 398+88.06  
 End Project - HEN-115 Sta 400+32.76  
 Net length of Project - HEN-115 144.7 Lin. ft. or 0.027 mi.

TOTAL LENGTH OF PROJECT 2424.8 Lin. ft. or 0.459 mi.

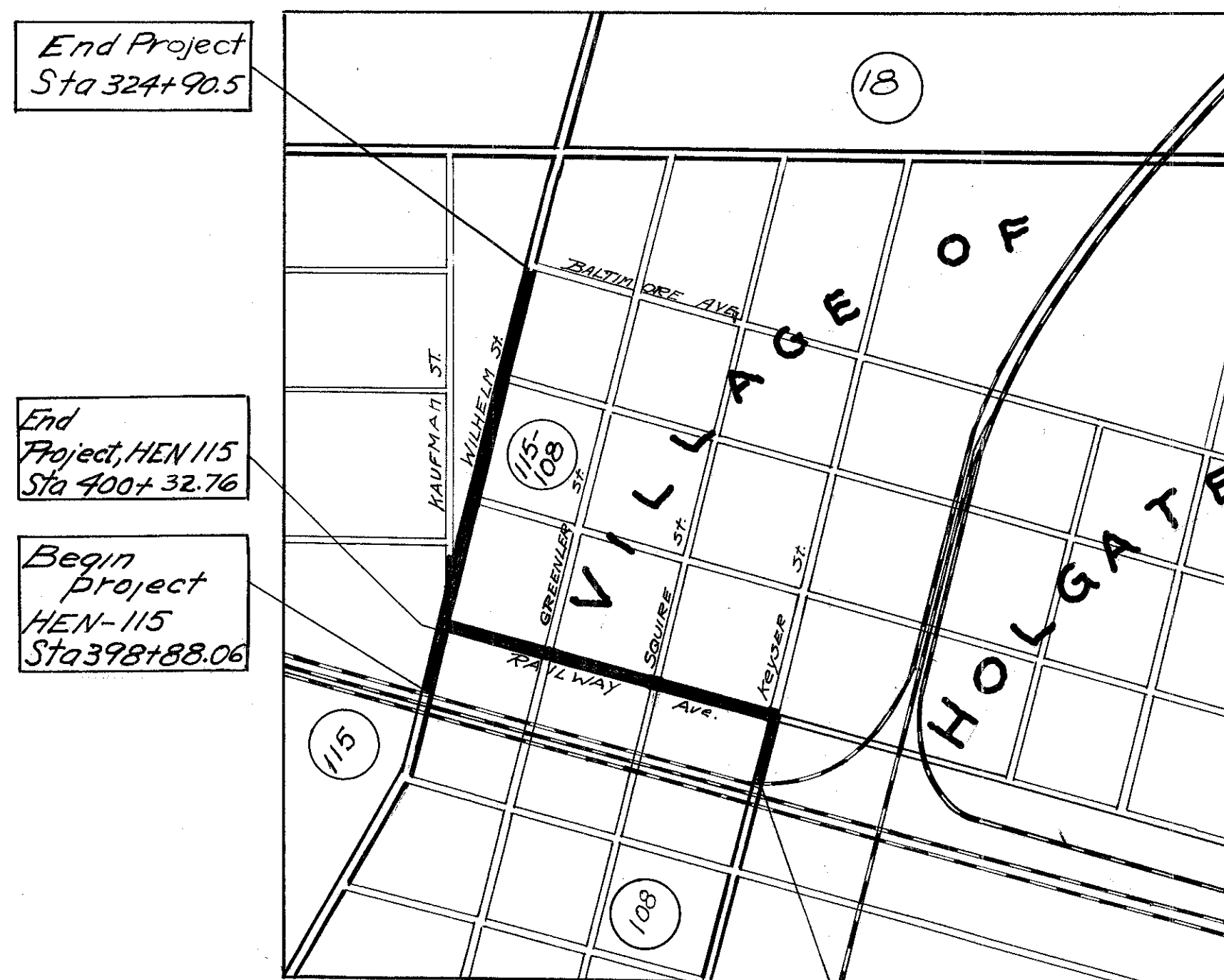

#### LOCATION MAP

#### SCALE OF FEET



Portion to be improved   
 State Roads   
 Other Roads

#### Scale

Plan \_\_\_\_\_ 1"=20'  
 Profile: Horizontal \_\_\_\_\_ 1"=20'  
 Profile: Vertical \_\_\_\_\_ 1"=5'

The Standard Specifications of the State of Ohio, Department of Highways including changes and supplemental specifications listed in the proposal shall govern this improvement.

The right of way for this improvement will be provided by the State of Ohio.

I hereby approve these plans and declare that the making of this improvement will not require the closing to traffic of the highway and that provisions for the maintenance and safety of traffic will be as set forth on these plans and estimates.

Approved LC Roush  
 Date June 11, 1958 Division Deputy Director

Approved G. H. Mahoney  
 Date 7-1-58 Deputy Director of Planning & Programming

Approved \_\_\_\_\_  
 Date \_\_\_\_\_ Engineer of Bridges

Approved P.E. Shultz  
 Date 6-30-58 Engineer of Location & Design.

Approved P.E. Washburn  
 Date 6-20-58 Deputy Director of Design & Construction

Approved George J. Shumway  
 Date 7/1/58 First Assistant Director

Approved W. M. Yell  
 Date 7/2/58 Director of Highways

Standard Drawings	
I.B.C.B. No. 6	5-1-52
T-12	7-1-54
T-35	1-2-56
I-1,2,3,4&5	4-24-58

APR 20 1961  
 GROUND PHOTOLAP

FILE No.	HEN-108-(5.70-6.06) HEN-115-7.56
Date of Letting	_____
Contract No.	_____

HEN 108 ~ (5.70 - 6.06)  
HEN 115 ~ 7.56

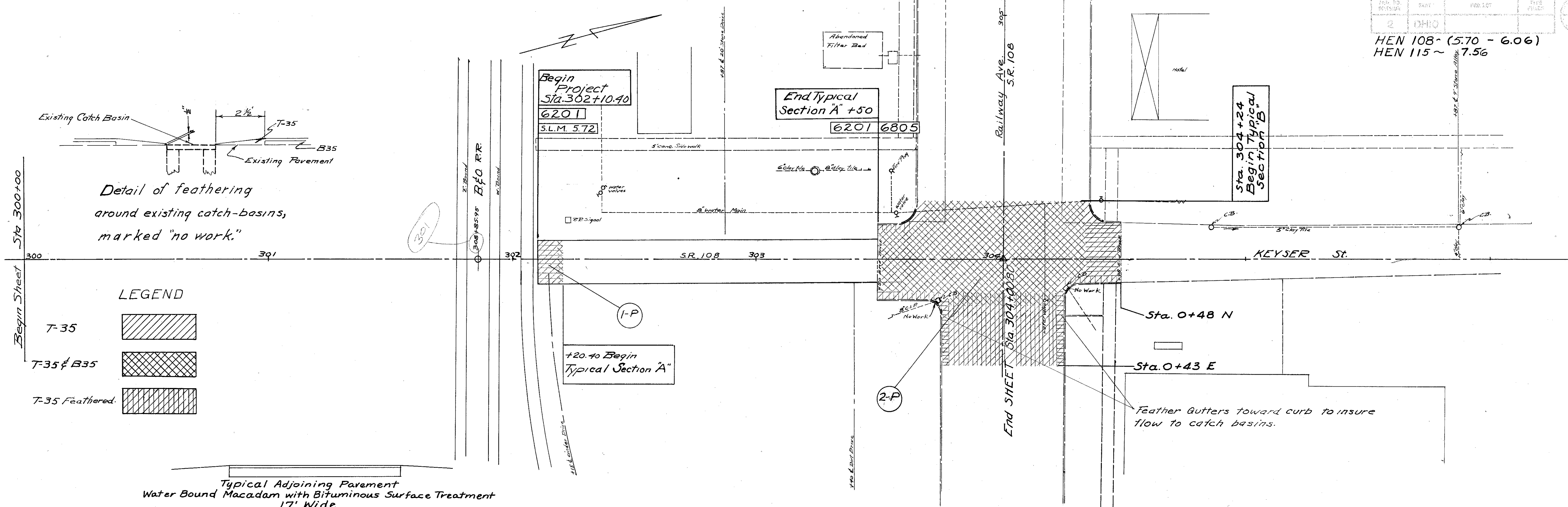

BM#55 Elev. 715.52  
301+63-18' Rt.  
Top of nut on RR signal.

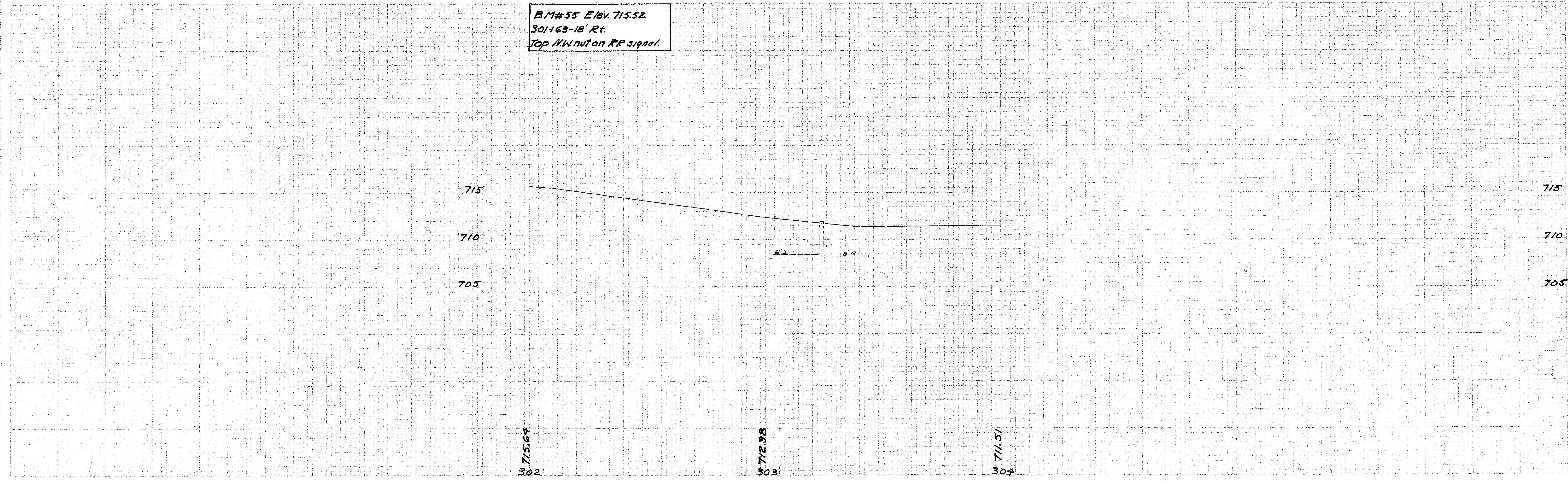



2	CHIC		
HEN 108-(5.70-6.06)			
HEN 115~7.56			
1 story Conc. Block			

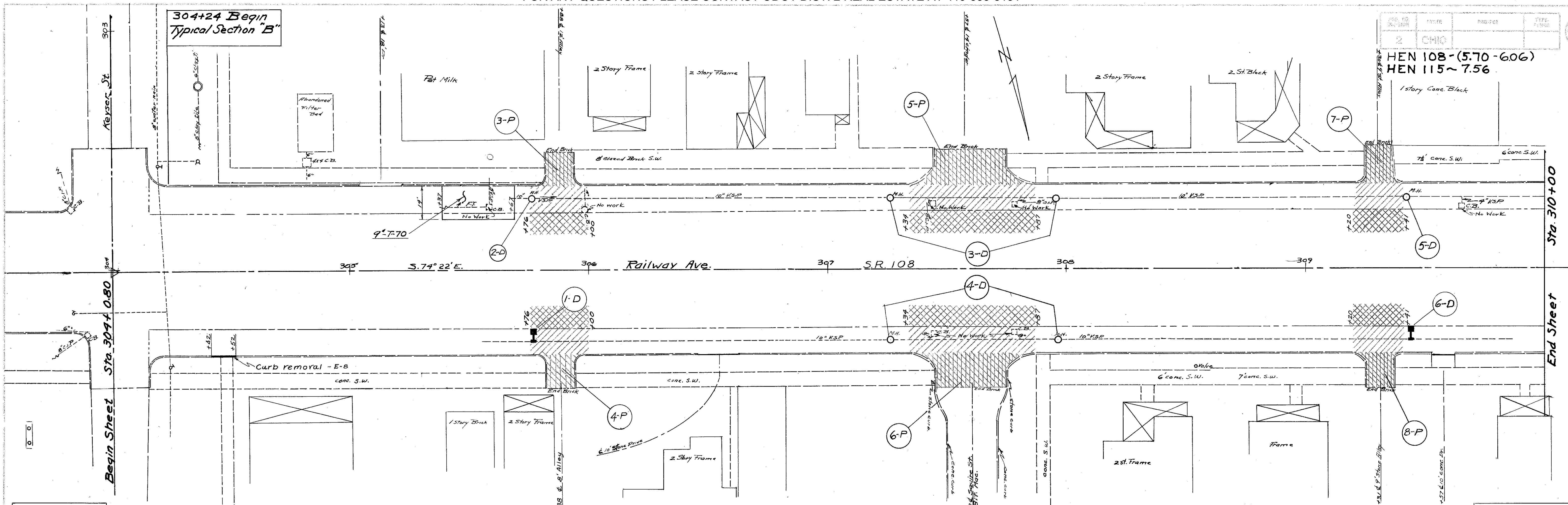

Code 6805

Code 6805

Sta 304+42 to 304+52 Right:-  
Item E-8 Remove and dispose  
of 10 lin ft. existing curb.  
Item I-12 Place 10' of standard  
Type 6 curb.  
Totals to General Summary

BM#54 El. 712.60  
304+78-50 Lt  
NW Corner Filter  
Bed

Sta 305+37 to 305+67 left:-  
Item E-8 Remove and dispose  
of 47 sq. yards of existing  
pavement.  
Item T-70 Place 47 sq. yards  
of Portland cement concrete  
pavement 9" thick. Slope  
gutter to meet existing  
catch basin. See note below  
Totals to General Summary

\* Finish T-70 to conform to  
surface of surrounding T-35.  
Hand finishing will be permitted.

1-D Sta 305+76 -24' Rt. Build one  
standard No 6 catch basin modified,  
connect to existing sewer with 3' of  
10" class A storm sewer under pavement  
and approaches and one 10" on 10" tee  
Item E-8 ~4 sq. yds. Pavement removal.  
B-70 ~4 Sq. yds. 9" Base replacement.  
2-D Sta 305+76 Left: Adjust Manhole to grade

3-D Sta 307+26 to 307+95.5 Left: Adjust 2 manholes  
to grade.  
4-D Sta 307+26 to 307+96 Right: Adjust 2 manholes  
to grade.

6-D Sta 309+43 -24' Rt. Build one  
standard number 6 catch basin modified,  
connect to existing sewer with  
approx 4' of 10" class A storm sewer  
under pavement and approaches  
and one 10" on 10" tee. Item E-8 ~  
4 Sq. yds. Pavement removal.  
B-70 ~ 4 Sq. yds. 9" Base replacement.

BM#53 El. 711.56  
309+89 - 50' Rt. Adjust manhole to grade  
E. End 1st Step.  
5-D Sta 309+42 Left: Adjust manhole to grade

Note: Removal and disposal and replacement of pavement  
as necessary, to be included in unit price  
bid for Item I-8. Manholes adjusted to grade  
and Item I-8 Catch Basins adjusted to grade.

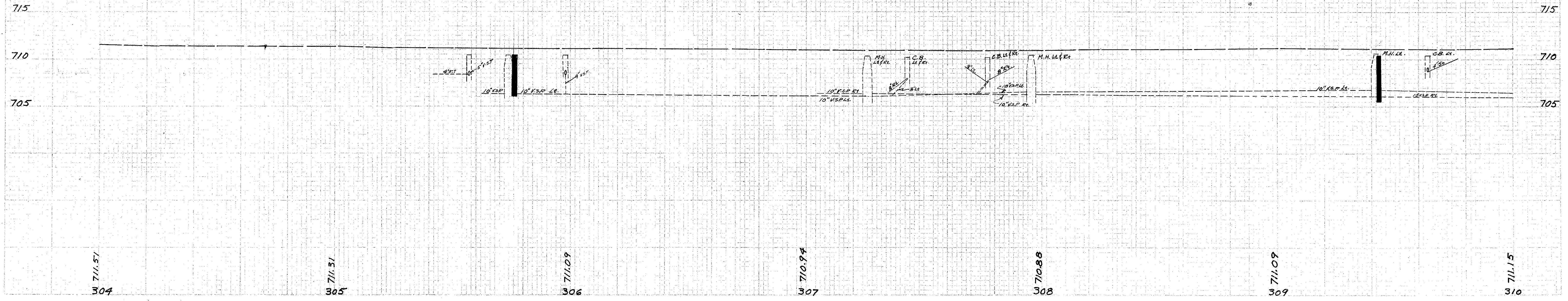



NO. TO SHEET	SHEET	PROJECT	DATE
2	OHIO		

7  
10

HEN 108~(5.70~6.06)  
HEN 115~7.56

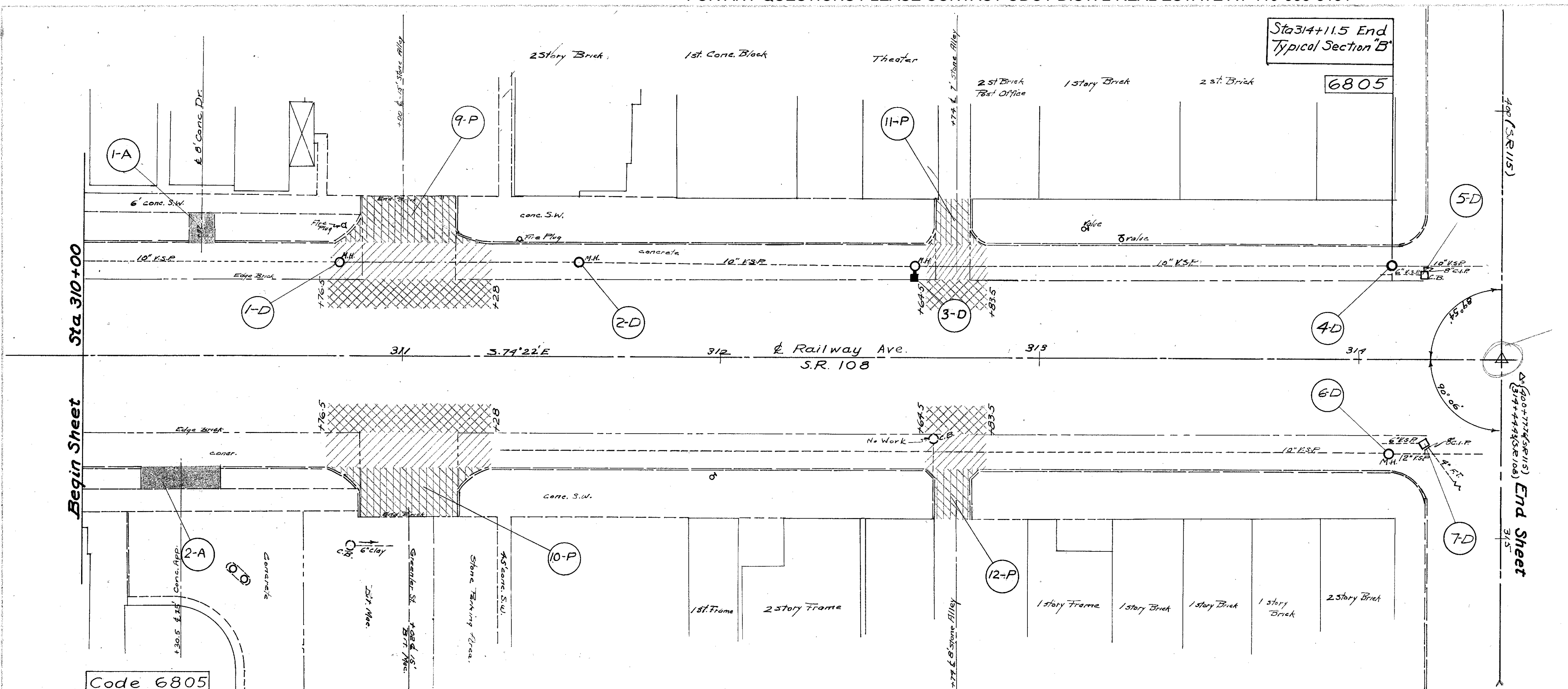

**LEGEND**  
 T-35 Surface Course (Feathered) (Carried to Drive Table "A")

- 1-D Sta 310+80 Left: Adjust manhole to grade.
- 2-D Sta 311+55 Left: Adjust manhole to grade.
- 3-D Sta 312+61-24' Left Build one standard number 6 catch basin modified, connect to existing manhole with approximately 2' of 10" class A storm sewer under pavement and approaches. Item E-B ~ 4 Sqyds. Pavement removal. B-70 ~ 4 Sqyds. 9" Base replacement. 28.5 Left: Adjust manhole to grade.
- 4-D Sta 314+10.5 Left: Adjust manhole to grade.
- 5-D Sta 314+20.5 Left: Adjust catch basin to grade.
- 6-D Sta 314+09.5 Right: Adjust manhole to grade.
- 7-D Sta 314+20.5 Right: Adjust catch basin to grade.

BM#52 E1711.53  
314+76-36' Lt  
"X" on Conc. Ledge

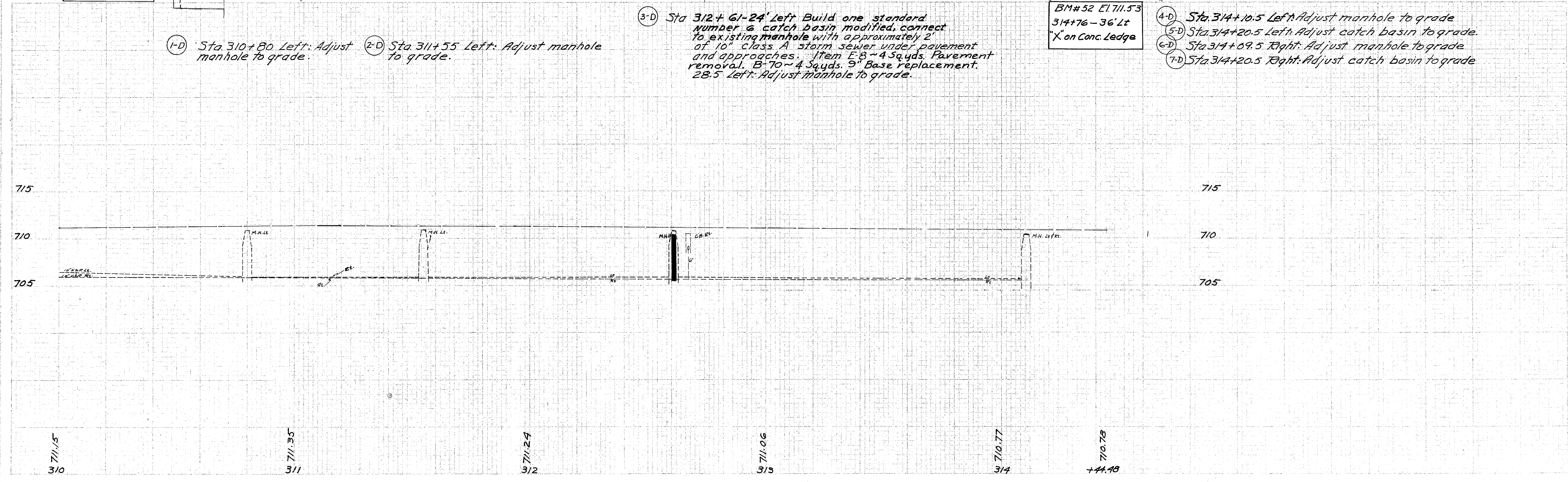



HEN 108~(5.70-6.06)  
HEN 115~7.56

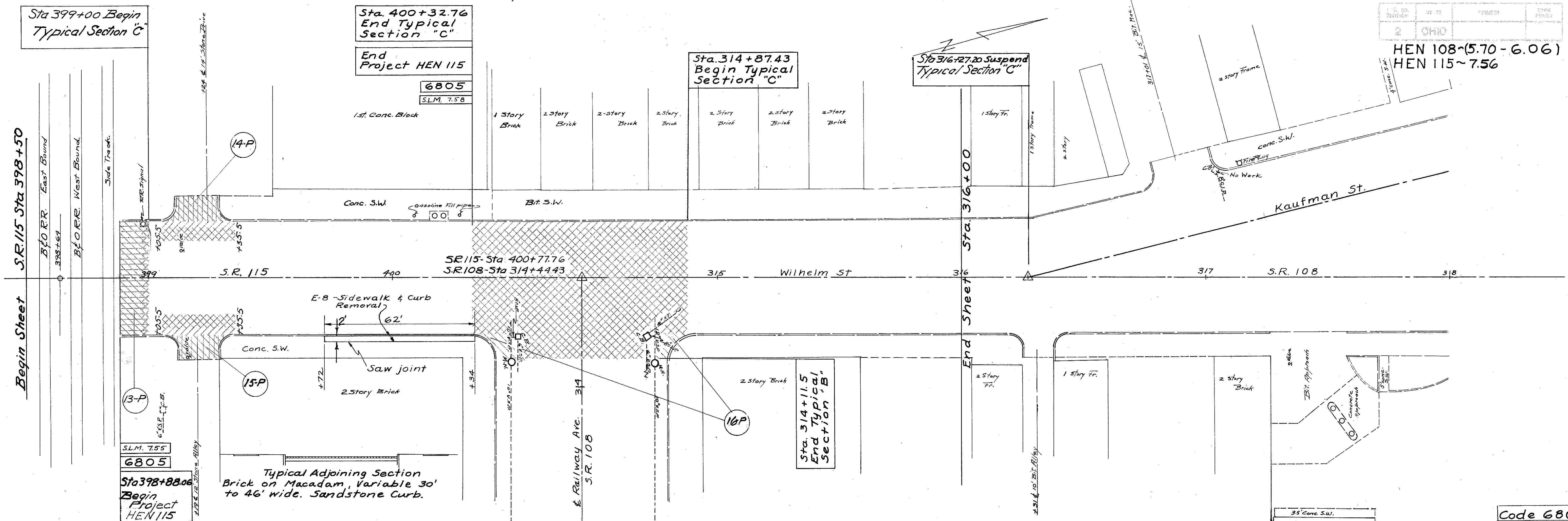

SLM. 755  
6805  
Sta 398+88.06  
Begin Project HEN 115

Typical Adjoining Section  
Brick on Macadam, Variable 30'  
to 46' wide. Sandstone Curb.

Sta 399+72 to Sta 400+34 Right:-  
Item E-8 Remove and dispose of 62 lin. ft. of existing curb.  
Item E-8 Remove and dispose of 124 sq. ft. of existing sidewalk.  
Item I-12 Place 62 lin. ft. of Type 6 concrete curb.  
Item I-13 Place 124 square feet of concrete sidewalk. (4" Thickness)  
Totals to General Summary

B.M.# 51 El. 711.89  
317+71 - 32' Rt.  
X" Corner conc. curb

Code 6805

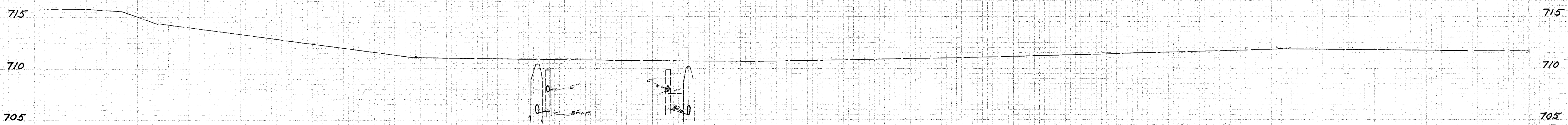

371.91  
399

711.05  
400

710.66  
315

711.15  
316

711.80  
317

711.58  
318



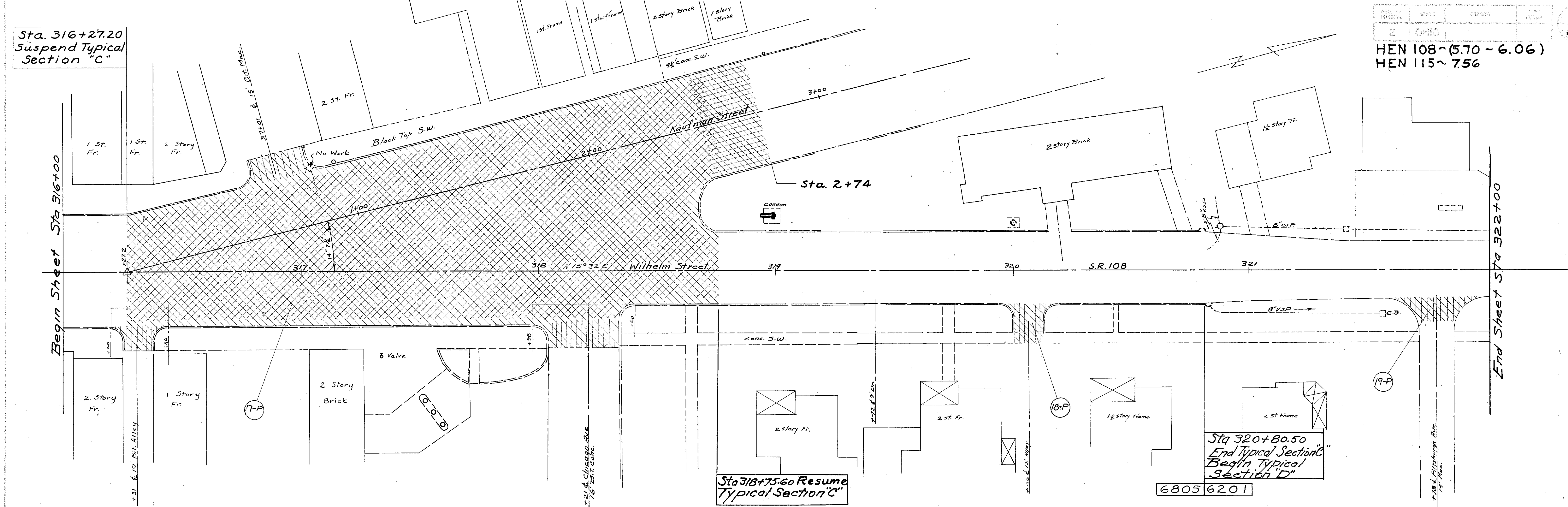

Sta. 316+00 to 322+00



JOB NO.	DATE	REVISION	BY
2	0410		

HEN 108~(5.70 ~ 6.06)  
HEN 115~7.56

10  
10

Do not ink  
NOTE: Sta. 324+90.5 is beginning of Typical Section on proposed Hen-108~6.15 Improvement, Job No. 02221

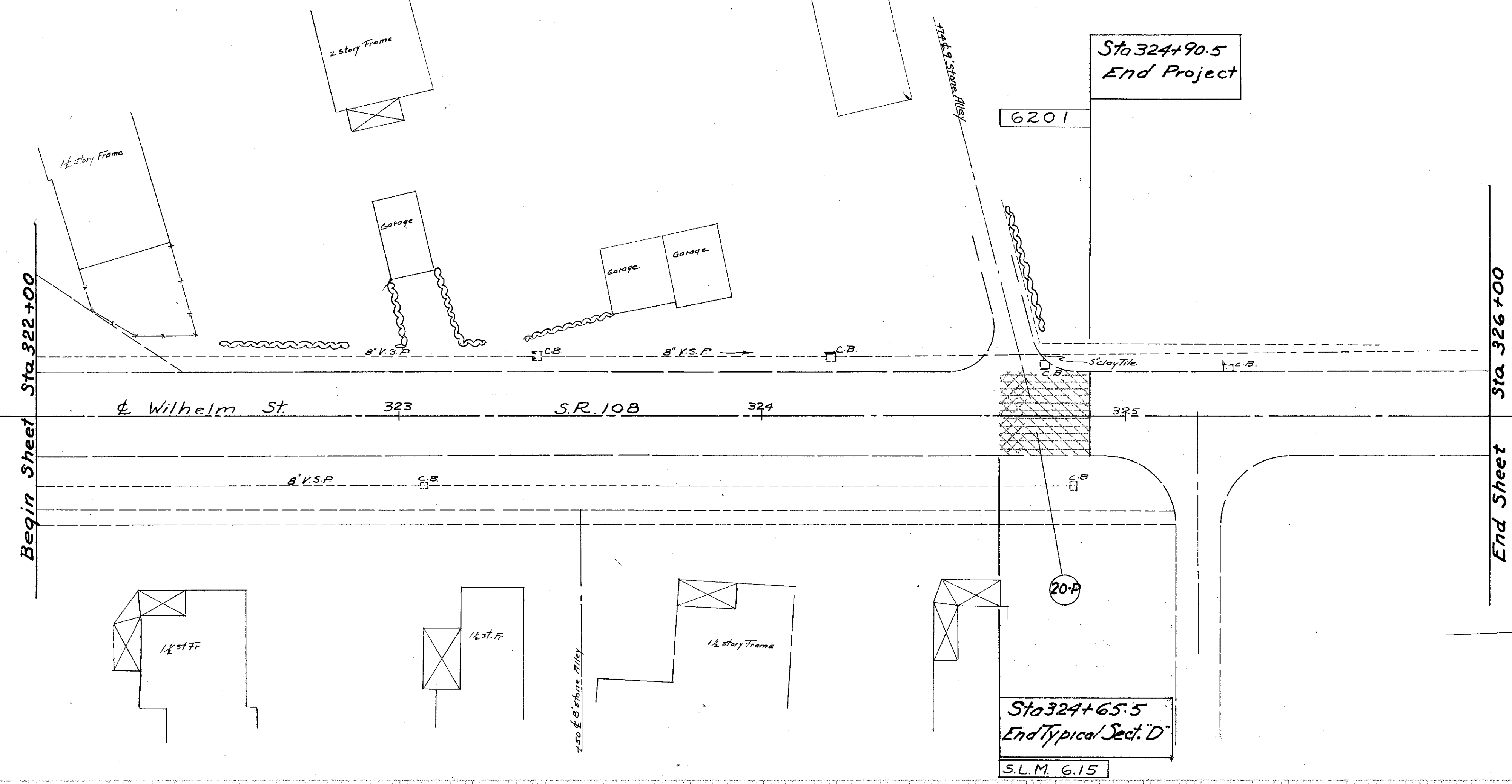

Typical Adjoining Pavement  
Water Bound Macadam with Bituminous  
Surface Treatment 18' Wide, and  
Concrete Widening 2 1/2' on each side.

Sta 324+65.5  
End Typical Sect. 'D'  
S.L.M. 6.15



2-B-12