

FED. RD. DIVISION	STATE	PROJECT	FISCAL YEAR
2	OHIO		1948

HENRY COUNTY
HEN-6-(11.87-13.13)

STATE OF OHIO
DEPARTMENT OF HIGHWAYS

HEN-6-(11.87-13.13)

HENRY COUNTY

VILLAGE OF NAPOLEON

CONVENTIONAL

- COUNTY LINE
- TOWNSHIP LINE
- SECTION LINE
- CORPORATION LINE
- FENCE LINE
- CENTER LINE
- POLE LINE
- STEAM RAILROAD
- GUARD RAIL

SIGNS



INDEX OF SHEETS

TITLE SHEET	1
TYPICAL SECTIONS	2-3
GENERAL NOTES	4
PAVEMENT COMPUTATIONS	4
GENERAL SUMMARIES	4
SUB SUMMARIES	4
PLAN & PROFILE	5-9

LINE DATA

BEGIN PROJECT	STA. 17+13
END PROJECT	STA. 84+07.03
GROSS LENGTH	6694.03 LIN. FT.
DEDUCT FOR BRIDGE STA. 23+46 TO STA. 25+00	= 154 LIN. FT.
DEDUCT FOR BRIDGE STA. 62+51 TO STA. 72+46	= 995 LIN. FT.
DEDUCT FOR RAILROAD STA. 31+58 TO STA. 31+87	= 29 LIN. FT.
TOTAL DEDUCTIONS	1178 LIN. FT.
NET LENGTH	5516.03 LIN. FT. OR 1.044 MILES

BEGIN PROJECT
STA. 17+13

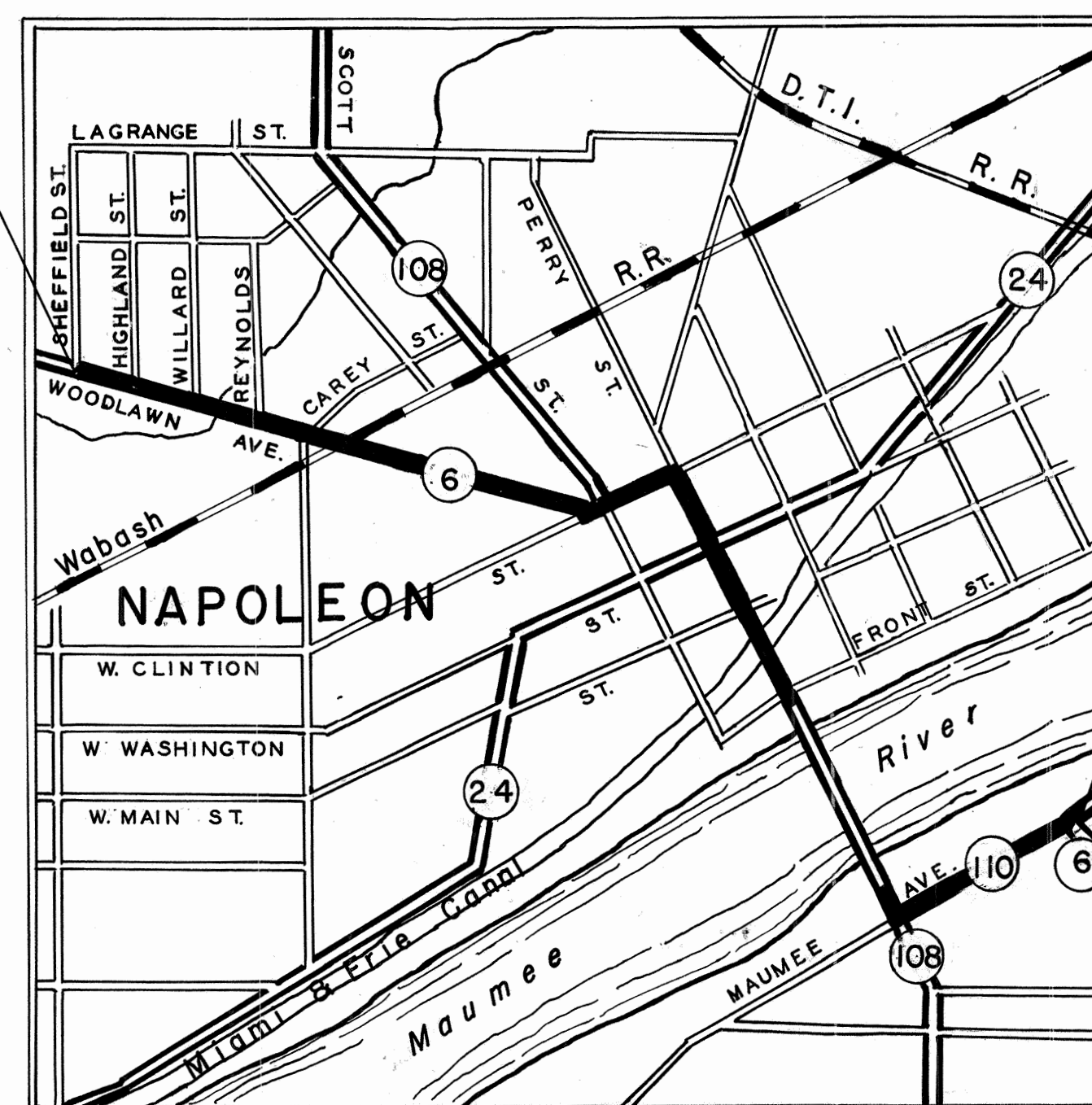

END PROJECT
STA. 84+07.03

LOCATION PLAN

Scale 1"=800'

PORTION TO BE IMPROVED	
STATE HIGHWAYS	
OTHER ROADS	
DETOURS	NONE

SCALES

PLAN	1" = 50'
PROFILE HORIZONTAL	1" = 50'
PROFILE VERTICAL	1" = 5'
CROSS SECTIONS	NONE

The Standard Specifications of the State of Ohio, Department of Highways, including changes and Supplemental Specifications listed in the proposal shall govern this improvement.

The right of way necessary for this improvement will be provided by the State of Ohio.

I hereby approve these plans and declare that the making of this improvement will not require the closing to traffic of the Highway, and that provisions for the maintenance and safety of traffic will be as set forth on the plans and estimates.

Approved: W. B. Robison
Date: 4-19-48 Division Deputy Director

Approved: _____
Date: _____ Chief Engineer, Bureau of Maintenance

Approved: G. B. Logue
Date: 5-12-48 Chief Engineer, Bureau of Bridges & R.R. Crossings

Approved: George J. Thorny
Date: 5/13/48 Chief Engineer, Bureau of Location & Design

Approved: Frank M. Williams
Date: 5-13-48 First Asst. Director & Chief Engineer

Approved: Earl L. Reeb
Date: 5-13-48 Director of Highways

SUPPLEMENTAL SPECIFICATIONS

NONE

STANDARD DRAWINGS

NONE

CONSTRUCTION BUREAU
JUN 24 1955
GROUND PHOTOLAB

FILE NO.	HENRY COUNTY HEN-6-(11.87-13.13)
SEC.	
DATE OF LETTING:	
CONTRACT NO.	

omit

HENRY COUNTY
HEN-6-(11.87-13.13)

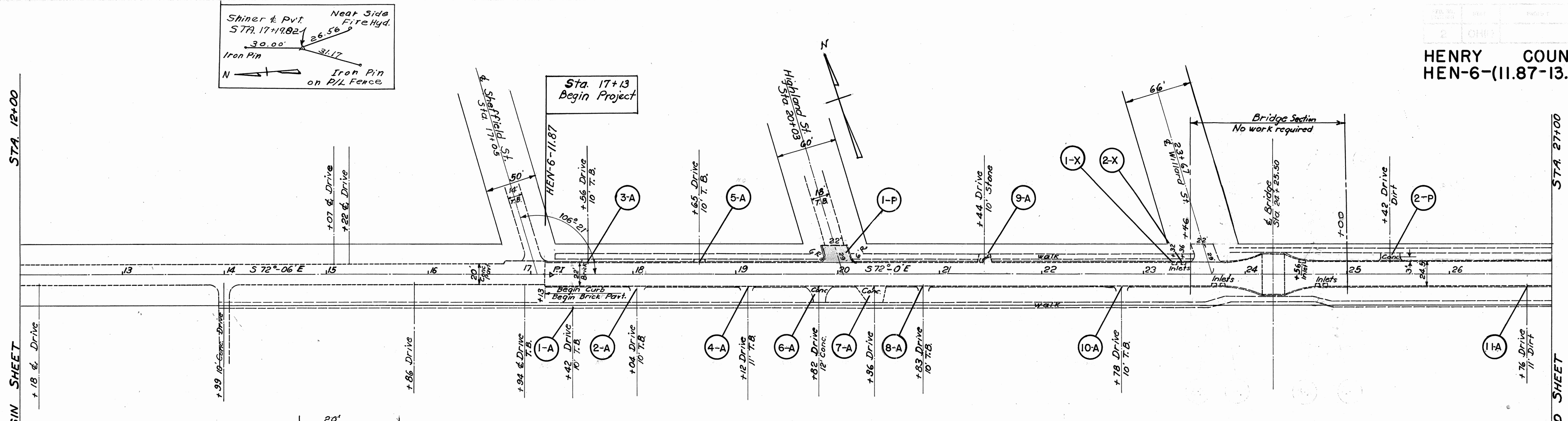

Typical Section of Adjoining Pavement: Concrete

SIDE APPROACHES "A"
1-A to 11-A No Work Required

INLETS "X"

Ref. No.	Remarks
1-X	Raise Grate
2-X	Raise Grate

EXTRA PAVEMENT "P"

Ref. No.	I-35 Sq. Yds.	B-35 Sq. Yds.
1-P	46	23
2-P	7	0
TOTAL	53	23

BRIDGE No. HE-6-120
TYPE: Conc. Slab Bridge
SPAN: 22'-0" Clear
ROADWAY: 40'-0" with two 6'-0" Sidewalks
LOADING: S-20-46
SURFACE COURSE: Bituminous
APPR. SLABS: A5-41-F (Modified)

S.E. Cor. N.W. Wing C.B.
Station 12+48
Elevation 676.89

Top N. not Fire Hyd.
Station 17+35
Elevation 681.02

Top Center N.W. End Post
Station 23+95
Elevation 676.48

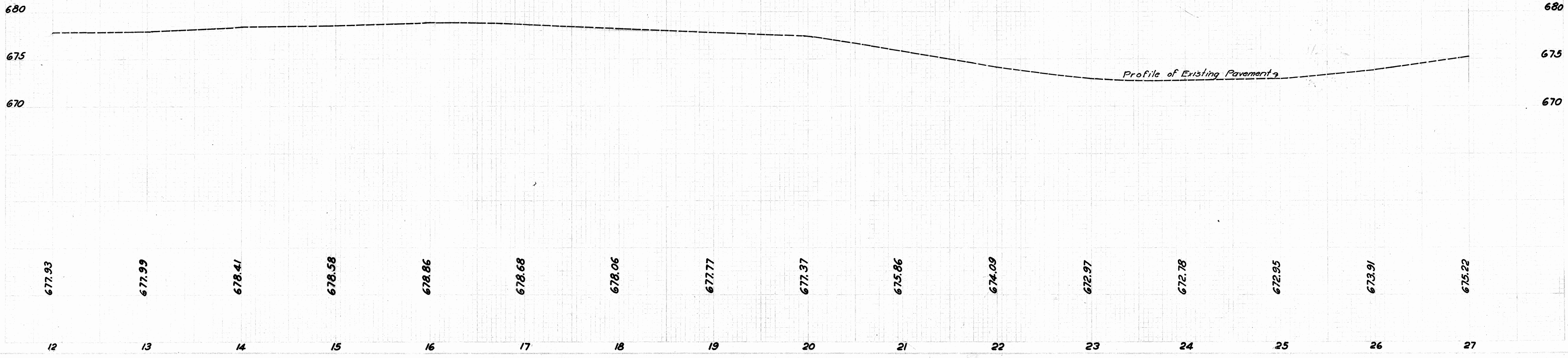

677.93 677.99 678.41 678.58 678.86 678.68 678.06 677.77 677.37 675.86 674.09 672.97 672.78 672.95 673.91 675.22

12 13 14 15 16 17 18 19 20 21 22 23 24 25 26 27

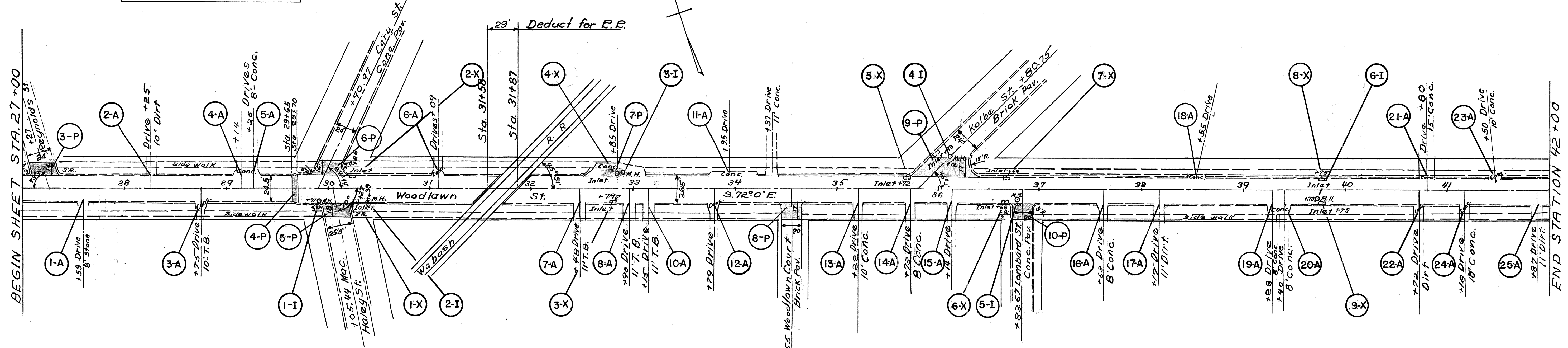
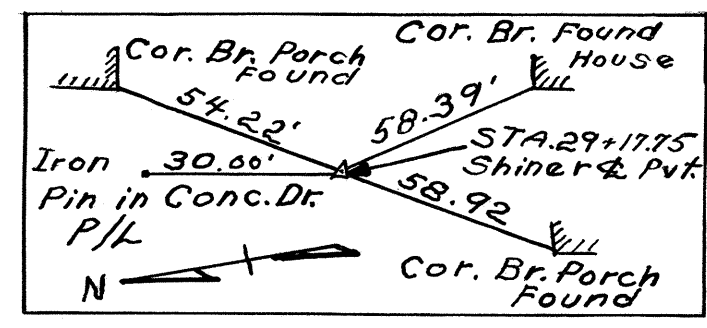

SIDE APPROACHES "A"
I-A TO 25-A No Work Required

EXTRA PAVEMENT "P"

Ref. No.	T-35 Sq. Yds.	B-35 Sq. Yds.
3-P	38	19
4-P	14	14
5-P	53	20
6-P	35	0
7-P	9	0
8-P	38	19
9-P	92	46
10-P	38	19
Total	317	137

INLETS "X"

Ref. No.	Remarks
1-X	Raise Grate
2-X	Raise Grate
3-X	Raise Grate
4-X	Raise Casting
5-X	Raise Grate
6-X	Raise Grate
7-X	Raise Grate
8-X	Raise Grate
9-X	Raise Grate

MANHOLES "I"

Ref. No.	Remarks
1-I	No Work
2-I	No Work
3-I	No Work
4-I	No Work
5-I	Raise Casting
6-I	Raise Casting

Top N.E. outside bolt R.R.
Blinker Found
Station 30+26
Elevation 679.84

* Center 1st Conc. Step to House
Station 37+33
Elevation 679.77

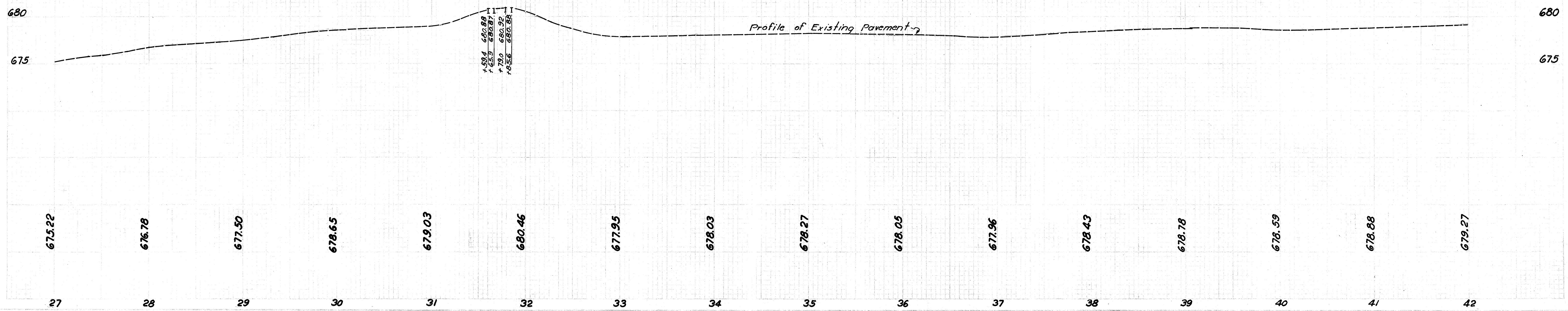

HENRY COUNTY
HEN-6-(11.87-13.13)

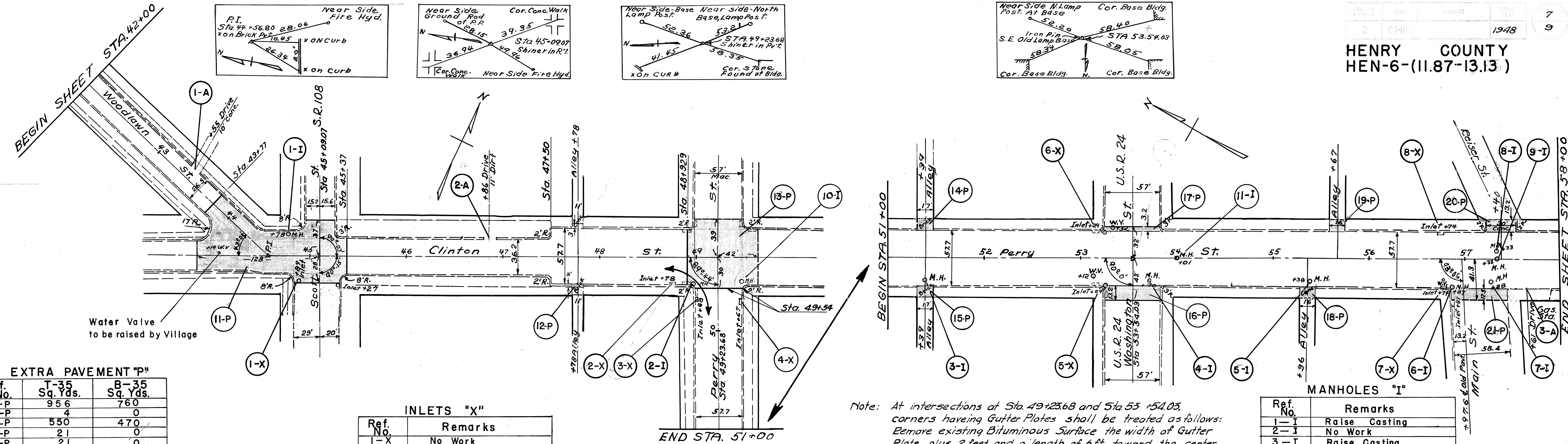

EXTRA PAVEMENT "P"

Ref. No.	T-35 Sq. Yds.	B-35 Sq. Yds.
11-P	95.6	76.0
12-P	4	0
13-P	550	470
14-P	21	0
15-P	21	0
16-P	83	40
17-P	21	0
18-P	21	0
19-P	21	0
20-P	44	20
21-P	81	40
Total	1,823	1,330

INLETS "X"

Ref. No.	Remarks
1-X	No Work
2-X	* Raise Casting & Grate
3-X	Raise Casting & Grate
4-X	Raise Casting & Grate
5-X	Raise Casting & Grate
6-X	No Work
7-X	Raise Grate
8-X	No Work
9-X	No Work

MANHOLES "I"

Ref. No.	Remarks
1-I	Raise Casting
2-I	No Work
3-I	Raise Casting
4-I	Raise Casting
5-I	Raise Casting
6-I	No Work
7-I	Raise Casting
8-I	Raise Casting
9-I	Raise Casting
10-I	Raise Casting
11-I	Raise Casting

Note: At intersections at Sta. 49+23.68 and Sta. 53+54.05, corners having Gutter Plates shall be treated as follows: Remove existing Bituminous Surface the width of Gutter Plate plus 2 feet and a length of 6 ft. toward the center of the Street, Resurface using T-35, Feather at Gutter Plates. Estimated area for Surface Removal at each Corner = 16 sq. Yds. 16 x 4 1/2 = 72 sq. yds.

x on Curb
Station 44+57
Elevation 683.27

*See detail on sheet 4.

x in Sidewalk
Station 49+64
Elevation 683.25

x S.W. Cor. lower Court
House Step
Station 54+95
Elevation 681.27

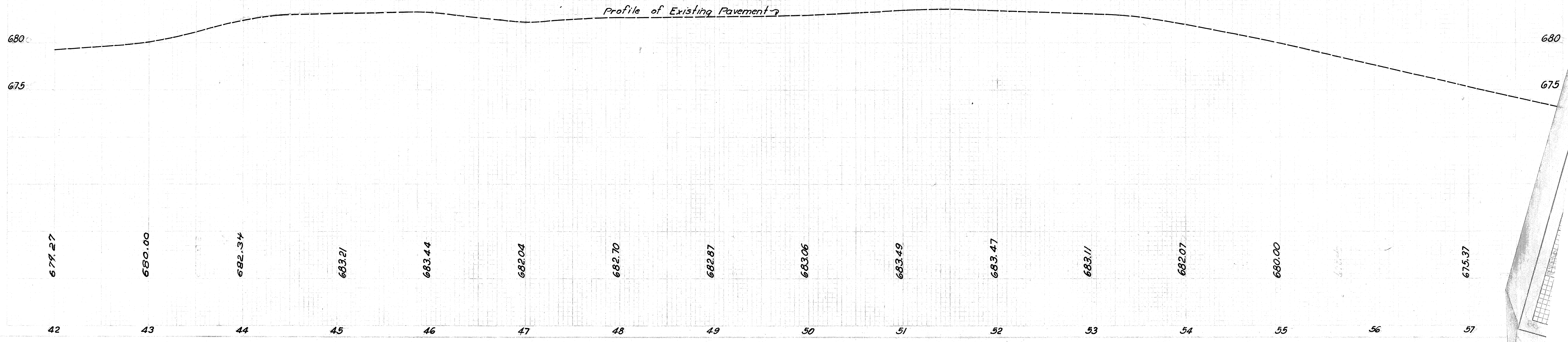

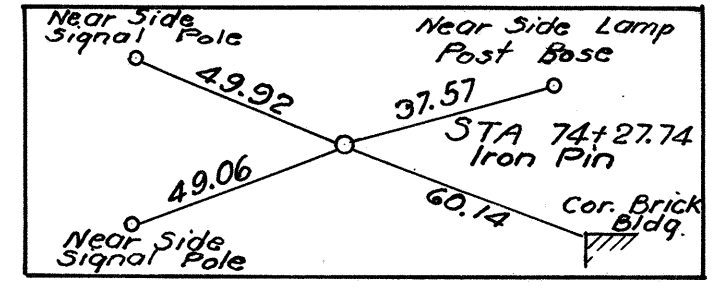
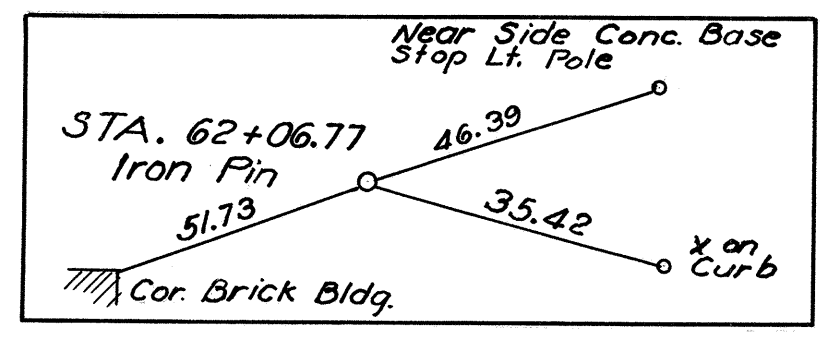
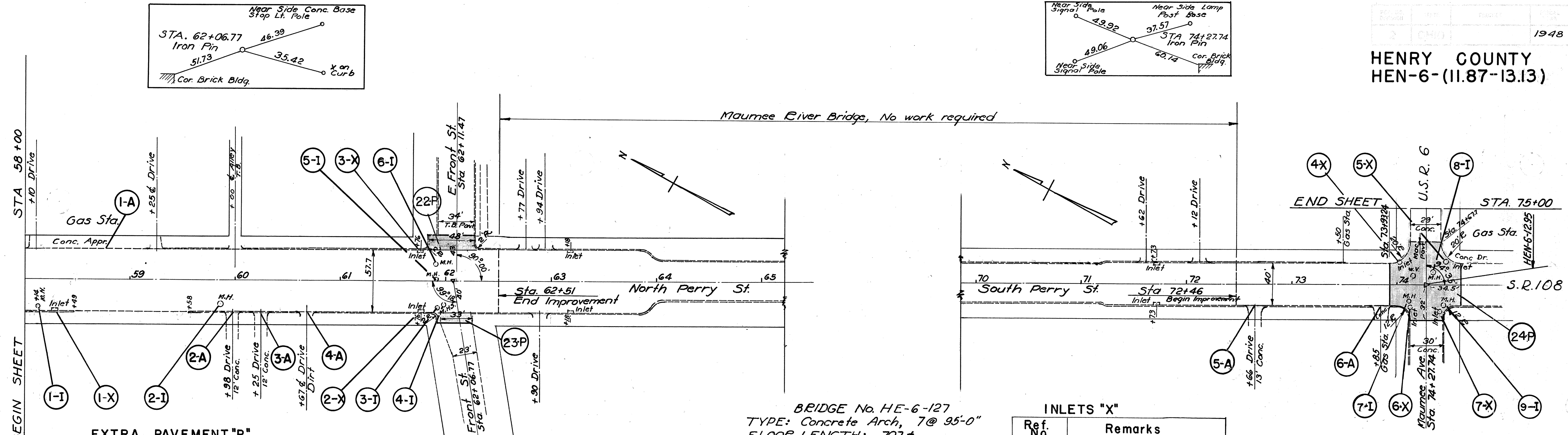

EXTRA PAVEMENT "P"

Ref. No.	T-35 Sq. Yds.	B-35 Sq. Yds.
22-P	70	30
23-P	39	18
24-P	438	360
Total	547	408

MANHOLES "I"

Ref. No.	Remarks
1-I	Raise Casting
2-I	" "
3-I	" "
4-I	" "
5-I	" "
6-I	" "
7-I	" "
8-I	" "
9-I	" "

SIDE APPROACHES "A"
1-A to 6-A No Work Required.

BRIDGE No. HE-6-127
TYPE: Concrete Arch, 7@ 95'-0"
FLOOR LENGTH: 707±
ROADWAY: 36'
SIDEWALKS: 2-5' wide
PAVEMENT: 3" Brick
LOADING: H-15

INLETS "X"

Ref. No.	Remarks
1-X	No Work
2-X	" "
3-X	" "
4-X	" "
5-X	" "
6-X	" "
7-X	" "

*N.W. Cor. Pump Island
Station 59+56
Elevation 669.76

*Inside Edge Sidewalk
Station 64+07
Elevation 667.03

*Inside Edge Sidewalk
Station 71+22
Elevation 667.00

*S.E. Cor. Conc. pump Is
Sta. 74+58
Elevation 670.32

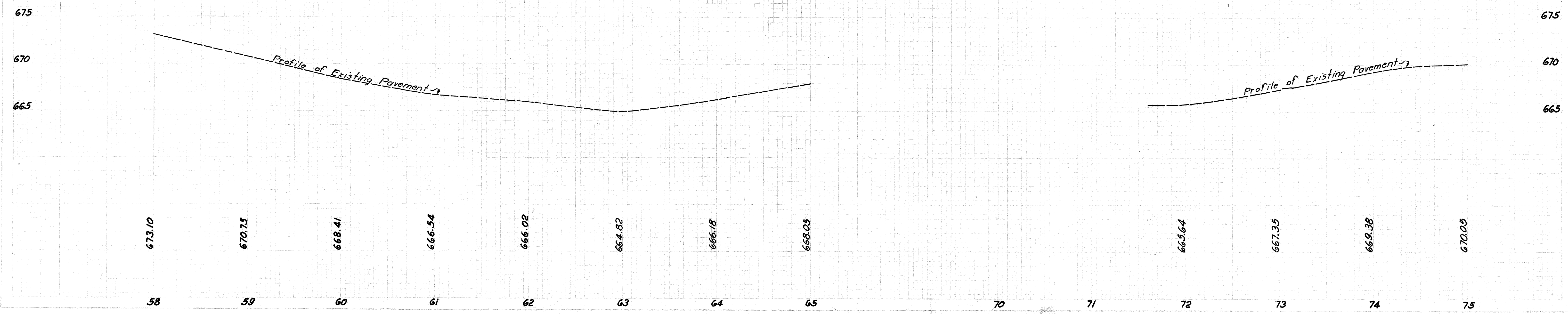

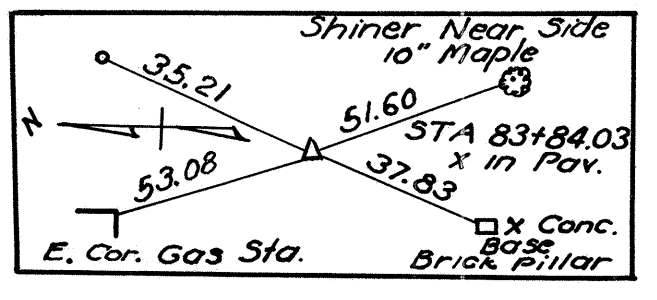

BEGIN SHEET STA. 75+00

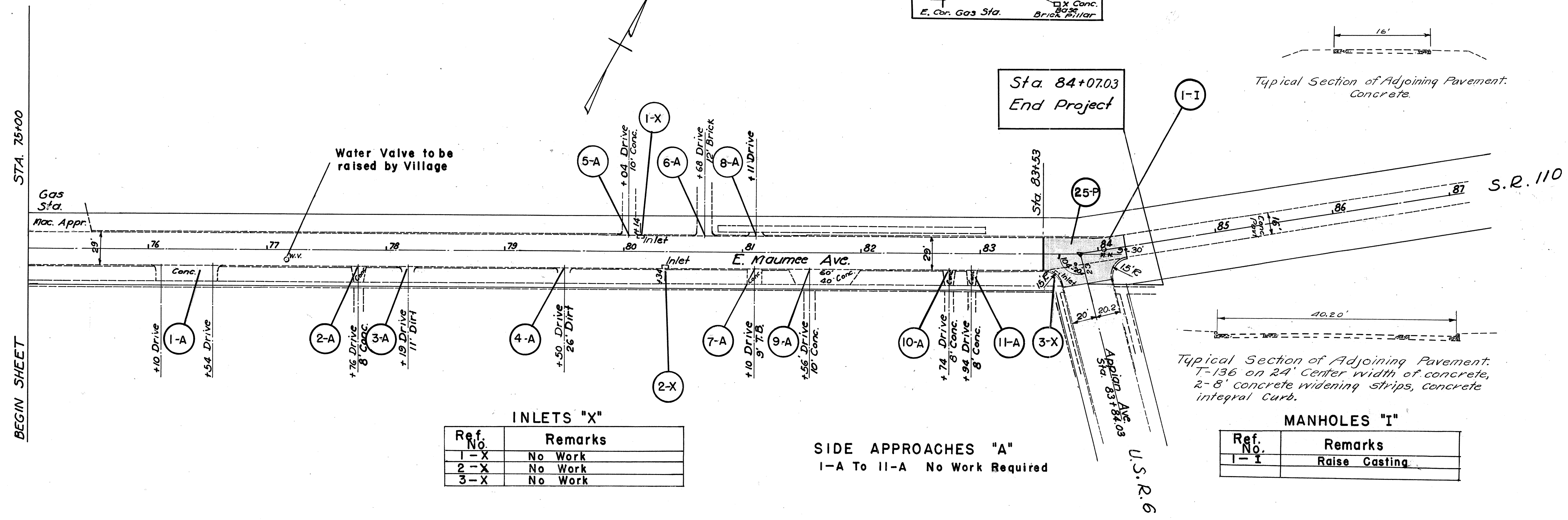

Typical Section of Adjoining Pavement: Concrete.

Typical Section of Adjoining Pavement: T-136 on 24' Center width of concrete, 2-8' concrete widening strips, concrete integral curb.

INLETS "X"

Ref No.	Remarks
1-X	No Work
2-X	No Work
3-X	No Work

SIDE APPROACHES "A"
1-A To 11-A No Work Required

MANHOLES "I"

Ref. No.	Remarks
1-I	Raise Casting

EXTRA PAVEMENT "P"

Ref. No.	T-35 Sq. Yds.	B-35 Sq. Yds.	T-30 Sq. Yds.
25-P	260	170	260
TOTAL	260	170	260

* N.W. Cor. Step to Bldg.
Station 76+61
Elevation 672.34

* Center E. end pump Is.
Sta. 83+58
Elevation 672.77

