

O.D.O.T. DISTRICT 2 SURVEY OFFICE (USE ONLY)

PERSONNEL _____ REFERENCE NO. 36 C SHEET 29 OF 36
 NOTES BARNHISEL DATE 9/28/90 ROUTE SR 109
 H.C. BARNHISEL WEATHER CLEAR COUNTY HENRY
 R.C. HOFFMAN TEMP. 65° TOWNSHIP HARRISON
 SECTION 11
 DWG BY RHOADES PID CHIP SEAL T 5 N R 7 E

TYPE MONUMENT P.K./WASHER
 ON SURFACE - ~~BELOW~~ ON _____
 OFFSET Q PAVEMENT 5.9' LT : ~~RT~~
6.1' TO LT EDGE PAVEMENT
 STATION: 887+71.94

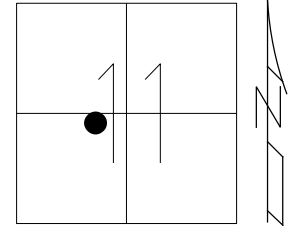

HORZ. DATUM: _____ GEOID: _____
 GRID: NORTHING: _____ EASTING: _____

RECORD: P.I.
 $\Delta=9^{\circ}36'$ RT
 FD P.K./WASHER
 9/28/90, MB
 SET P.K./WASHER
 10-11-90, MB
 D.N.F.
 8/31/15, JFO

NOTE: REF 13 A SR 110

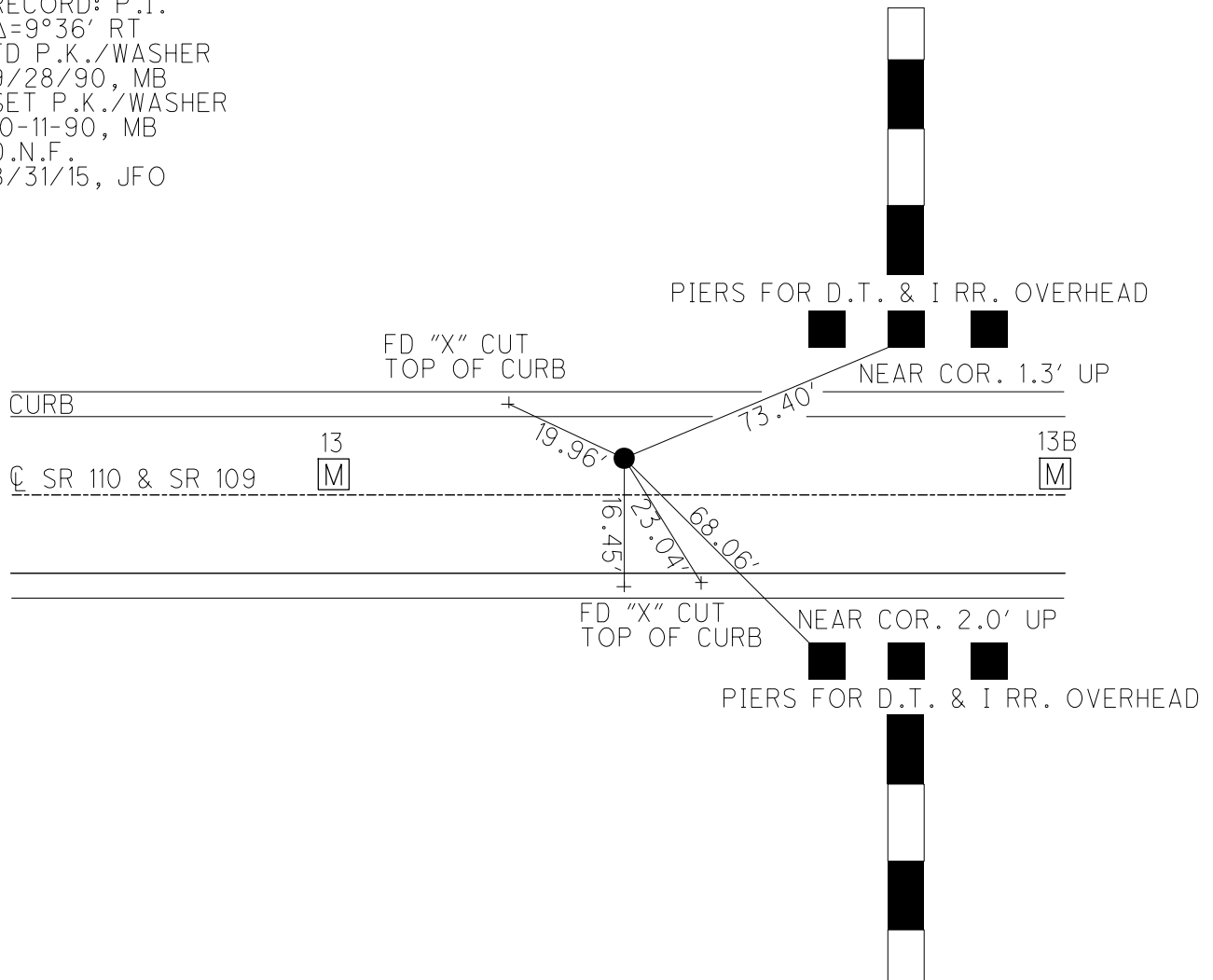

O.D.O.T. DISTRICT 2 SURVEY OFFICE

PERSONNEL _____

REFERENCE NO. 13/SR 110

SHEET _____ OF _____

NOTES HOMAN

H.C. HOMAN

R.C. BEAUMONT

DATE 8-13-02

WEATHER SUNNY

TEMP. 80°

ROUTE 109 + 110

COUNTY HENRY

TOWNSHIP HARRISON

SECTION 11

T 5 N R 7 E

TYPE MONUMENT PK + WASHER

ON SURFACE - BELOW YES

LEFT - ϕ PAV'T. - RIGHT 5.9'

6.1 TO LT. EDGE PAVEMENT

S.L.M. 887+59

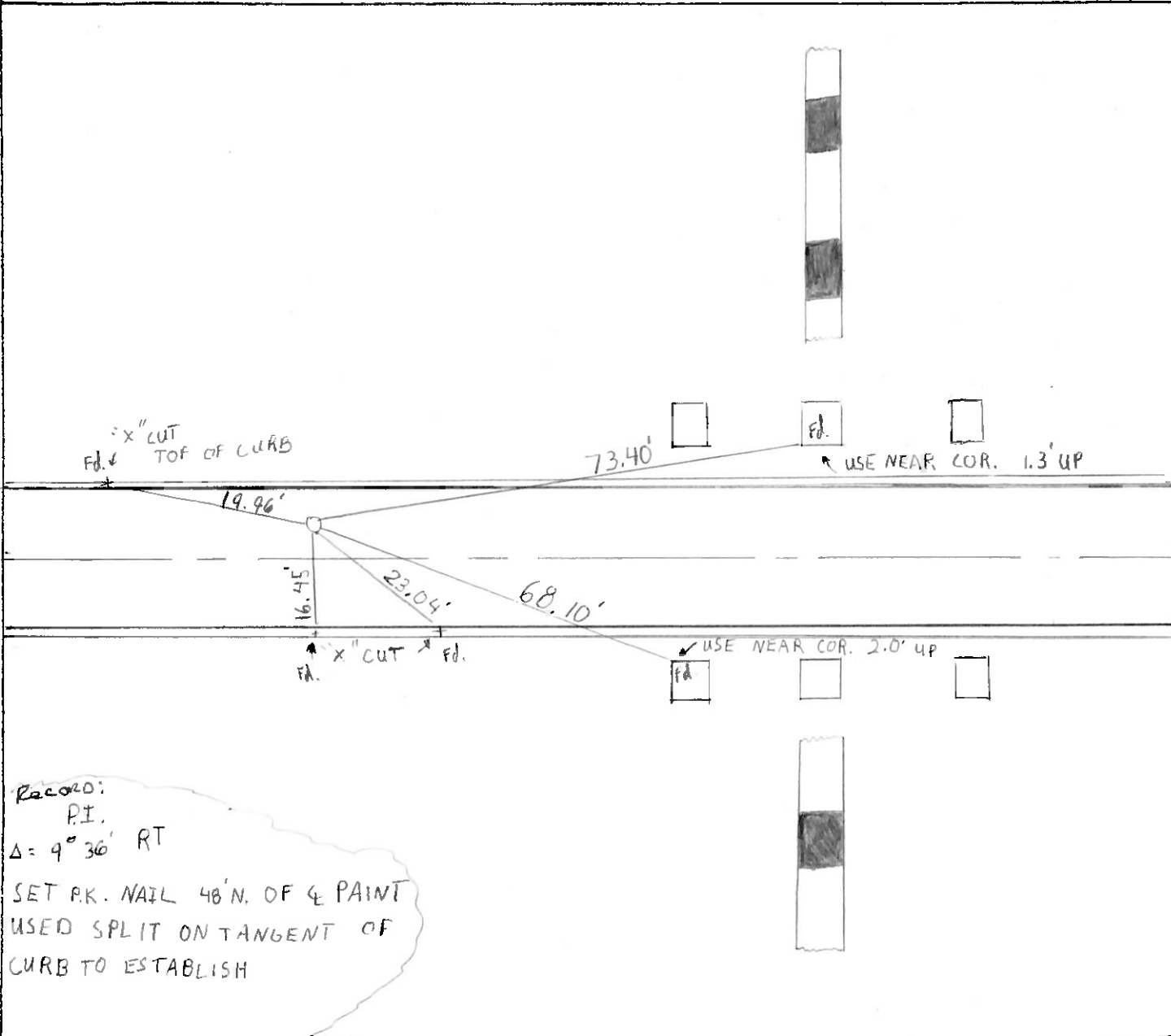
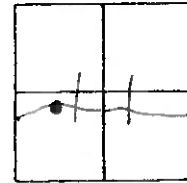

O.D.O.T. DISTRICT 2 SURVEY OFFICE (USE ONLY)

PERSONNEL _____ REFERENCE NO. 36 B SHEET 29 OF 38

NOTES BARNHISEL DATE 9-28-90 ROUTE SR 109
 H.C. BARNHISEL WEATHER CLEAR COUNTY HENRY
 R.C. HOFFMAN TEMP. 65°F TOWNSHIP HARRISON
 SECTION 11
 T 5 N R 7 E

TYPE MONUMENT PK/WASHER
 ON SURFACE - ~~BELOW~~ ON _____
 LEFT - ☉ PAV'T - ~~RIGHT~~ 5.9'
6.1' TO LT EDGE PAVEMENT
 S.L.M. 887+59
 Grid: Northing: - _____ Easting: - _____

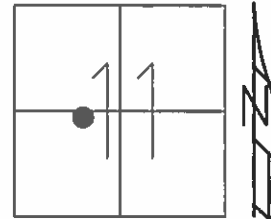

RECORD:
 P.I. $\Delta=9^{\circ}36'$ RT
 USED SPLIT ON TANGENT
 OF CURB TO ESTABLISHED
 SET PK/WASHER
 10-11-90, MB

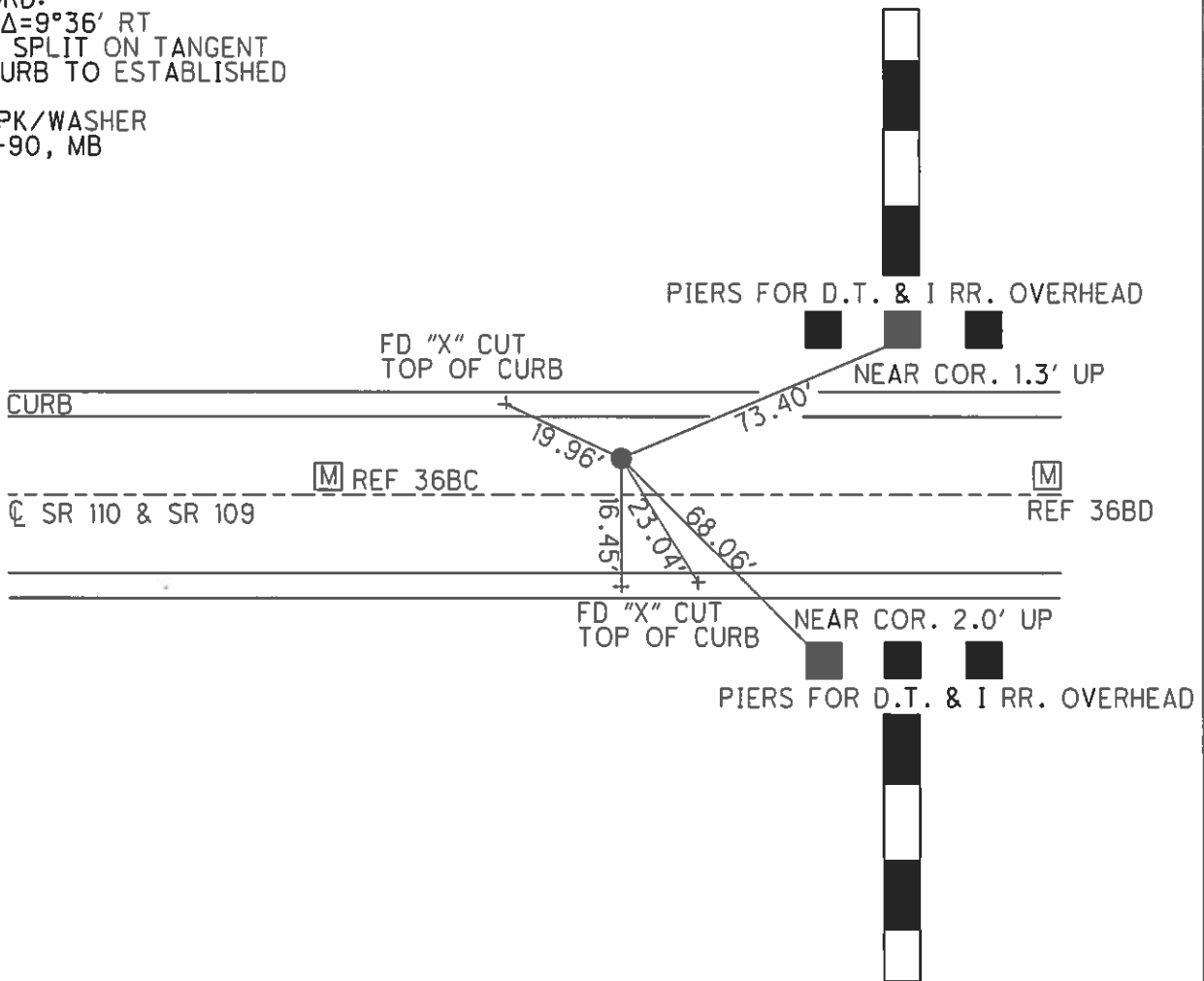

O.D.O.T. DISTRICT 2 SURVEY OFFICE

PERSONNEL

REFERENCE NO. 13/SR 110
36 B

SHEET 3 OF 9

NOTES BARNHISEL

H.C. " "

R.C. HOFFMAN

DATE 9-28-90

WEATHER clear

TEMP. +65°

ROUTE 109 & 110

COUNTY Henry

TOWNSHIP HARRISON

SECTION 11

T 5 N R 7 E

TYPE MONUMENT PK & Washer

ON SURFACE - ~~BELOW~~ YES

LEFT- & PAV'T. - RIGHT 5.9

6.1 TO RT EDGE PAVEMENT

S.L.M. 887 + 59

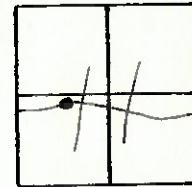

RECORD: P.I.
 $\Delta = 7^{\circ} 36' RT$
SET P.K. NAIL 4.8' N. OF & PAVT
USED SPIT ON TARGET OF
CURB TO ESTABLISH

Set P.K. & Washer
10-11-90
MB

NOTE:
ALL TIES CROSS
NO NAIL FD.
8-13-93
D.H.

