

O.D.O.T. DISTRICT 2 SURVEY OFFICE (USE ONLY)

PERSONNEL

REFERENCE NO. 51 A

SHEET 23 OF 31

NOTES NIESE DATE 3/5/21
 H.C. RHOADES WEATHER SUNNY
 R.C. _____ TEMP. 30°

ROUTE SR 109
 COUNTY HENRY
 TOWNSHIP LIBERTY
 SECTION 13
 T 6 N R 7 E

DWG BY NIESE PID PAVE TRAIN

TYPE MONUMENT MAG/WASHER

ON SURFACE - ~~BELOW~~ ON

OFFSET ☉ PAVEMENT ON LT : RT

10' TO LT EDGE PAVEMENT

STATION: 1237+04.1

HORZ.DATUM: NAD83 2011

GEOID: NAVD88 2012A

GRID: NORTHING: 664160.667

EASTING: 1555110.592

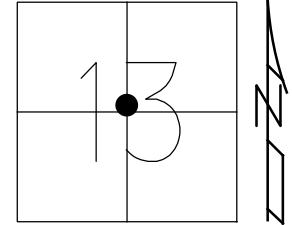

RECORD:
 FD P.K./WASHER
 9/9/02, DCH
 SET MAG/WASHER
 12/10/02, DCH
 FD MAG/WASHER
 2/27/19, JLL
 FD MAG/WASHER
 REFA51
 6/10/20, JFO
 3/5/21,
 1/11/23, JMR

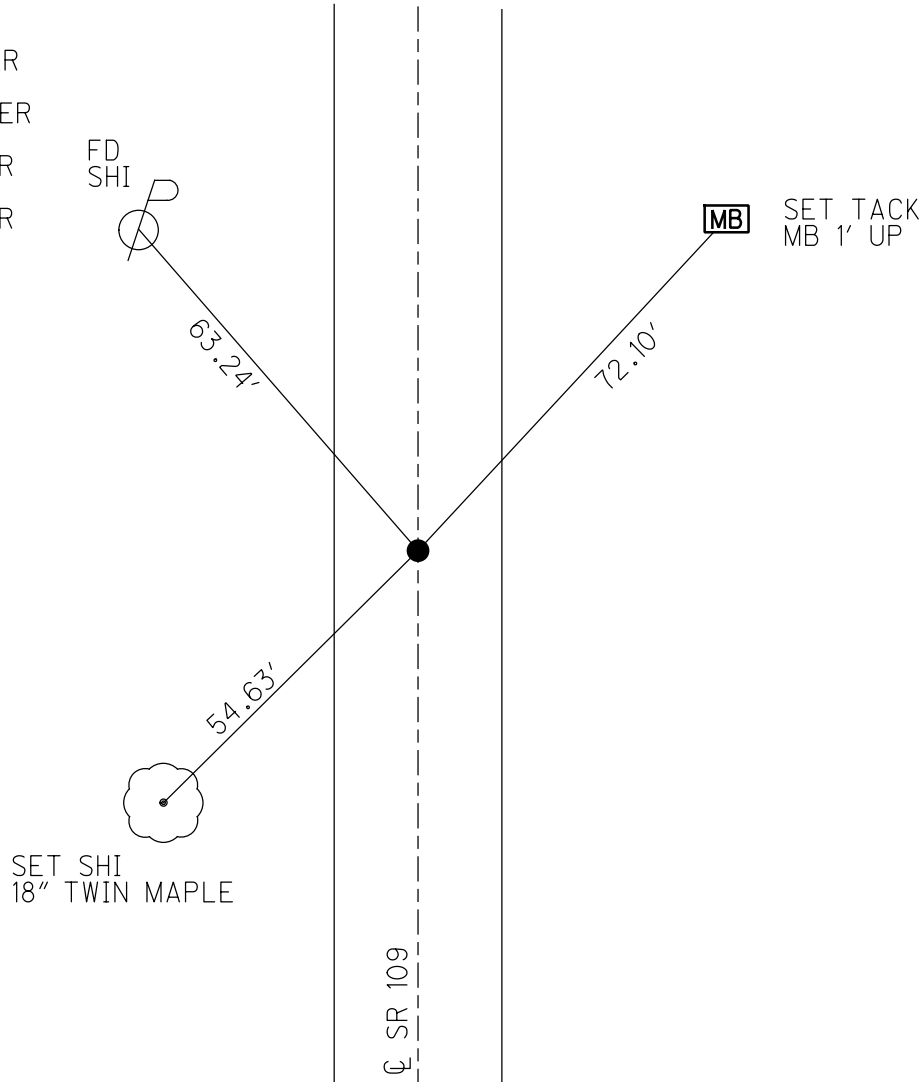

O.D.O.T. DISTRICT 2 SURVEY OFFICE (USE ONLY)

PERSONNEL _____ REFERENCE NO. 51 A SHEET 23 OF 31
 NOTES NIESE DATE 3/5/21 ROUTE SR 109
 H.C. RHOADES WEATHER SUNNY COUNTY HENRY
 R.C. _____ TEMP. 30° TOWNSHIP LIBERTY
 DWG BY NIESE PID PAVE TRAIN SECTION 13
 T 6 N R 7 E

TYPE MONUMENT MAG/WASHER
 ON SURFACE - ~~BELOW~~ ON
 OFFSET \varnothing PAVEMENT ON LT : RT
10' TO LT EDGE PAVEMENT
 STATION: 1237+07

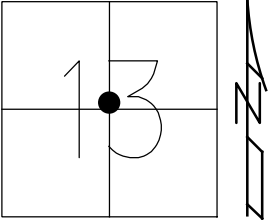

HORZ.DATUM: NAD83 2011 GEOID: NAVD88 2012A
 GRID: NORTHING: 664160.667 EASTING: 1555110.592

RECORD:
 FD P.K./WASHER
 9/9/02, DCH
 SET MAG/WASHER
 12/10/02, DCH
 FD MAG/WASHER
 2/27/19, JLL
 FD MAG/WASHER
 REFA51
 6/10/20, JFO
 3/5/21, JMR

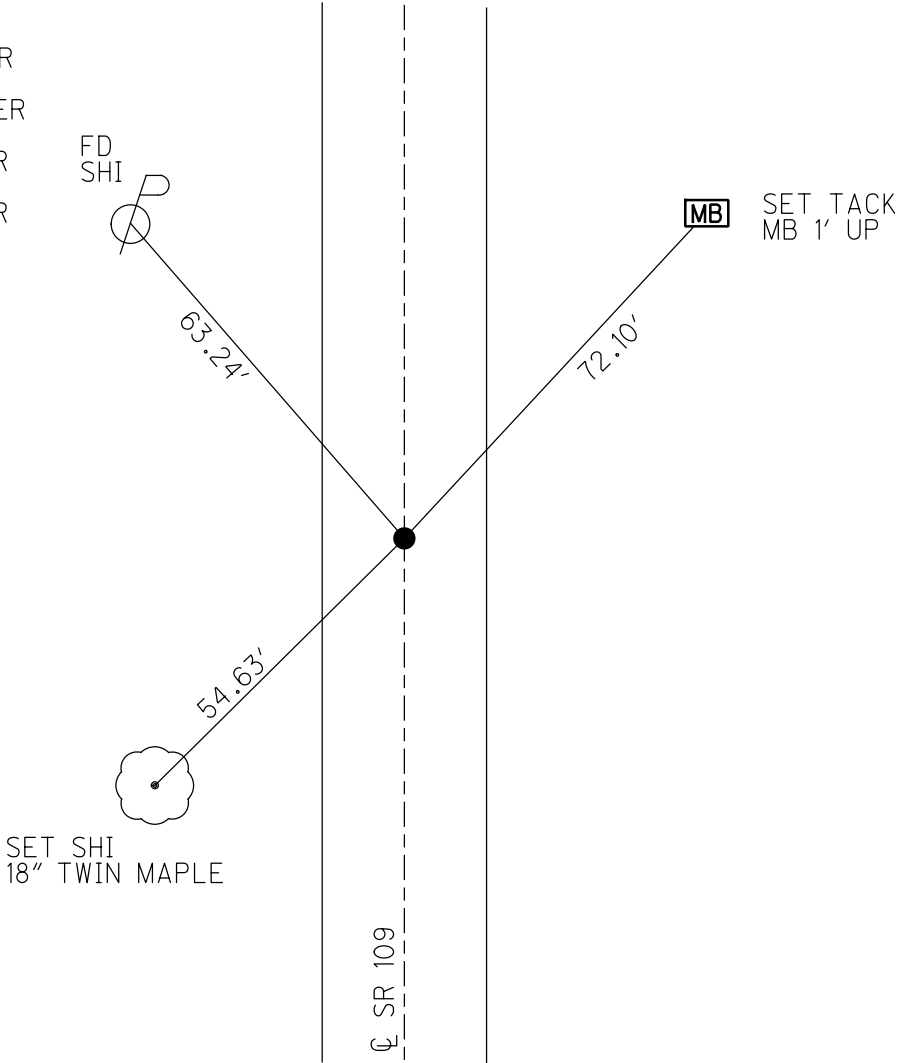

O.D.O.T. DISTRICT 2 SURVEY OFFICE

PERSONNEL

REFERENCE NO. 51
A, B, C

SHEET 21 OF 27

NOTES HOMAN

DATE 9-9-02

ROUTE S.R. 109

H.C. HOMAN

WEATHER SUNNY

COUNTY HENRY

R.C. BROWN

TEMP. 75

TOWNSHIP LIBERTY

SECTION 13

T 6 N R 7 E

TYPE MONUMENT PK & WASHER

ON SURFACE - ~~BELOW~~ ON

~~LEFT - Q PAV'T - RIGHT~~ ON

10' TO LT EDGE PAVEMENT

S.L.M. 1237+07 PT A

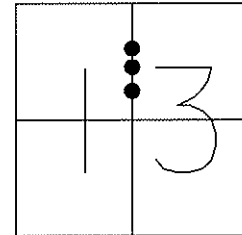

SET MAG NAIL IN Q DRIVE

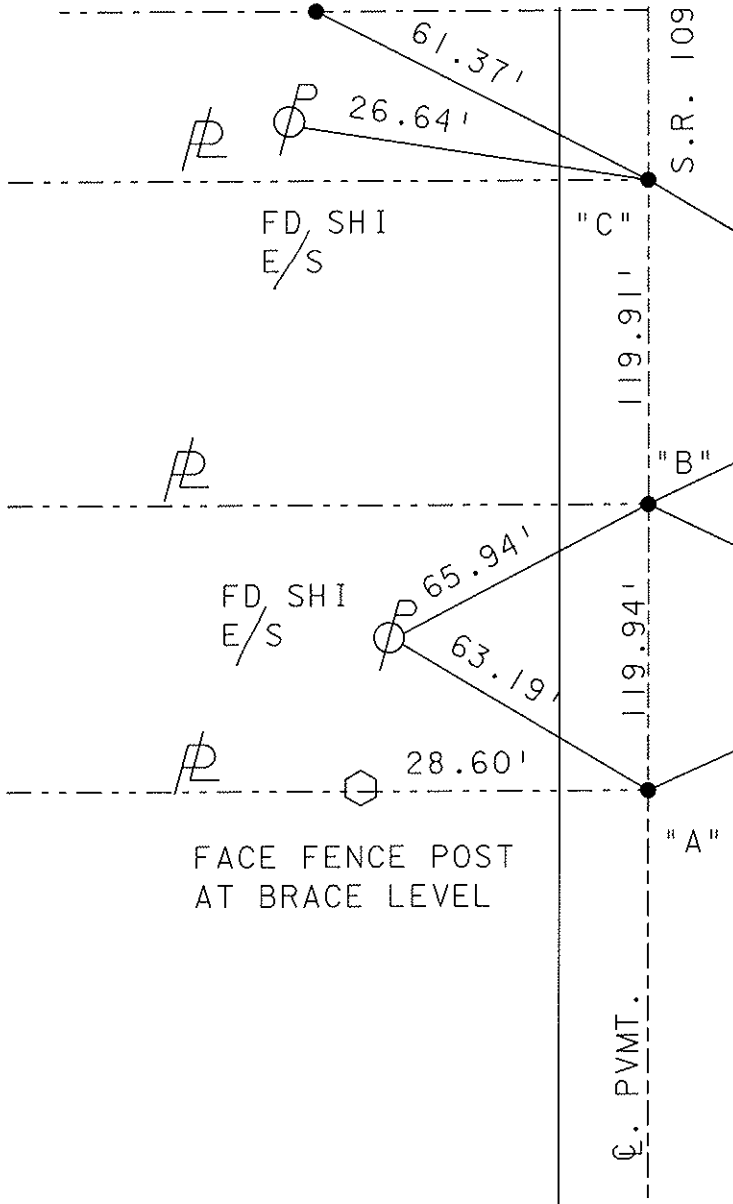

SET MAG NAIL
& WASHER
12-10-02
DCH

[MB] SET TACK
MB 1' UP

[MB] SET TACK
MB 1' UP

Fd R.R. SPIKE
1/2" down

O.D.O.T. DISTRICT 2 SURVEY OFFICE

PERSONNEL _____

REFERENCE NO. 51
A, B, C

SHEET _____ OF _____

NOTES VAN DUSEN

H.C. BARNHISEL

R.C. KUSZ

DATE 8-12-92

WEATHER CLEAR

TEMP. + 75° F

ROUTE S.R. 109

COUNTY HENRY

TOWNSHIP LIBERTY

SECTION 13

T 6 N R 7 E

TYPE MONUMENT P.K.'S & WASHERS
ON SURFACE - BELOW YES
LEFT - & PAV'T. - RIGHT YES
10.4 TO LT. EDGE PAVEMENT
S.L.M. P.T. A 1237+07

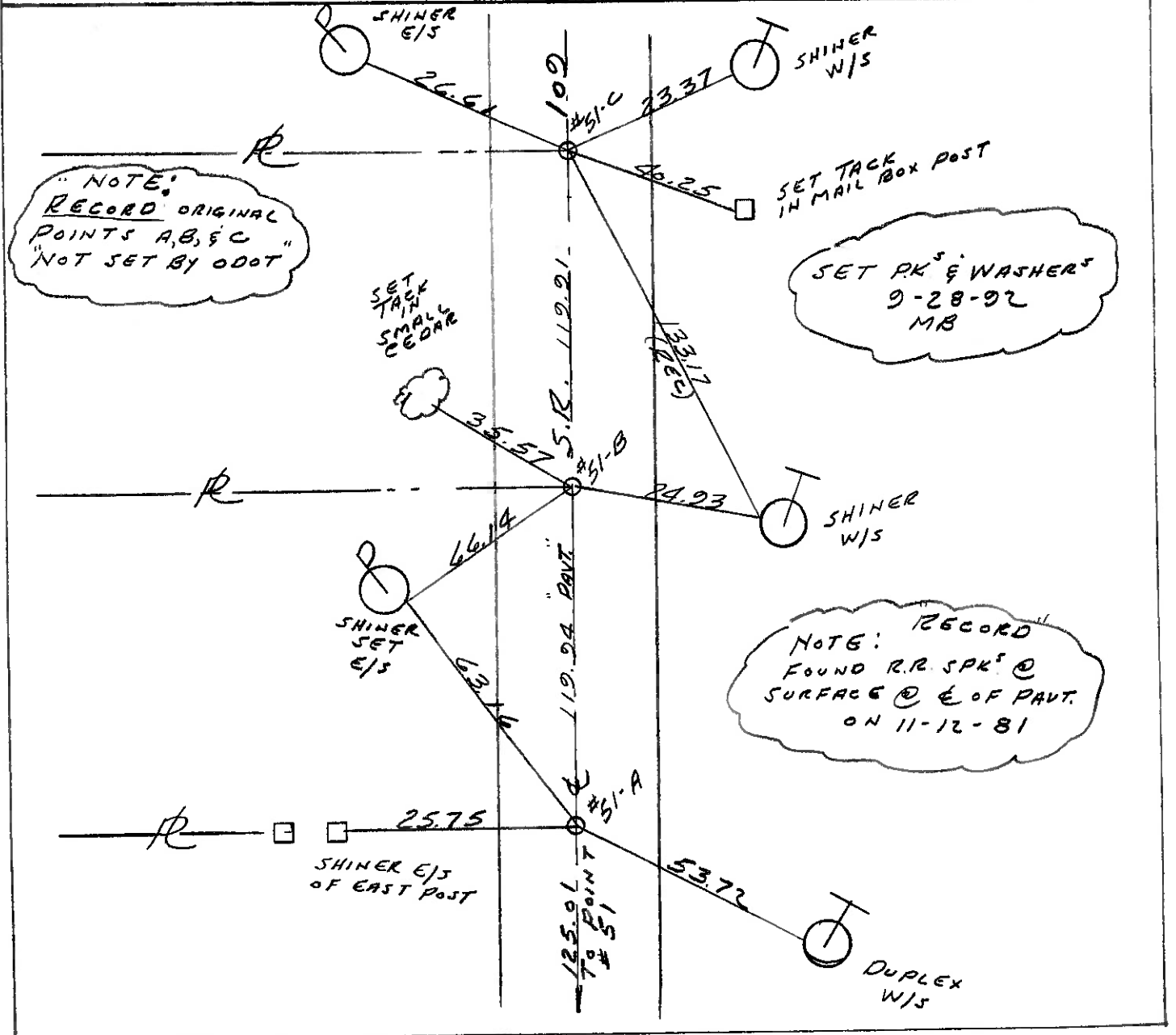
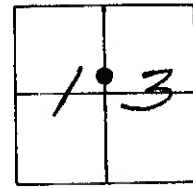

OD.O.T. DISTRICT 2 SURVEY OFFICE

SHEET _____ OF _____

County Henry S.R. 109

Date 11-12-81

Township Liberty

Weather Clear

Section 13

Temp. +48°

T6N, R7E

Personnel Hoffman

Householder

Loehrke

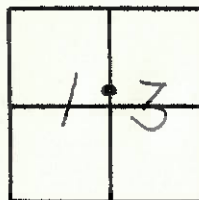

#51-a, b & c Not set by ODOT

RE-SET P.K. & WASHER @ ALL PTS.

5-18-82
S.W.M.

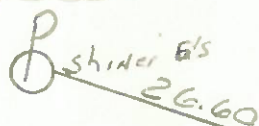

#51-C
R.R. SPK/+ @ surface
@ & of PAUT.

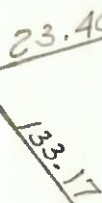

#51-B
Severly Bent
R.R. SPK @ surface
@ & of PAUT.



Shiner W/S m.B. Post
#1 V-559

Shiner W/S

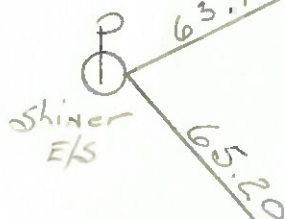

Shiner W/S of m.B. Post
Roger Carpenter

#51-A
R.R. SPK @
SURFACE @
& of PAUT.

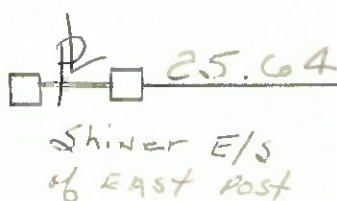

125.01
To point
#51

