

O.D.O.T. DISTRICT 2 SURVEY OFFICE (USE ONLY)

PERSONNEL \_\_\_\_\_ REFERENCE NO. 7 A SHEET 22 OF 51

NOTES MILLER DATE 3/13/24 ROUTE SR 110  
 H.C. NIESE WEATHER CLEAR COUNTY HENRY  
 R.C. RHOADES TEMP. 55° TOWNSHIP HARRISON  
 SECTION 8

DWG BY RHOADES PID 94321 T 5 N R 7 E

TYPE MONUMENT MAG/WASHER

ON SURFACE - ~~BELOW~~ ON \_\_\_\_\_

OFFSET  $\odot$  PAVEMENT 10.0'  $\pm$  : RT

1.5' TO LT EDGE PAVEMENT

S.L.M. 154+34

HORIZ.DATUM: NAD83 (2011) GEOID: NAVD88 2018

GRID: NORTHING: 637078.629 EASTING: 1534750.366

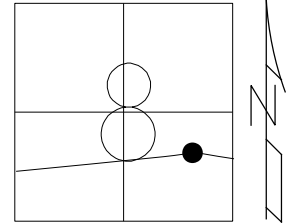

RECORD: P.O.T.  
 FD P.K./WASHER  
 4/24/03, MB  
 SET MAG/WASHER  
 6/19/03, MB  
 FD HOLE  
 REFA7  
 5-05-21, JFO  
 FD MAG/WASHER  
 REF7A  
 8/18/23, TDN  
 SET MAG/WASHER  
 3/13/24, TDN

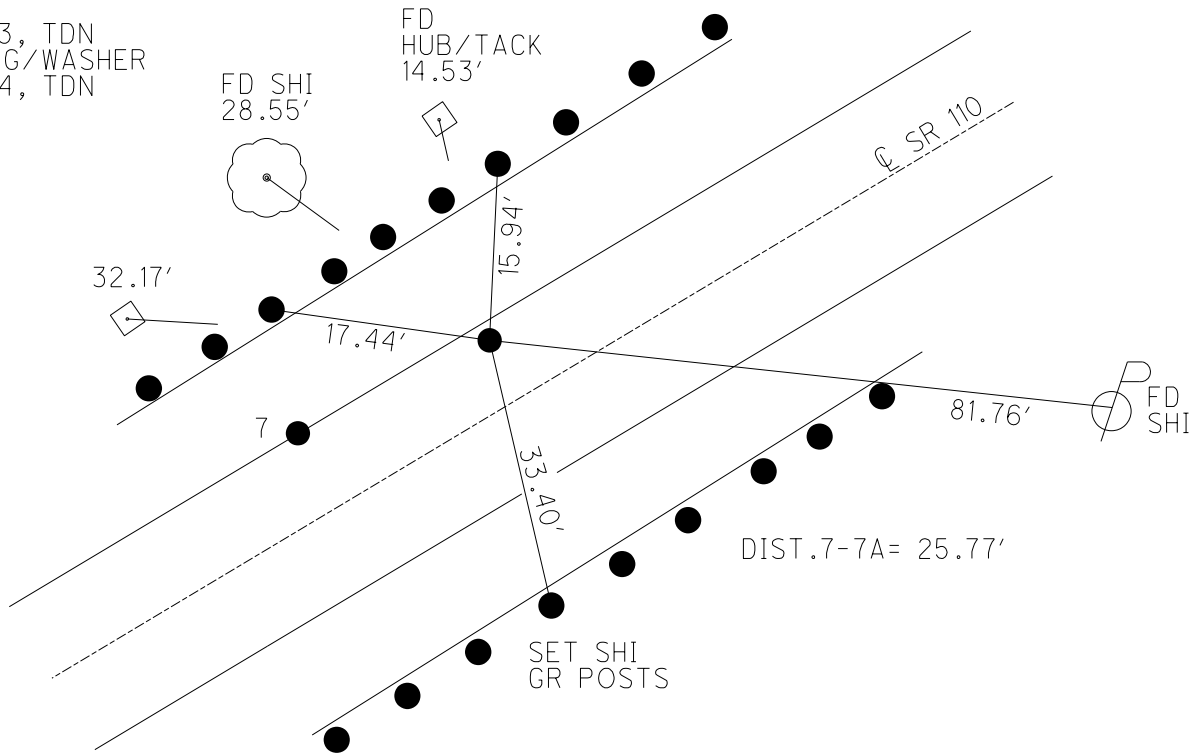

**O.D.O.T. DISTRICT 2 SURVEY OFFICE (USE ONLY)**

PERSONNEL \_\_\_\_\_ REFERENCE NO. 7 A SHEET 15 OF 44  
 NOTES ASTON DATE 8/18/23 ROUTE SR 110  
 H.C. NIESE WEATHER CLEAR COUNTY HENRY  
 R.C. RHOADES TEMP. 75° TOWNSHIP HARRISON  
 \_\_\_\_\_ AUBLE \_\_\_\_\_ SECTION 8  
 DWG BY RHOADES PID 94321 T 5 N R 7 E

TYPE MONUMENT MAG/WASHER  
 ON SURFACE - ~~BELOW~~ ON \_\_\_\_\_  
 OFFSET  $\odot$  PAVEMENT 10.0' ~~LT~~ : RT  
1.5' TO LT EDGE PAVEMENT  
 S.L.M. 154+34

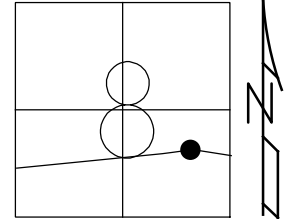

HORIZ.DATUM: NAD83 (2011) GEOID: NAVD88 2018  
 GRID: NORTHING: 637078.629 EASTING: 1534750.366

RECORD: P.O.T.  
 FD P.K./WASHER  
 4/24/03, MB  
 SET MAG/WASHER  
 6/19/03, MB  
 FD HOLE  
 REFA7  
 5-05-21, JFO  
 FD MAG/WASHER  
 REF7A  
 8/18/23, TDN

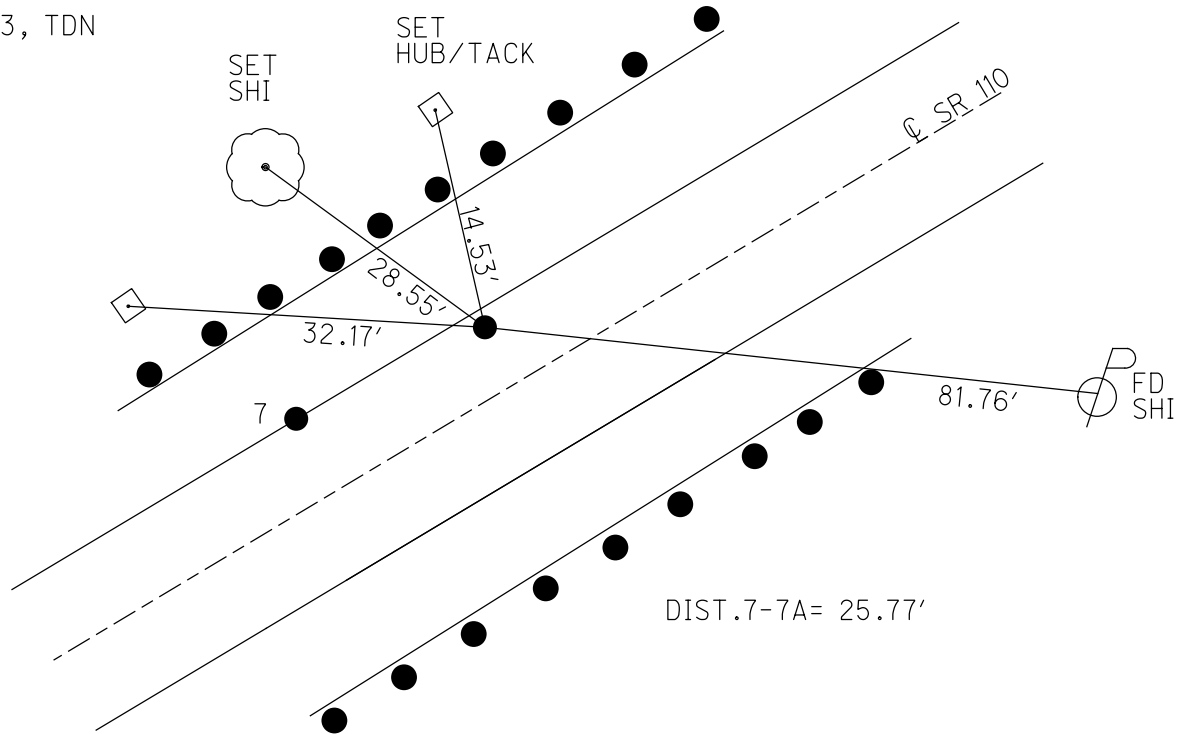

O.D.O.T. DISTRICT 2 SURVEY OFFICE

PERSONNEL

REFERENCE NO. 7

SHEET 4 OF 26

NOTES BARNHISEL  
 H.C. CANTERBURY  
 R.C. BARNHISEL  
BRUMBAUGH

DATE 4-24-03  
 WEATHER CLEAR  
 TEMP. +60°

ROUTE S.R. 110  
 COUNTY HENRY  
 TOWNSHIP HARRISON  
 SECTION 8  
T 5 N R 7 E

TYPE MONUMENT "A" SM. R.R. SPIKE ---- "B" P.K. NAIL & WASHER

ON SURFACE - ~~BELOW~~ YES

LEFT-Q PAV'T 11.5' PT "A" / "B" 10.0' LT

"A" ON LT. EDGE PAVEMENT

S.L.M. "A" 153+92 / "B" 154+18

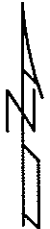
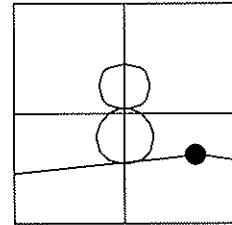

RECORD P.I. (PT. "A")

STA. 159+19.97

DELTA = 7°-09' RT.

D = 1°

T = 357.97'

POINT "B" = POT

L = 715.00'

E = 11.17'

R = 5729.58'

RESET MAG NAILS & WASHERS

6-19-03

MB

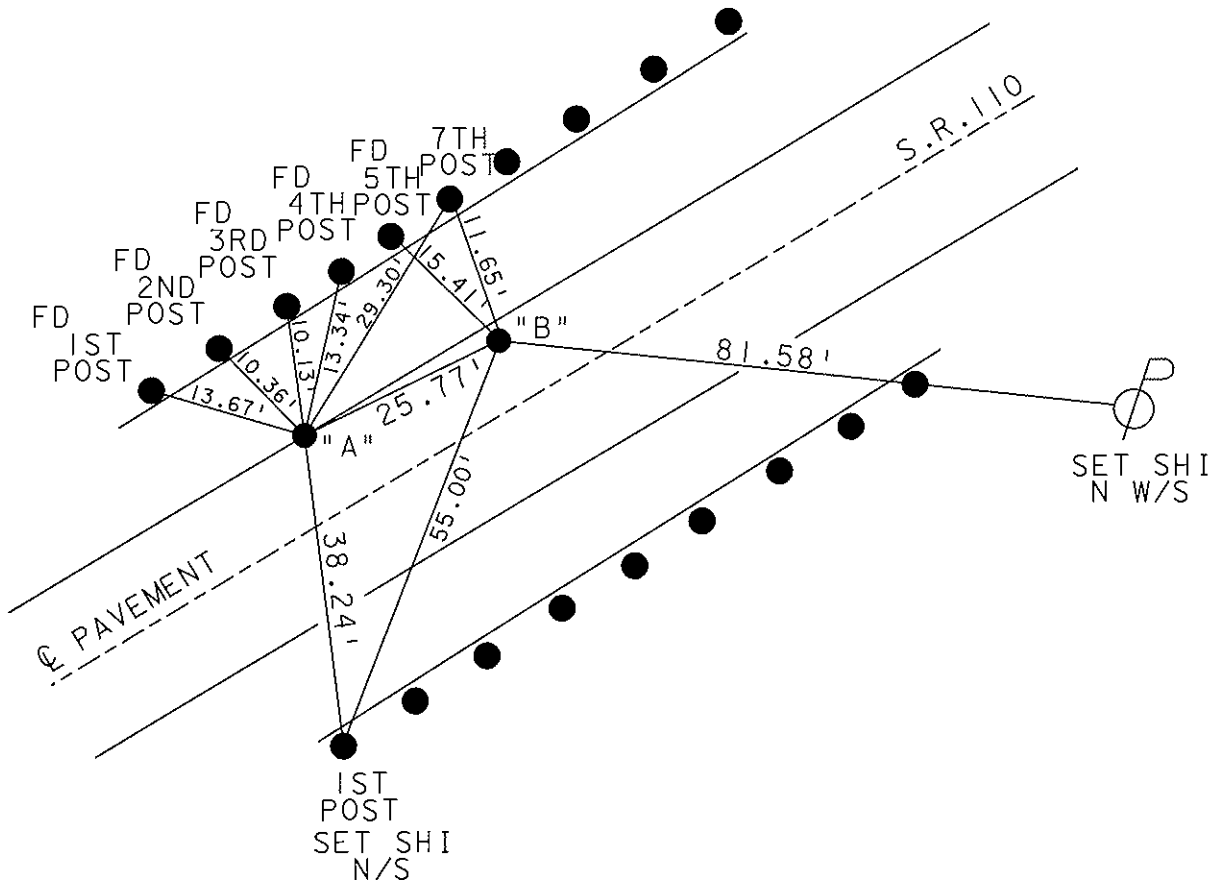

# O.D.O.T. DISTRICT 2 SURVEY OFFICE

PERSONNEL

REFERENCE NO. 7

SHEET 12 OF 34

NOTES LOEHRKE

H.C. CURTIS

R.C. ROMETO

DATE 5-27-92

WEATHER Pt Cloudy

TEMP. +60

ROUTE S.R. 110

COUNTY HENRY

TOWNSHIP HARRISON

SECTION 8

T5 N R 7 E

Reset SAME 10-27-92

TYPE MONUMENT "A" 5m RR spike B: P.K. Nail

ON SURFACE - ~~BELOW~~ Yes

LEFT- & PAV'T. - ~~RIGHT~~ 11.5 pt. A

~~ON TO~~ LT. EDGE PAVEMENT

S.L.M. "A" 153+92 154+18

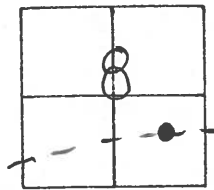

REC. P.I. (Pt. "A")

Pt "B" = P.D.T.

Sta 159+19.97

$\Delta = 7^{\circ}09' \text{ Rt.}$

$D = 1^{\circ}$

$T = 357.97'$

$L = 715.00'$

$E = 11.17'$

$R = 5729.58'$

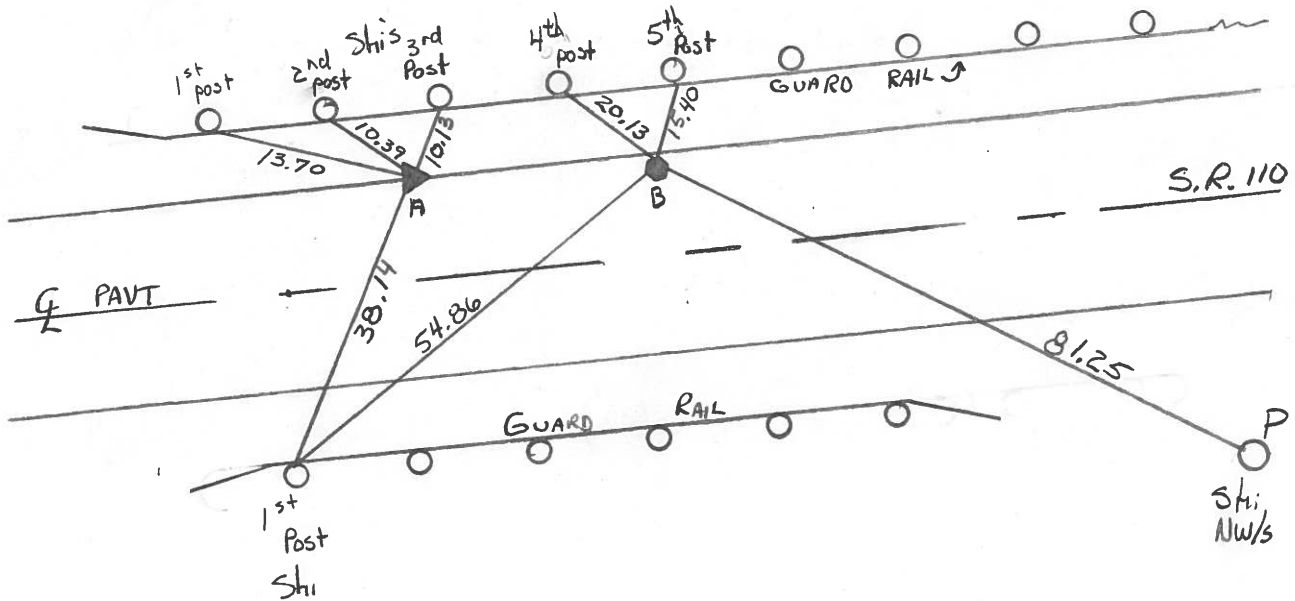

ODOT. DISTRICT 2 SURVEY OFFICE

SHEET \_\_\_\_\_ OF \_\_\_\_\_

County HENRY S.R. 110

Date 1-9-84

Township HARRISON

Weather CLOUDY, FLURRIES

Section 8

Temp. +28

T5N, R2E

Personnel BARNHISEL

HOUSEHOLDER

LOEHARKE

7

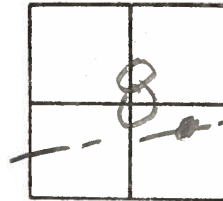

Pt "A" PI SIM 154+04

3/4" PIPE 1" Below SURFACE

ON WEP

115 LPOF & SR110

Pt B POT

SLM 154+30

SMALL RR SPIKE 1" Bel

1.6 to WEP

9.9 LPOF & SR110

DISTANCE Between 25.73

P.I. STA 159+19.97

$\Delta = 7^{\circ}09' RT$

$D = 1^{\circ}$

$T = 357.97'$

$L = 715.00'$

$E = 11.17'$

$R = 5729.58'$

Pt. "A"  
SET SMALL R.R. SPK.  
6/13/84 M.D.B.

Pt. "B"  
SET P.K./WASHER  
6/13/84 M.D.B.

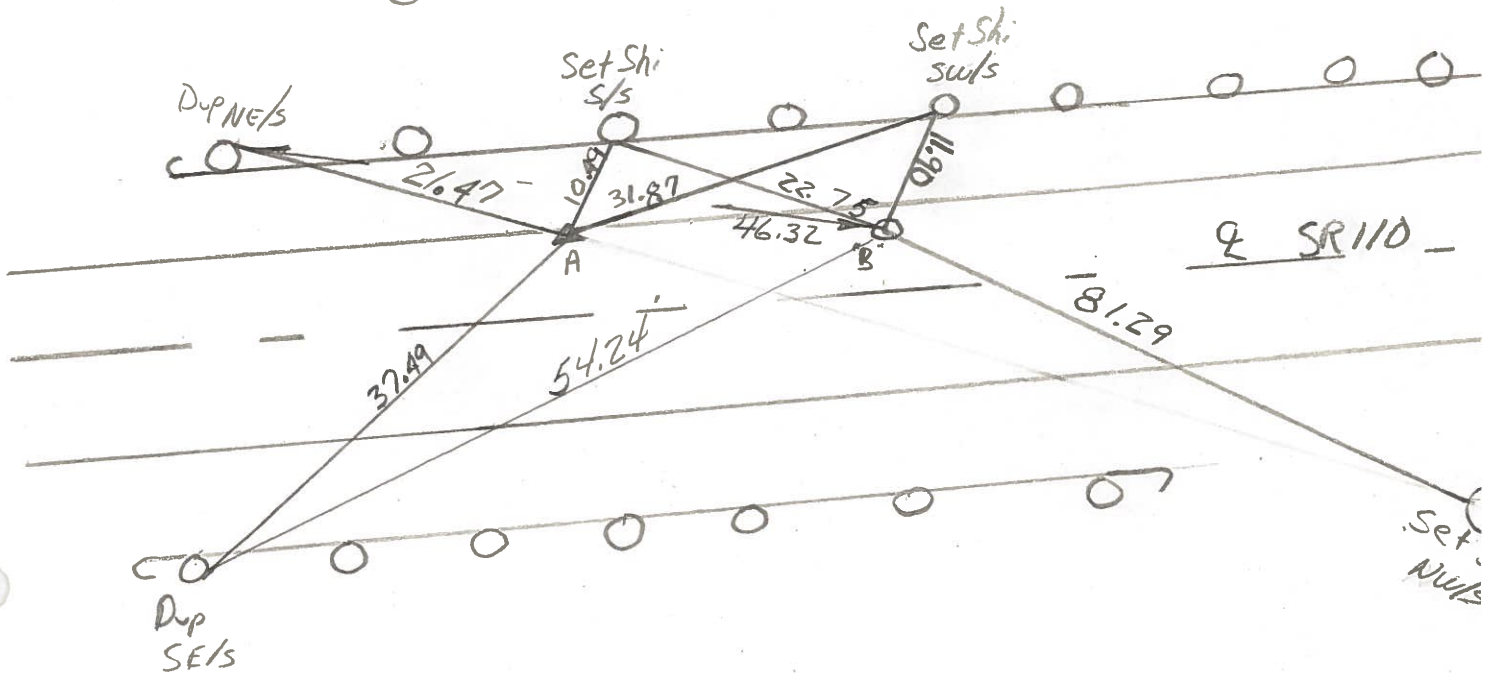



PERSONNEL	TITLE	PERSONNEL	TITLE	COUNTY	DATE
Ernsthausen				Henry	11-20-58
Donaldson				S. R. 110	WEATHER Clear
Text				SEC.	TEMP. 50°

DESCRIPTION: Ties To P.I.'s 119+41.91 TO 170+97.23  
LEFT CENTER LINE RIGHT JOB NO.

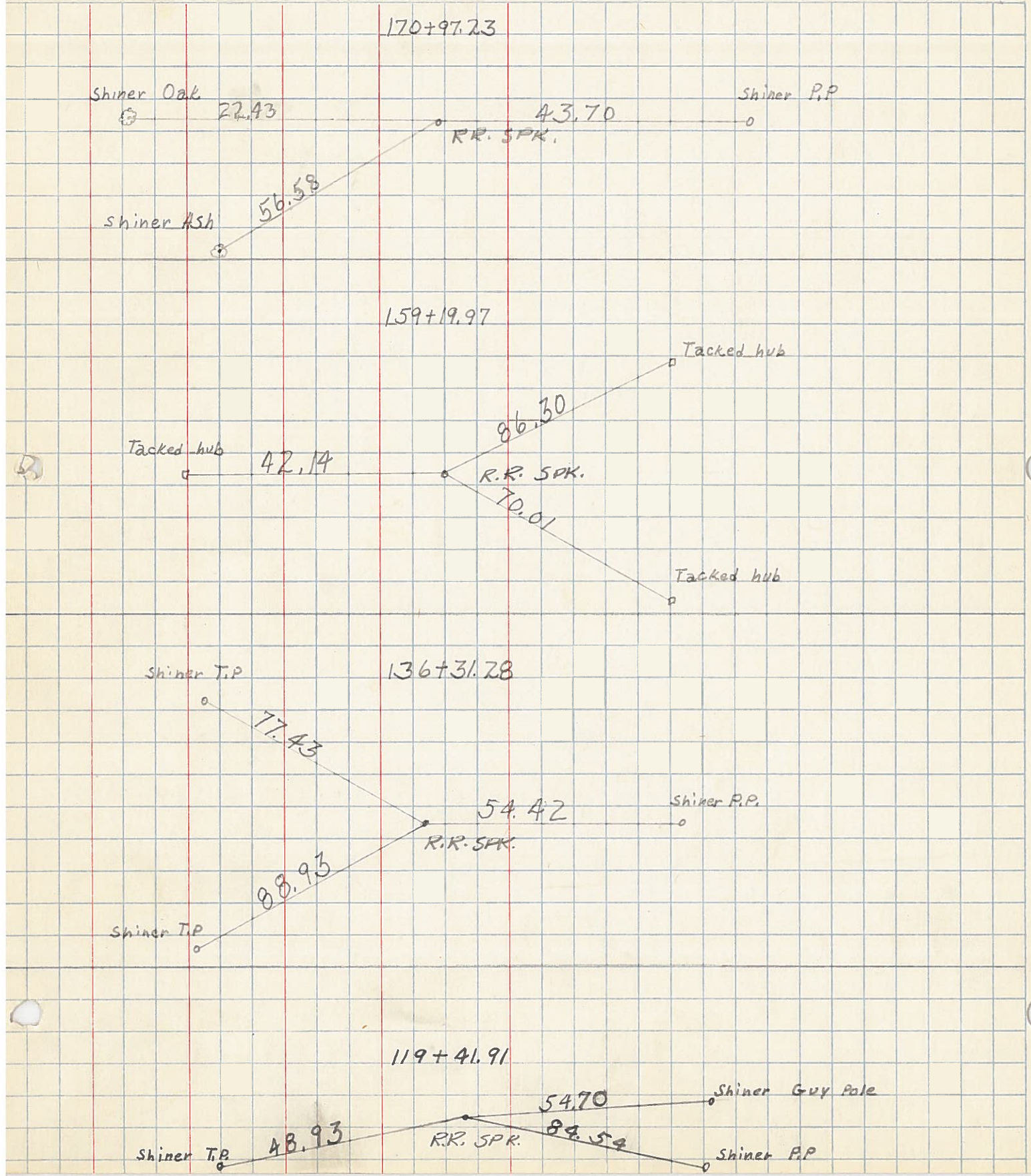

PERSONNEL	TITLE	PERSONNEL	TITLE	COUNTY	DATE
Beach				Henry	Dec. 1957
Armbruster				S. R. 110	WEATHER
Knape				SEC. 2.22	TEMP.
Harris					
Rychener					
DESCRIPTION	ALIGNMENT			Sheet #2	JOB NO.

LEFT CENTER LINE RIGHT

STATION EQUATION  
 P.T. STA. 162+77.00 BACK  
 = STA. 162+77.71 AHEAD  
 Subtract 0.71'

COMMON P.I. STA 159+19.97 Est. RR Spk  
 Existing Pav't Survey Proposed & Constr  
 $\Delta = 7^{\circ}09' Rt.$   $\Delta = 7^{\circ}09' Rt.$   
 $D = 4^{\circ}$   $D = 1^{\circ}$   
 $T = 89.49'$   $T = 357.97'$   
 $L = 178.75$   $L = 715.00'$

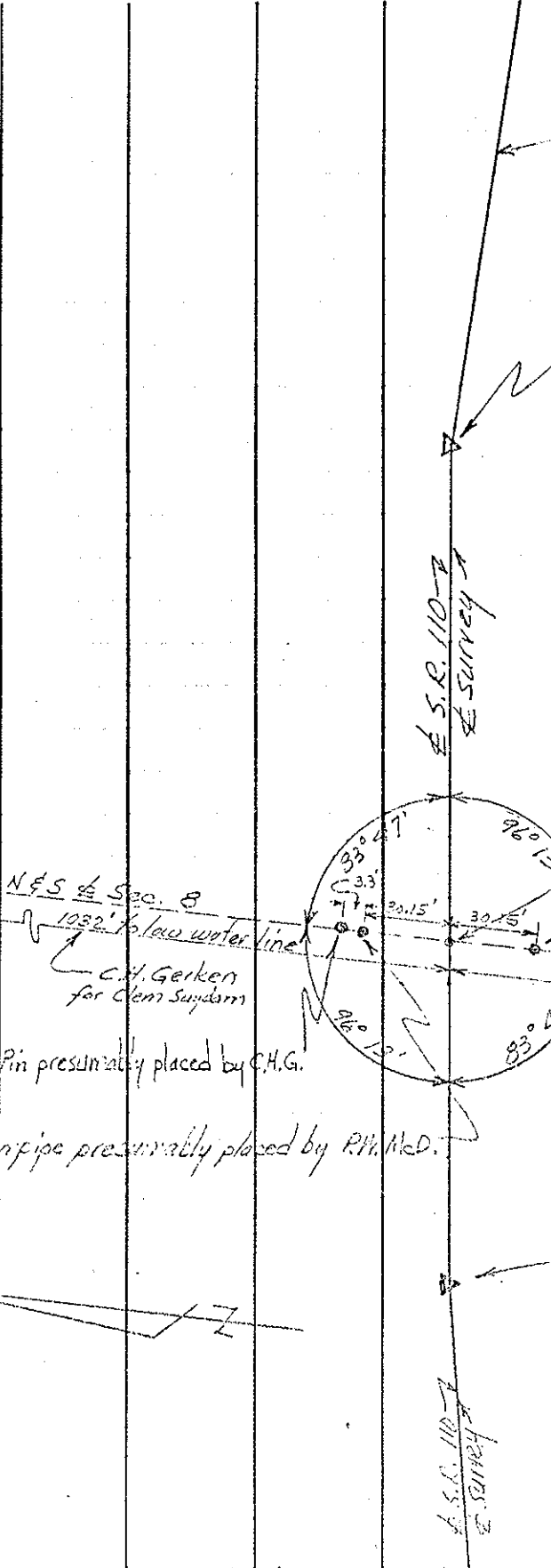

P.O.T. Sta. 145+92.60 Est. RR Spk  
 Found conc. Mon. presumably placed by P.M. McD.  
 Found Sol<sup>1</sup>/<sub>4</sub> Post Stone Sec. 8  
 N & S of Sec. 8  
 1592.67'  
 P.M. McDonnell for Campbell Soup

Found Iron Pin presumably placed by C.H.G.  
 Found Iron pipe presumably placed by P.M. McD.

Existing Pav't Survey & Proposed & Constr  
 P.I. STA 136+31.28  
 $\Delta = 2^{\circ}47'30'' Rt.$   
 $D = 0^{\circ}12'$   
 $T = 698.08'$   
 $L = 1395.83'$