

O.D.O.T. DISTRICT 2 SURVEY OFFICE (USE ONLY)

PERSONNEL _____ REFERENCE NO. 9 F SHEET 38 OF 51
 NOTES MILLER DATE 3/13/24 ROUTE SR 110
 H.C. NIESE WEATHER SUNNY COUNTY HENRY
 R.C. RHOADES TEMP. 55° TOWNSHIP HARRISON
 SECTION 10
 DWG BY RHOADES PID 94321 T 5 N R 7 E

TYPE MONUMENT MAG/WASHER
 ON SURFACE - ~~BELOW~~ ON
 OFFSET \odot PAVEMENT 0.6' LT : ~~RT~~
- TO - EDGE PAVEMENT
 STATION: 224+66.34

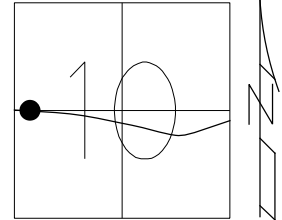

HORZ. DATUM: NAD83(2011) GEOID: NAVD88 2012A
 GRID: NORTHING: 637934.781 EASTING: 1541587.325

RECORD: C.P.O.C.
 FD MAG/WASHER
 11/1/04, MB
 SET MAG/WASHER
 6/19/03, MB
 FD MAG/WASHER
 6/15/18, JLL
 FD MAG/WASHER
 REFF9
 5/6/21, JFO
 SET MAG/WASHER
 7/19/21, DSA
 FD MAG/WASHER
 8/17/23, TDN
 SET MAG/WASHER
 3/13/24, TDN

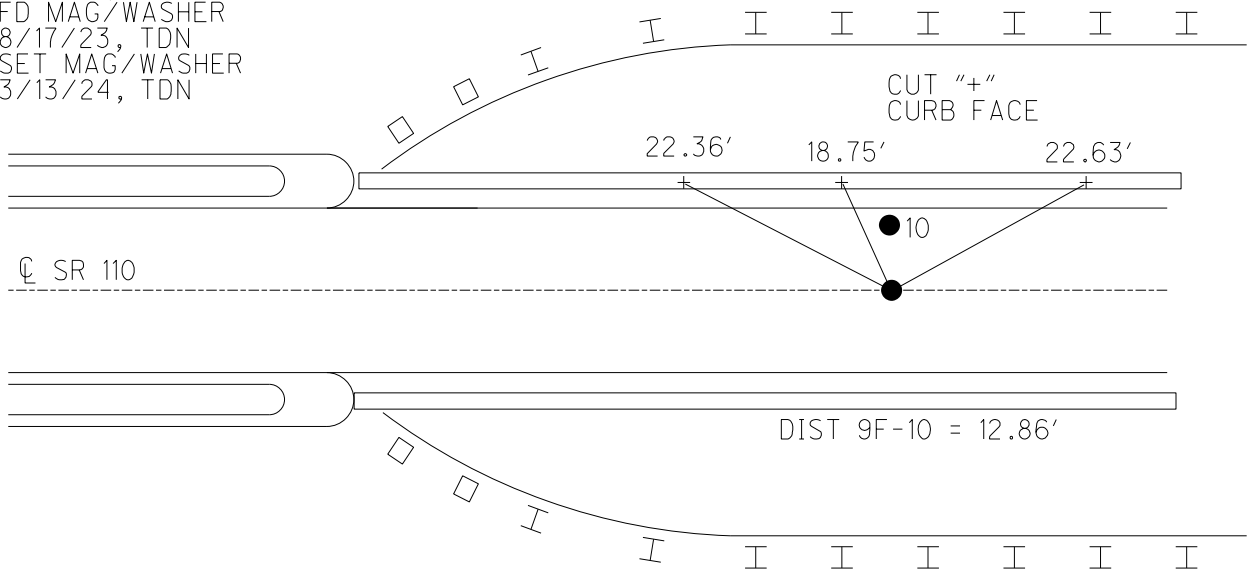

O.D.O.T. DISTRICT 2 SURVEY OFFICE (USE ONLY)

PERSONNEL

REFERENCE NO. 9 F

SHEET 31 OF 44

NOTES ASTON

DATE 8/17/23

ROUTE SR 110

H.C. NIESE

WEATHER WINDY

COUNTY HENRY

R.C. RHOADES

TEMP. 73°

TOWNSHIP HARRISON

AUBLE

SECTION 10

DWG BY RHOADES PID 94321

T 5 N R 7 E

TYPE MONUMENT MAG/WASHER

ON SURFACE - ~~BELOW~~ ON

OFFSET \varnothing PAVEMENT 0.06' LT : ~~RT~~

- TO - EDGE PAVEMENT

STATION: 224+66.34

HORZ.DATUM: NAD83(2011)

GEOID: NAVD88 2012A

GRID: NORTHING: 637934.781

EASTING: 1541587.325

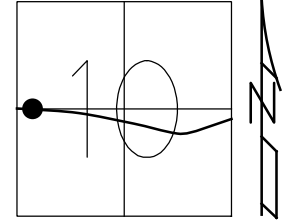

RECORD: C.P.O.C.
 FD MAG/WASHER
 11/1/04, MB
 SET MAG/WASHER
 6/19/03, MB
 FD MAG/WASHER
 6/15/18, JLL
 FD MAG/WASHER
 REFF9
 5/6/21, JFO
 SET MAG/WASHER
 7/19/21, DSA
 FD MAG/WASHER
 8/17/23, TDN

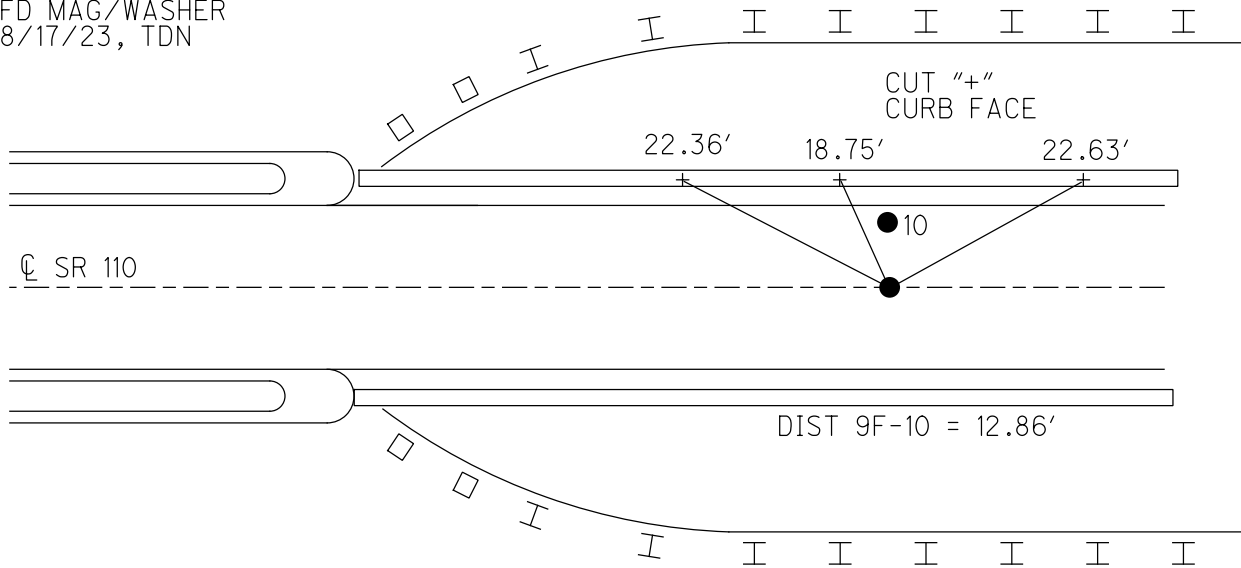

O.D.O.T. DISTRICT 2 SURVEY OFFICE (USE ONLY)

PERSONNEL

REFERENCE NO. 9 F

SHEET 29 OF 43

NOTES RHOADES DATE 6/15/18
 H.C. LEU WEATHER SUNNY
 R.C. TRENKA TEMP. 73°

ROUTE SR 110
 COUNTY HENRY
 TOWNSHIP HARRISON
 SECTION 10
 T 5 N R 7 E

DWG BY NIESE PID 104940

TYPE MONUMENT MAG/WASHER

ON SURFACE - ~~BELOW~~ ON

OFFSET \odot PAVEMENT 0.06' LT : ~~RT~~

TO EDGE PAVEMENT

STATION: 224+55.77

HORIZ.DATUM: NAD83(2011) GEOID: NAVD88 2012A

GRID: NORTHING: 637934.762 EASTING: 1541587.334

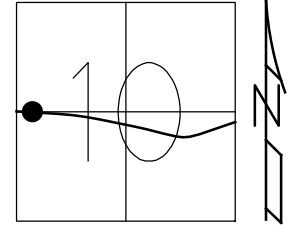

RECORD:
 ON \odot PAVT
 C.P.O.C.
 FD MAG/WASHER
 11/1/04, MB
 SET MAG/WASHER
 6/19/03, MB
 FD MAG/WASHER
 6/15/18, JLL
 FD MAG/WASHER
 REFF9
 7/19/21, DSA

DIST 9F-10 = 12.86'

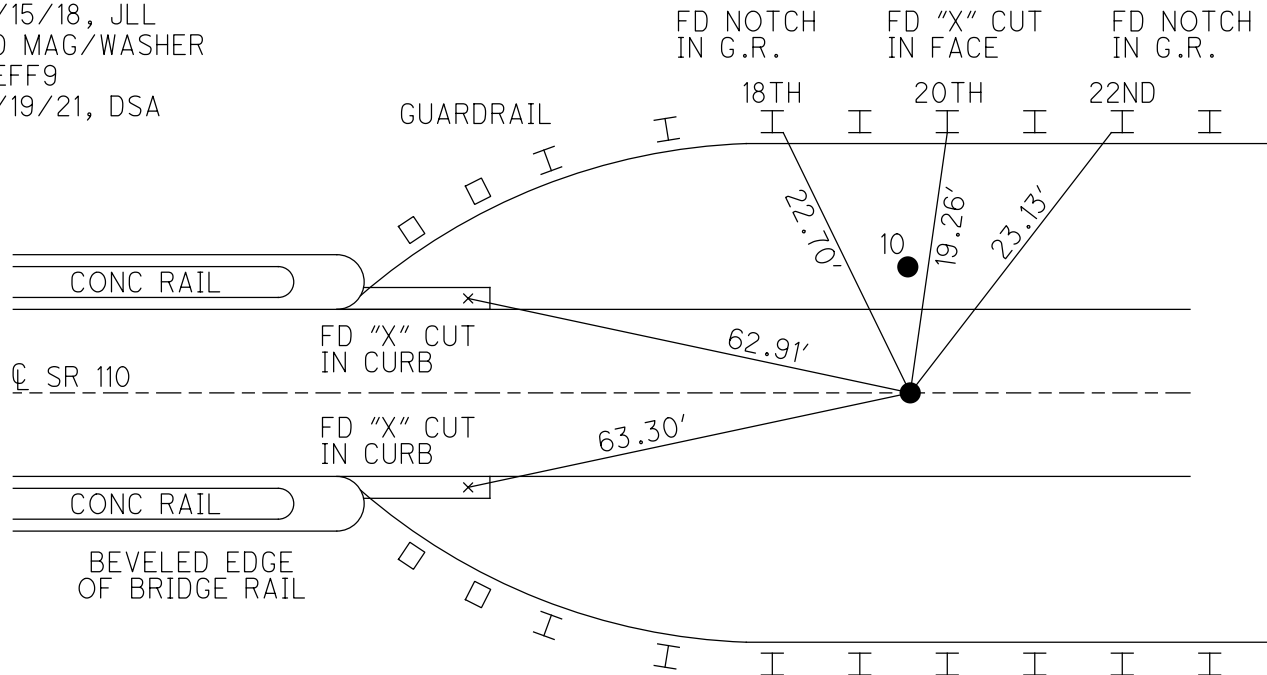

O.D.O.T. DISTRICT 2 SURVEY OFFICE (USE ONLY)

PERSONNEL

REFERENCE NO. 9 F

SHEET 29 OF 43

NOTES RHOADES DATE 6-15-18
 H.C. LEU WEATHER SUNNY
 R.C. TRENKA TEMP. 73°

ROUTE SR 110
 COUNTY HENRY
 TOWNSHIP HARRISON
 SECTION 10
 T 5 N R 7 E

DWG BY AUBLE PID 104940

TYPE MONUMENT MAG/W

ON SURFACE - ~~BELOW~~ ON

OFFSET \odot PAVEMENT 0.6' LT : ~~RT~~
TO EDGE PAVEMENT

STATION: 224+53

HORIZ.DATUM: NAD83(2011) GEOID: 2012A

GRID: NORTHING: 637934.762 EASTING: 1541587.334

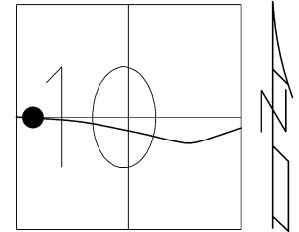

RECORD:
 ON \odot PAVT
 C.P.O.C.
 FD MAG/WASHER
 11-1-04, MB
 RESET MAG/WASHER
 6-19-03, MB
 FD MAG/W REFF9
 6-15-18, JLL

DIST 9F-10 = 12.86'

FD NOTCH CUTS 18TH AND 22ND
 GR POST.
 "X" CUT IN FACE OF 20TH STEEL POST

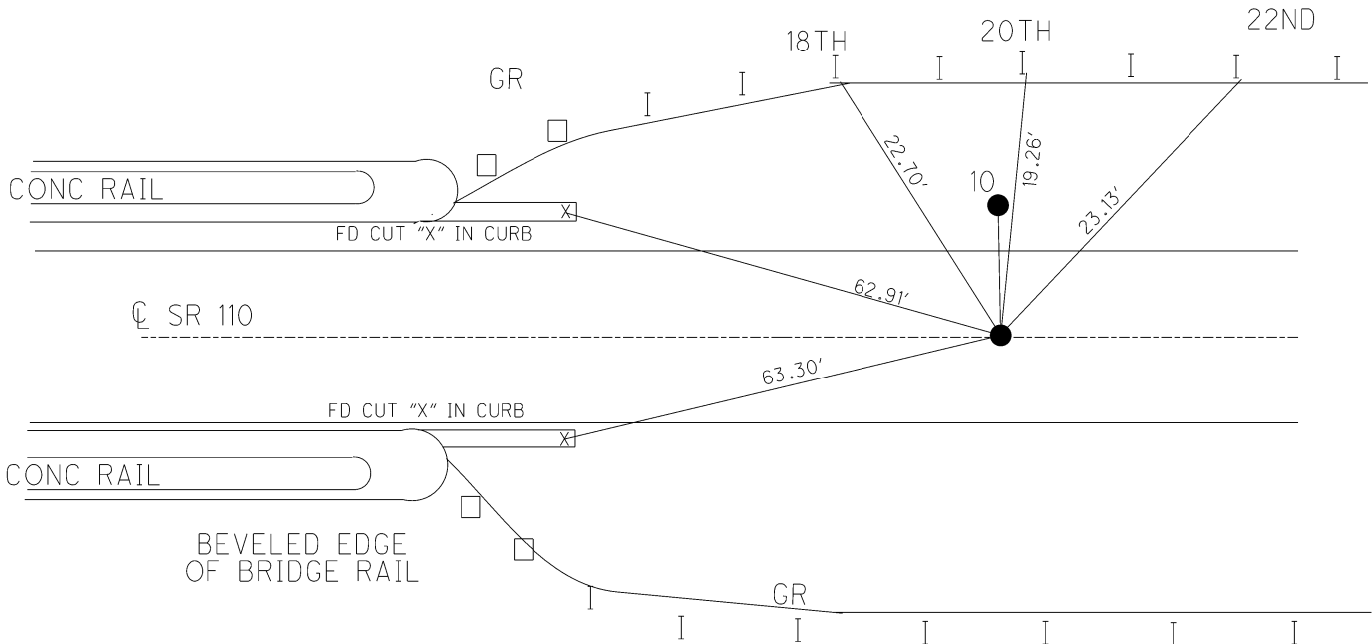

O.D.O.T. DISTRICT 2 SURVEY OFFICE

PERSONNEL

REFERENCE NO. 10

SHEET 17 OF 26

NOTES BARNHISEL

DATE 11/01/04

ROUTE S.R. 110

H.C. CANTERBURY

WEATHER CLOUDY

COUNTY HENRY

R.C. HOMAN

TEMP. +50°

TOWNSHIP HARRISON

SECTION 10

T 5 N R 7 E

TYPE MONUMENT "A" = MAG/WASHER "B" = MAG/WASHER

ON SURFACE - ~~BELOW~~ YES

LEFT-CL PAV'T-RIGHT "A" - 12.7' LT OF CL PAV'T
"A" - 0.7' LT OF RT ED.

TO EDGE PAVEMENT "B" ON CL

S.L.M. 224+53

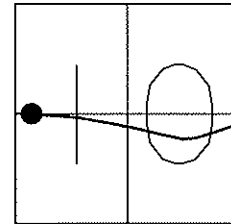

PT "A"

CONC. MON W/ DAMAGED TOP
REF ARE TO 1/2" IRON PIN
REC P.I. STA 229+84.15
DELTA = 8°-50' RT
D = 1°-20'

PT B
ON CL PAVT
C.P.O.C.

RESET MAG NAIL & WASHER
6-19-03
MB

NOTCH CUT 18TH AND 22TH
GUARDRAIL POST.
"X" CUT IN FACE OF 20TH STEEL POST

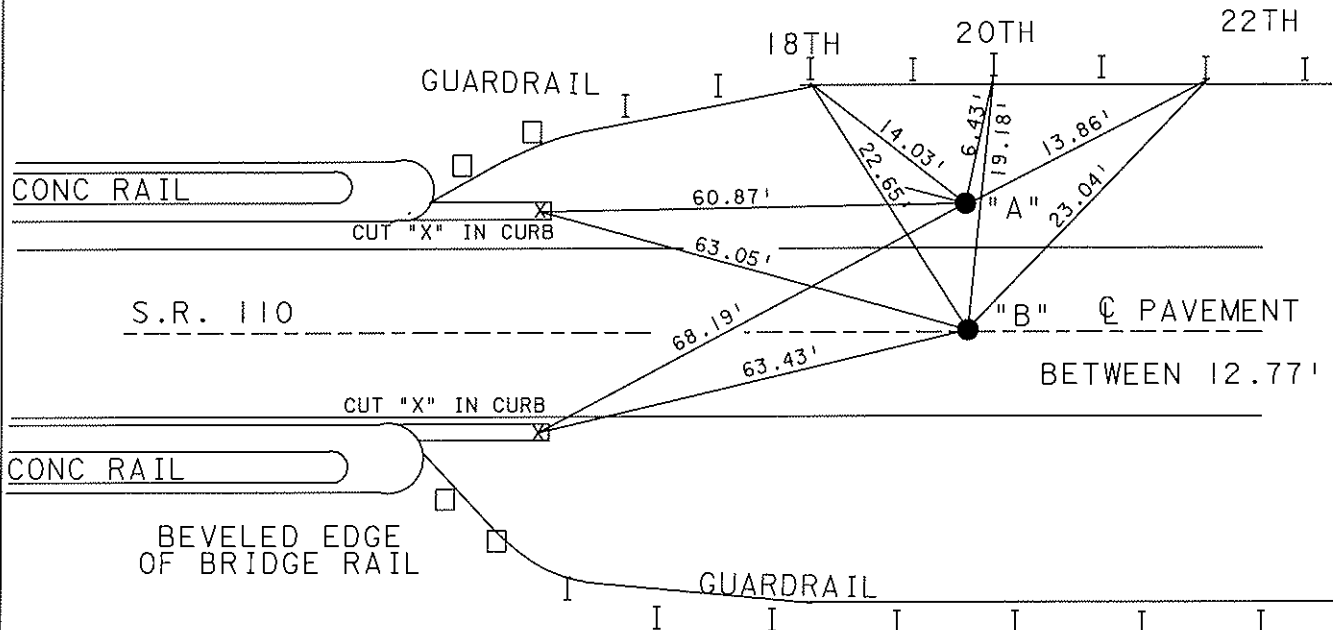

O.D.O.T. DISTRICT 2 SURVEY OFFICE

PERSONNEL

REFERENCE NO. 10

SHEET 17 OF 26

NOTES CANTERBURY

DATE 4-28-03

ROUTE S.R. 110

H.C. BROWN

WEATHER SUNNY

COUNTY HENRY

R.C. BEAMOUNT

TEMP. +55°

TOWNSHIP HARRISON

SECTION 10

T 5 N R 7 E

TYPE MONUMENT "A" = CONC. MON W/PIN "B" = PK/WASHER

ON SURFACE - ~~BELOW~~ YES

LEFT-CL PAV'T-RIGHT "A" - 13.0' LT OF CL PAV'T
"A" - 1.4' LT OF RT ED.

"B" 12.0' TO LT. EDGE PAVEMENT "B" ON CL

S.L.M. 224+53

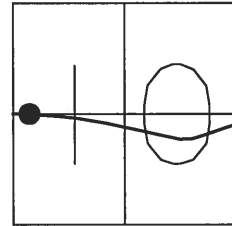

PT "A"

CONC. MON W/ DAMAGED TOP
REF ARE TO 1/2" IRON PIN
REC P.I. STA 229+84.15
DELTA = 8°-50' RT
D = 1°-20'

PT B
ON CL PAVT
C.P.O.C.

RESET MAG NAIL & WASHER
6-19-03
MB

SHI IN 13TH 15TH 17TH
ROUND GUARDRAIL POST

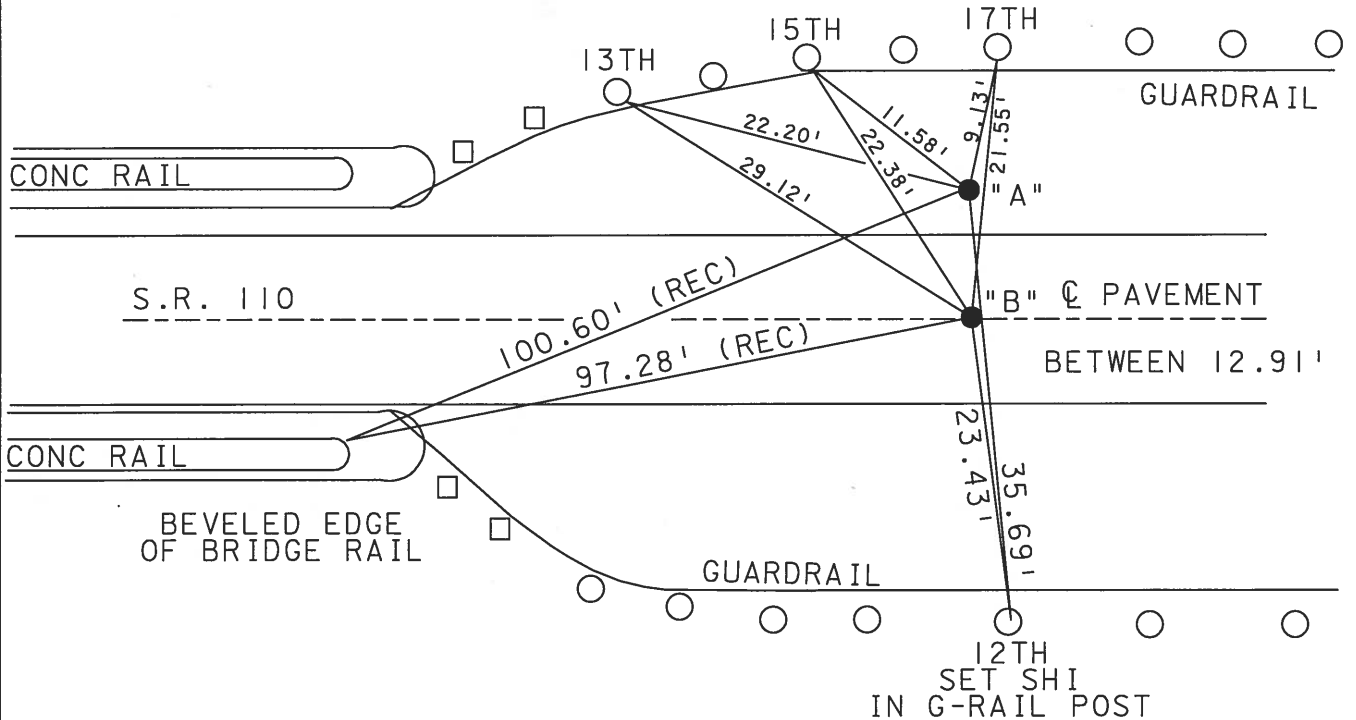

O.D.O.T. DISTRICT 2 SURVEY OFFICE

PERSONNEL _____

REFERENCE NO. 10

SHEET 25 OF 34

NOTES LOEHRKE

H.C. CURTIS

R.C. ROMETO

DATE 5-28-92

WEATHER CLEAR

TEMP. +72

ROUTE S.R.110

COUNTY HENRY

TOWNSHIP HARRISON

SECTION 10

T. 5 N. R. 7 E

TYPE MONUMENT A-PK / WASHER B= Sm R.R. Spike

ON SURFACE - BELOW Yes

LEFT- & PAV'T. - RIGHT A Lt B - ON &

11.4 TO Lt EDGE PAVEMENT

S.L.M. 224+53

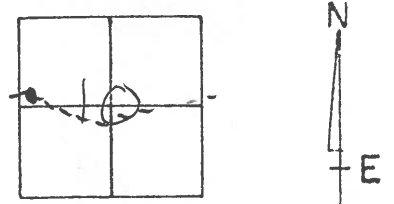

CONC. MON W/ DAMAGED TOP
 REF ARE TO 1/2" IRON PIN
 REC. P.I. STA 229+84.15
 $\Delta = 8^{\circ}-50'$ Rt
 $D = 1^{\circ}-20'$

Pt. A

A, B Set P.K.
 Sm. R.R. SPIKE WASHER
 ON & PAVT 10-27-92
 "C.P.O.C."

BETWEEN - 13.08

Shis in 13th 15th & 17th
 Round GUARD RAIL Post

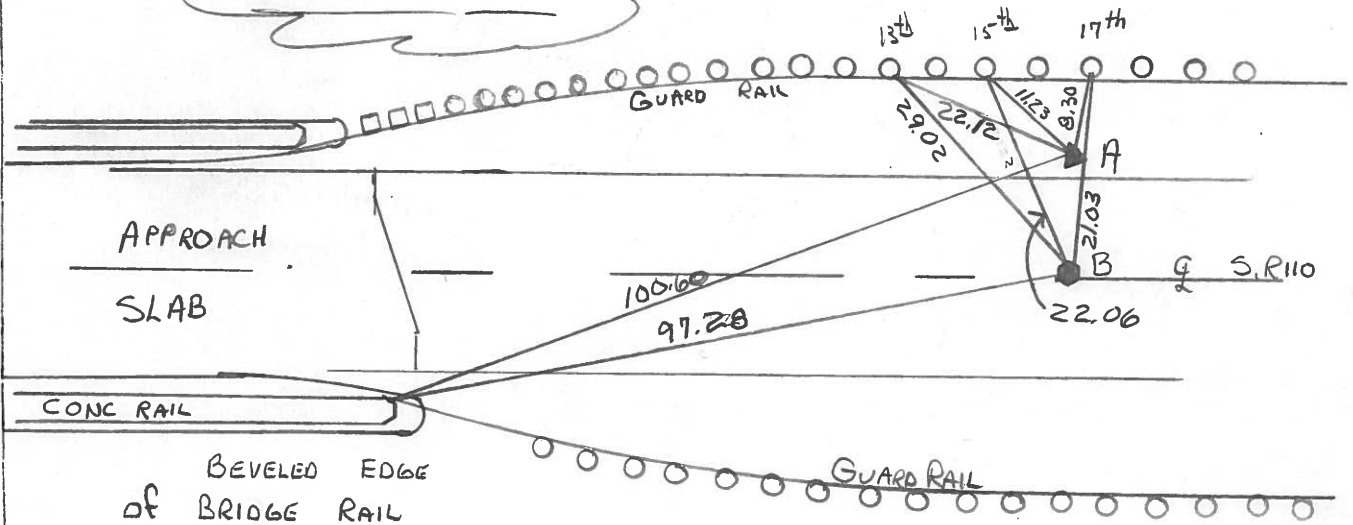

County HENRY S.R. 110

Date 2-7-84

Township HARRISON

Weather PT. CLOUDY

Section 10

Temp. +16°

T5N, R7E

Personnel BARNHISEL HC

HOUSEHOLDER RC

HOFFMAN

LOEHRKE

10

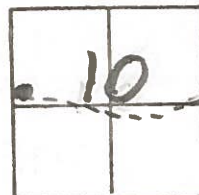

PTA. FA CONC MON w/DAMAGED TOP
Ref to 1/2" IRON ROD.
PI STA 229+84.15
 $\Delta = 8^{\circ} 50' R$
 $D = 1^{\circ} 20'$
1.3 Lt of LEP

PT'B' FA 1/2 pipe @ SURFACE
CPOC ON E PART SR110
11.6 TO LEP
11.6 TO REP

SLM = 224 + 63

SET SMALL R.R.S.
6/6/84
S.W.H.

SET P.K./WASHER
6/6/84
S.W.H.

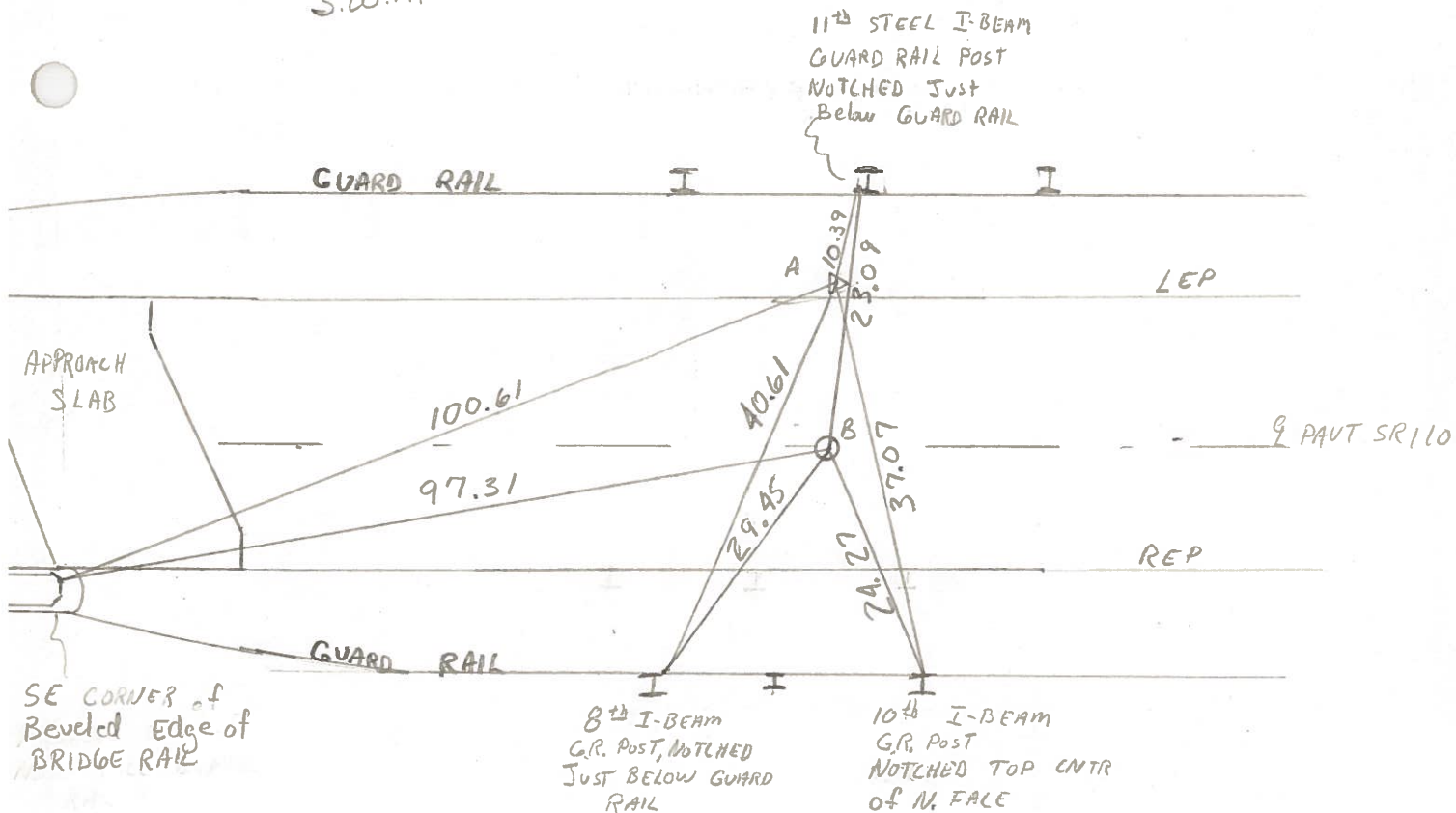

APPROACH SLAB

SE CORNER of Beveled Edge of BRIDGE RAIL

HEN 110-04.19

PT'A' to PT'B' = 13.09

PERSONNEL	TITLE	PERSONNEL	TITLE	COUNTY	Henry	DATE	11-20-58
Ernsthausen				S. R.	110	WEATHER	Clear
Donaldson				SEC.		TEMP.	+55°
Tesst				DESCRIPTION	Ties To P.I.'s		JOB NO.

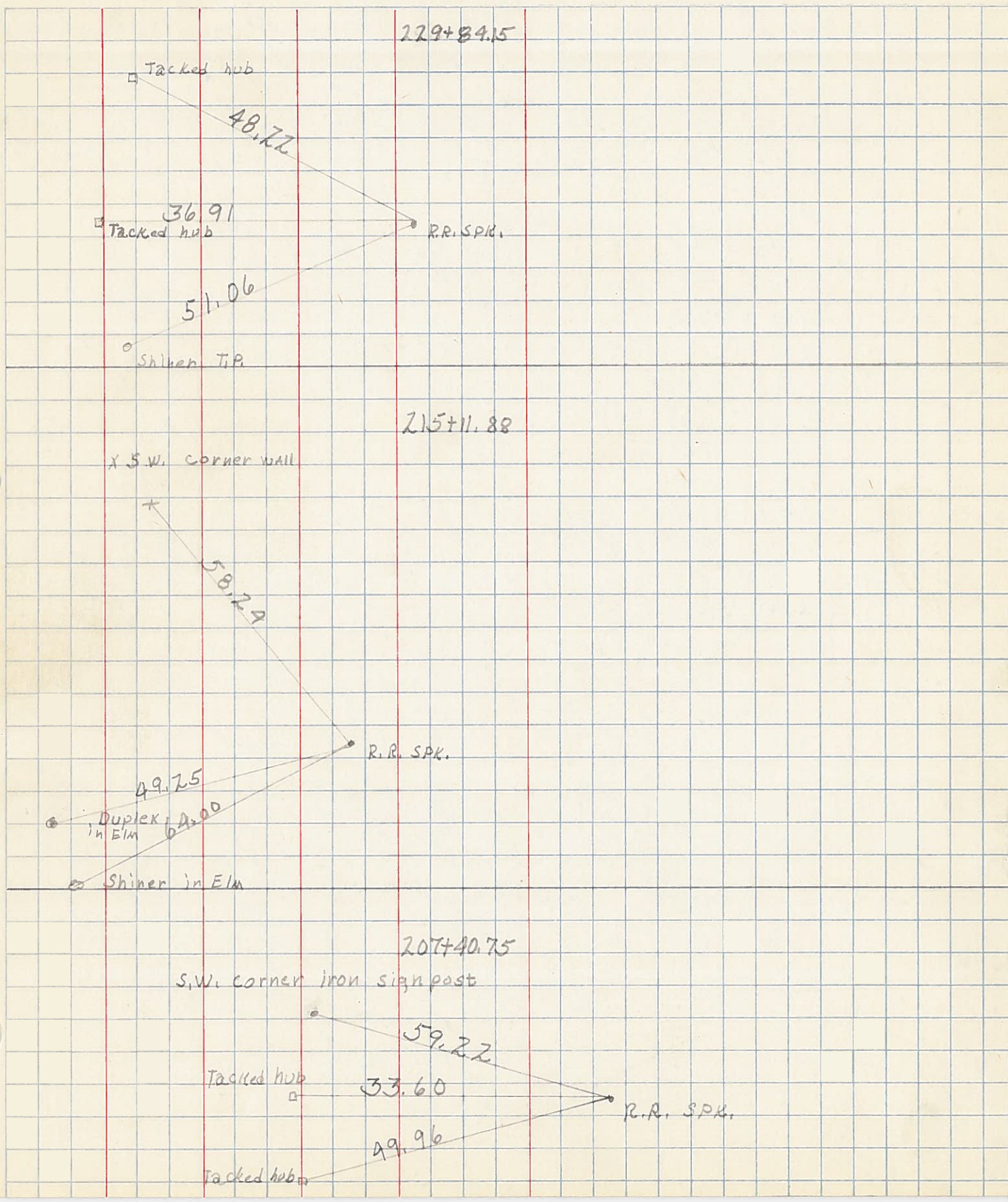

PERSONNEL	TITLE	PERSONNEL	TITLE	COUNTY	DATE	WEATHER	TEMP.
<u>Beach</u>		<u>Harris</u>		<u>Henry</u>	<u>Dec. 1957</u>		
<u>Armbruster</u>	<u>X</u>	<u>Hoff</u>		<u>S. R. 110</u>			
<u>Knapp</u>		<u>Buchener</u>		<u>SEC. 2.22</u>			
<u>Ruffler</u>		<u>Delvanthal</u>		<u>ALIGNMENT sheet # 5</u>			
DESCRIPTION				JOB NO.			

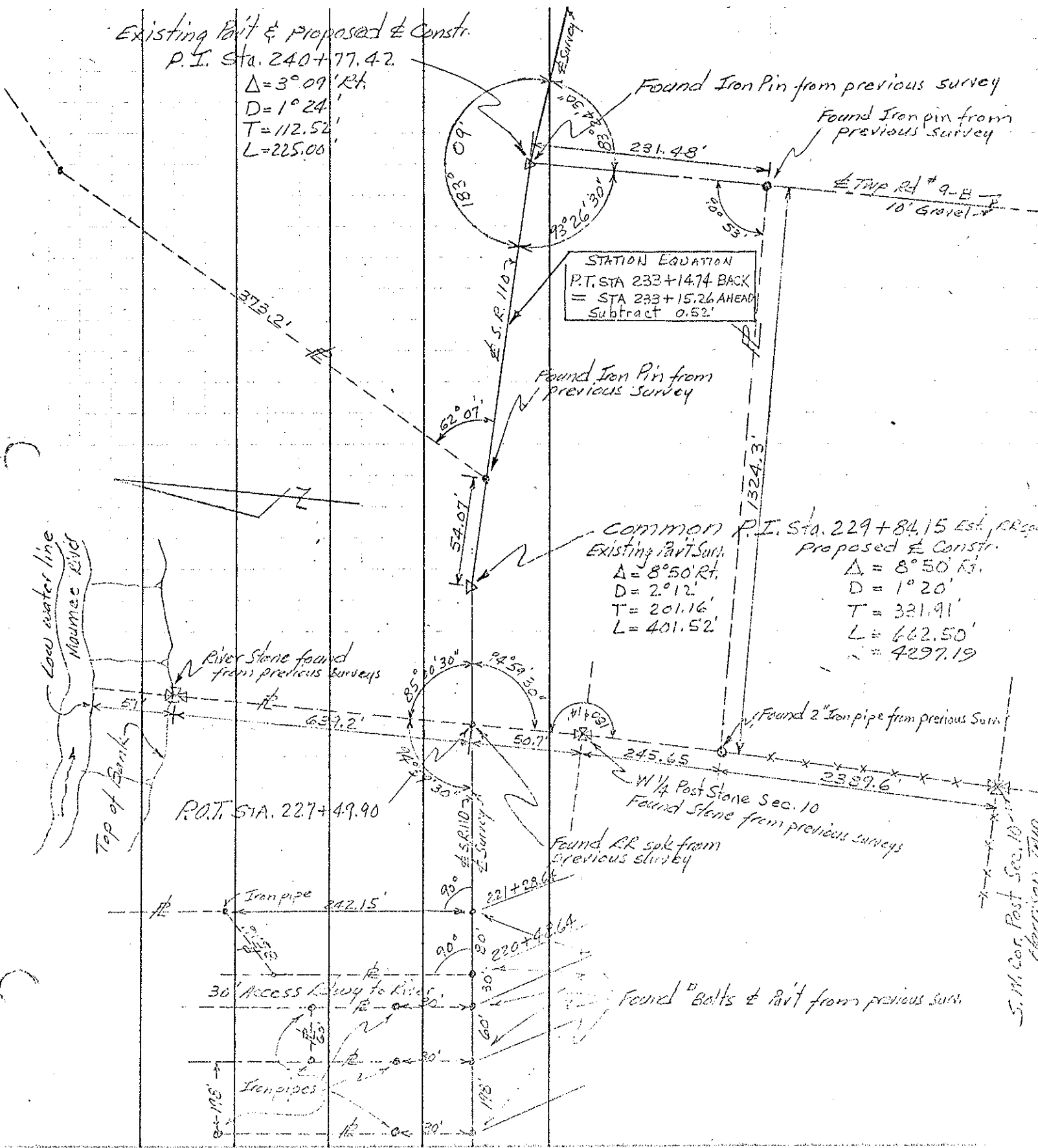

Existing Part & Proposed & Constr.
 P.I. Sta. 240+77.42
 $\Delta = 3^{\circ}09' \text{ Rt.}$
 $D = 1^{\circ}24'$
 $T = 112.52'$
 $L = 225.00'$

STATION EQUATION
 P.T. STA 233+14.74 BACK
 = STA 233+15.26 AHEAD
 Subtract 0.52'

Common P.I. Sta. 229+84.15 Est. Prop.
 Existing Part Surv. Proposed & Constr.
 $\Delta = 8^{\circ}50' \text{ Rt.}$ $\Delta = 8^{\circ}50' \text{ Rt.}$
 $D = 2^{\circ}12'$ $D = 1^{\circ}20'$
 $T = 201.16'$ $T = 321.91'$
 $L = 401.52'$ $L = 662.50'$
 $L = 4297.19'$

P.O.T. STA. 227+49.90

S. M. Cor. Post Sec. 10
 Harrison Twp.

PERSONNEL	TITLE	PERSONNEL	TITLE	COUNTY	DATE
Beach		Hoff		Henry	Dec. 1957
Armbruster	x	Harris		S. R. 110	WEATHER
Ruffer		Rybenor		SEC. 2.22	TEMP.
Knape		Delvantral			

DESCRIPTION: CONTROL POINTS 4 JOB NO. _____

