

O.D.O.T. DISTRICT 2 SURVEY OFFICE (USE ONLY)

PERSONNEL

REFERENCE NO. 10 A

SHEET 40 OF 51

NOTES MILLER DATE 3/13/24
 H.C. NIESE WEATHER SUNNY
 R.C. RHOADES TEMP. 55°

ROUTE SR 110
 COUNTY HENRY
 TOWNSHIP HARRISON
 SECTION 10
 T 5 N R 7 E

DWG BY RHOADES PID 94321

TYPE MONUMENT MONBOX W/ 1" IPIN

~~ON SURFACE~~ - BELOW ON

OFFSET $\text{\textcircled{C}}$ PAVEMENT ON LT : RT

11.5' TO LT EDGE PAVEMENT

STATION: 227+97.69

HORZ. DATUM: NAD83(2011)

GEOID: NAVD88 2012A

GRID: NORTHING: 637918.449

EASTING: 1541918.185

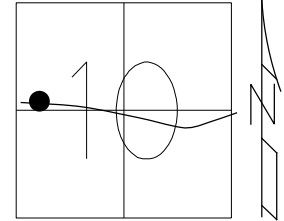

RECORD:
 FD MON BOX
 5/28/92, CL
 06/19/03, MD
 FD MON BOX
 W/1" IPIN
 REFA10
 6/15/18, JLL
 FD MONBOX
 W/1" IPIN
 REFA10
 5/6/21, JFO
 7/19/21, DSA
 8/17/23, TDN
 CKREFA10
 3/13/24, TDN

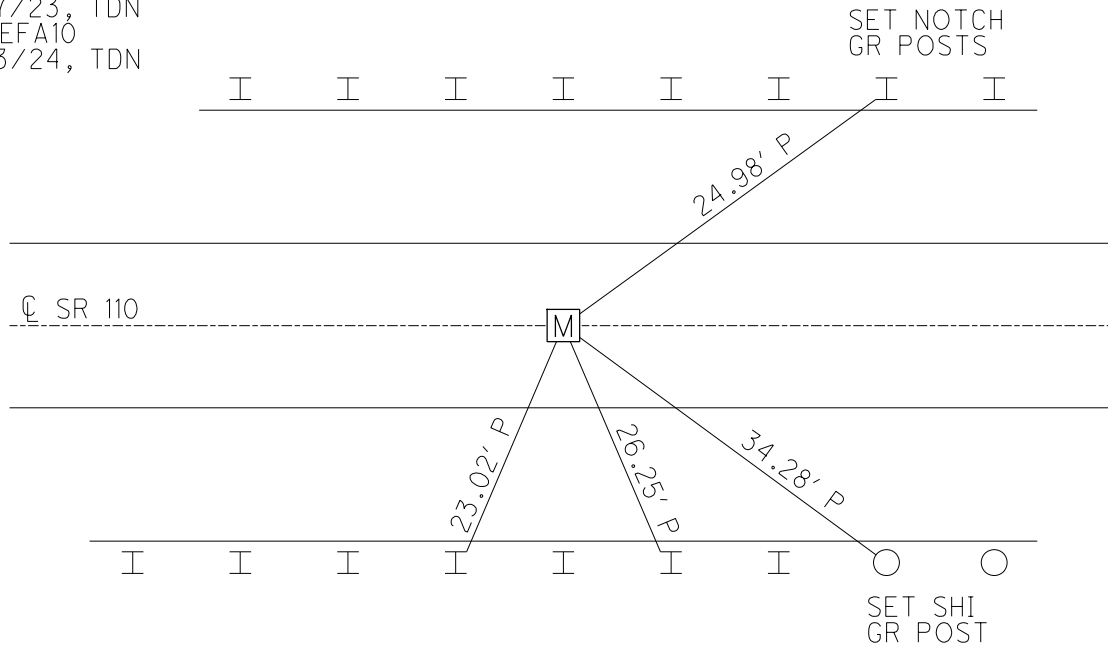

O.D.O.T. DISTRICT 2 SURVEY OFFICE (USE ONLY)

PERSONNEL

REFERENCE NO. 10 A

SHEET 33 OF 44

NOTES ASTON

DATE 8/17/23

ROUTE SR 110

H.C. NIESE

WEATHER WINDY

COUNTY HENRY

R.C. RHOADES

TEMP. 73°

TOWNSHIP HARRISON

AUBLE

SECTION 10

DWG BY RHOADES PID 94321

T 5 N R 7 E

TYPE MONUMENT MONBOX W/ 1" IPIN

~~ON SURFACE~~ - BELOW ON

OFFSET \odot PAVEMENT ON LT : RT

11.5' TO LT EDGE PAVEMENT

STATION: 227+97.69

HORZ. DATUM: NAD83(2011)

GEOID: NAVD88 2012A

GRID: NORTHING: 637918.449

EASTING: 1541918.185

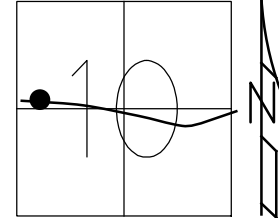

RECORD:
 FD MON BOX
 5/28/92, CL
 06/19/03, MD
 FD MON BOX
 W/1" IPIN
 REFA10
 6/15/18, JLL
 FD MONBOX
 REFA10
 5/6/21, JFO
 7/19/21, DSA
 8/17/23, TDN

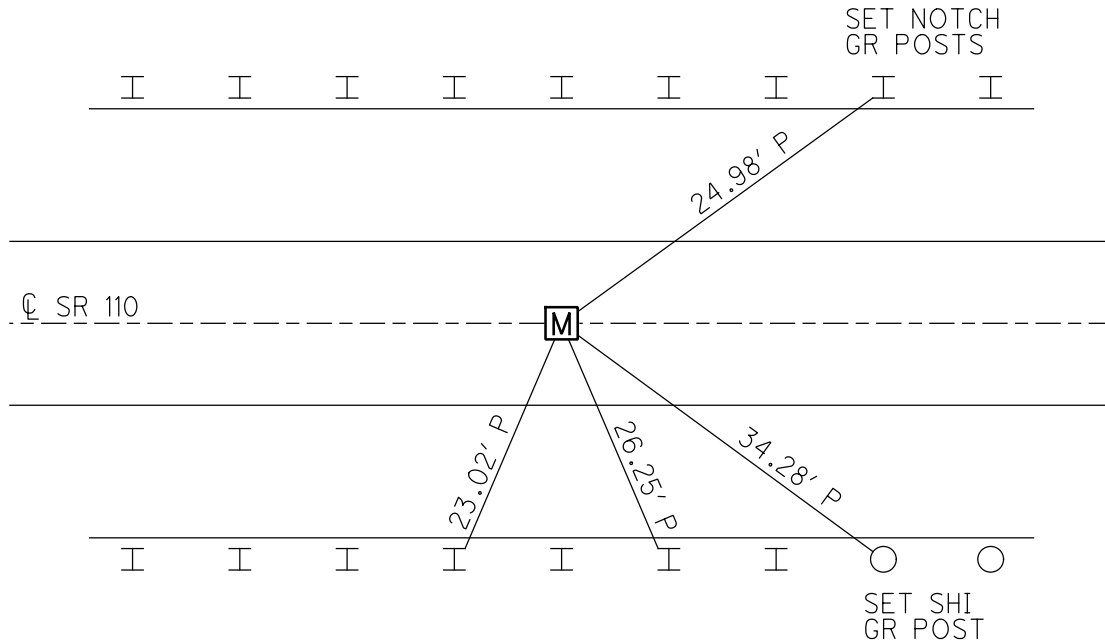

O.D.O.T. DISTRICT 2 SURVEY OFFICE (USE ONLY)

PERSONNEL

REFERENCE NO. 10 A

SHEET 31 OF 43

NOTES RHOADES
 H.C. LEU
 R.C. TRENKA

DATE 6/15/18
 WEATHER SUNNY
 TEMP. 73°

ROUTE SR 110
 COUNTY HENRY
 TOWNSHIP HARRISON
 SECTION 10
 T 5 N R 7 E

DWG BY NIESE PID 104940

TYPE MONUMENT MONBOX W/ 1" IPIN

~~ON SURFACE~~ - BELOW 1.0'

OFFSET $\text{\textcircled{C}}$ PAVEMENT ON LT : RT
11.5' TO LT EDGE PAVEMENT

STATION: 227+87.10

HORZ.DATUM: NAD83(2011)

GEOID: NAVD88 2012A

GRID: NORTHING: 637918.449

EASTING: 1541918.182

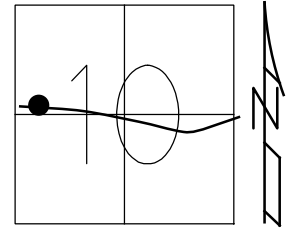

RECORD:
 FD MON BOX
 5/28/92, CL
 DID NOT OPEN BOX
 06/19/03, MD
 FD MON BOX
 W/1" IPIN
 REFA10
 6/15/18, JLL
 FD MONBOX
 7/19/21, DSA

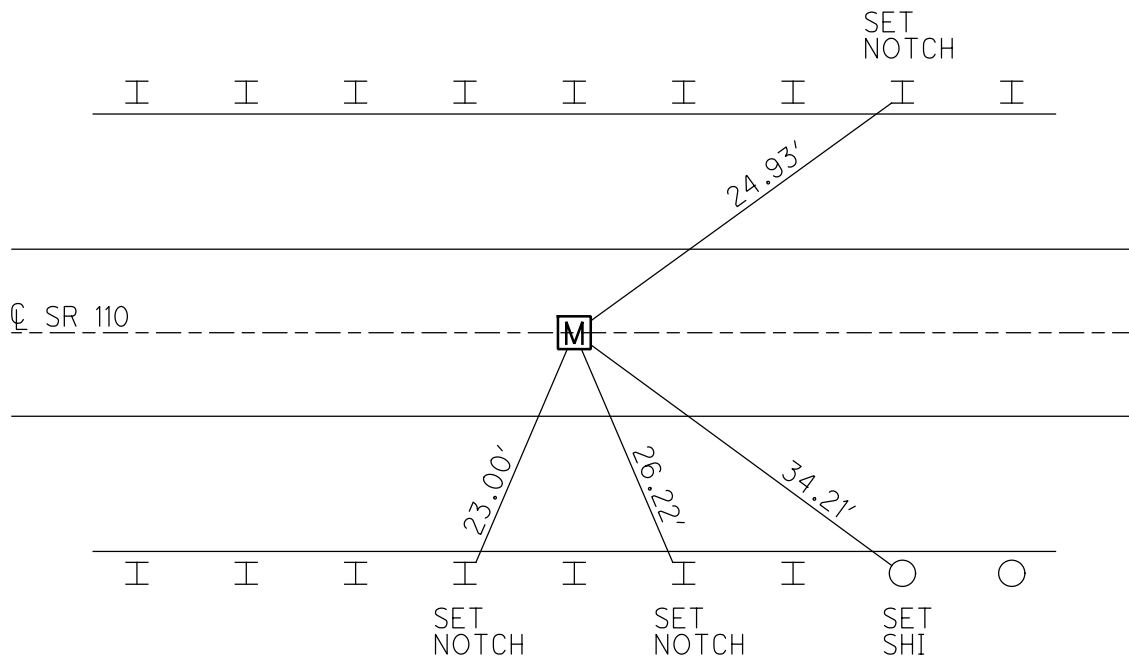

O.D.O.T. DISTRICT 2 SURVEY OFFICE (USE ONLY)

PERSONNEL _____ REFERENCE NO. 10 A SHEET 31 OF 43
 NOTES RHOADES DATE 6-15-18 ROUTE SR 110
 H.C. LEU WEATHER SUNNY COUNTY HENRY
 R.C. TRENKA TEMP. 73° TOWNSHIP HARRISON
 SECTION 10
 DWG BY AUBLE PID 104940 T 5 N R 7 E

TYPE MONUMENT MON BOX W/ 1" IPIN
~~ON SURFACE~~ - BELOW 1' DOWN
 OFFSET \odot PAVEMENT ON ~~LT~~ : ~~RT~~
11.7' TO LT EDGE PAVEMENT
 STATION: 227+84

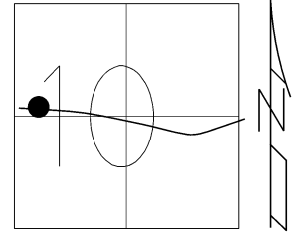

HORZ. DATUM: NAD83(2011) GEOID: 2012A
 GRID: NORTHING: 637918.449 EASTING: 1541918.182

RECORD:
 FD MON BOX
 5-28-92, CL
 DID NOT OPEN BOX.
 06-19-03, MD
 FD MON BOX W/1" IPIN
 REFA10 6-15-18, JLL

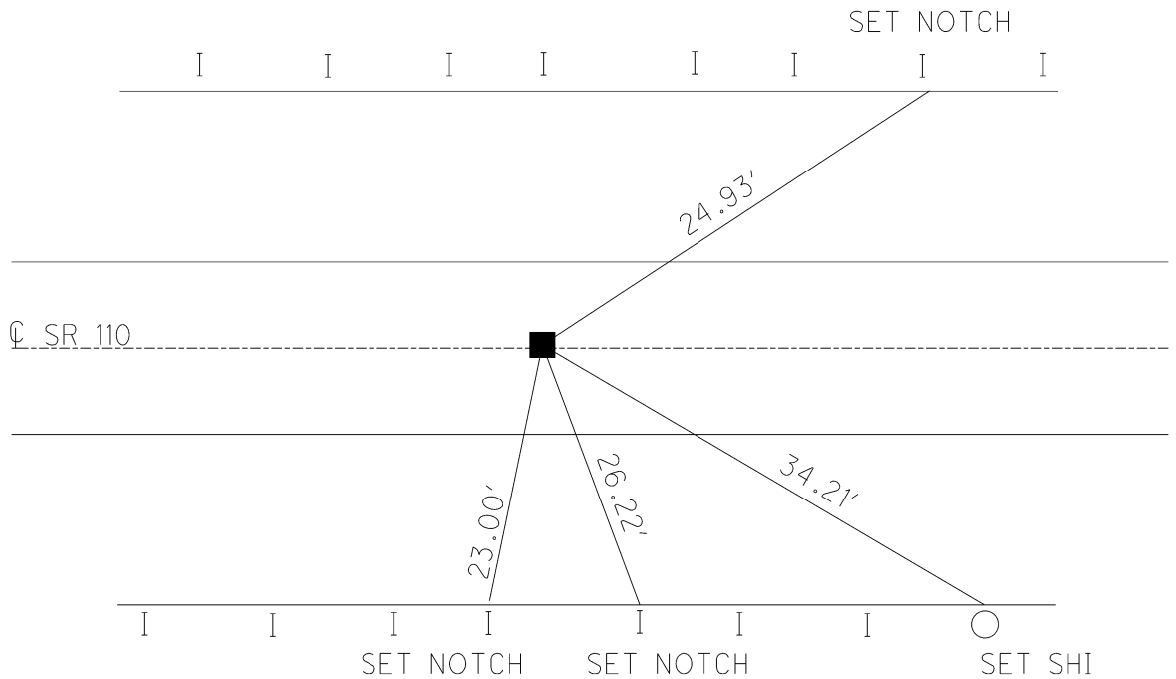

O.D.O.T. DISTRICT 2 SURVEY OFFICE

PERSONNEL

REFERENCE NO. 10-A

SHEET 18 OF 26

NOTES LOEHRKE

DATE 5-28-92

ROUTE S.R. 110

H.C. CURTIS

WEATHER CLEAR

COUNTY HENRY

R.C. ROMETO

TEMP. +72°

TOWNSHIP HARRISON

SECTION 10

T 5 N R 7 E

TYPE MONUMENT MON BOX

ON SURFACE - BELOW YES

LEFT-☉ PAV'T-RIGHT YES

11.5' TO LT. EDGE PAVEMENT

S.L.M. 227+84

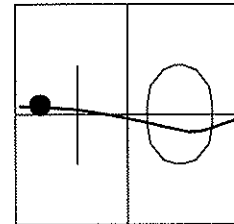

NOTE: DID NOT OPEN BOX.
06-19-03
MD

SET SHI'S IN G-RAIL POSTS

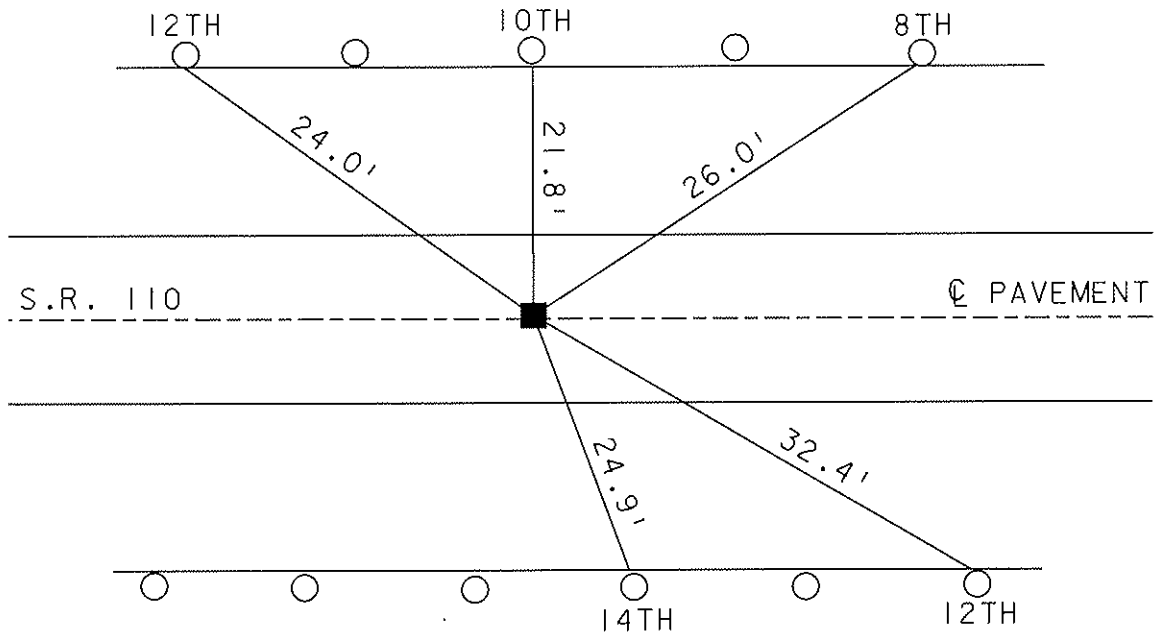

SET SHI'S IN G-RAIL POSTS

O.D.O.T. DISTRICT 2 SURVEY OFFICE

PERSONNEL _____

REFERENCE NO. 10A

SHEET 26 OF 34

NOTES LOEHRKE

H.C. CURTIS

R.C. ROMETO

DATE 5-28-92

WEATHER CLEAR

TEMP. +72

ROUTE S.R. 110

COUNTY HENRY

TOWNSHIP HARRISON

SECTION 10

T 5 N R 7 E

TYPE MONUMENT Mon Box

ON SURFACE - ~~BELOW~~ Yes

~~LEFT - & PAV'T. - RIGHT~~ Yes

11.5 TO Lt EDGE PAVEMENT

S.L.M. 227 +84

OK. 10-27-92

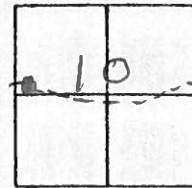

Set Shi's in 8th 10th & 12th Round
GUARD RAIL Post From EAST

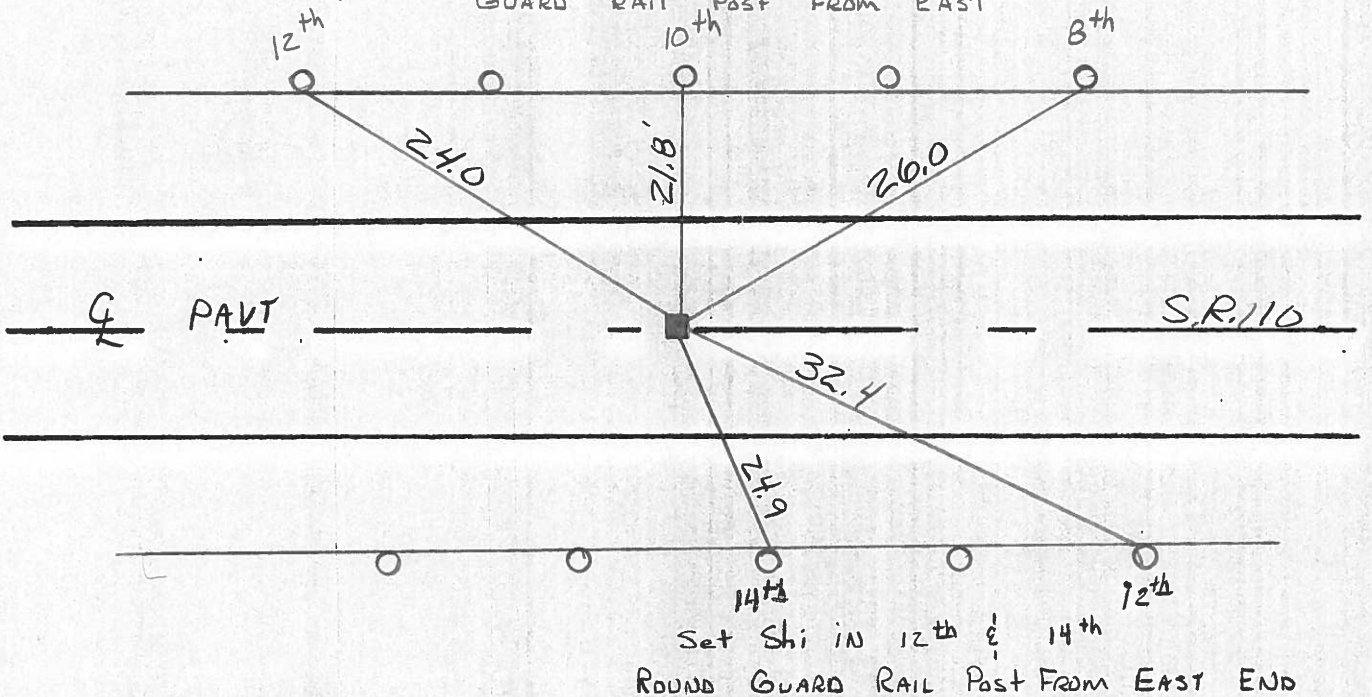

Set Shi in 12th & 14th
ROUND GUARD RAIL Post From EAST END

County HENRY S.R. 110

Date 2-7-84

Township HARRISON

Weather CLEAR

Section 10

Temp. +16°

T5N, R2E

Personnel BARNHISEL HC

HOUSE HOLDER RC

HOFFMAN

LOENRKE

10A

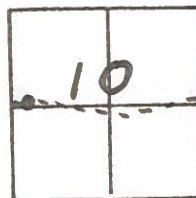

Fa: Mon. Box @ SURFACE
 DID NOT OPEN. Ref to CNTR. of LID
 ON & PART SR110
 11.8 LEP
 11.4 REP

SLM 227+95

