

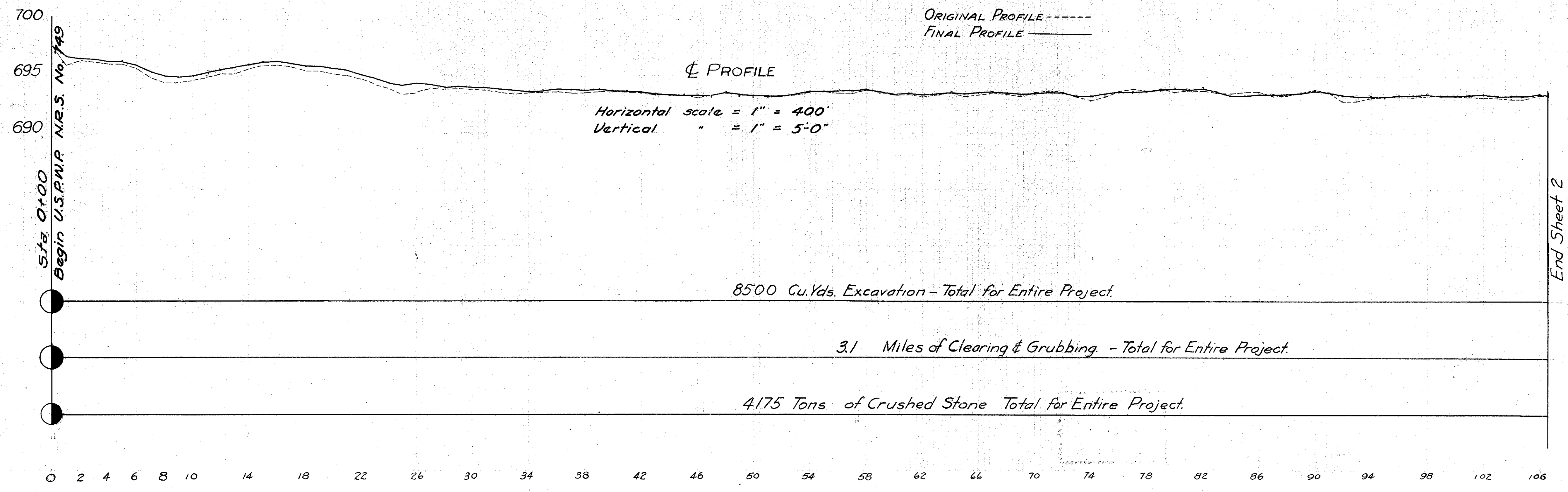

FED. RD. DIST. NO.	STATE	FED. AID PROJECT	FISCAL YEAR	2 5
10	OHIO	749	1933	

ORENDERFER RD.  
HENRY COUNTY

R I C H F I E L D T W P.

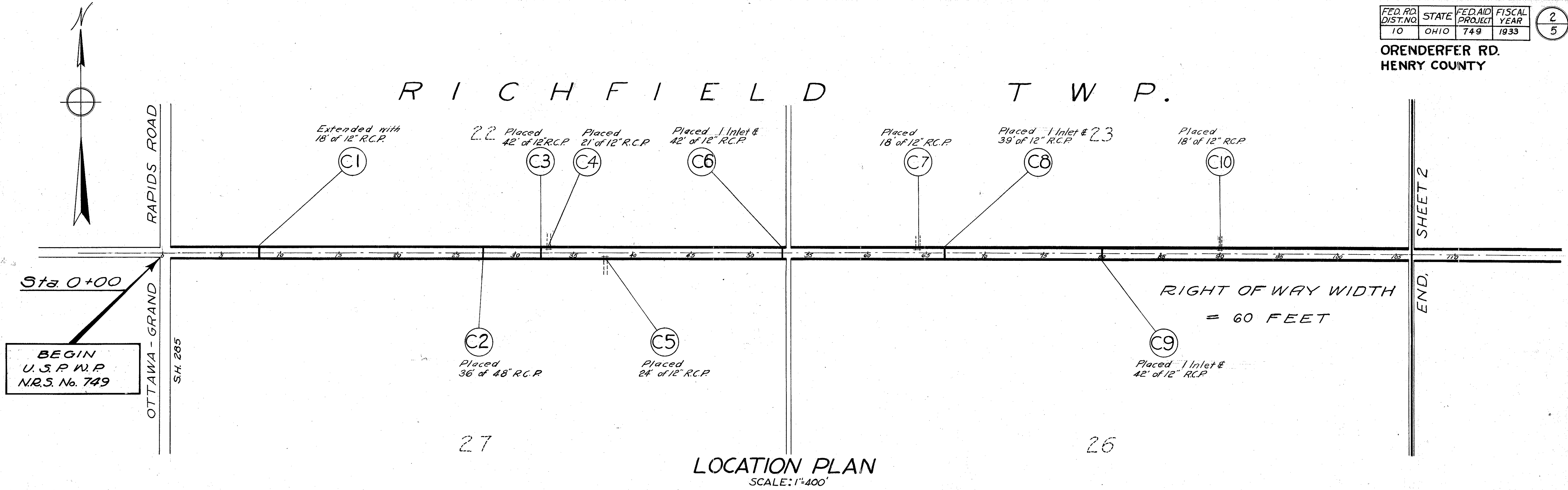



FED. RD. DIST. NO.	STATE	FED. AID PROJECT	FISCAL YEAR
10	OHIO	NRS 749	1933

3  
5

ORENDERFER RD.  
HENRY COUNTY

RICHFIELD TWP.

MILTON TWP.

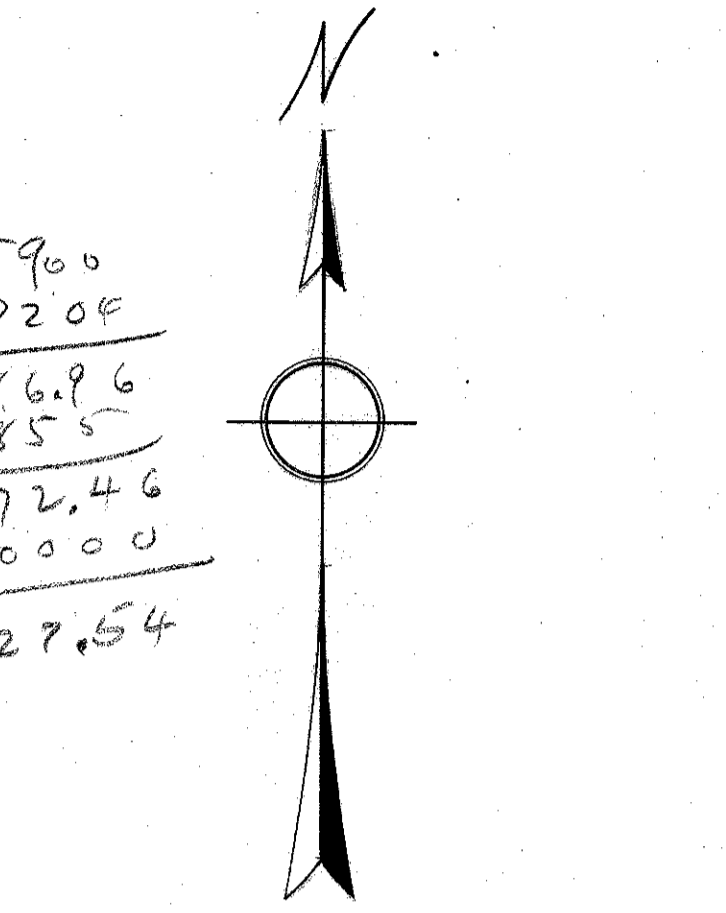
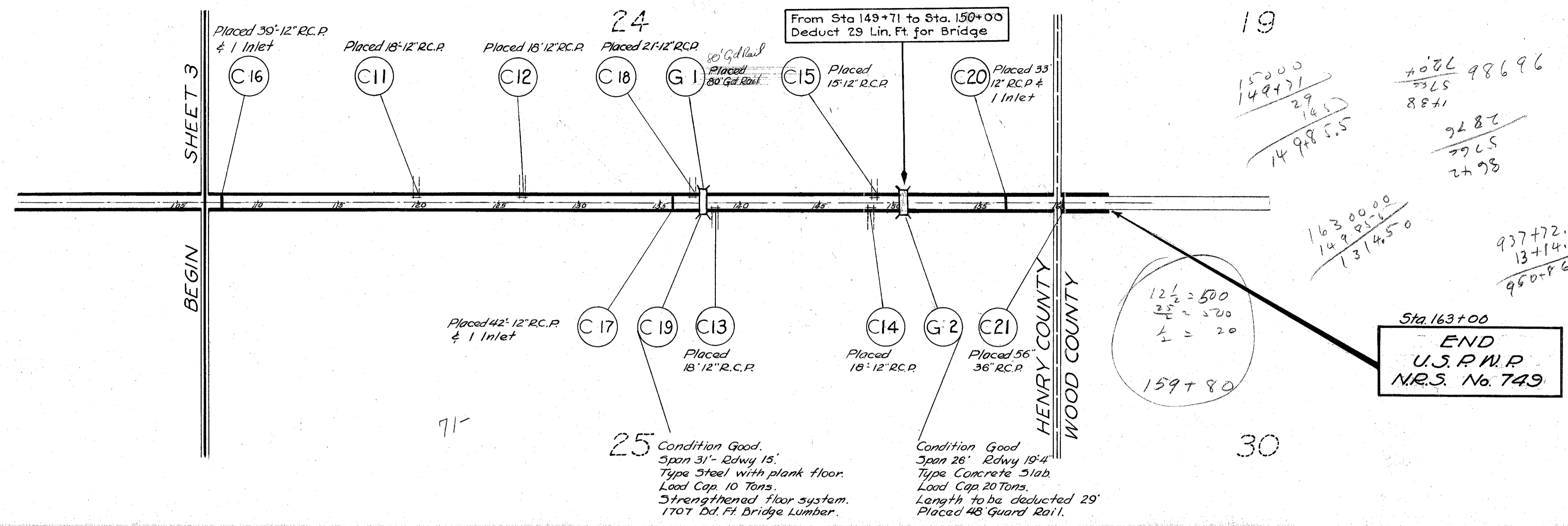

LOCATION PLAN  
SCALE: 1"=400'

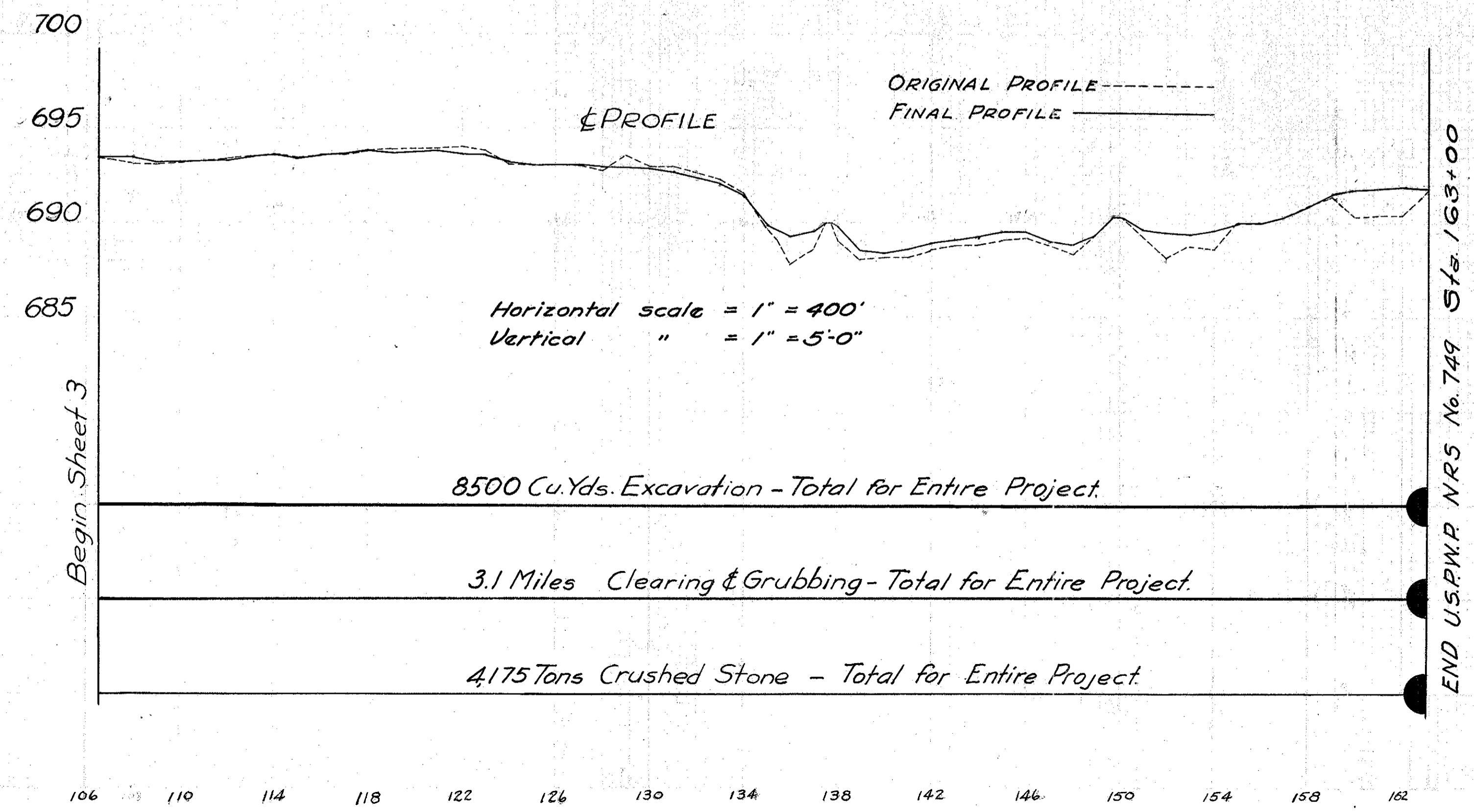

FED. RD. DIST. NO.	STATE	FED. AID PROJECT	FISCAL YEAR
10	OHIO	NR5749	1933

4  
5

**ORENDERFER ROAD  
HENRY COUNTY**

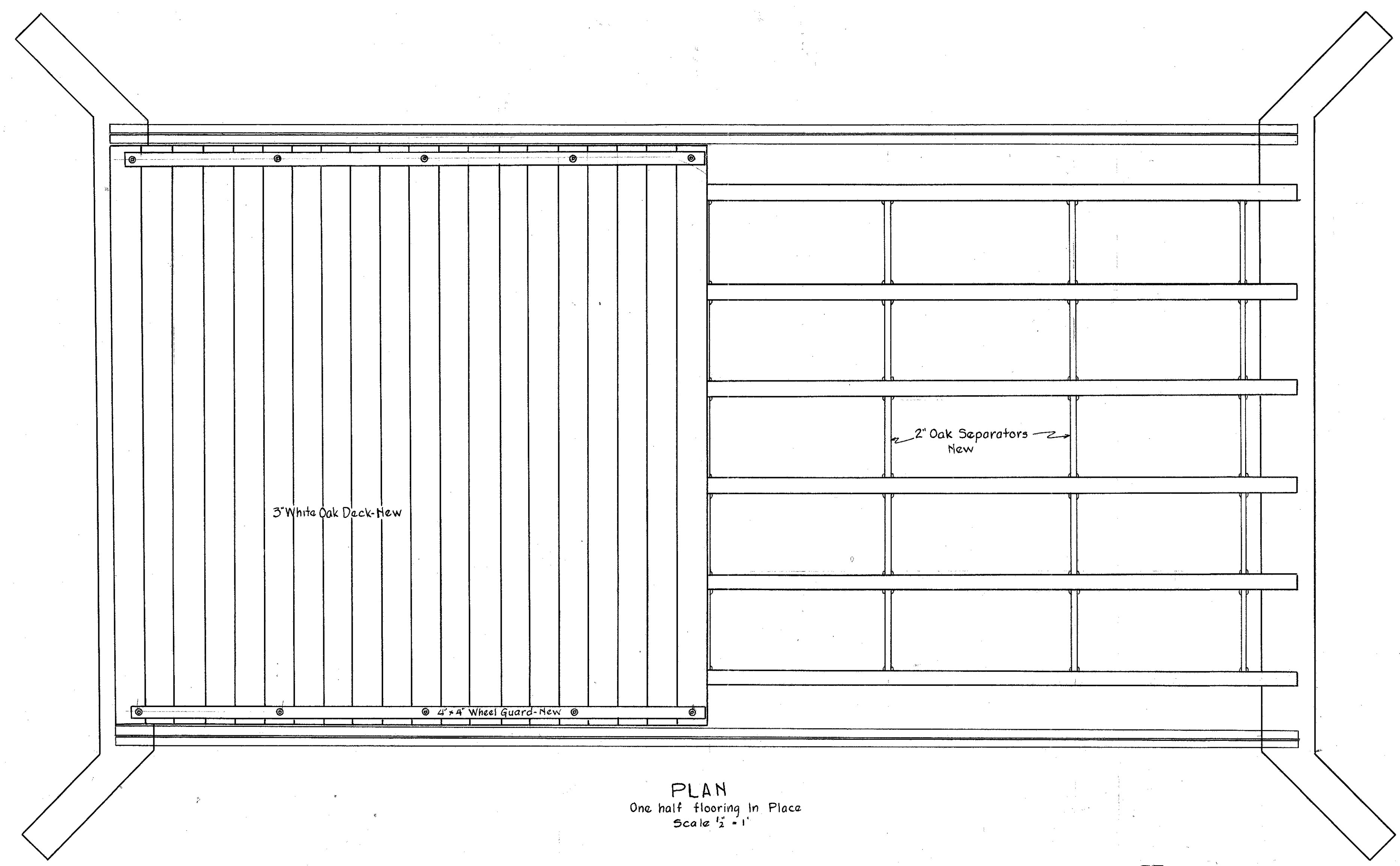

**PLAN**  
One half flooring in Place  
Scale 1/2" = 1'

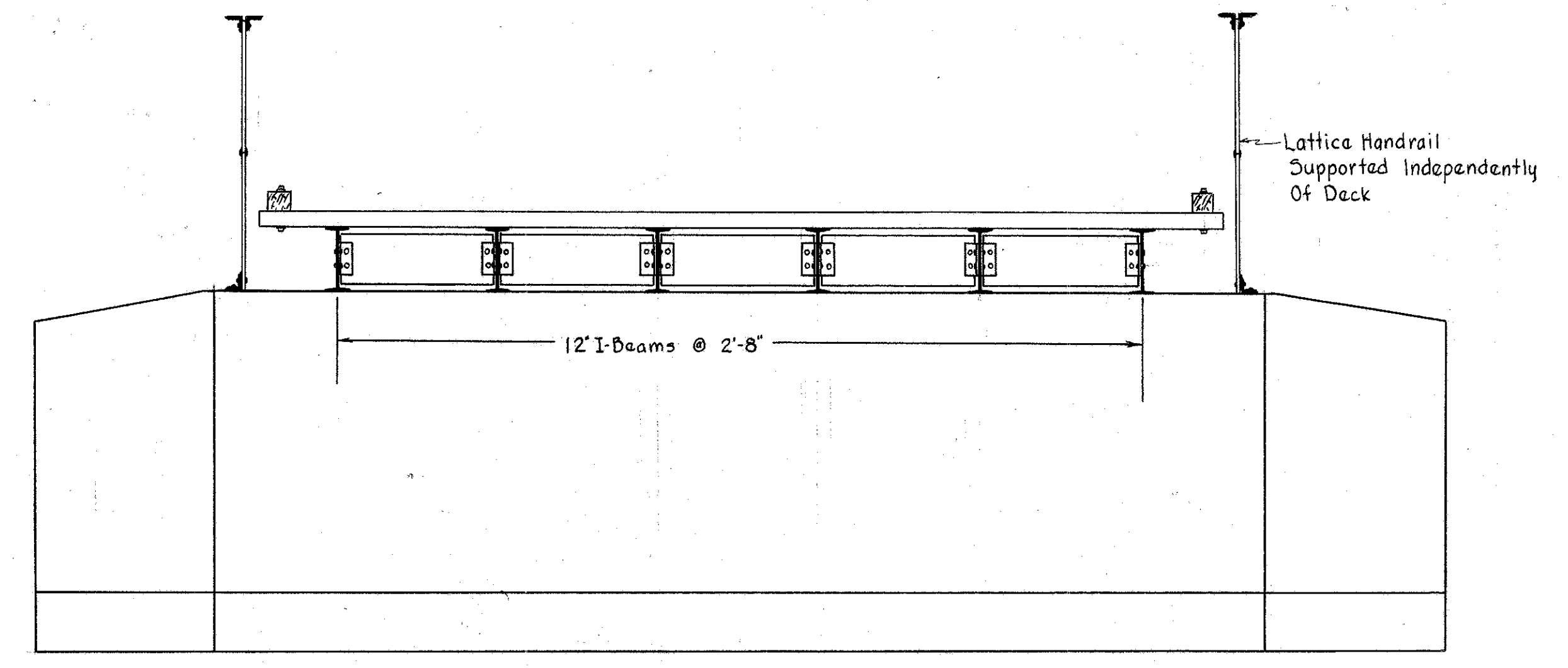

**TRANVERSE SECTION**  
Scale 1/2" = 1'

**BRIDGE AT STATION 137+55**  
SPAN 31 FT. ROADWAY 15 FT.  
WORK DONE:  
Replaced Wood Floor & Wheel Guards  
Placed Wood Separators

ORENDERFER RD.  
HENRY COUNTY

### GENERAL SUMMARY

	QUAN.	UNIT	UNIT COST	TOTAL COST
<b>ROADWAY</b>				
Excavation	8500	Cu. Yds.	0.30	2550.00
Clearing and Grubbing				274.32
Guard Rail	128	Lin. Ft.	0.50	64.00
Guard Posts	100	Each	1.70	170.00
Inlets	6	Each	16.00	96.00
12" R.C.P. Sec. M-6.6 - For Driveways	189	Lin. Ft.	1.90	359.10
<b>TOTAL ROADWAY</b>				<b>3513.42</b>
<b>PAVEMENT</b>				
Crushed Stone	4175.23	Tons	1.75	7306.65
<b>TOTAL PAVEMENT</b>				<b>7306.65</b>
<b>STRUCTURES 20' and UNDER</b>				
36" Reinforced Concrete Pipe Sec. M-6.6	56	Lin. Ft.	6.70	375.20
48" " " " " " " " "	36	" "	8.70	313.20
12" " " " " " " " "	297	" "	2.10	623.70
<b>TOTAL STRUCTURES 20' and Under</b>				<b>1312.10</b>
<b>STRUCTURES over 20'</b>				
Bridge Timber	1707	Bd. Ft.	.08	136.56
<b>TOTAL STRUCTURES over 20'</b>				<b>136.56</b>
<b>TOTAL ROADWAY PROPER, BRIDGES &amp; CULVERTS</b>				<b>12,775.31</b>
Premium on Industrial Insurance (7% 7238.82)				506.58
<b>TOTAL ROADWAY PROPER, BRIDGES &amp; CULVERTS</b>				<b>12,775.31</b>
Cost of Engineering, Superintendence and Contingencies				2319.47
<b>TOTAL COST AND EXPENSE</b>				<b>15,094.78</b>

### STRUCTURE SUMMARY

ITEM	STA.	PRESENT STRUCTURE	WORK COMPLETED	12" R.C.P. LIN. FT.	36" R.C.P. LIN. FT.	48" R.C.P. LIN. FT.	C. BASINS	BRIDGE LBR	GUARD RAIL Bd. Ft.	INLETS LIN. FT.
C-1	8+38		Extended X-over	18'						
C-2	26+54		Built X-over			36'				
C-3	32+43		" " "	42'						
C-4	32+75		Placed Pipe for Priv. Drive	21'						
C-5	37+90		" " " " "	24'						
C-6	52+80		Built X-over	42'						1
C-7	64+33		Placed Pipe for Priv. Drive	18'						1
C-8	66+55		Built X-over	39'						1
C-9	80+00		" " "	42'						1
C-10	90+00		Placed Pipe for Priv. Drive	18'						
C-11	119+75		" " " " "	18'						
C-12	126+36		" " " " "	18'						
C-13	138+33		" " " " "	18'						
C-14	147+75		" " " " "	18'						
C-15	148+33		" " " " "	15'						
C-16	107+50		Built X-over	39'						1
C-17	135+76		" " "	42'						1
C-18	137+00		Placed Pipe for Priv. Drive	21'						
C-19	137+55	Bridge No. 1	Strengthened Floor System					1707		
C-20	156+25		Built X-over	33'						1
C-21	157+90		" " "			56'				
G-1	137+55		Placed Guard Rail						80'	
G-2	149+85	Bridge No. 2	" " "						48'	
<b>TOTAL</b>				<b>486</b>	<b>56'</b>	<b>36'</b>		<b>1707</b>	<b>128'</b>	<b>6</b>

### TYPICAL CROSS SECTIONS

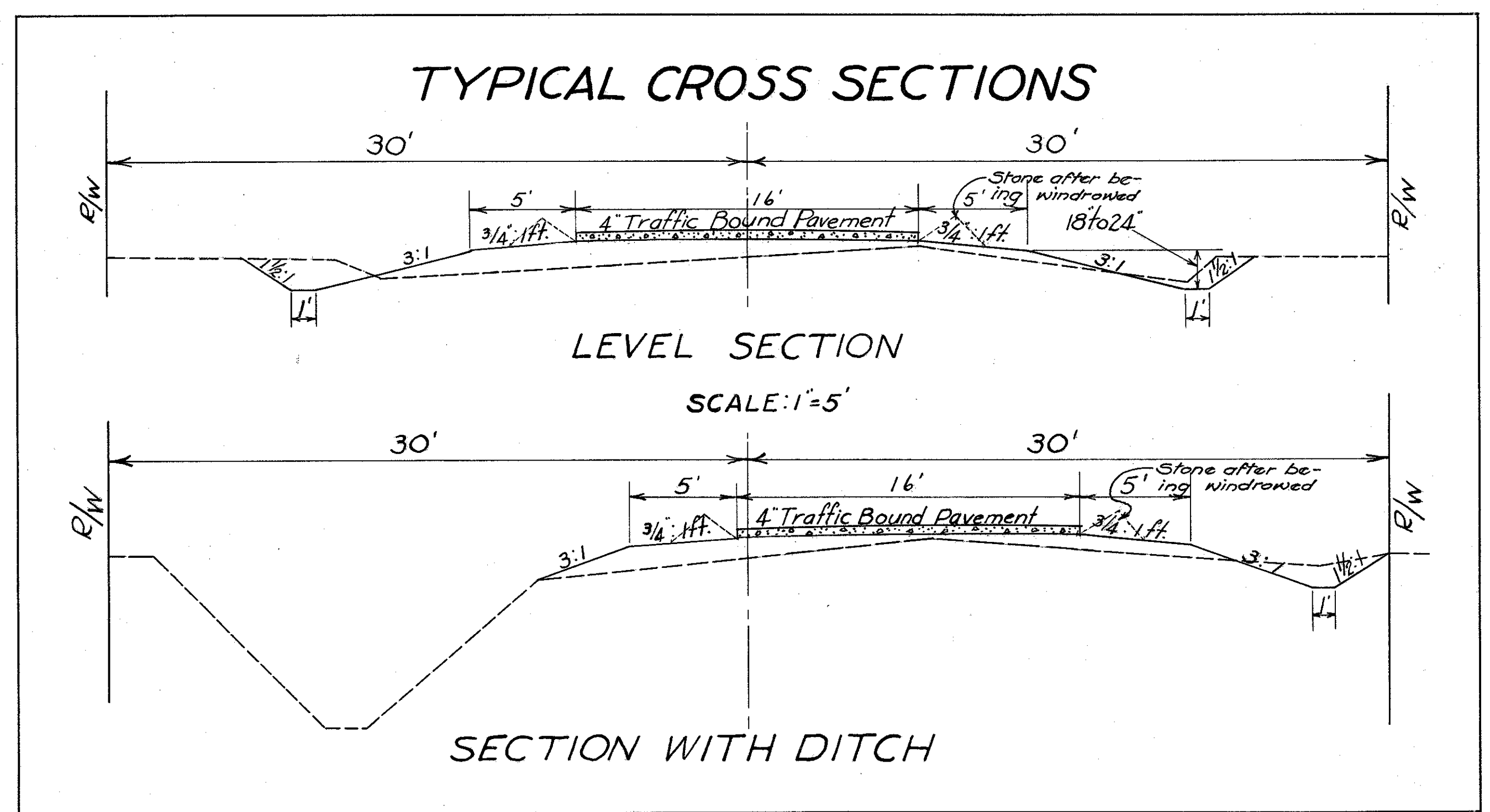

### LINE DATA

From Sta. 0+00 to Sta. 163+00 = Gross Length = 16,300 Ft.  
 Deductions  
 From Sta. 149+71 to Sta. 150+00 for Bridge = 29 Ft.  
 Net Length of Project 16,271 Ft. or 3.081 Miles

Length of Roadway  
 Sta. 0+00 to Sta. 137+39.5 13739.5  
 Sta. 137+70.5 to Sta. 149+71 1200.5  
 Sta. 150+00 to Sta. 163+00 1300.0  
 16,240 Ft. or 3.075 Miles

Length of Bridge  
 Sta. 137+39.5 to Sta. 137+70.5 31 Ft. or .006 Miles

Length of Project 16,271 Ft. or 3.081 Miles