

O.D.O.T. DISTRICT 2 SURVEY OFFICE (USE ONLY)

PERSONNEL _____ REFERENCE NO. 3 SHEET 3 OF 48
 NOTES HOMAN DATE 05/08/12 ROUTE SR 424
 H.C. ROUSOS WEATHER CLOUDY COUNTY HENRY
 R.C. HARBAUGH TEMP. 43° TOWNSHIP FLATROCK
 _____ SECTION 18
 _____ T 4 N R 6 E

TYPE MONUMENT 1/2" IRON ROD
 ON SURFACE - ~~BELOW~~ 0.2"
 LEFT - ~~C PAV'T~~ - ~~RIGHT~~ 16.4
5.0 TO LT EDGE PAVEMENT
 S.L.M. 29+32

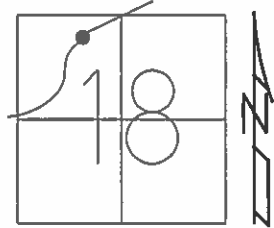

Grid: Northing: 603181.882 Easting: 1495627.933

RECORD:
 SLM STA. 29+84.4
 FD OK
 12/29/08
 #102
 REF4
 FD IPIN
 02/15/12, DCH

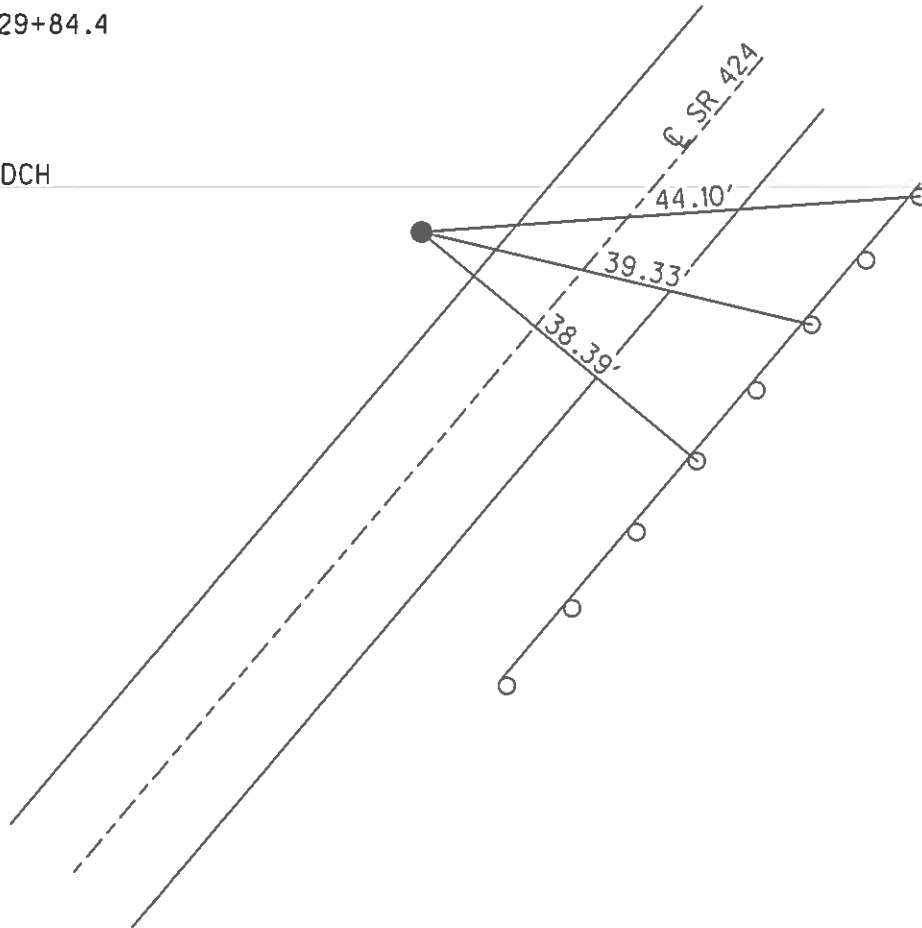

PERSONNEL TITLE PERSONNEL TITLE

Loays _____
 Fessenden _____
 Rutter _____
 Wise _____

COUNTY He.

DATE 12-14-54

S. R. 24

WEATHER Cloudy

SEC. Sta 0+00 = (Co. Line)

TEMP. 32°

DESCRIPTION

Witnesses to Central Points (PI) to _____ of survey

LEFT

CENTER LINE

RIGHT

JOB NO.

Note -

First (Spk shiners, etc) are placed in witnesses (trees, posts etc) on sides as shown in diagrams.

Note & of page above each central point is approx line of forward tangent

checked 4-12-62
 A.E.H.

PI Sta 11+07.39 (1/2" Iron Rod)
 $\Delta = 20^{\circ} 20' \text{ LT}$
 $D = 2^{\circ} 45'$
 $T = 373.64$

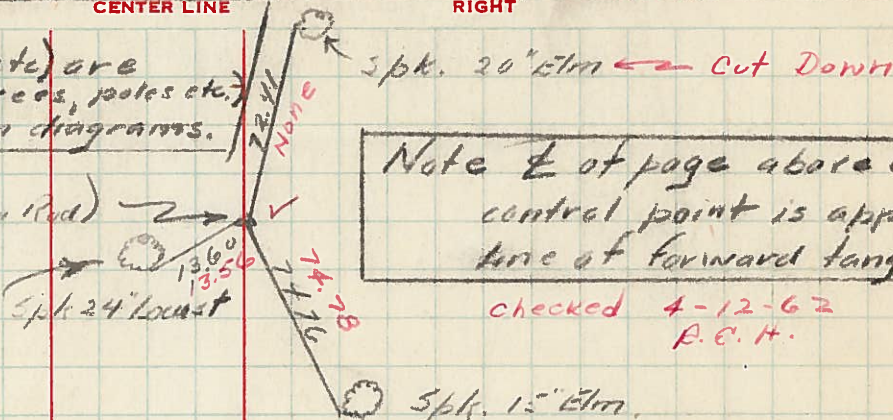

PI Sta 17+57.24 (1/2" Iron Rod)
 $\Delta = 13^{\circ} 25' \text{ LT}$
 $D = 3^{\circ} 00'$
 $T = 224.64$

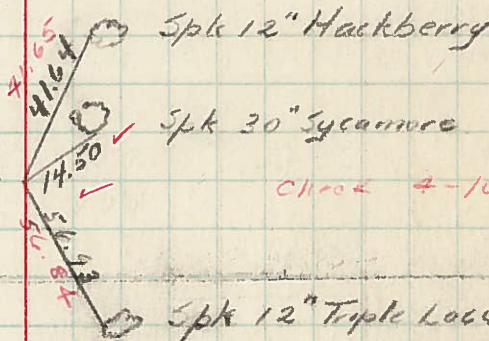

check 4-16-62

PI Sta 24+87.55 (Lag screw in Pavil)
 $\Delta = 2^{\circ} 35' \text{ RT}$
 $D = 1^{\circ} 00'$
 $T = 129.19$

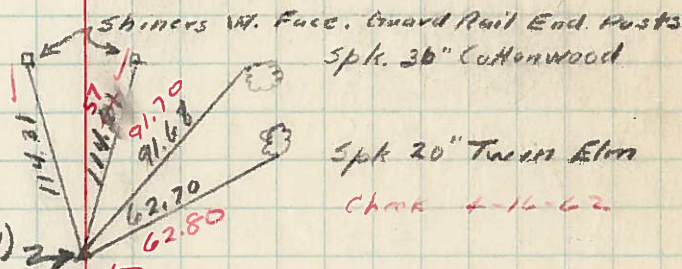

check 4-16-62

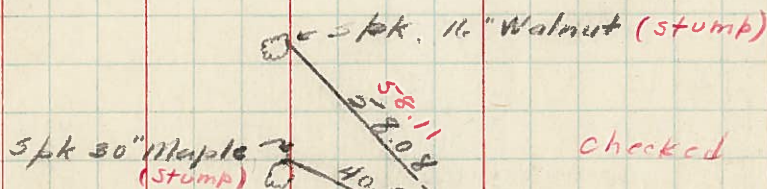

checked 4-16-62

PI Sta. 29+844 (1/2" Iron Rod)
 $\Delta = 21^{\circ} 48' \text{ RT}$
 $D = 6^{\circ} 30'$
 $T_s = 270.07$
 $\Delta_c = 8^{\circ} 48'$
 $L_s = 300'$

