

O.D.O.T. DISTRICT 2 SURVEY OFFICE (USE ONLY)

PERSONNEL _____ REFERENCE NO. 35 B SHEET 34 OF 48
 NOTES HOMAN DATE 03/09/12 ROUTE SR 424
 H.C. HOMAN WEATHER CLEAR COUNTY HENRY
 R.C. ROUSOS TEMP. 30° TOWNSHIP NAPOLEON
 _____ SECTION 35
 _____ T 5 N R 6 E

TYPE MONUMENT _____ P.K./WASHER _____
 ON SURFACE - ~~BELOW~~ _____ ON _____
~~LEFT - C PAV'T~~ - RIGHT _____ 12.4' _____
 1.2' TO RT EDGE PAVEMENT _____
 S.L.M. _____ 310+13.32 _____
 Grid: Northing: 616094.761 Easting: 1516767.662

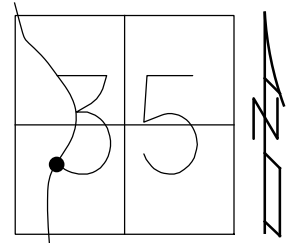

RECORD:
 STA. 310+57.79
 SET P.K./WASHER
 5/23/91, CL
 FD P.K./WASHER
 12/30/08
 B130
 REF34
 FD P.K.NAIL
 2/22/12, DCH

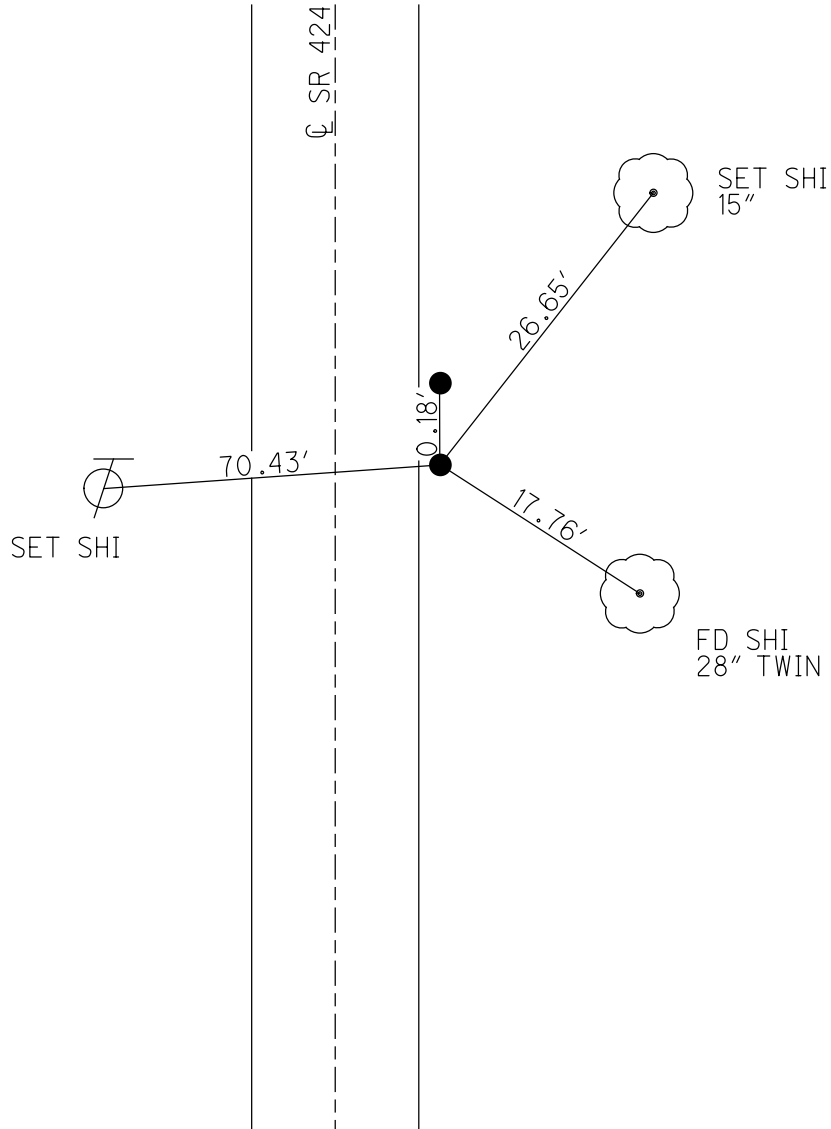

O.D.O.T. DISTRICT 2 SURVEY OFFICE

PERSONNEL

REFERENCE NO. 35A

SHEET 32 OF 43

NOTES HOFFMAN

H.C. LOHRKE

DATE 4-4-91

ROUTE SR 424

R.C. BARNHISEL

WEATHER CLEAR

COUNTY HENRY

TEMP. 50°

TOWNSHIP NAPOLEON

SECTION 35

T 5 N R 6 E

"A"

"B"

TYPE MONUMENT P.K./WASHER

P.K./WASHER

ON SURFACE - BELOW YES

YES

SET P.K./WASHER

~~LEFT - C. POINT~~ - RIGHT 12.4'

12.4'

BOTH POINTS

1.2' TO RT EDGE PAVEMENT

5-23-91

S.L.M. P.T. A = 310+27

CL.

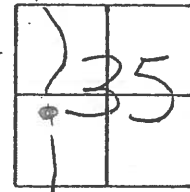

RECORD:

Sta. 310 + 57.79

