

O.D.O.T. DISTRICT 2 SURVEY OFFICE (USE ONLY)

PERSONNEL _____ REFERENCE NO. 39 B SHEET 2 OF 25
 NOTES HOMAN DATE 07/07/14 ROUTE SR 424
 H.C. LEU WEATHER CLOUDY COUNTY HENRY
 R.C. THOMAS TEMP. 70° TOWNSHIP NAPOLEON
 _____ SECTION 27
 _____ T 4 N R 6 E

TYPE MONUMENT 3/4" IRON ROD
~~ON SURFACE~~ - BELOW 3"
~~LEFT - C PAV'T~~ - RIGHT 30'
18.5 TO RT EDGE PAVEMENT
 S.L.M. 394+62
 Grid: Northing: 623945.343 Easting: 1514963.600

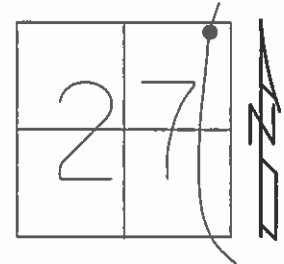

RECORD:
 NOTE: THIS POINT LAST
 LOCATED ON 1962 NOTES
 #142
 REF49
 FD 5/8" IPIN 2" DOWN
 02/22/12 DCH
 REFB39

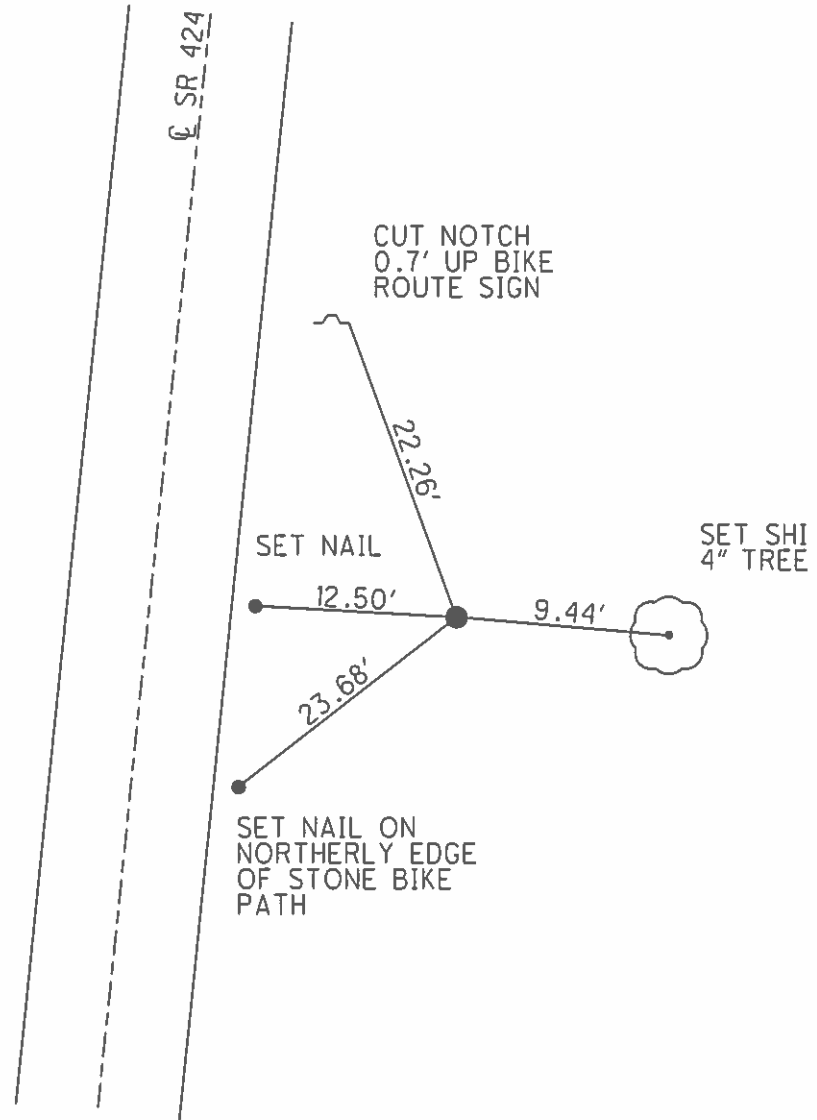

O.D.O.T. DISTRICT 2 SURVEY OFFICE

PERSONNEL

REFERENCE NO. 398

SHEET OF

NOTES BARNHISEL

H.C. CANTERBURY

R.C. BARNHISEL

DATE 1-12-04

WEATHER CLOUDY

TEMP. +38°

ROUTE S.R. 424

COUNTY HENRY

TOWNSHIP NAPOLEON

SECTION 27

T 5 N R 6 E

TYPE MONUMENT 3/4" IRON ROD

ON SURFACE - BELOW 3" DOWN

LEFT- & PAVT. - RIGHT 30' RT &

18.5 FT TO OF RT. EDGE PAVEMENT

S.L.M. 394 + 62

