

O.D.O.T. DISTRICT 2 SURVEY OFFICE (USE ONLY)

PERSONNEL

REFERENCE NO. 63 A

SHEET 12 OF 15

NOTES CURTIS

DATE 4/19/94

ROUTE (OLD) SR 424

H.C. CANTERBURY

WEATHER SUNNY

COUNTY HENRY

R.C. VOGEL

TEMP. 64°

TOWNSHIP LIBERTY

LOEHRKE

SECTION 9

DWG BY NIESE PID \_\_\_\_\_

T 5 N R 7 E

TYPE MONUMENT P.K. NAIL

ON SURFACE - ~~BELOW~~ ON

OFFSET ☉ PAVEMENT 3.0' LT : ~~RT~~

11.0' TO LT EDGE PAVEMENT

STATION: 763+35

HORZ. DATUM: \_\_\_\_\_

GEOID: \_\_\_\_\_

GRID: NORTHING: \_\_\_\_\_

EASTING: \_\_\_\_\_

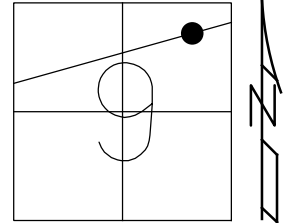

RECORD:  
FD P.K. NAIL  
4/19/94, MC

DIST.63-63A= 26.38'  
DIST.63A-63B= 22.62'

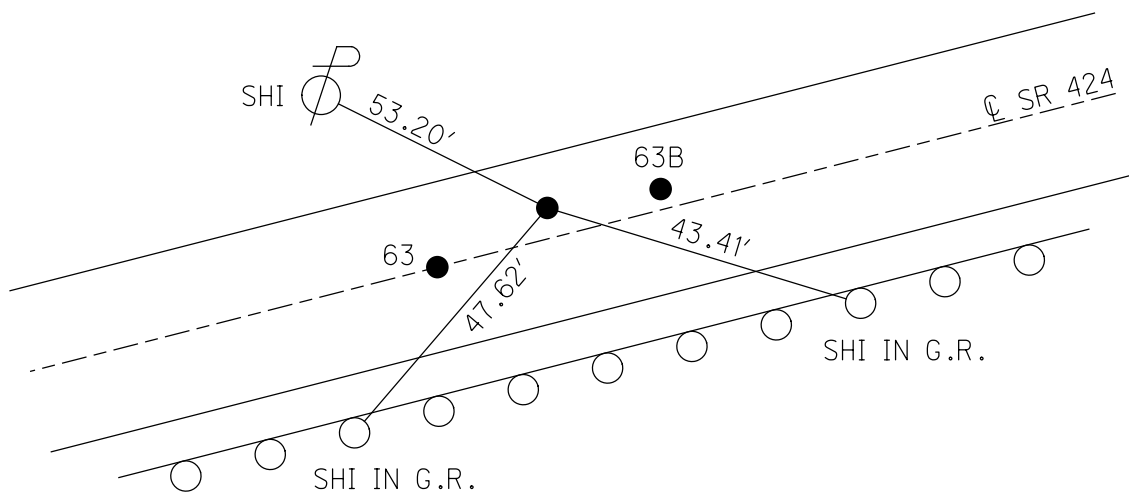

# O.D.O.T. DISTRICT 2 SURVEY OFFICE

PERSONNEL

REFERENCE NO. 63-63A  
63B

SHEET 23 OF 26

NOTES J. CURTIS

H.C. CANTERBURY

R.C. VOGEL

LOENKE

DATE 4-19-94

WEATHER M. SUNNY

TEMP. +64

ROUTE OLD S. R. 424

COUNTY HENRY

TOWNSHIP LIBERTY

SECTION 9

T 5 N R 7 E

63 = SURVEYERS CAR  
63-A = P.K. NAIL  
63-B = P.K. NAIL

TYPE MONUMENT 63-A = P.K. NAIL

ON SURFACE - BELOW ALL PTS ON SURFACE

LEFT - 63 - ON E (63-A) 3' Lt. E (63-B) 2.2' Lt. E

11' to L. ED. 12.2' to L. ED.

TO EDGE PAVEMENT

S.L.M. (63) = 763+09 (63-A) = 763+35 (63-B) = 763+58

