

O.D.O.T. DISTRICT 2 SURVEY OFFICE (USE ONLY)

PERSONNEL \_\_\_\_\_ REFERENCE NO. 64 SHEET 14 OF 15  
 NOTES CURTIS DATE 4/19/94 ROUTE (OLD) SR 424  
 H.C. CANTERBURY WEATHER SUNNY COUNTY HENRY  
 R.C. VOGEL TEMP. 64° TOWNSHIP LIBERTY  
 \_\_\_\_\_ LOEHRKE \_\_\_\_\_ SECTION 9  
 DWG BY NIESE PID \_\_\_\_\_ T 5 N R 7 E

TYPE MONUMENT P.K. NAIL  
 ON SURFACE - ~~BELOW~~ ON  
 OFFSET Q PAVEMENT ON LT : RT  
11.9' TO LT EDGE PAVEMENT  
 STATION: 765+28  
 HORZ.DATUM: \_\_\_\_\_ GEOID: \_\_\_\_\_  
 GRID: NORTHING: \_\_\_\_\_ EASTING: \_\_\_\_\_

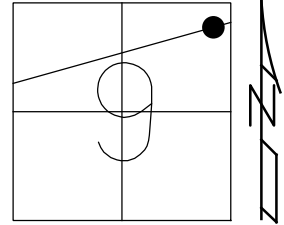

RECORD:  
 FD P.K. NAIL  
 4/19/94, MC

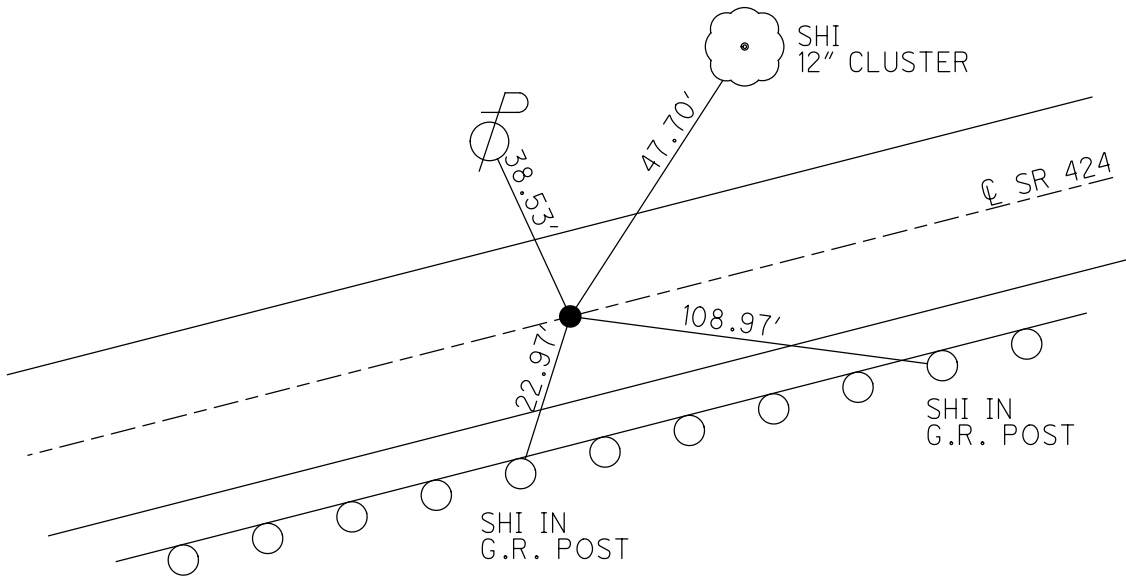

# O.D.O.T. DISTRICT 2 SURVEY OFFICE

PERSONNEL \_\_\_\_\_

REFERENCE NO. 64

SHEET 24 OF 26

NOTES D. CURTIS

H.C. CANTERBURY

R.C. VOGEL

LOEHRKE

DATE 4-19-94

WEATHER Sunny

TEMP. +64

ROUTE OLD S. R. 424

COUNTY HENRY

TOWNSHIP LIBERTY

SECTION 9

T 5 N R 7 E

TYPE MONUMENT P.K. NAIL

ON SURFACE - BELOW ON SURFACE

LEFT - ON PAV'T. - RIGHT ON PAV'T.

11.9 TO LT EDGE PAVEMENT

S.L.M. 765+28

