

INDEX

Title page	p. 1
Plans & Profiles	p. 2
Typical Cross Section	p. 3&4
Cross Sections	p. 3&4

File # 68

STATE HIGHWAY DEPARTMENT OF OHIO

BUREAU OF CONSTRUCTION

SEC. H-1-TOLEDO-WAUSEON ROAD.

I.C.H. No. 20.

LUCAS COUNTY

SPRINGFIELD TWP. MARCH 1918.

PETITION 3269

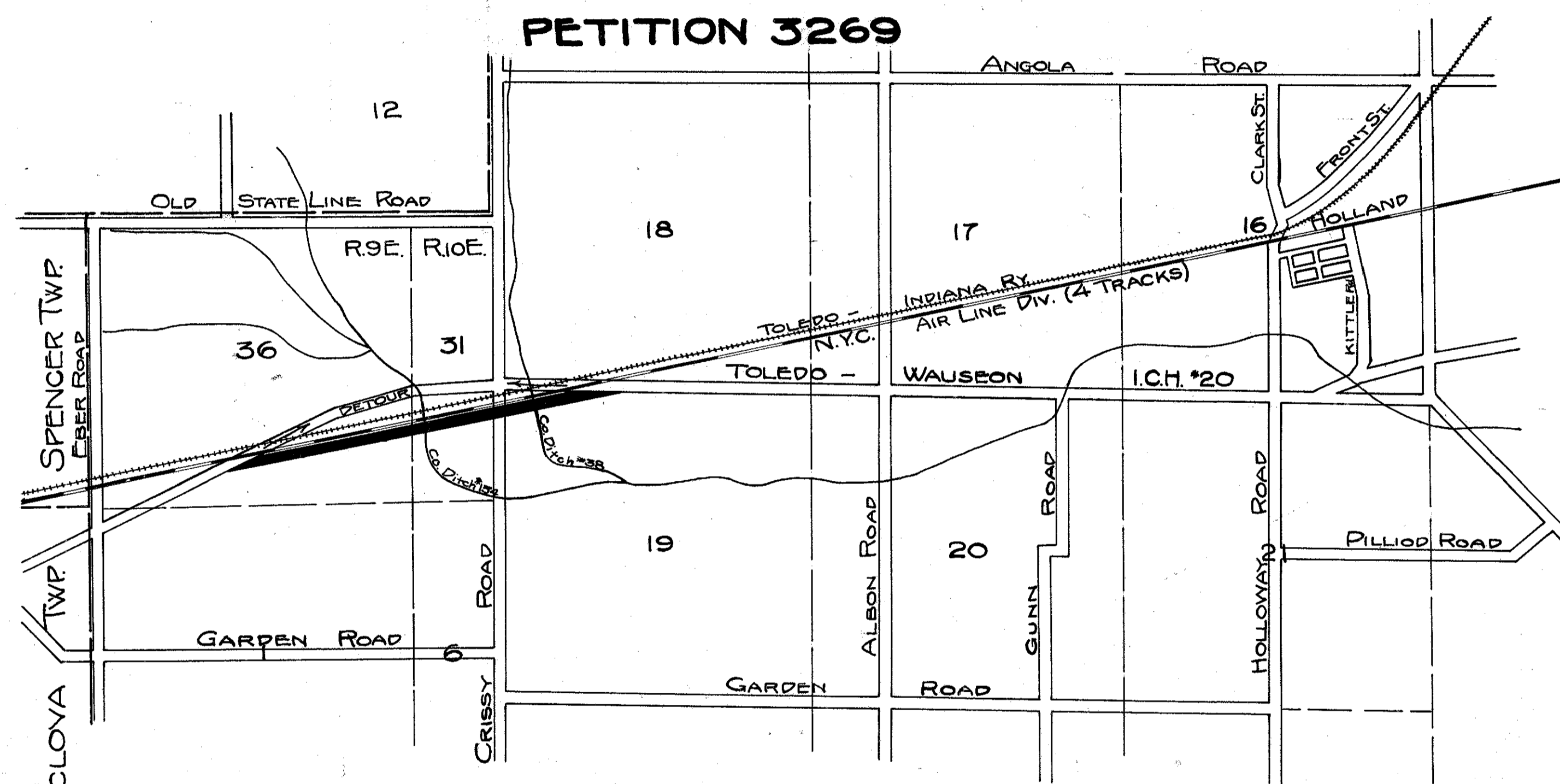

LOCATION PLAN

SCALE - 3" = 1 mile
PORTION TO BE IMPROVED

CONVENTIONAL SIGNS

State Line	-----
County Line	-----
Township Line	-----
Section Line	-----
Property Line	-----
Center Line	-----
City or Village Line	-----
Steam Railroad	-----
Electric Line	-----

SCALES

Plan	1" = 100'
Profile (Vertical)	1" = 10'
Profile (Horizontal)	1" = 100'
Cross Sections	1" = 50'

Approved: *Ch. Road*
Date: 5-17-1918 County Surveyor

We, the Commissioners of Lucas County, hereby approve these plans and certify that the right-of-way is available for the construction of the above highway.

Signed: *W. B. Brant*
C. J. Compton
W. J. Kelly
Date: July 2 County Commissioners

I hereby approve these plans and declare that the making of the improvement will require the closing to traffic of the highway and that the detours will be indicated by signs as shown on the plans and estimates.

Approved: *D. V. Seitz*
Date: 7-5-18 Division Engineer.

Approved: *A. D. Pruning*
Date: 7-6-18 Chief Highway Engineer.

Approved: *Simon Colson*
Date: 7-9-18 State Highway Commissioner.

CONSTRUCTION
BUREAU
JUN 28 1918
GROUND PHOTOLAB

99
02 LUCAS - 20 - H-1

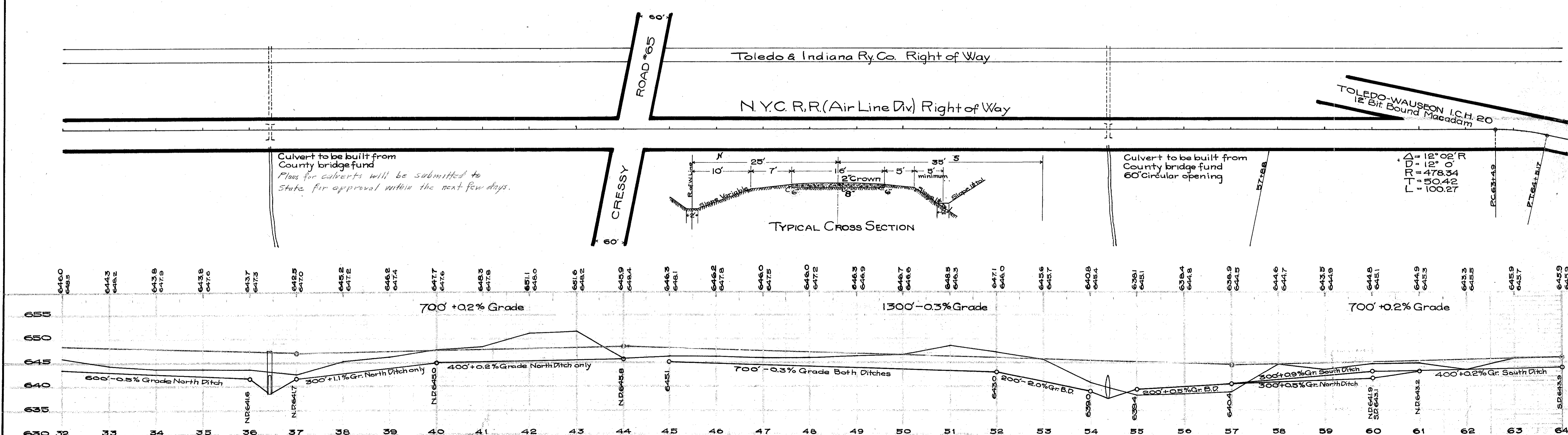
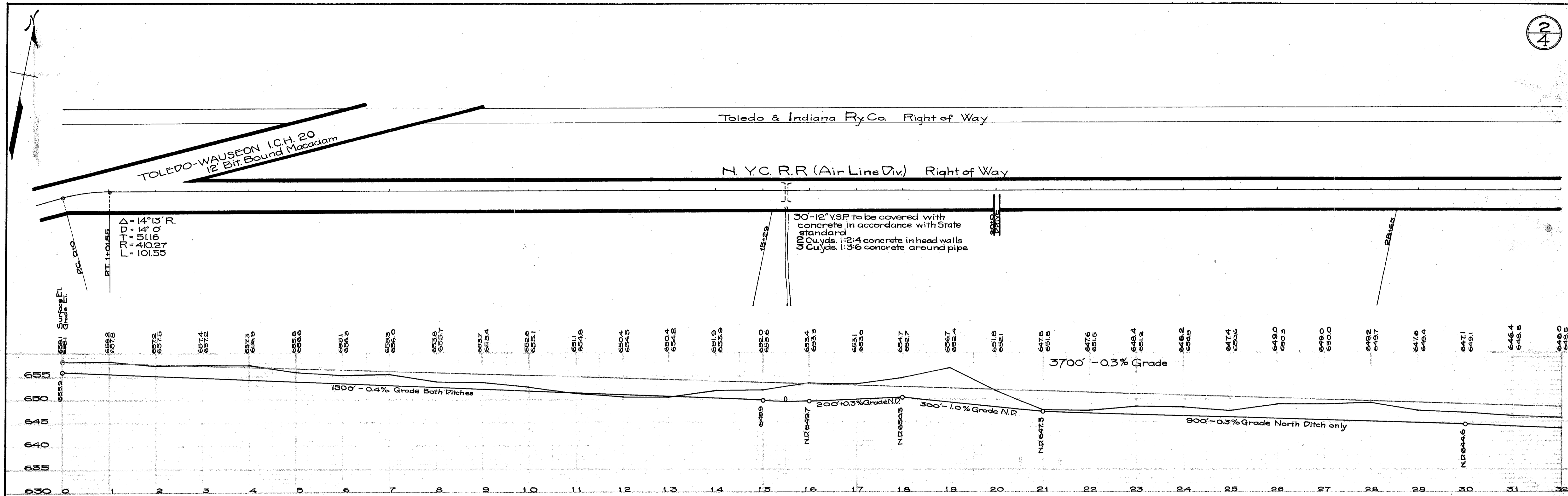

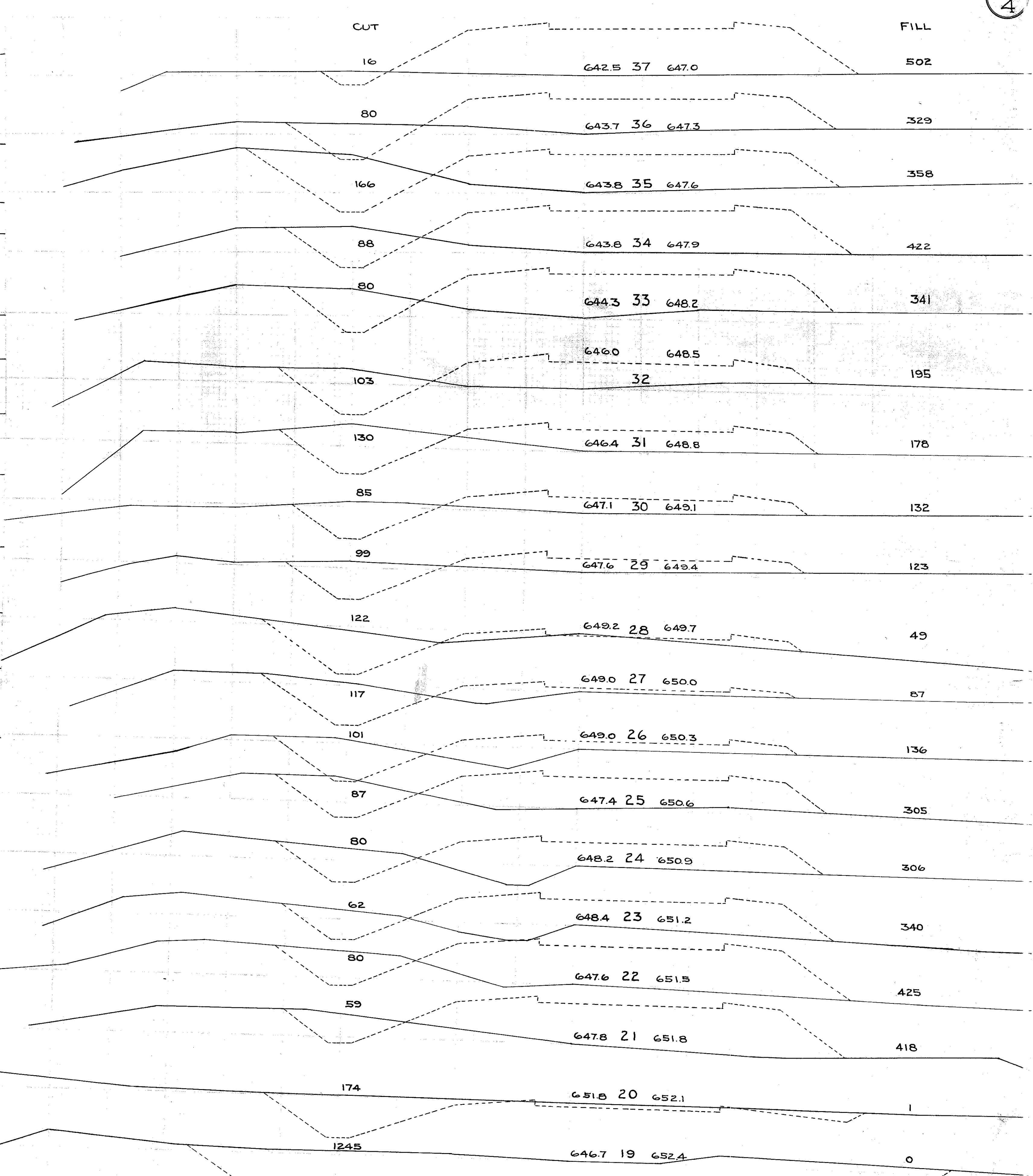
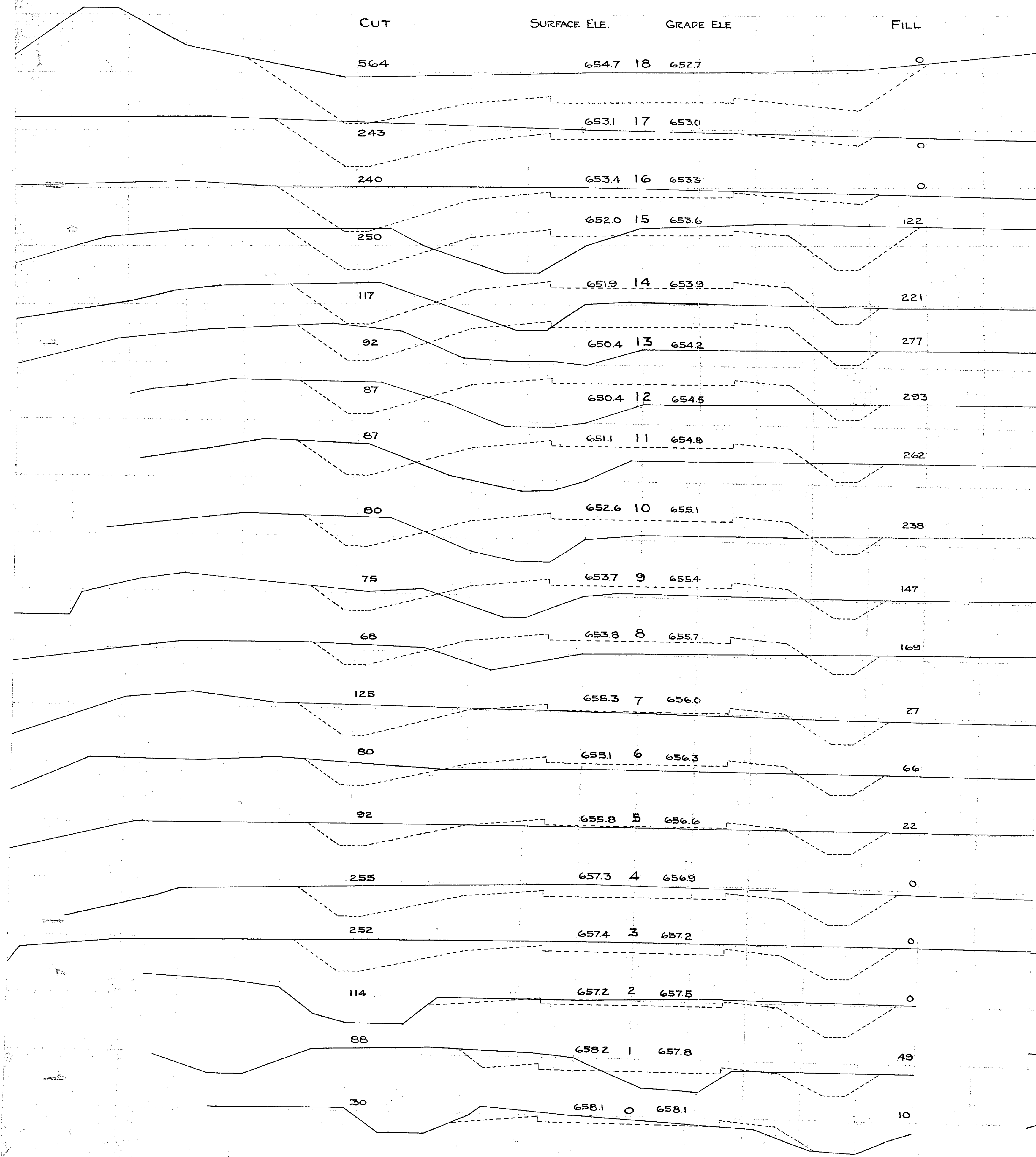

Total Cut 11589

Total Fill 11117

