

FED. NO. DIST. NO.	STATE	PROJECT	FISCAL YEAR
10	OHIO		1944

1
6

LUCAS COUNTY
S. H. 53, SEC. TOLEDO (PT.)
ANTHONY WAYNE BRIDGE

STATE OF OHIO
DEPARTMENT OF HIGHWAYS

TOLEDO ~ GRAND RAPIDS ROAD
S. H. 53.
LUCAS COUNTY
CITY OF TOLEDO

CONVENTIONAL SIGNS

COUNTY LINE	-----
TOWNSHIP LINE	- - - - -
SECTION LINE	-----
CORPORATION LINE	-----
PROPERTY LINE	-----
FENCE LINE	- x - x - x - x -
CENTER LINE	-----
STEAM RAILROAD	=====
POLE LINE	-----
HEDGE	~~~~~
DRAIN PIPE (NEW)	-----
DRAIN PIPE (OLD)	-----
GUARD RAIL	-----

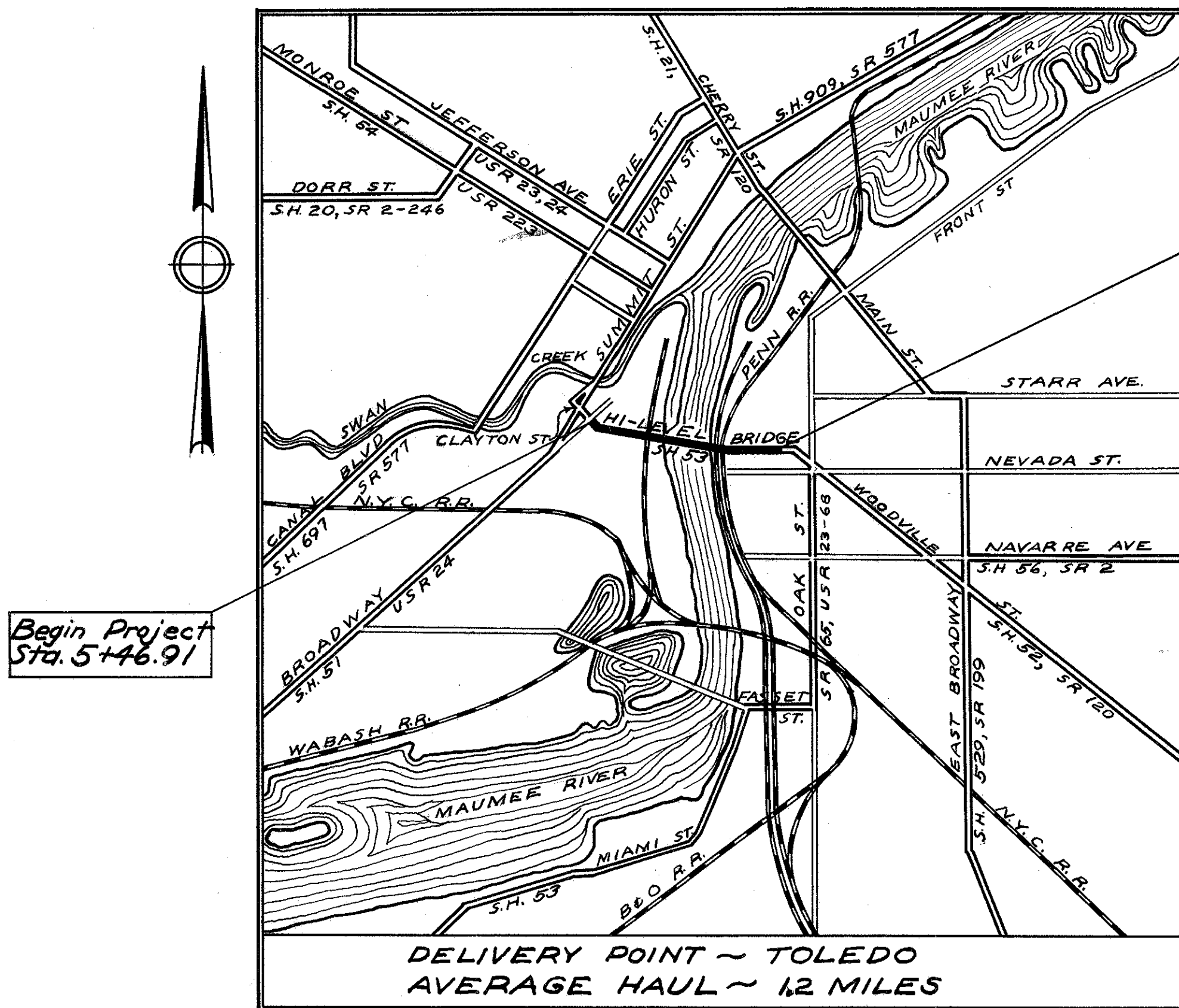

The Standard Specifications of the State of Ohio, Department of Highways, including changes and Supplemental Specifications listed in the proposal shall govern this improvement.

I hereby approve these plans and declare that the making of this improvement will not require the closing to traffic of the highway and that provisions for the maintenance and safety of traffic will be as set forth on the plans and estimates.

The right of way necessary for this improvement will be provided by the State of Ohio.

Approved: _____
Date: 5-7-44 Resident Division Deputy Director

Approved: _____
Date: _____ Chief Engineer Bureau of Maintenance

Approved: _____
Date: _____ Chief Engineer Bureau of Bridges & R.R. Crossings

Approved: _____
Date: 6-12-44 Chief Engineer Bureau of Location & Right of Way

Approved: _____
Date: 6-13-44 First Asst. Director & Chief Engineer

Approved: _____
Date: 6-13-44 Director of Highways.

Approved for the City of Toledo, Ohio.

Approved: _____
Date: _____ Director of Public Service.

INDEX OF SHEETS

TITLE SHEET	1
TYPICAL SECTIONS	2
PLAN & PROFILE	3-5
GENERAL NOTES, SUMMARY	6

LINE DATA

Begin Project Sta. 5 + 46.91
End Project Sta. 43 + 00
Gross Length - Net Length = 3753.09 Lin. Ft.
or 0.710 Miles.

LOCATION PLAN
Scale 1 inch = 2000 Feet

PORTION TO BE IMPROVED
STATE HIGHWAYS
OTHER STREETS

SCALES

PLAN 1" = 50'
PROFILE, HORIZONTAL 1" = 50'
PROFILE, VERTICAL 1" = 10'



FILE NO.	LUCAS COUNTY
	S. H. 53, SEC. TOLEDO (PT.)
	DATE OF LETTING 194
	CONTRACT NO.

STANDARD DRAWINGS	
G - 7.07	6-1-42

SUPPLEMENTAL SPECIFICATIONS			
177	Rev. 4-21-44	T-170.15	8-2-43
M-102.12	8-2-43		
T-370.05	1-12-43		

TYPICAL SECTION TYPE T-35

SCALE 1/4"=1'

FED. RD. DIST. NO.	STATE	PROJECT	FISCAL YEAR	2 6
10	OHIO		1944	

LUCAS COUNTY
S.H. 53 SEC. TOLEDO (PT.)
ANTHONY WAYNE BRIDGE

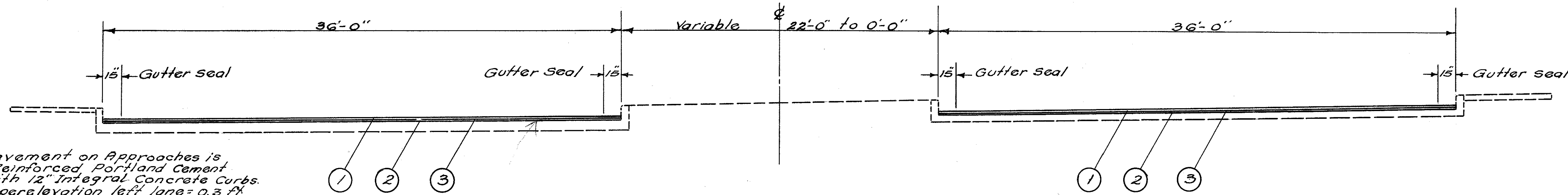

Note: Existing Pavement on Approaches is 9" uniform Reinforced Portland Cement Concrete with 12" Integral Concrete Curbs. Maximum Superelevation left lane = 0.3 ft. Maximum Superelevation right lane = 0.44 ft. No additional Superelevation required.

The above Section applies from Sta 5+61.8 to Sta 8+26.06 = 264.26 Lin. Ft.

- ① Item T-35, 1 1/4" Asphaltic Concrete Surface Course, Type "B" or Type "B" Modified, as per Special Provisions
- ② Item T-30, Bituminous Prime Coat using Bituminous Material, Sec. M-5.12 AE-3, applied at the rate of 0.10 gal. per sq. yd., including Sand Cover
- ③ Item B-35, 1" Minimum Thickness, Asphaltic Concrete Leveling Course.
- ④ Item T-70, 4"-7"-4" Portland Cement Concrete for Dividing Strip ~ As per Detail.

Note: Transition in Pavement width, Sta. 8+26.06 to Sta. 9+86.8 = 160.74 Lin. Ft.

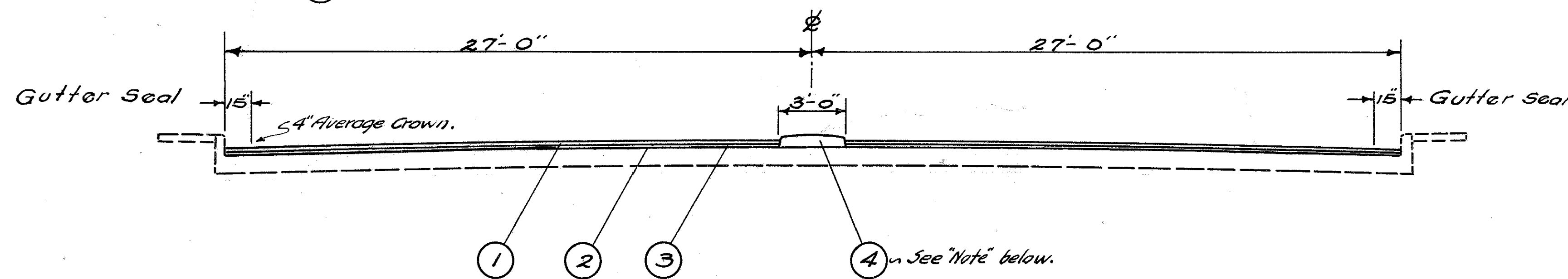

Note: Existing Pavement on Structure is a 9" Reinforced Portland Cement Concrete. Crown ~ Approximately 4 inches.

The above section applies from Sta. 9+86.8 to Sta. 42+82.74 = 3295.94 Lin. Ft.
Deductions for 14 Expansion Joints on Bridge ~ See Summary, Sheet 6 = 44.30 Lin. Ft.
Net Length Typical Section - Approaches and Suspension Span = 3251.64 Lin. Ft.

Note: 4"-7"-4" Portland Cement Concrete for Dividing Strip (Ref. 4) is to start at Sta. 9+49.24 and to end at Sta. 42+82.74 ~ Gross Length = 3333.50 Lin. Ft.
Deductions for 14 Expansion Joints on Bridge ~ See Summary, Sheet 6 = 44.30 Lin. Ft.
Net Length of Dividing Strip = 3289.20 Lin. Ft.

Designation	Width	Raise
Joint A	2.8'	3"
Joint B	2.8'	3"
Joint C	2.8'	3"
Joint D	3.1'	3"
Joint E	7.2'	2 1/2"
Joint F	7.25'	2 1/2"
Joint G	3.2'	3"
Joint H	2.8'	3"
Joint I	2.9'	3"
Joint J	3.0'	3"
Joint K	1.6'	3"
Joint L	1.65'	3"
Joint M	1.6'	3"
Joint N	1.6'	3"

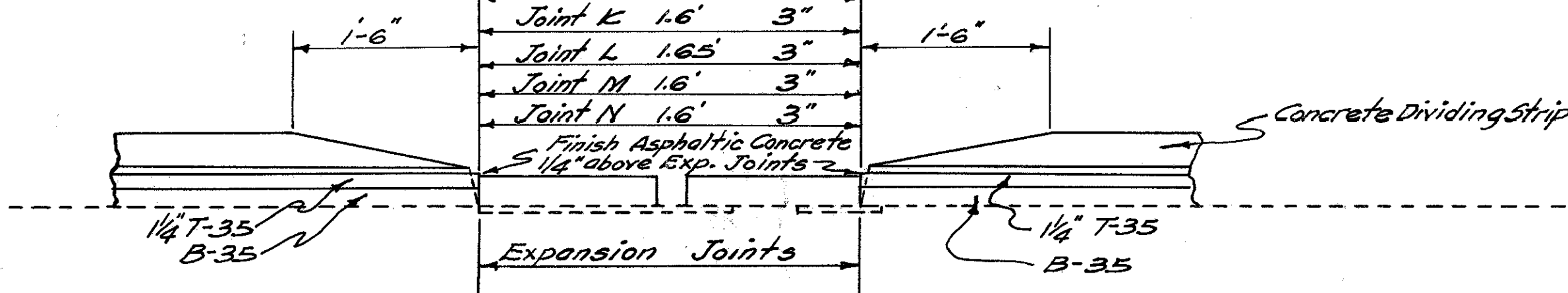

DETAIL SHOWING ASPHALTIC CONCRETE ADJACENT TO RAISED EXPANSION JOINTS

Note: The new Asphaltic Concrete Surface Course shall be finished 1/4" above Expansion Joints but shall be constructed to the course thicknesses (2 1/4") between said Expansion Joints. The increase in thickness (2 1/4" to 3 1/4") shall be accomplished in a 25 ft. distance.

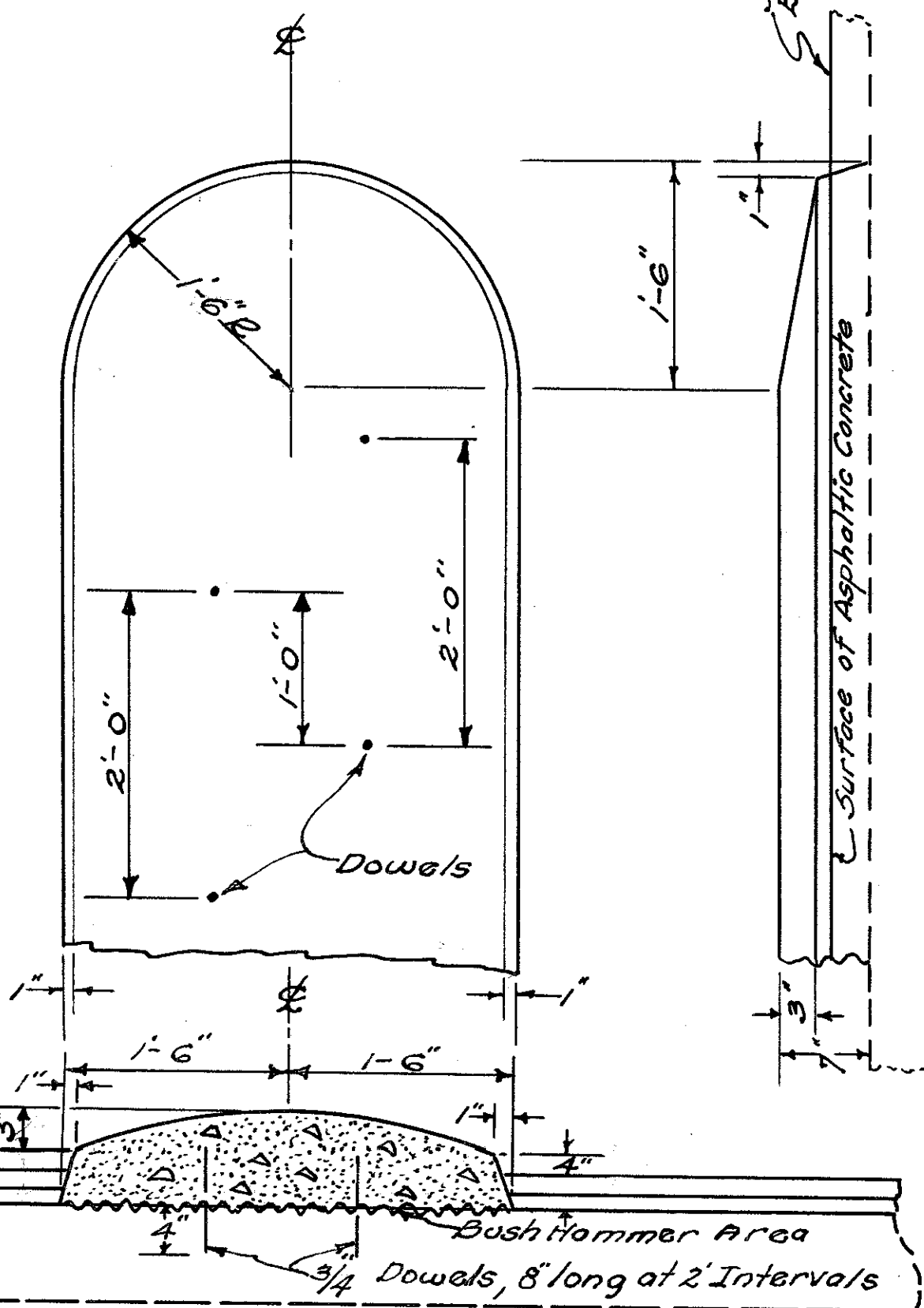

DETAIL OF PORTLAND CEMENT CONCRETE DIVIDING STRIP ~ To be constructed on 54 ft. width Bridge and Approach Pavement.

Note: The area upon which the 4"-7"-4" Portland Cement Concrete is to be placed shall be bush hammered as indicated and 3/4" dowels shall be furnished and placed. The bush hammering and the furnishing and placing of 3/4" dowels is included in the unit price bid per square yard for 4"-7"-4" Portland Cement Concrete for Dividing Strip.

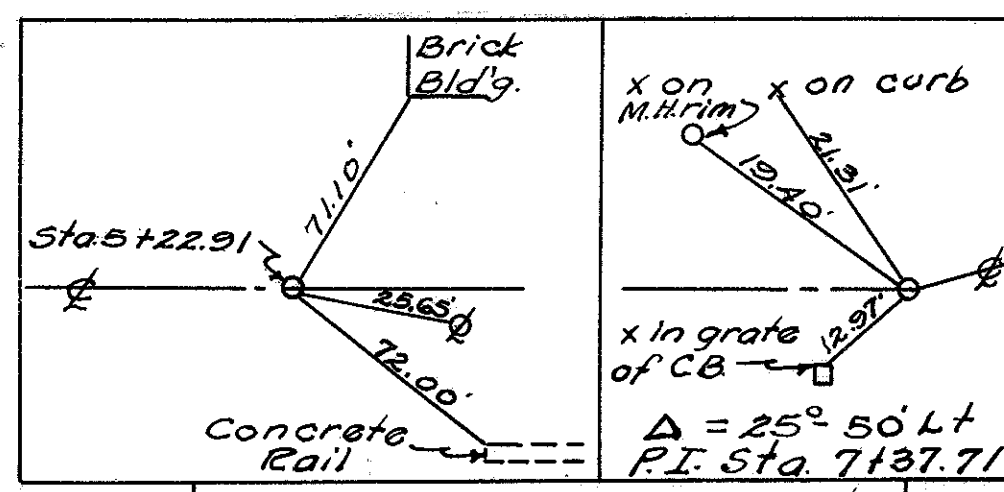
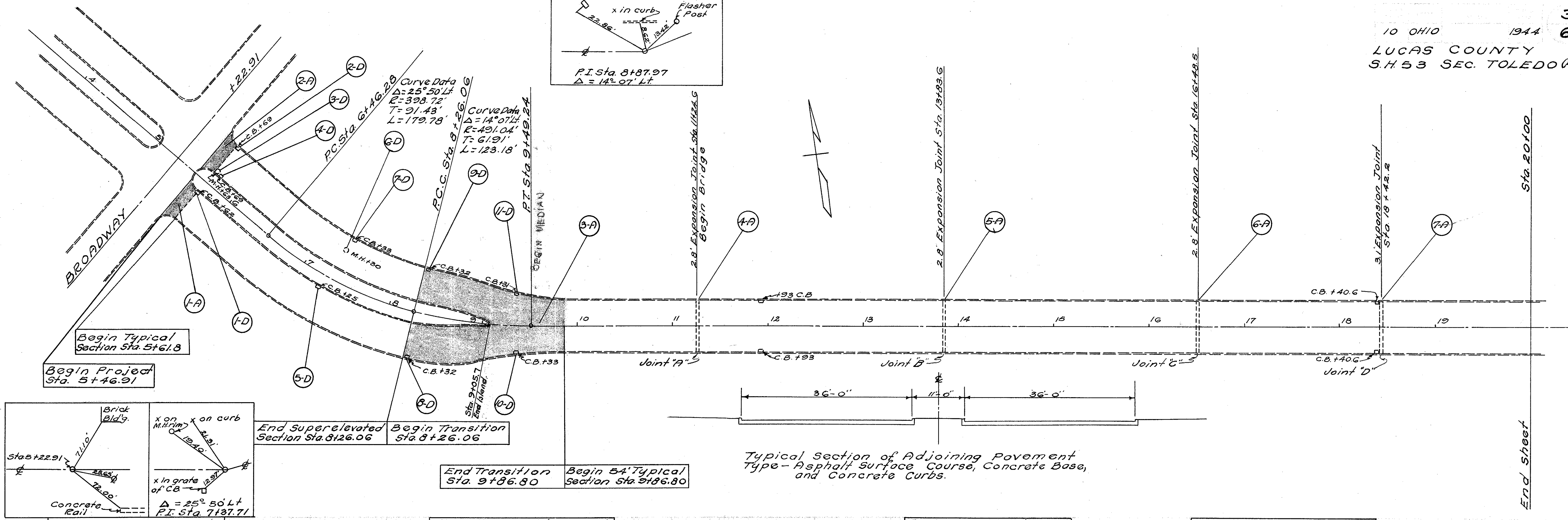

End Superelevated Section Sta. 8+26.06
 Begin Transition Section Sta. 8+26.06

End Transition Section Sta. 9+86.80
 Begin 54' Typical Section Sta. 9+86.80

Typical Section of Adjoining Pavement Type - Asphalt Surface Course, Concrete Base, and Concrete Curbs.

B.M. in concrete W. end Bridge Rail 53 ft. Rt. Sta. 5+70 Elev. 613.52

B.M. in concrete E. end Island Sta. 9+04 Elev. 623.04

B.M. in concrete walk 33 ft. Rt. Sta. 14+70 Elev. 647.87

B.M. in concrete walk 33 ft. Rt. Sta. 17+49 Elev. 660.13

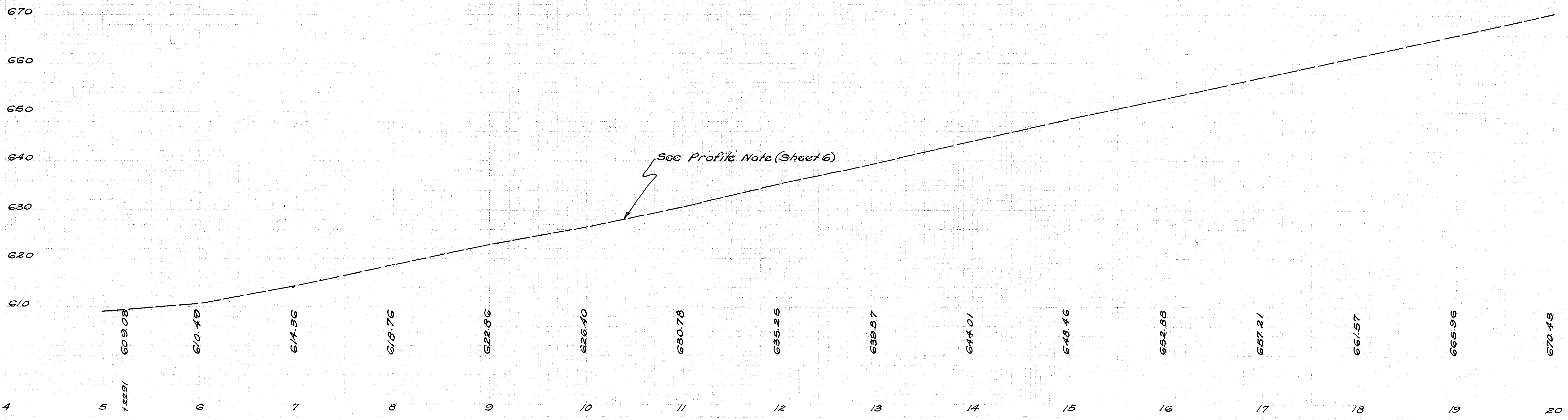

End Sheet

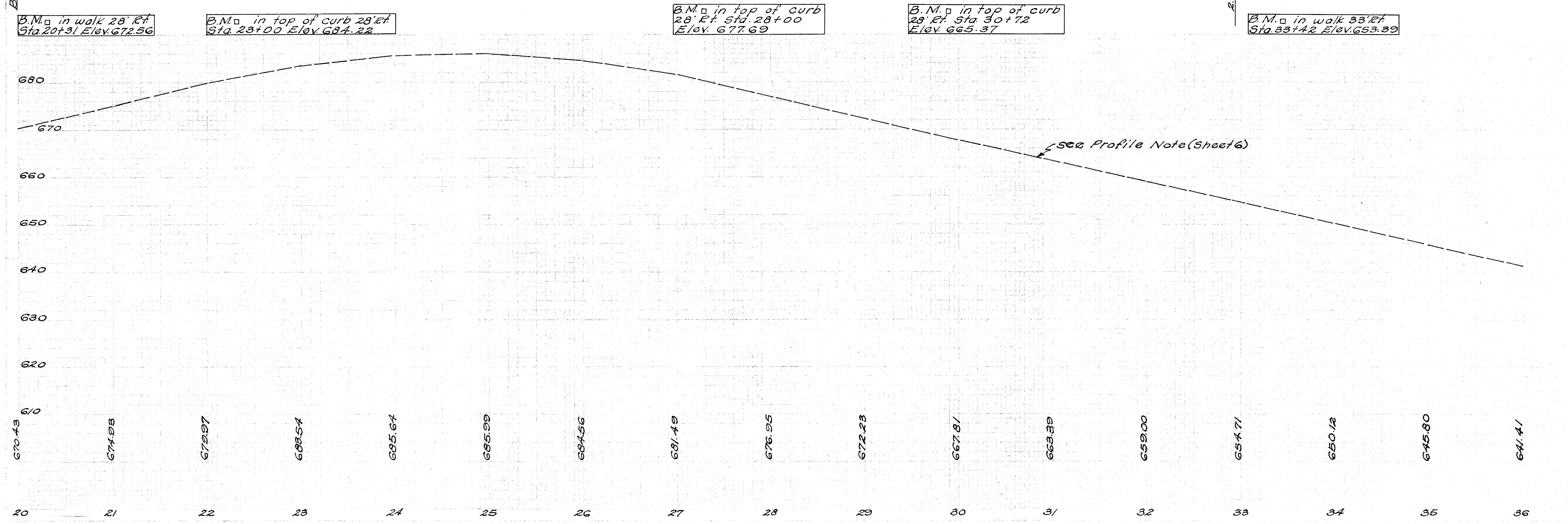
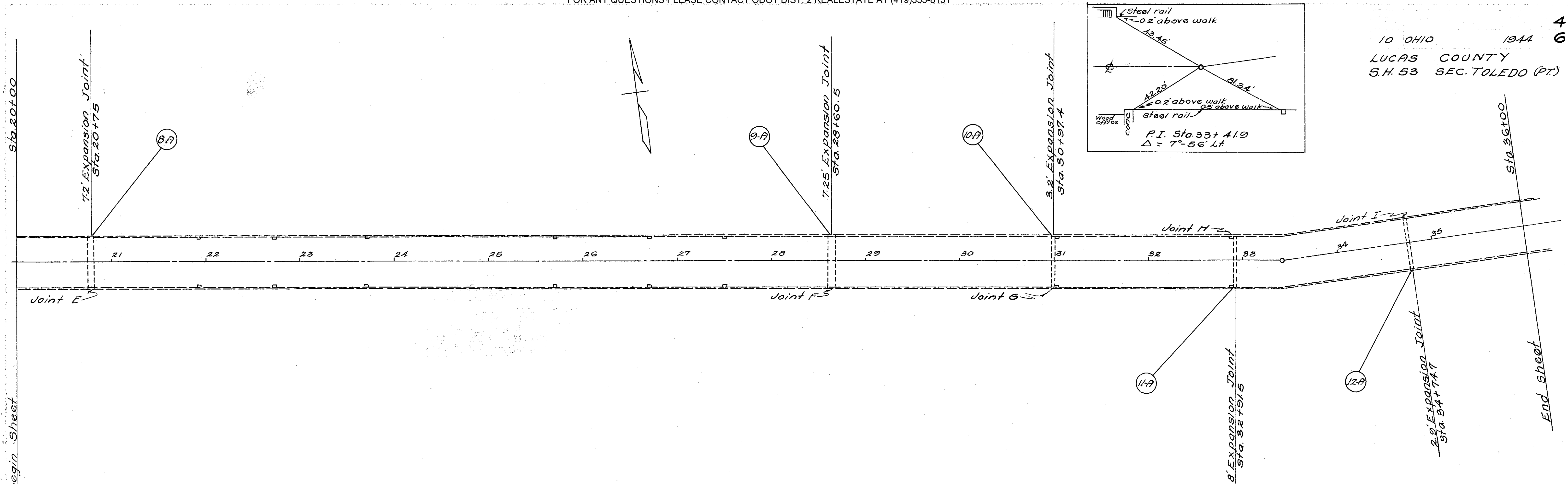

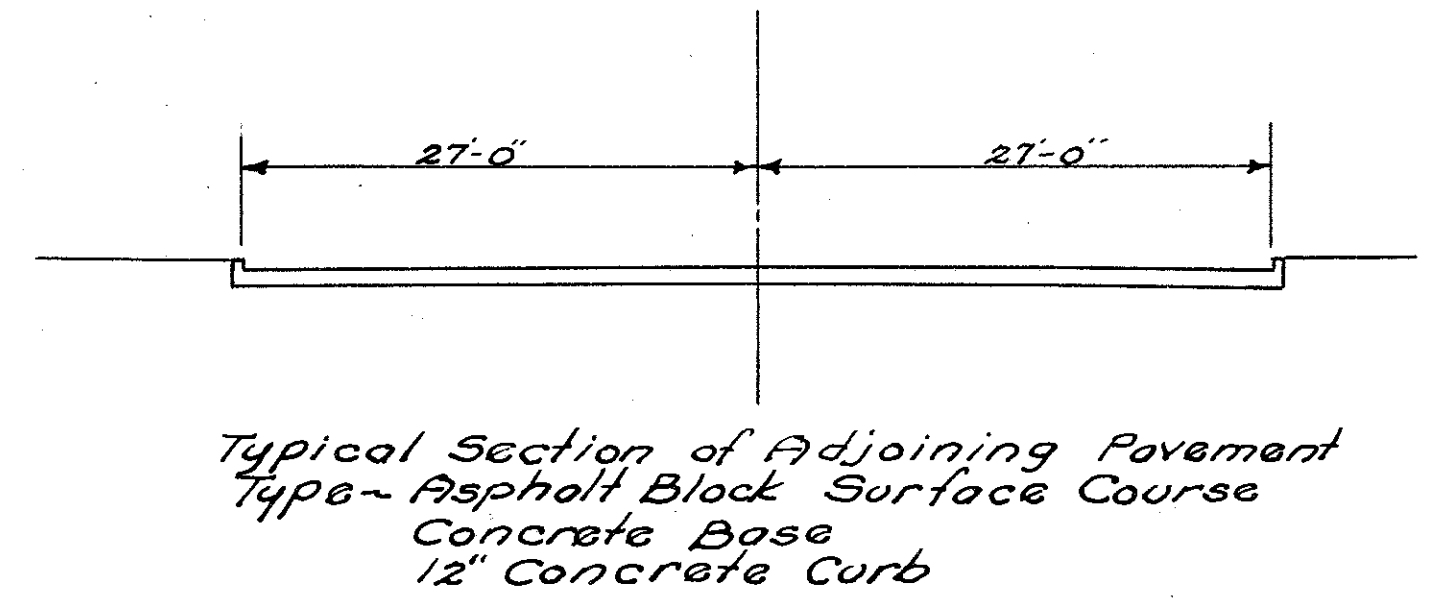
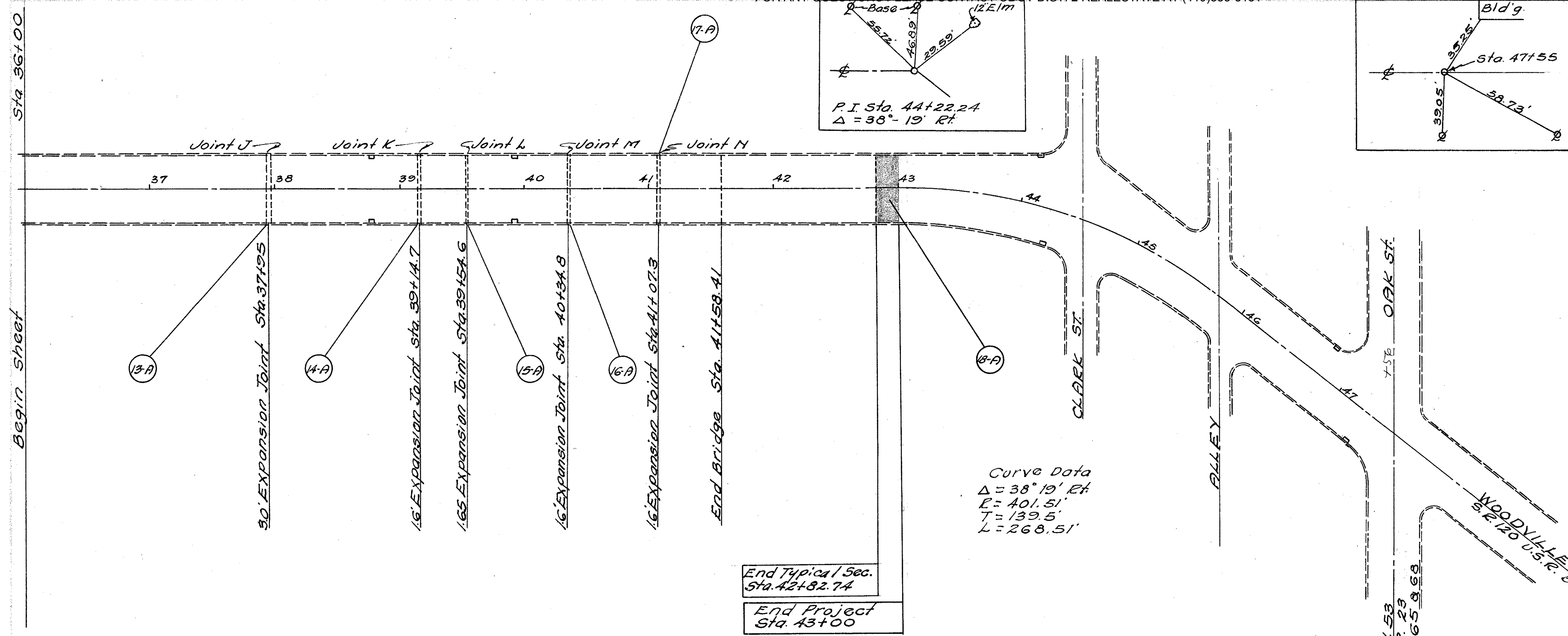

B.M. \square in walk 33' Et.
Sta. 36+15 Elev. 641.46

B.M. \square in walk 33' Et.
Sta. 41+58 Elev. 617.60

