

3070

3047

FOR ANY QUESTIONS PLEASE CONTACT ODOT DIST. 2 REALESTATE AT (419)353-8131

I.C.H. 438 SEC. H
LUCAS COUNTY

FED. RD. DIST.	STATE	FED. AID PROJECT	FISCAL YEAR	11
10	OHIO	471-A	1926	

STATE OF OHIO

DEPARTMENT OF HIGHWAYS & PUBLIC WORKS

DIVISION OF HIGHWAYS

BUREAU OF CONSTRUCTION

INDEX

TITLE SHEET	PAGE 1
TYPICAL CROSS SECTION	PAGE 2
PLANS AND PROFILE	PAGE 3-6
CROSS SECTIONS	PAGE 7-9
STRUCTURAL PLANS	PAGE 10
SUMMARY SHEET	PAGE 11

BONO-PORT CLINTON

I.C.H. NO. 438 SECTION H PET. NO. 4892
 LUCAS COUNTY
 JERUSALEM TOWNSHIP 1925

The Standard Specifications of the State of Ohio, Division of Highways in force on date of contract will govern this improvement

I hereby approve these plans and declare that the making of this improvement will require the closing to traffic of the highway and that detours will be provided as shown on the plan and estimates

CONVENTIONAL SIGNS

- STATE LINE _____
- COUNTY LINE _____
- TOWNSHIP LINE _____
- SECTION LINE _____
- PROPERTY LINE NOT FENCED _____
- CENTER LINE _____
- CITY LINE _____
- FENCE _____
- TELEPHONE OR TELEGRAPH >>>>
- STEAM RAILROAD _____
- ELECTRIC RAILROAD _____
- UNLOADING POINT _____

We, the Commissioners of Lucas County, hereby approve these plans and certify that the right-of-way 60' wide, is available for the construction, maintenance and repair of the highway

Roy E. Davis
Wm. H. Johnson
R. E. Hambrecht

DATE 6-18 1926 COUNTY COMMISSIONERS

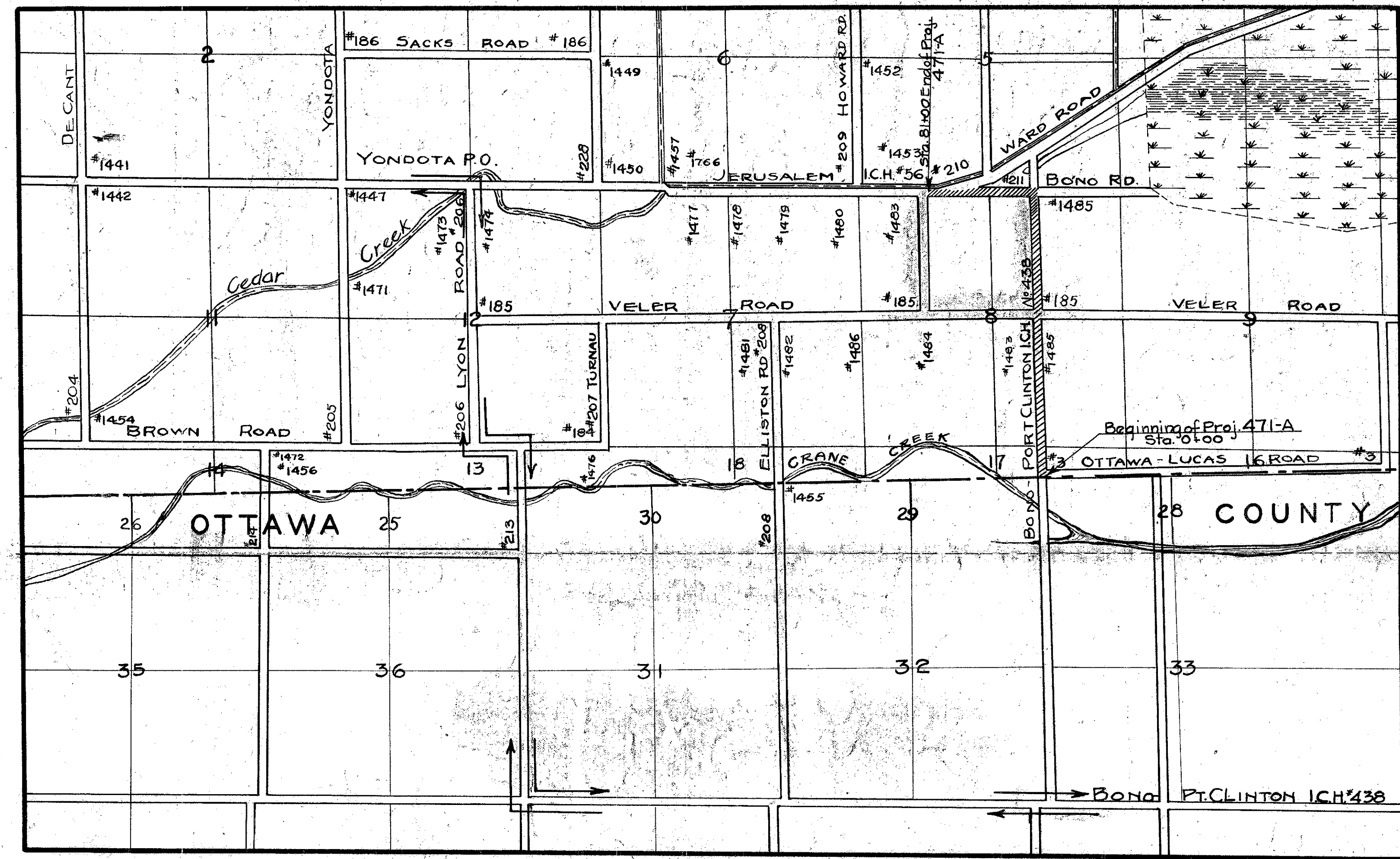

Portion to be Improved

Detours indicated thus

APPROVED: *C. L. Sawyer*
 DATE: May 17, 1926 RESIDENT ENGINEER

APPROVED: *M. J. Friedman*
 DATE: 5-27-26 DIVISION ENGINEER

APPROVED: *Harry J. Clark*
 DATE: 6-17-26 STATE HIGHWAY ENGINEER

APPROVED: *G. F. Schlemmer*
 DATE: 6-17-26 DIRECTOR OF HIGHWAYS & PUBLIC WORKS

RECOMMENDED FOR APPROVAL: _____
 DATE: _____ DIST. ENGR. BUREAU OF PUBLIC ROADS

RECOMMENDED FOR APPROVAL: _____
 DATE: _____ CHIEF ENGR. BUREAU OF PUBLIC ROADS

APPROVED: _____
 DATE: _____ CHIEF OF BUREAU.

Scale 3"=1 mile

CONSTRUCTION BUREAU
 JUL 5 1926
 GROUND PHOTO LAB

97
 30 458 LUCAS H
 1926

FED. RD. DIST.	STATE	FED. AID PROJECT	FISCAL YEAR.
10.	OHIO.	471-A.	1926.

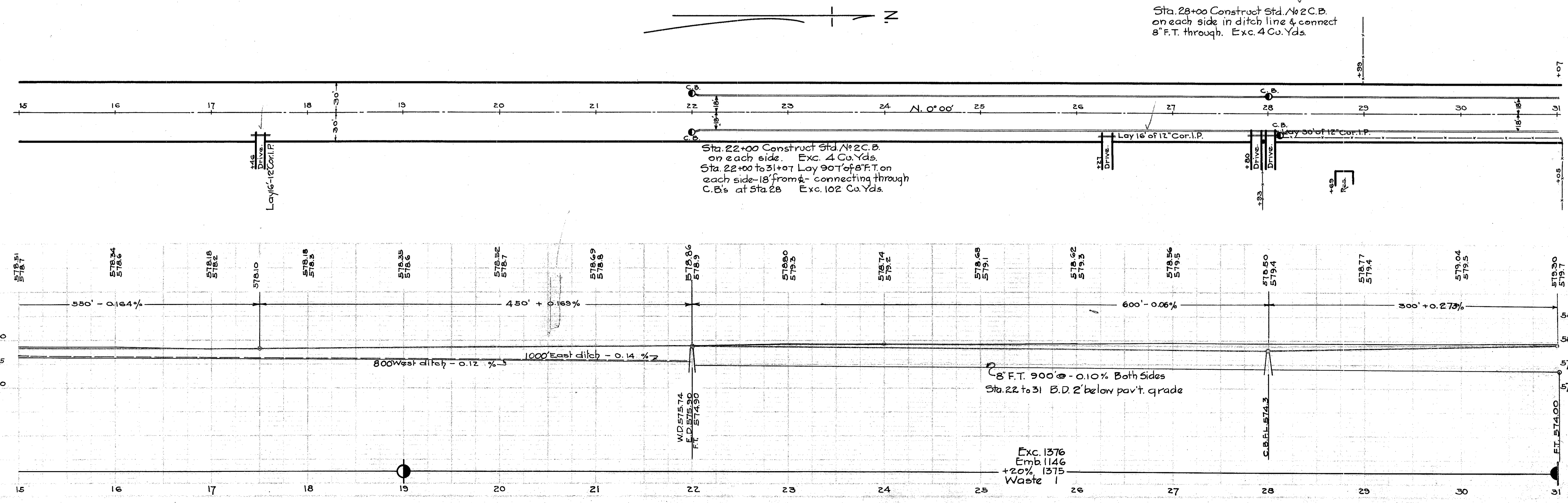
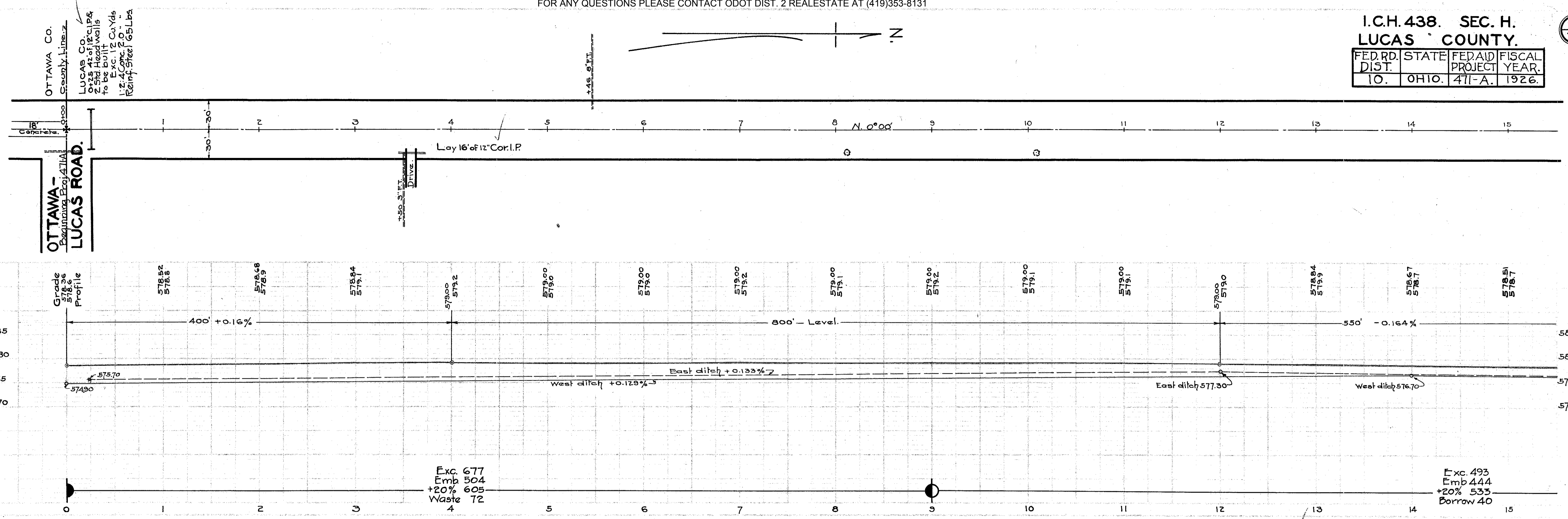

FED. RD. DIST.	STATE	FED. AID PROJECT	FISCAL YEAR.
10.	OHIO.	471-A.	1926.

Sta. 31+10 Extra reinforcement for pav'tover Culvert
48 longitudinal bars $\frac{3}{4}$ " ϕ x 12' long 5%
12 transverse bars $\frac{1}{2}$ " ϕ x 19.5' long 12%
Reinforcing Steel 1022 Lbs.

Sta. 31+60 One each side build Std. No. 2 C.B.
& lay 44 of 12" C.I.P. across Veler Rd. to Culvert
openings. Exc. 35 Cu. Yds.

Sta. 31+60 to 33+50 Lay 190' of 8" F.T. on
each side - 18' from \pm . Exc. 47 Cu. Yds.
Sta. 33+50 Build Std. No. 2 C.B. on each
side. Exc. 4 Cu. Yds.

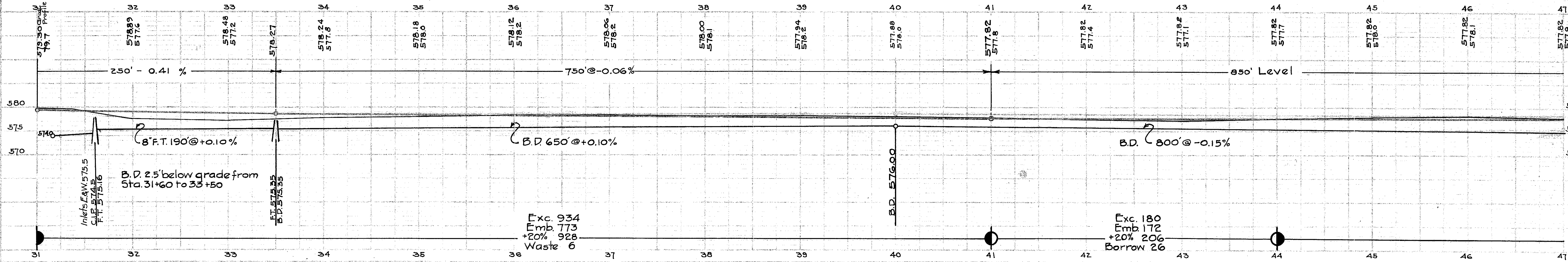

Exc. 934
Emb. 773
+20% 928
Waste 6

Exc. 180
Emb. 172
+20% 206
Borrow 26

+74
Hs.

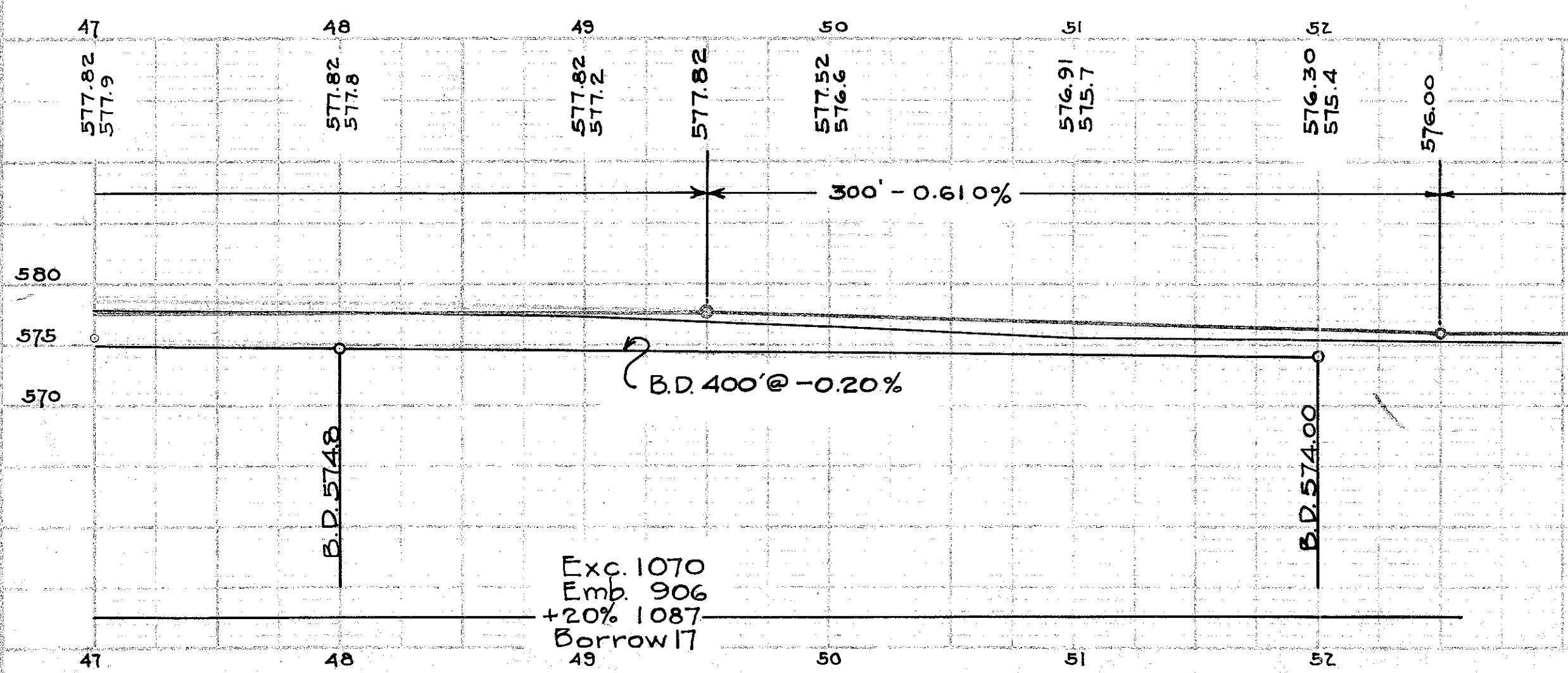

Exc. 1070
Emb. 906
+20% 1087
Borrow 17

PLAN
DATE: 10/1/26
BY: J. H. BROWN
CHECKED: J. H. BROWN
SCALE: AS SHOWN

PROFILE
DATE: 10/1/26
BY: J. H. BROWN
CHECKED: J. H. BROWN
SCALE: AS SHOWN

I.C.H.438. SEC.H.
LUCAS COUNTY.

FED. RD. DIST.	STATE	FED. AID PROJECT	FISCAL YEAR.
10	OHIO	471-A.	1926.

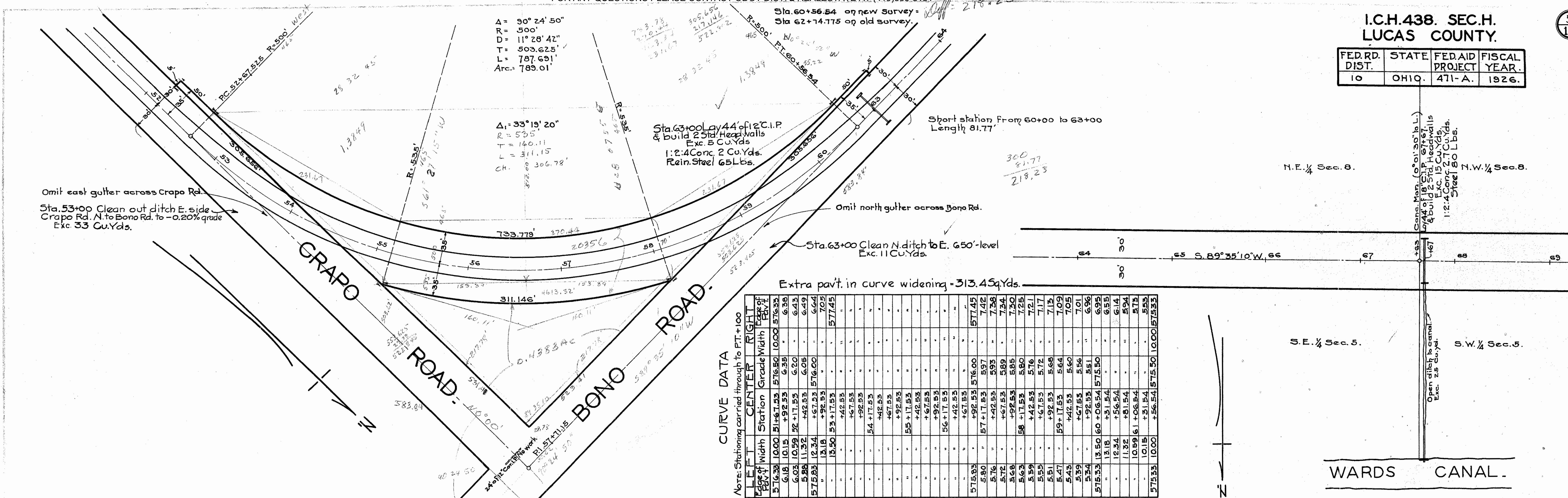

CURVE DATA

Notes: Stationing carried through to PT.+100

LEFT SIDE	RIGHT SIDE	STATION	WIDTH	GRADE	WIDTH	GRADE	WIDTH	GRADE
516.33	10.00	516.75	576.50	10.00	576.33	6.38	6.38	6.38
6.18	10.15	+92.53	6.20	6.43	6.43	6.43	6.43	
6.03	10.99	+92.53	6.05	6.49	6.49	6.49	6.49	
5.88	11.32	+92.53	5.90	6.64	6.64	6.64	6.64	
5.75	12.24	+92.53	5.76	7.05	7.05	7.05	7.05	
5.61	13.18	+92.53	5.61	7.45	7.45	7.45	7.45	
5.47	14.13	+92.53	5.47	7.84	7.84	7.84	7.84	
5.33	15.08	+92.53	5.33	8.23	8.23	8.23	8.23	
5.19	16.03	+92.53	5.19	8.62	8.62	8.62	8.62	
5.05	16.98	+92.53	5.05	9.01	9.01	9.01	9.01	
4.91	17.93	+92.53	4.91	9.40	9.40	9.40	9.40	
4.77	18.88	+92.53	4.77	9.79	9.79	9.79	9.79	
4.63	19.83	+92.53	4.63	10.18	10.18	10.18	10.18	
4.49	20.78	+92.53	4.49	10.57	10.57	10.57	10.57	
4.35	21.73	+92.53	4.35	10.96	10.96	10.96	10.96	
4.21	22.68	+92.53	4.21	11.35	11.35	11.35	11.35	
4.07	23.63	+92.53	4.07	11.74	11.74	11.74	11.74	
3.93	24.58	+92.53	3.93	12.13	12.13	12.13	12.13	
3.79	25.53	+92.53	3.79	12.52	12.52	12.52	12.52	
3.65	26.48	+92.53	3.65	12.91	12.91	12.91	12.91	
3.51	27.43	+92.53	3.51	13.30	13.30	13.30	13.30	
3.37	28.38	+92.53	3.37	13.69	13.69	13.69	13.69	
3.23	29.33	+92.53	3.23	14.08	14.08	14.08	14.08	
3.09	30.28	+92.53	3.09	14.47	14.47	14.47	14.47	
2.95	31.23	+92.53	2.95	14.86	14.86	14.86	14.86	
2.81	32.18	+92.53	2.81	15.25	15.25	15.25	15.25	
2.67	33.13	+92.53	2.67	15.64	15.64	15.64	15.64	
2.53	34.08	+92.53	2.53	16.03	16.03	16.03	16.03	
2.39	35.03	+92.53	2.39	16.42	16.42	16.42	16.42	
2.25	35.98	+92.53	2.25	16.81	16.81	16.81	16.81	
2.11	36.93	+92.53	2.11	17.20	17.20	17.20	17.20	
1.97	37.88	+92.53	1.97	17.59	17.59	17.59	17.59	
1.83	38.83	+92.53	1.83	17.98	17.98	17.98	17.98	
1.69	39.78	+92.53	1.69	18.37	18.37	18.37	18.37	
1.55	40.73	+92.53	1.55	18.76	18.76	18.76	18.76	
1.41	41.68	+92.53	1.41	19.15	19.15	19.15	19.15	
1.27	42.63	+92.53	1.27	19.54	19.54	19.54	19.54	
1.13	43.58	+92.53	1.13	19.93	19.93	19.93	19.93	
1.00	44.53	+92.53	1.00	20.32	20.32	20.32	20.32	
0.86	45.48	+92.53	0.86	20.71	20.71	20.71	20.71	
0.72	46.43	+92.53	0.72	21.10	21.10	21.10	21.10	
0.58	47.38	+92.53	0.58	21.49	21.49	21.49	21.49	
0.44	48.33	+92.53	0.44	21.88	21.88	21.88	21.88	
0.30	49.28	+92.53	0.30	22.27	22.27	22.27	22.27	
0.16	50.23	+92.53	0.16	22.66	22.66	22.66	22.66	
0.02	51.18	+92.53	0.02	23.05	23.05	23.05	23.05	
0.00	52.13	+92.53	0.00	23.44	23.44	23.44	23.44	
0.00	53.08	+92.53	0.00	23.83	23.83	23.83	23.83	
0.00	54.03	+92.53	0.00	24.22	24.22	24.22	24.22	
0.00	54.98	+92.53	0.00	24.61	24.61	24.61	24.61	
0.00	55.93	+92.53	0.00	25.00	25.00	25.00	25.00	
0.00	56.88	+92.53	0.00	25.39	25.39	25.39	25.39	
0.00	57.83	+92.53	0.00	25.78	25.78	25.78	25.78	
0.00	58.78	+92.53	0.00	26.17	26.17	26.17	26.17	
0.00	59.73	+92.53	0.00	26.56	26.56	26.56	26.56	
0.00	60.68	+92.53	0.00	26.95	26.95	26.95	26.95	
0.00	61.63	+92.53	0.00	27.34	27.34	27.34	27.34	
0.00	62.58	+92.53	0.00	27.73	27.73	27.73	27.73	
0.00	63.53	+92.53	0.00	28.12	28.12	28.12	28.12	
0.00	64.48	+92.53	0.00	28.51	28.51	28.51	28.51	
0.00	65.43	+92.53	0.00	28.90	28.90	28.90	28.90	
0.00	66.38	+92.53	0.00	29.29	29.29	29.29	29.29	
0.00	67.33	+92.53	0.00	29.68	29.68	29.68	29.68	
0.00	68.28	+92.53	0.00	30.07	30.07	30.07	30.07	
0.00	69.23	+92.53	0.00	30.46	30.46	30.46	30.46	

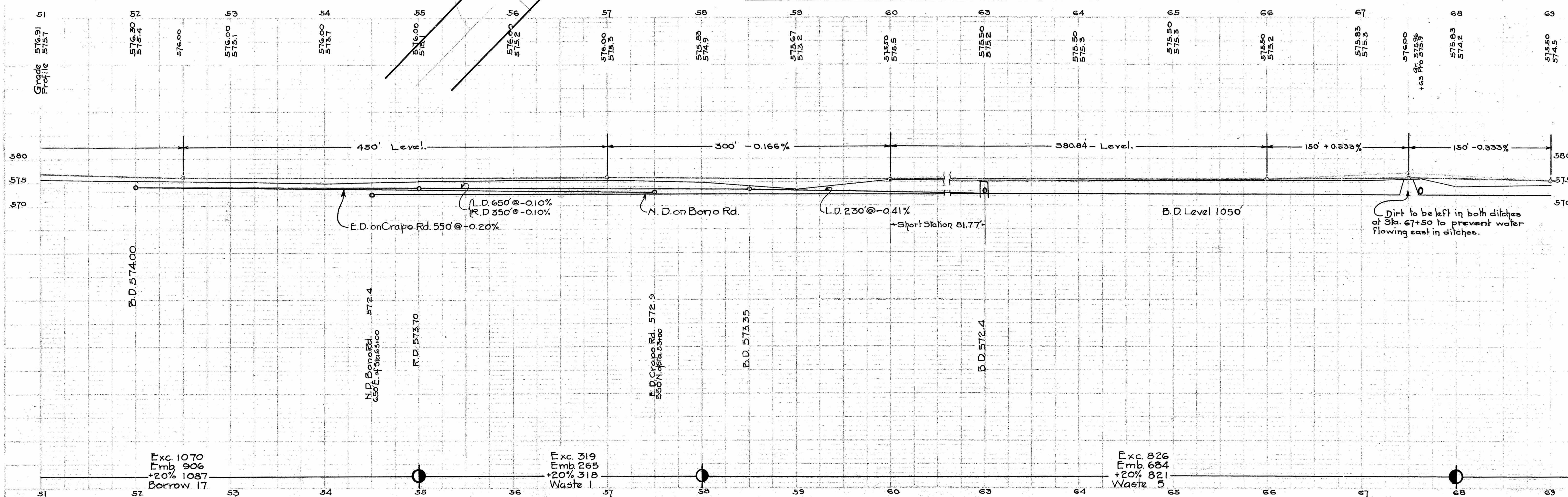

Exc. 1070
Emb 906
+20% 1087
Borrow 17

Exc. 319
Emb 265
+20% 318
Waste 1

Exc. 826
Emb 684
+20% 821
Waste 5

FED. RD. DIST.	STATE	FED. AID PROJECT	FISCAL YEAR
10.	OHIO.	471-A.	1926.

PLAN
MORGAN
SOLOK
SNELL
237

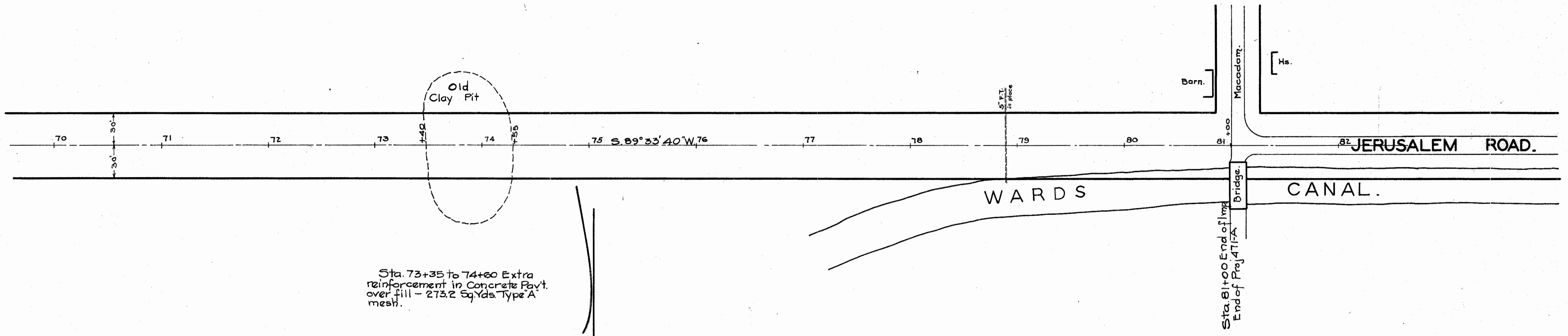

Sta. 73+35 to 74+60 Extra reinforcement in Concrete Pavt. over fill - 273.2 Sq Yds. Type A mesh.

