

O.D.O.T. DISTRICT 2 SURVEY OFFICE (USE ONLY)

PERSONNEL _____ REFERENCE NO. 11 D SHEET 20 OF 29
NOTES LOEHRKE DATE 3/29/94 ROUTE SR 2
H.C. CANTERBURY WEATHER NICE COUNTY LUCAS
R.C. VOGEL TEMP. 48° TOWNSHIP SPRINGFIELD
DWG BY RHOADES PID 88525 SECTION 36
T 8 N R 9 E

TYPE MONUMENT MONBOX
ON SURFACE - ~~BELOW~~ ON
OFFSET 0 PAVEMENT ON LT : RT
15.0' TO RT EDGE PAVEMENT
STATION: 314+69.88

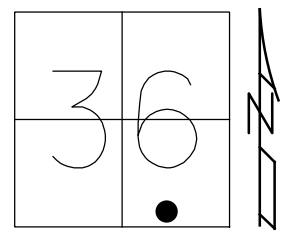

HORIZ.DATUM: NAD83(2011) GEOID: NAVD88 2018
GRID: NORTHING: 708764.403 EASTING: 1620134.977

RECORD: S.T.
FD MONBOX
3/29/94, CAL
FD MONBOX
W/ 1" IPIN
REFD11
1/28/15, EBW
FD MONBOX
W/ 1" IPIN
REFD11
8/18/20
4/30/21, DSA
11/21/22, TDN

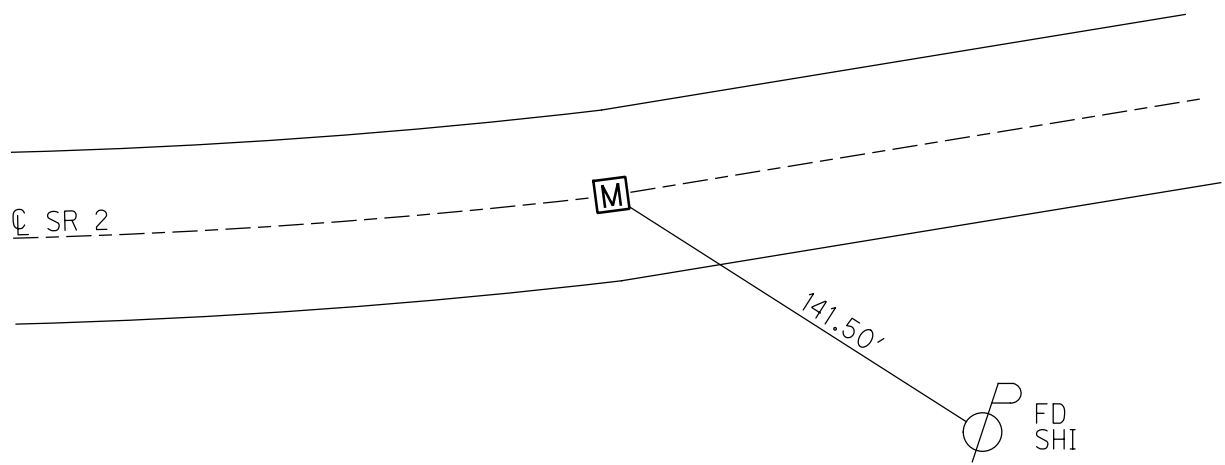

O.D.O.T. DISTRICT 2 SURVEY OFFICE (USE ONLY)

PERSONNEL _____ REFERENCE NO. 11 D SHEET 20 OF 31
NOTES LOEHRKE DATE 3/29/94 ROUTE SR 2
H.C. CANTERBURY WEATHER NICE COUNTY LUCAS
R.C. VOGEL TEMP. 48° TOWNSHIP SPRINGFIELD
DWG BY NIESE PID 11616 SECTION 36
T 8 N R 9 E

TYPE MONUMENT MONBOX
ON SURFACE - ~~BELOW~~ ON
OFFSET Q PAVEMENT ON LT : RT
15.0' TO RT EDGE PAVEMENT
STATION: 314+69.88

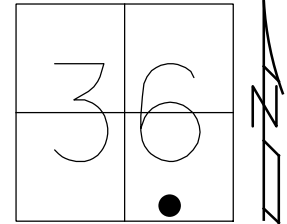

HORIZ.DATUM: NAD83(2011) GEOID: NAVD88 2018
GRID: NORTHING: 708764.426 EASTING: 1620134.993

RECORD: P.T.
FD MONBOX
3/29/94, CAL
FD MONBOX
W/ 1" IPIN
1/28/15
FD MONBOX
W/ 1" IPIN
REFD11
8/18/20
4/30/21, DSA

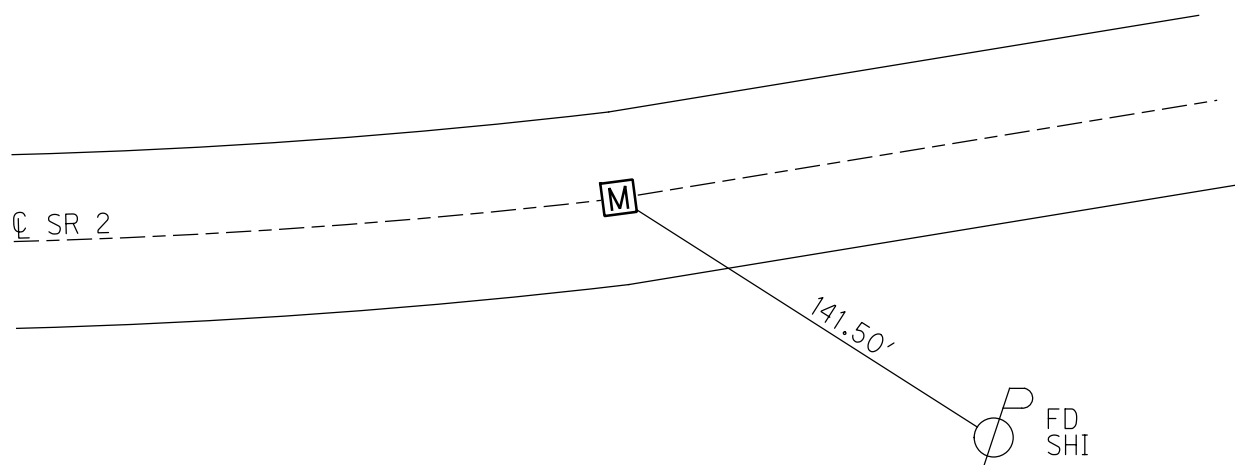

O.D.O.T. DISTRICT 2 SURVEY OFFICE (USE ONLY)

PERSONNEL _____ REFERENCE NO. 11 D SHEET 20 OF 31
NOTES LOEHRKE DATE 3/29/94 ROUTE SR 2
H.C. CANTERBURY WEATHER NICE COUNTY LUCAS
R.C. VOGEL TEMP. 48° TOWNSHIP SPRINGFIELD
SECTION 36
T 7 N R 9 E

TYPE MONUMENT MON BOX
ON SURFACE - ~~BELOW~~ ON _____
~~LEFT~~ - Q PAV'T - ~~RIGHT~~ ON _____
15' TO RT EDGE PAVEMENT
S.L.M. _____ 314+69.88
GRID: NORTHING: 708764.403 EASTING: 1620134.977

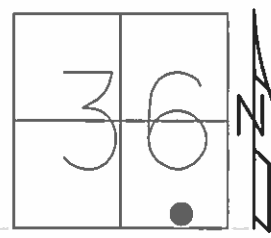

RECORD: P.T.
REFD11
FD MON BOX W/ 1" IPIN
1/28/15

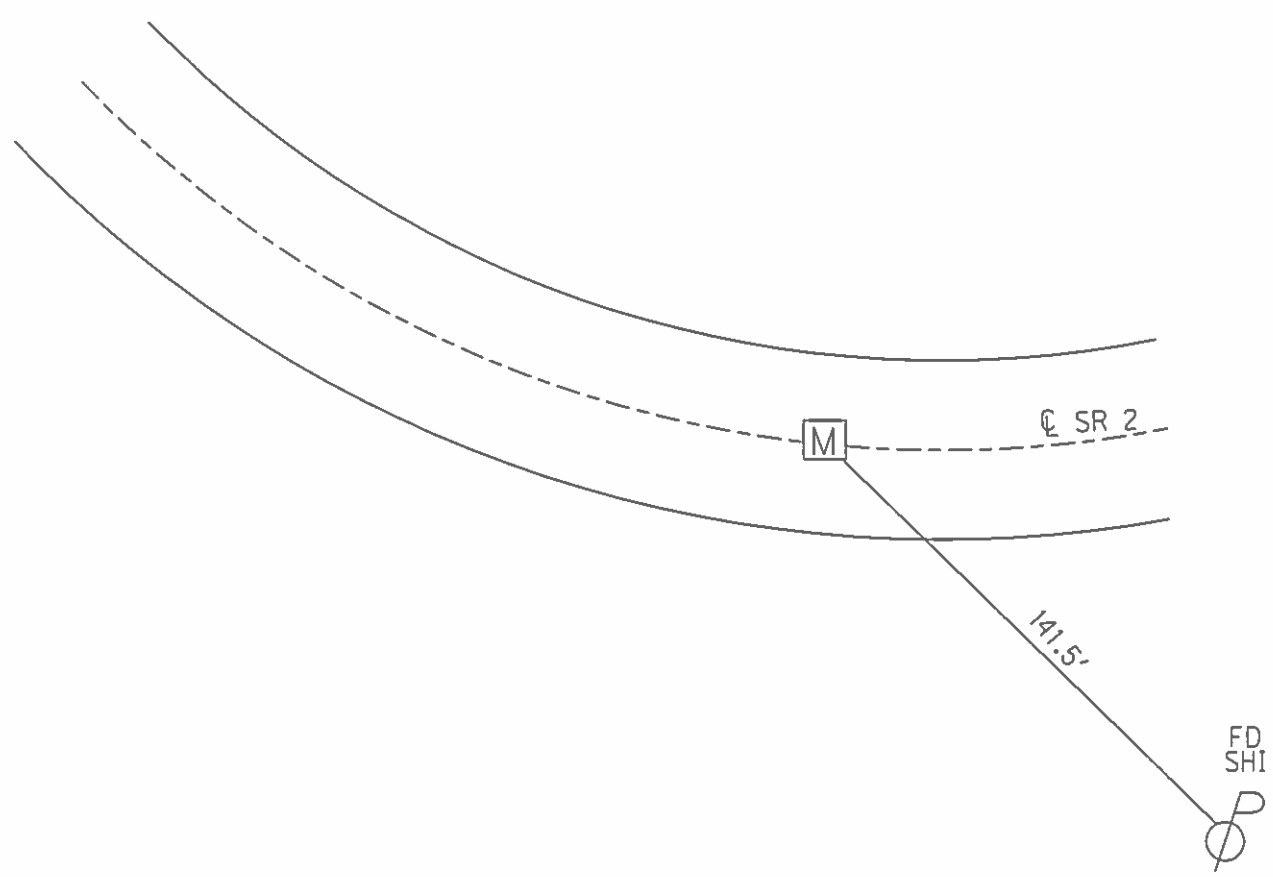

O.D.O.T. DISTRICT 2 SURVEY OFFICE

PERSONNEL

NOTES

H.C.

R.C.

REFERENCE NO. 11-D

SHEET 7 OF 25

DATE

WEATHER

TEMP.

3-29-94

Nice

+48

ROUTE

COUNTY

TOWNSHIP

SECTION

S.R. 2

LUCAS

Springfield

36

T 7 N R 9 E

TYPE MONUMENT

ON SURFACE -

LEFT - & PAV'T. -

25' TO RT EDGE PAVEMENT

S.L.M.

Mon Box

Yes

Yes

3/4 +60

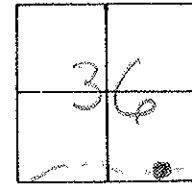

P.T.

L/2 PAVT

S.R. 2

141.5'

P
Fd. Str.

O.D.O.T. DISTRICT 2 SURVEY OFFICE

PERSONNEL

REFERENCE NO. 11-D

SHEET 7 OF 25

NOTES LOEHRKE

H.C. CANTERBURY

R.C. VOGEL

DATE 3-29-94

WEATHER Nice

TEMP. +48

ROUTE SR 2

COUNTY LUCAS

TOWNSHIP Springfield

SECTION 36

T. 7 N R. 9 E

TYPE MONUMENT Mon Box

ON SURFACE - ~~BELOW~~ Yes

~~LEFT - & PAV'T. - RIGHT~~ Yes

25' TO Rt EDGE PAVEMENT

S.L.M. 3/4 +60

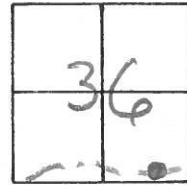

P.T.

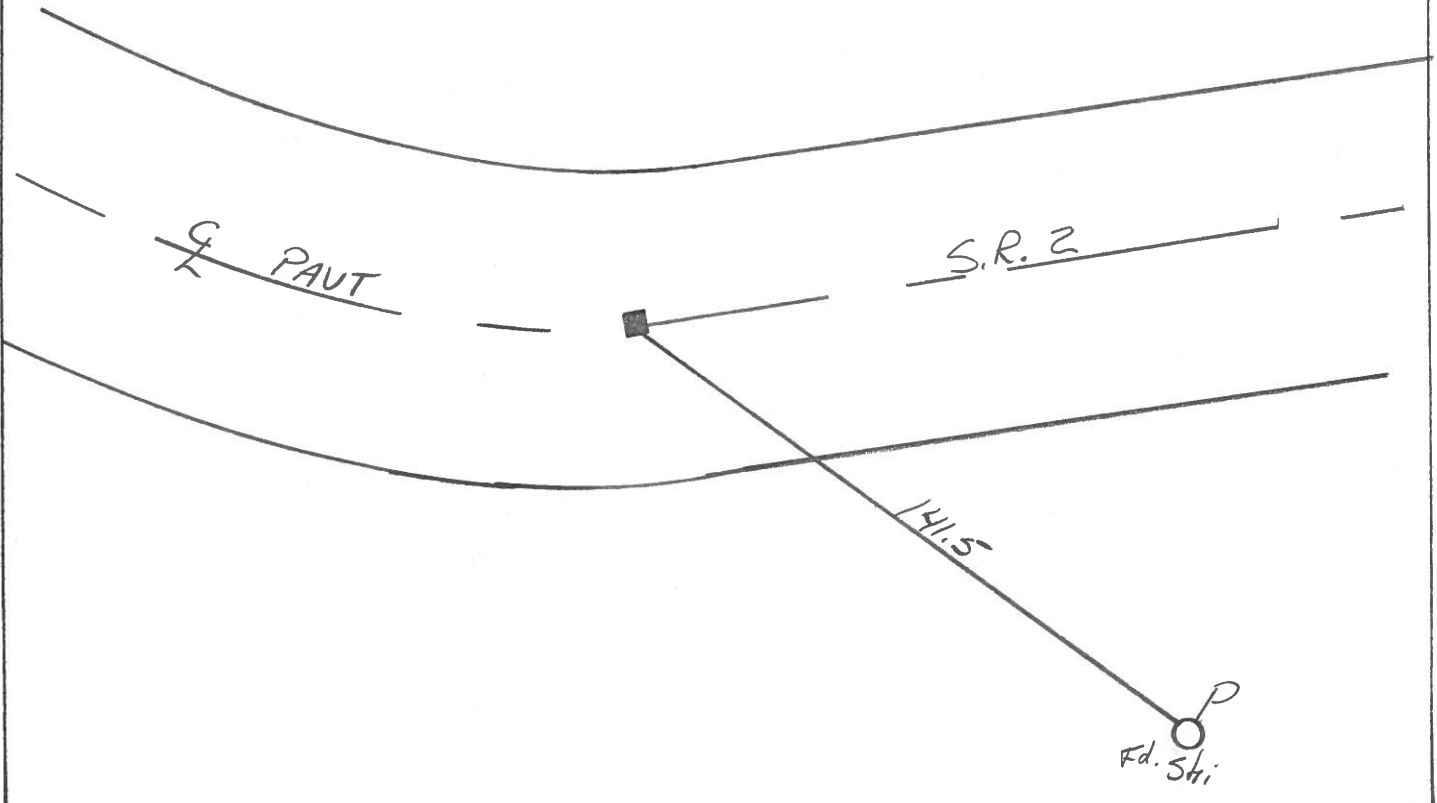

PERSONNEL	TITLE	PERSONNEL	TITLE	COUNTY	Lucas	DATE	17 Sept. 77
Stanc				S. R.	42	WEATHER	Fair
E				SEC.		TEMP.	58°
Lucas							

DESCRIPTION Reference to Contour Points JOB NO. _____

LEFT CENTER LINE RIGHT

