

O.D.O.T. DISTRICT 2 SURVEY OFFICE (USE ONLY)

PERSONNEL

REFERENCE NO. 15

SHEET 27 OF 29

NOTES LOEHRKE

DATE 3/30/94

ROUTE SR 2

H.C. CANTERBURY

WEATHER NICE

COUNTY LUCAS

R.C. VOGEL

TEMP. 45°

TOWNSHIP SPRINGFIELD

DWG BY RHOADES PID 88525

SECTION 19

T 7 N R 10 E

TYPE MONUMENT MONBOX

ON SURFACE - ~~BELOW~~ ON

OFFSET C PAVEMENT ON LT : RT

25' TO RT EDGE PAVEMENT

STATION: 403+76.74

HORZ.DATUM: NAD83 2011

GEOID: NAVD88 2012A

GRID: NORTHING: 710560.946

EASTING: 1628788.422

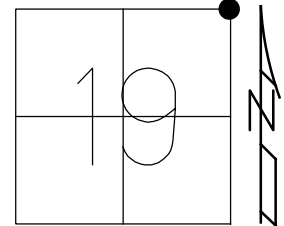

RECORD: P.I.
STA.404+32.58
FD MONBOX
W/ 1" IPIN
3/30/94, CL
REF15
2/3/15, EWB

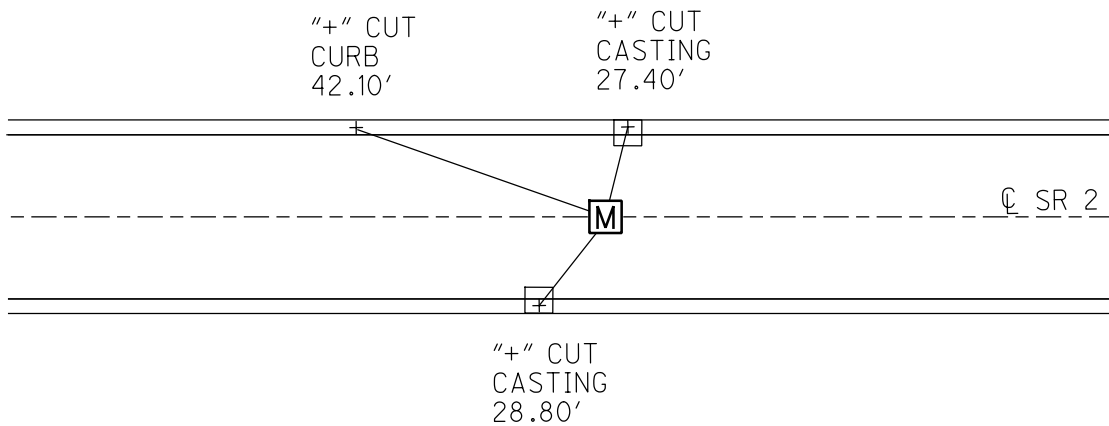

O.D.O.T. DISTRICT 2 SURVEY OFFICE (USE ONLY)

PERSONNEL	REFERENCE NO.	<u>15</u>	SHEET	<u>27</u>	OF	<u>31</u>
NOTES	LOEHRKE	DATE	<u>3/30/94</u>	ROUTE	<u>SR 2</u>	
H.C.	<u>CANTERBURY</u>	WEATHER	<u>NICE</u>	COUNTY	<u>LUCAS</u>	
R.C.	<u>VOGEL</u>	TEMP.	<u>45°</u>	TOWNSHIP	<u>SPRINGFIELD</u>	
				SECTION	<u>19</u>	
				T	<u>7</u>	R
					<u>N</u>	
						<u>10</u>
						<u>E</u>

TYPE MONUMENT MON BOX
 ON SURFACE - ~~BELOW~~ ON
~~LEFT~~ - CL PAV'T - ~~RIGHT~~ ON
25' TO RT EDGE PAVEMENT
 S.L.M. 403+76.74
 GRID: NORTHING: 710560.946 EASTING: 1628788.422

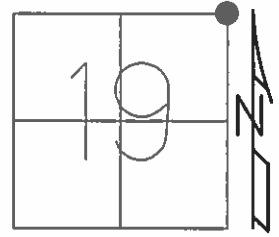

RECORD: P.I.
 STA. 404+32.58
 FD 1" IPIN
 REF 15
 1/30/15

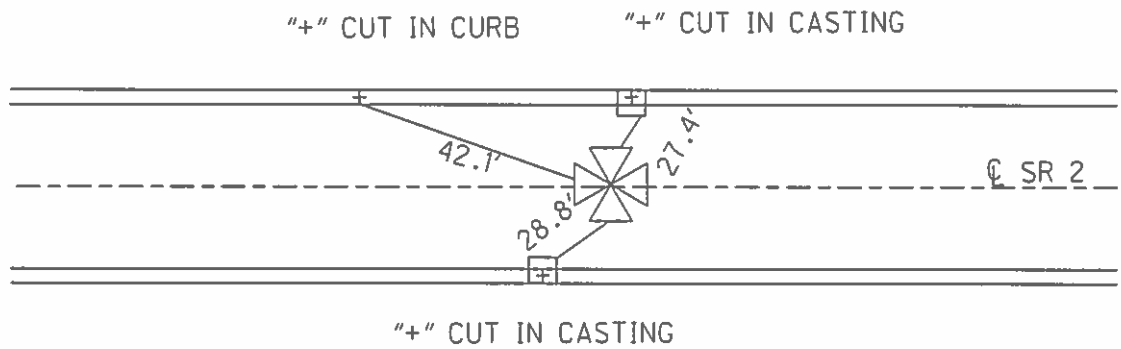

O.D.O.T. DISTRICT 2 SURVEY OFFICE

PERSONNEL _____

REFERENCE NO. 15

SHEET 14 OF 25

NOTES LOENRKE

H.C. CANTERBURY

R.C. VOGEL

DATE 3-30-94

WEATHER Nice

TEMP. +45

ROUTE S.R. 2

COUNTY LUCAS

TOWNSHIP SPRINGFIELD

SECTION 19

T. 7 R. 10 E.

TYPE MONUMENT MON. BDX

ON SURFACE BELOW YES

LEFT - & PAV'T. - RIGHT Yes

25' TO Rt EDGE PAVEMENT

S.L.M. 403+55

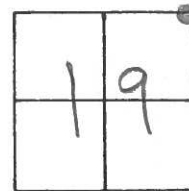

REC: 404+32.58

PI:

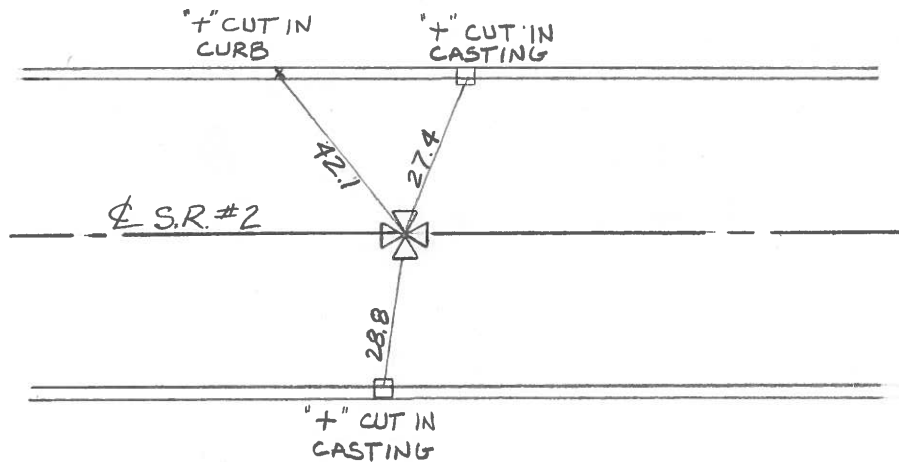

PERSONNEL	TITLE	PERSONNEL	TITLE	COUNTY	DATE	WEATHER	TEMP.
Stone				Lucas	14 Sept. 77	Fair	67°
Crew				#2			
				SEC.			

DESCRIPTION References to Control Points JOB NO. _____

LEFT CENTER LINE RIGHT

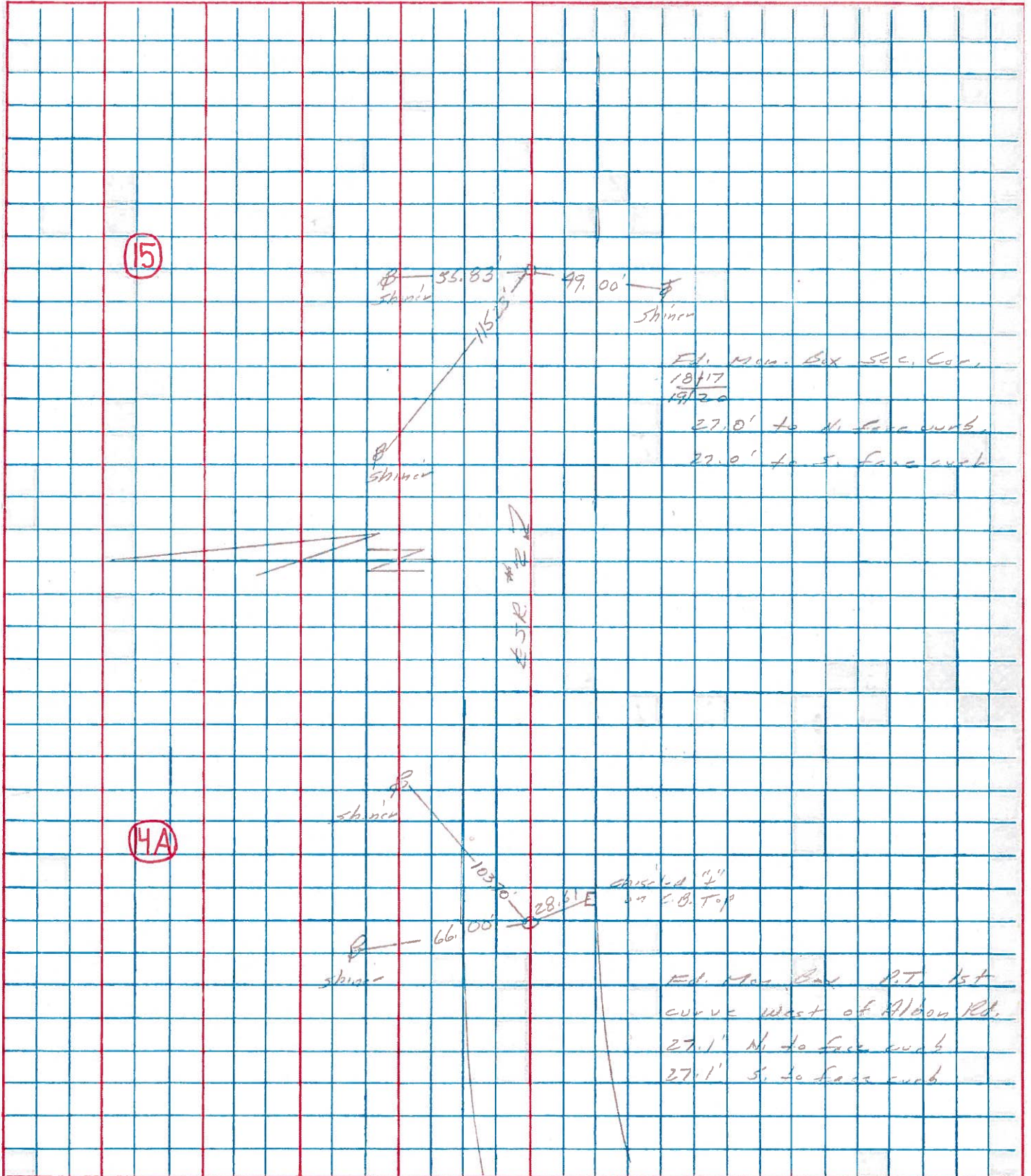

PERSONNEL	TITLE	PERSONNEL	TITLE	COUNTY	DATE	WEATHER	TEMP.
Stone		Brindley		Lucas	17 June 71	Fair	
Michalak	H.C.			S. R. #2			
Schroder	R.C.			SEC. Crissey Rd. - East			66°
Farr							

DESCRIPTION References to Control Points JOB NO. _____

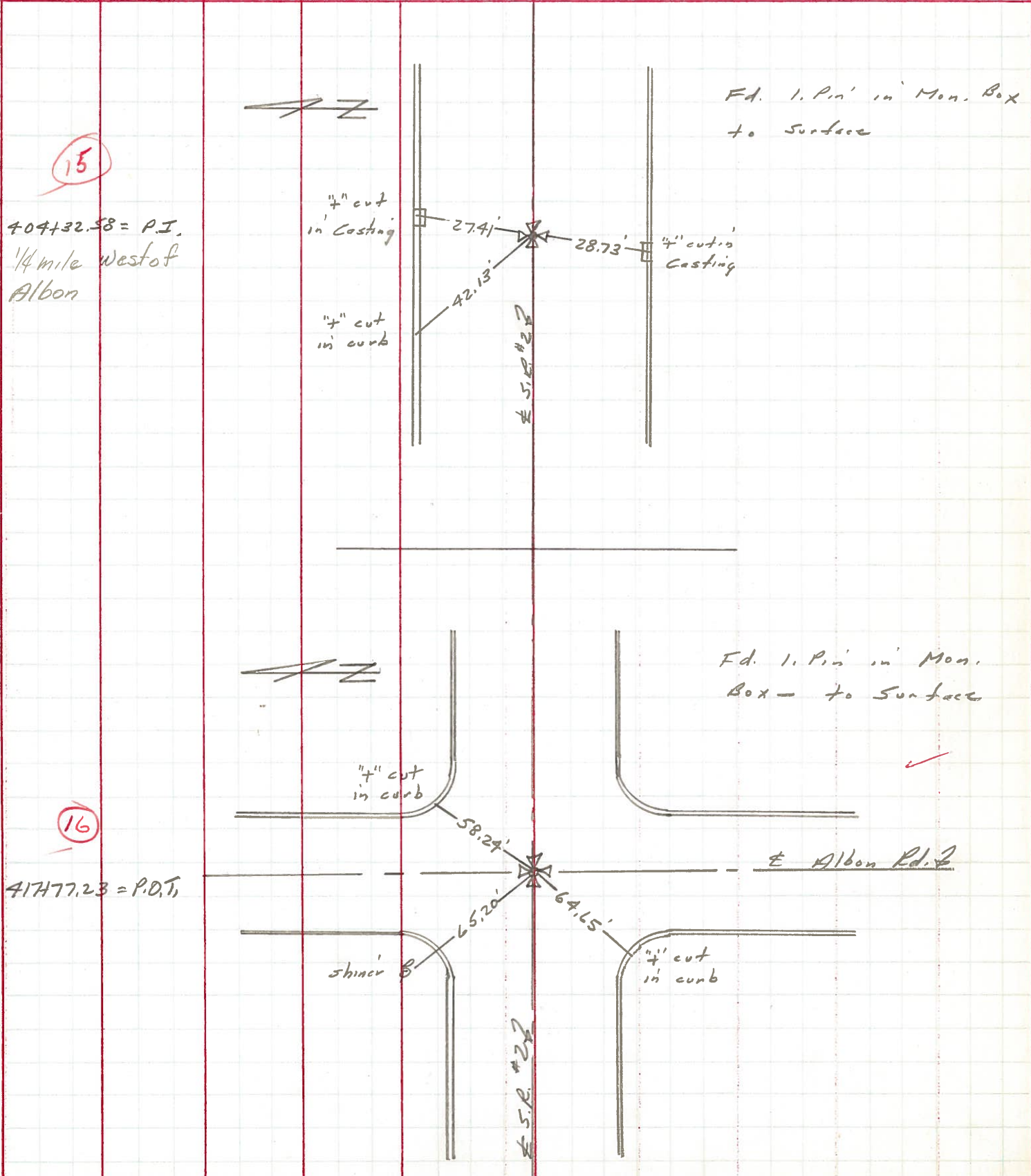

15

404+32.58 = P.I.
1/4 mile west of
Albon

16

417+77.23 = P.D.T.

± Aldon Rd. ✓

PERSONNEL TITLE PERSONNEL TITLE

COUNTY Lucas

DATE 9-20-57
Bowerman 5-1-58

S. R. #2

WEATHER

SEC.

TEMP.

DESCRIPTION

LEFT

CENTER LINE

RIGHT

JOB NO.

<p>Sta. 99+34.30 mon. - Rod in conc. - Set P.K.</p>	<p>#131 15</p>		<p>N.W. to near cor. top conc. blk porch fm. 88.62' E.S.E. to P/W mon. 72.13' E.N.E. to P/W mon. 72.50' S.E. to shiner in 30" walnut 37.22' S.E. to witness mon. 51.33' N.E. to witness mon. 40.42'</p>
<p>Sta. 112+80.00 Albon Ed. mon. - Iron rod in conc. - + P.K.</p>	<p>#132 16</p>		<p>N.E. to bot. conc. blk. store fm. 52.57' N.W. to point of V. in Co. B.M. 52.70' S.W. to +- in East end pump island. 79.94'</p>
<p>Sta. 126+07.22 set shiner from ref. - Set K.</p>	<p>#133 16-A</p>		<p>N.W. to shiner in 24" maple 45.09' S. to shiner in P.P. 29.13' N. to shiner in T.P. 28.93'</p>
<p>Sta. 152+58.77 mon. - Set P.K. N.E. cor. sec. 20</p>	<p>#134 26 17</p>		<p>N.E. to iron A.P. West side of dn. 57.75' N.W. to iron A.P. East side of gate 76.24' N. to witness mon. 30.85' S. to witness mon. 28.38' N.E. to witness mon. 50.85'</p>