

O.D.O.T. DISTRICT 2 SURVEY OFFICE (USE ONLY)

PERSONNEL

REFERENCE NO. 16

SHEET 28 OF 29

NOTES LOEHRKE

DATE 3/30/94

ROUTE SR 2

H.C. CANTERBURY

WEATHER NICE

COUNTY LUCAS

R.C. VOGEL

TEMP. 45°

TOWNSHIP SPRINGFIELD

DWG BY RHOADES PID 88525

SECTION 20

T 7 N R 10 E

TYPE MONUMENT MONBOX W/1" IPIN

ON SURFACE - ~~BELOW~~ ON

OFFSET \varnothing PAVEMENT ON LT : RT

- TO - EDGE PAVEMENT

STATION: 417+21.42

HORIZ.DATUM: NAD83 2011

GEOID: NAVD88 2012A

GRID: NORTHING: 710546.871

EASTING: 1630133.031

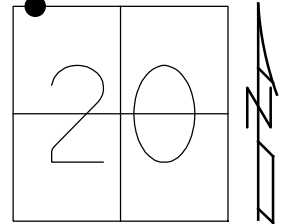

RECORD:
STA. 417+77.23
FD MONBOX
W/1" IPIN
3/30/94, CL
REF16
2/3/15, EBW

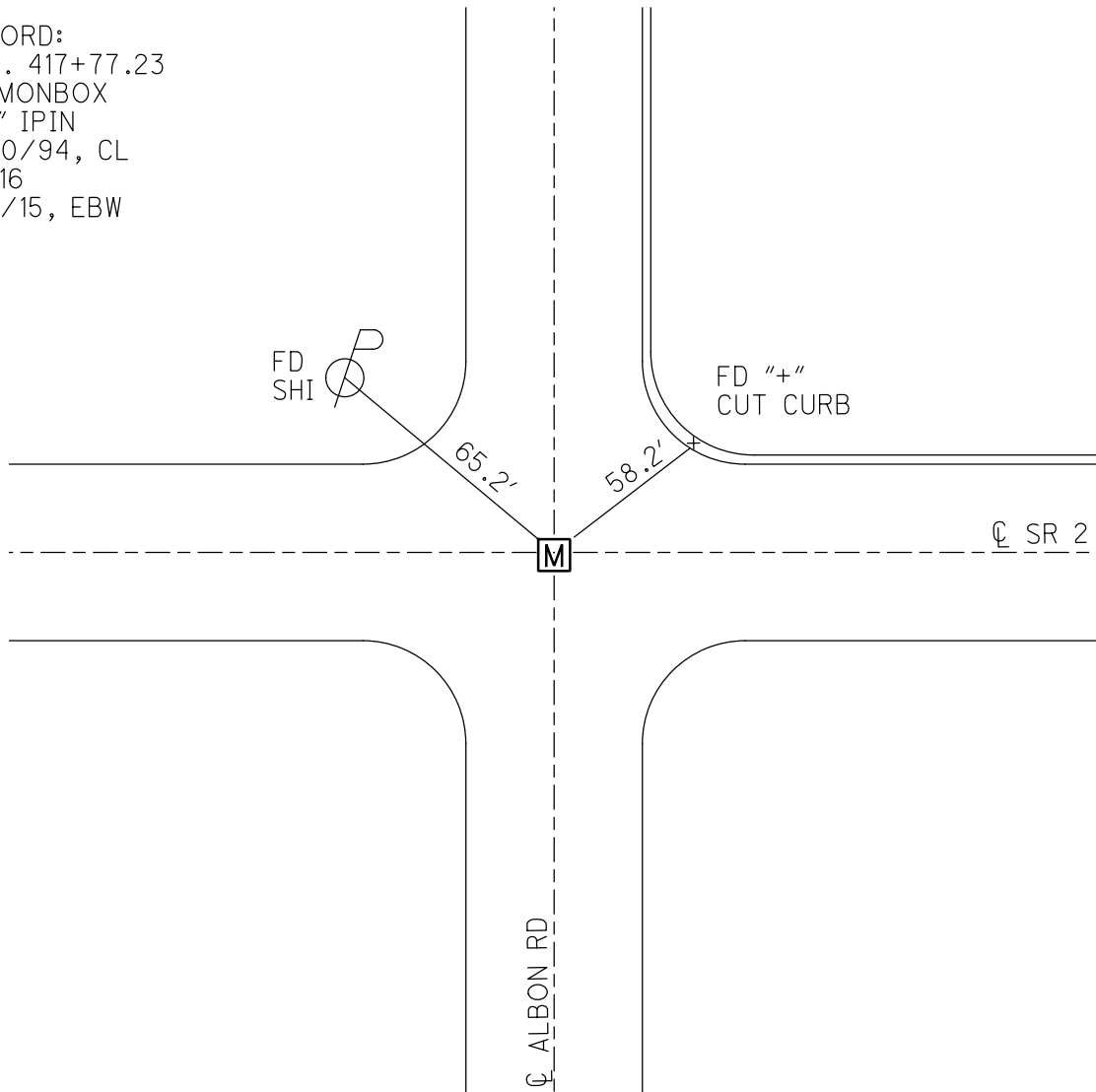

O.D.O.T. DISTRICT 2 SURVEY OFFICE (USE ONLY)

PERSONNEL _____ REFERENCE NO. 16 SHEET 28 OF 31
 NOTES LOHRKE DATE 3/30/94 ROUTE SR 2
 H.C. CANTERBURY WEATHER NICE COUNTY LUCAS
 R.C. VOGEL TEMP. 45° TOWNSHIP SPRINGFIELD
 _____ SECTION 20
 _____ T 7 N R 10 E

TYPE MONUMENT MON BOX
 ON SURFACE - ~~BELOW~~ ON _____
~~LEFT~~ - ☉ PAV'T - ~~RIGHT~~ ON _____
 _____ TO _____ EDGE PAVEMENT
 S.L.M. 417+21.42

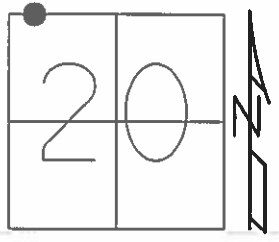

GRID: NORTHING: 710546.871 EASTING: 1630133.031

RECORD:
 STA. 417+77.23
 FD 1" IPIN
 REF16
 2/3/15

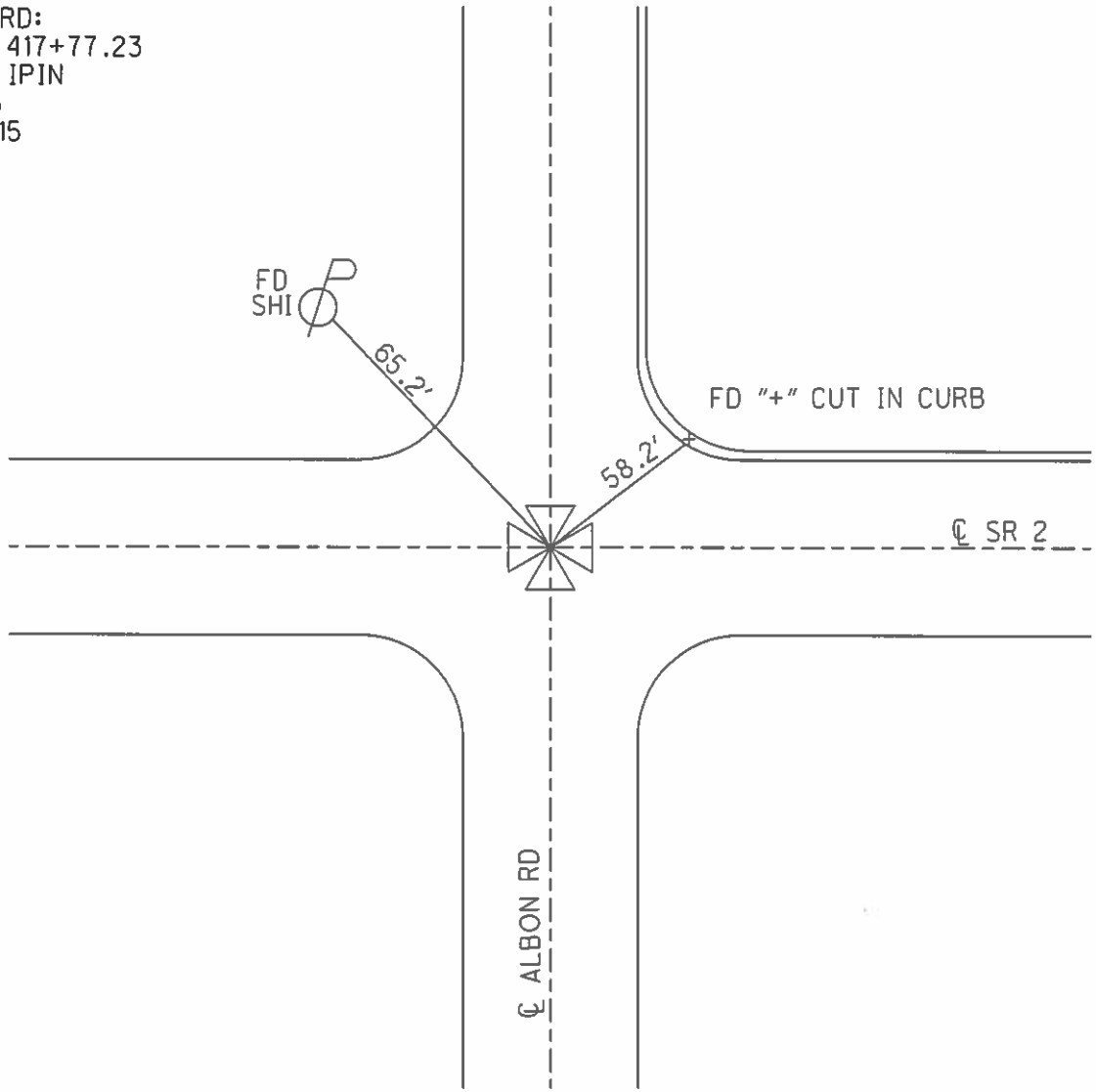

O.D.O.T. DISTRICT 2 SURVEY OFFICE

PERSONNEL _____ REFERENCE NO. 16 SHEET 15 OF 25
 NOTES LOHRKE
 H.C. CANTERBURY DATE 3-30-84 ROUTE SR2
 R.C. VOGEL WEATHER Nice COUNTY LUCAS
 _____ TEMP. +45 TOWNSHIP SPRINGFIELD
 _____ SECTION 20
 _____ T. 7 N. R. 10 E

TYPE MONUMENT MON. BOX
 ON SURFACE - ~~BELOW~~ YES
 LEFT- & PAV'T. - RIGHT Yes
 _____ TO _____ EDGE PAVEMENT
 S.L.M. 417+00

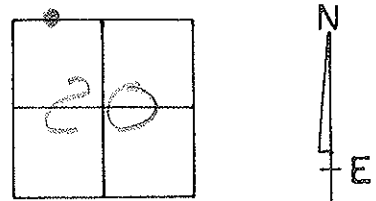

REC. 417+77.23

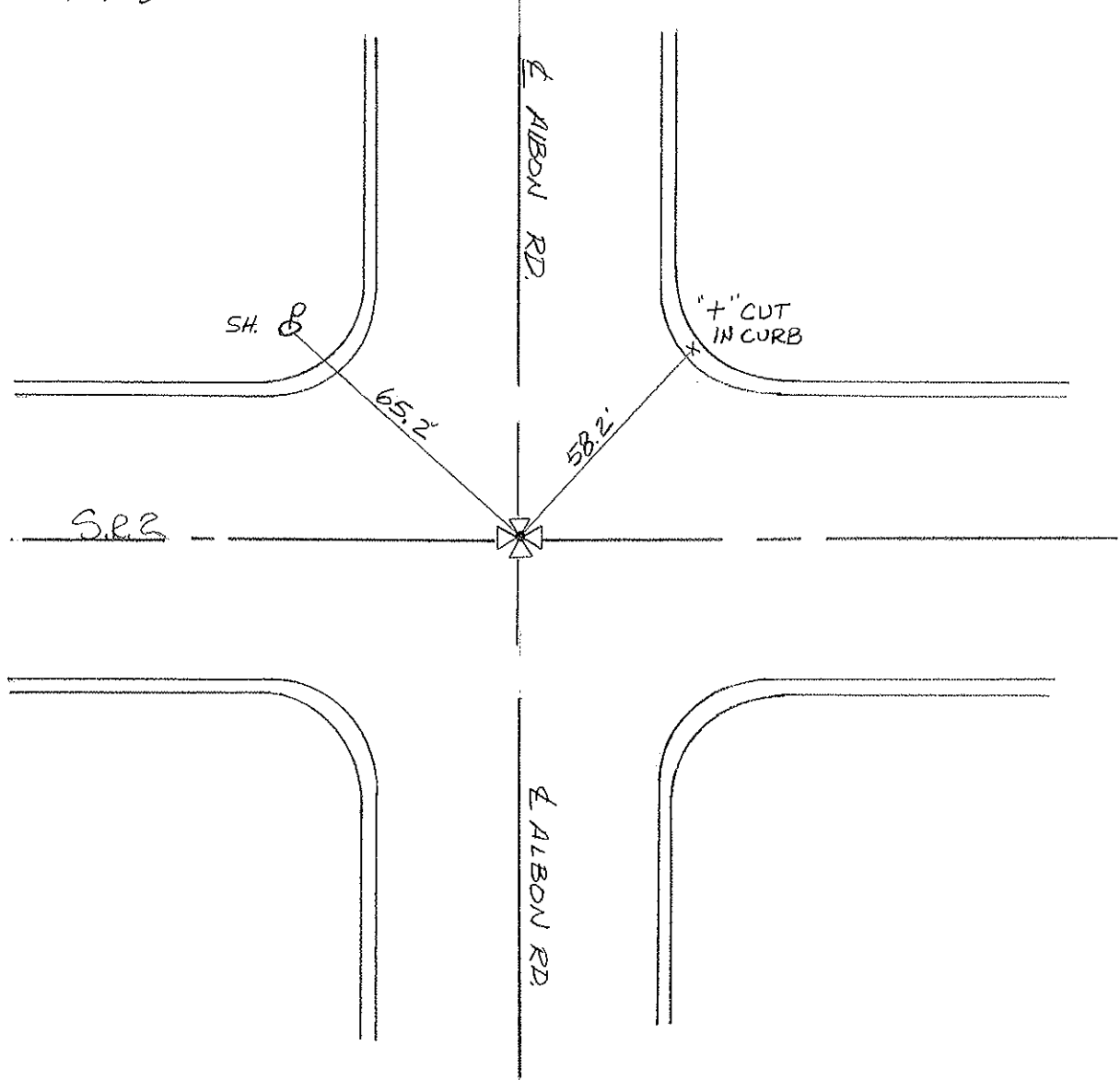

PERSONNEL	TITLE	PERSONNEL	TITLE	COUNTY	DATE	S. R.	WEATHER	TEMP.
Stake				Lucas	14 Sept. 77	#2	Fair	67°
⊕								
Crew								

DESCRIPTION References to Control Points JOB NO. _____

LEFT CENTER LINE RIGHT

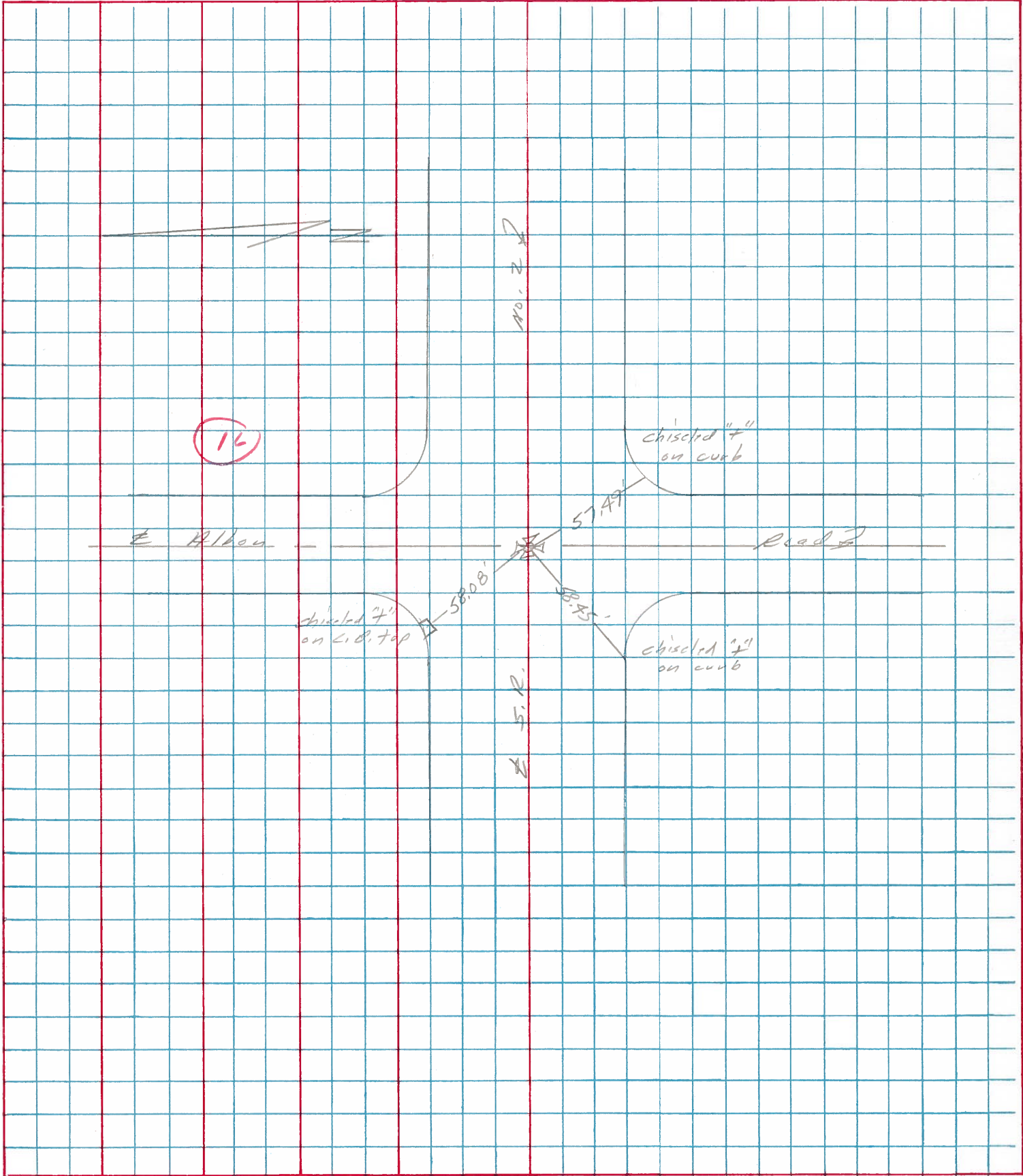

PERSONNEL	TITLE	PERSONNEL	TITLE	COUNTY	DATE	WEATHER	TEMP
Stoner		Brindley		Lucas	17 June 71	Fair	66°
Michalot	H.C.			S. R. #2			
Schroder	R.C.			SEC. Grissay Rd. - East			
Farr							

DESCRIPTION References to Control Points JOB NO. _____

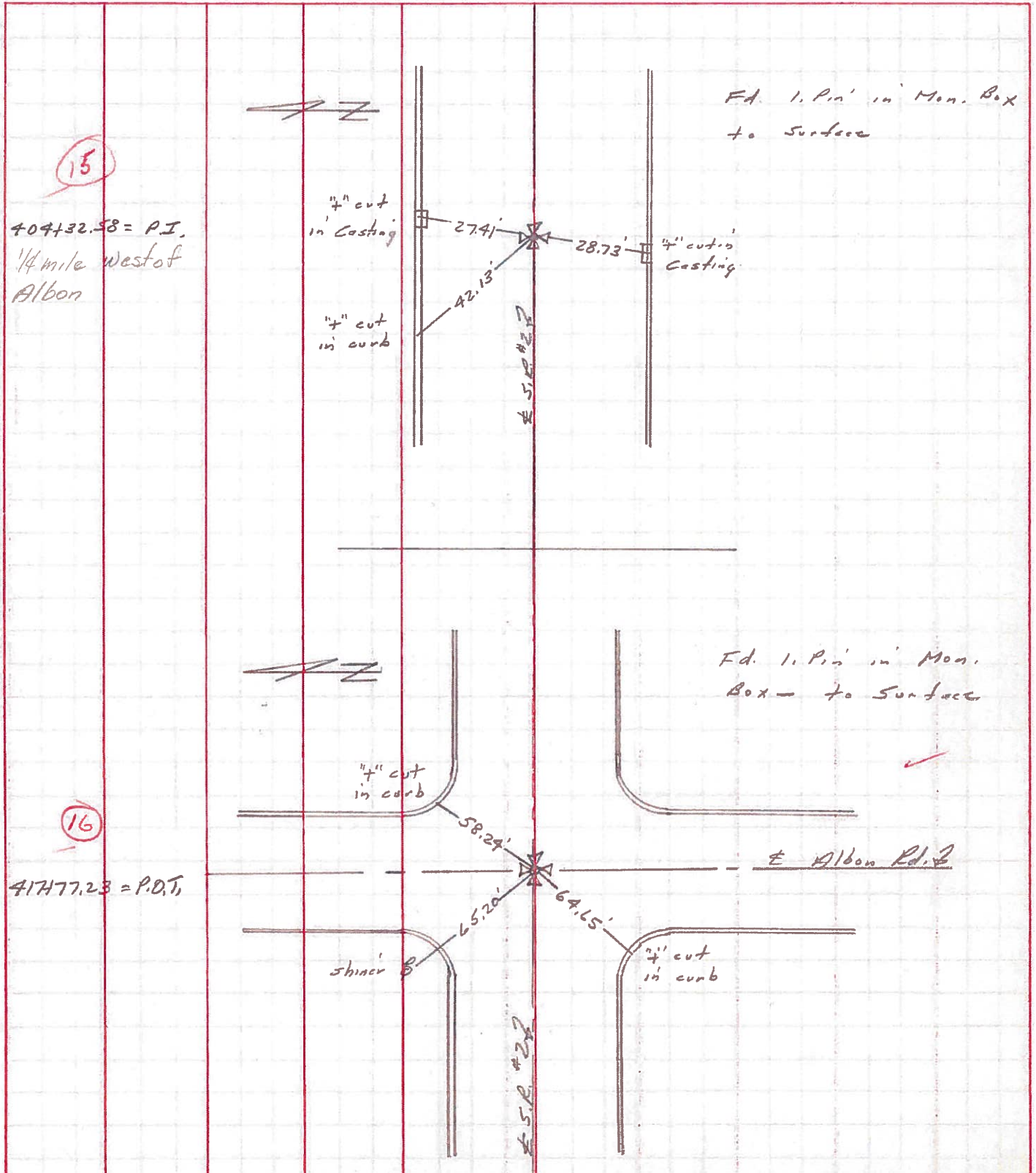

PERSONNEL	TITLE	PERSONNEL	TITLE
COUNTY <u>Lucas</u>			
DATE <u>9-20-57</u>			
<u>Bowerman 5-1-58</u>			
S. R. <u>#2</u>			
WEATHER			
SEC.			
TEMP.			

DESCRIPTION	LEFT	CENTER LINE	RIGHT	JOB NO.
Sta. 99+34.30 mon. - Rod in conc. - Set P.K.	#131 (15)		N.W. to near cor. top conc. blk. porch. 88.62' E.S.E. to P.W. man. 72.13' E.N.E. to P.W. man. 72.50' S.E. to shiner in 30" walnut 37.22' S.E. to witness man. 51.33' N.E. to witness man. 40.42'	
Sta. 112+80.00 Albon Rd. mon. - Iron rod in conc. - Set P.K.	#132 (16)		N.E. to bot. conc. blk. store rm. 52.57' N.W. to point of V. in Co. B.M. 52.70' S.W. to 4-in East end pump island 79.94'	
Sta. 126+07.22 set shiner from ref. - Set P.K.	#133 (16-A)		N.W. to shiner in 24" maple 45.09' S. to shiner in P.P. 29.13' N. to shiner in T.P. 28.95'	
Sta. 152+58.77 man. - Set P.K. N.E. cor. sec. 20	#134 (26) (17)		N.E. to iron A.P. West side of dr. 57.75' N.W. to iron A.P. East side of gate 76.24' N. to witness man. 36.85' S. to witness man. 28.38' N.E. to witness man. 50.85'	