

O.D.O.T. DISTRICT 2 SURVEY OFFICE (USE ONLY)

PERSONNEL _____ REFERENCE NO. 17 SHEET 1 OF 18
 NOTES LOEHRKE DATE 3-30-94 ROUTE SR 2
 H.C. CANTERBURY WEATHER NICE COUNTY LUCAS
 R.C. VOGEL TEMP. 48° TOWNSHIP SPRINGFIELD
 DWG BY JAMES PID 95717 SECTION 20
 T 7 N R 10 E

TYPE MONUMENT MONBOX W/3/4" IPIN
 ON SURFACE - ~~BELOW~~ ON
 OFFSET ☉ PAVEMENT ON LT : RT
25' TO LT EDGE PAVEMENT
 STATION: 456+98.62

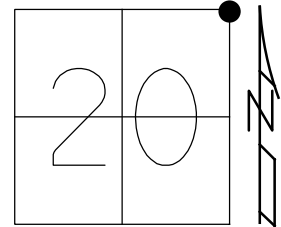

HORZ.DATUM: NAD83 2011 GEOID: NAVD88 2012A
 GRID: NORTHING: 710468.385 EASTING: 1634109.371

RECORD: P.I.
 STA 457+54.39
 FD MONBOX
 6/14/71, IRS
 3-30-94, CL
 FD MONBOX
 W/ 3/4" IPIN
 REF17
 2/11/15, EBW
 6-23-16, JFO

CUT "+S
 IN CASTING

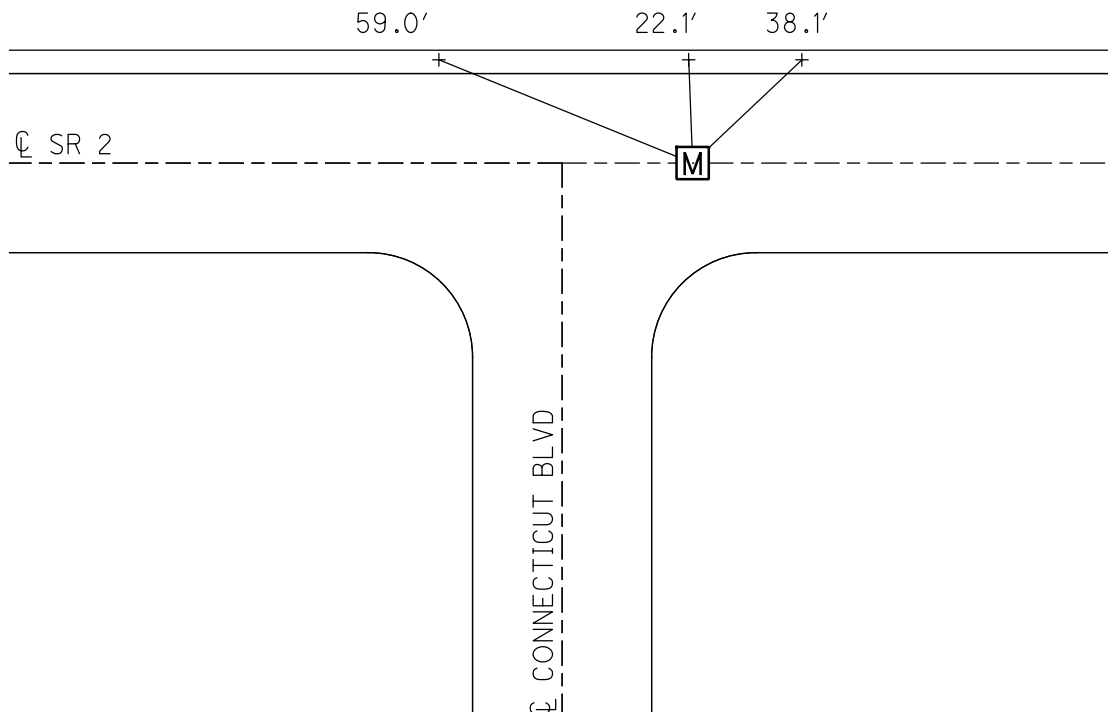

O.D.O.T. DISTRICT 2 SURVEY OFFICE (USE ONLY)

PERSONNEL

REFERENCE NO. 17

SHEET 1 OF 18

NOTES LOEHRKE

DATE 3-30-94

ROUTE SR 2

H.C. CANTERBURY

WEATHER NICE

COUNTY LUCAS

R.C. VOGEL

TEMP. 48°

TOWNSHIP SPRINGFIELD

SECTION 20

DWG BY JAMES PID 95717

T 7 N R 10 E

TYPE MONUMENT MONBOX

ON SURFACE - ~~BELOW~~ ON

OFFSET Q PAVEMENT ON LT : RT

25' TO LT EDGE PAVEMENT

STATION: 456+70

HORZ. DATUM: NAD83 2011

GEOID: NAVD88 2012A

GRID: NORTHING: 710468.385

EASTING: 1634109.371

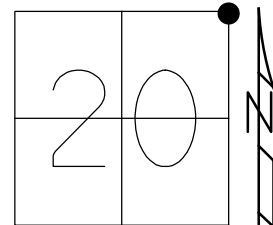

RECORD: P.I.
 STA 457+54.39
 FD MONBOX
 6/14/71, IRS
 3-30-94, CL
 FD MONBOX
 W/ 3/4" IPIN
 6-23-16, JFO

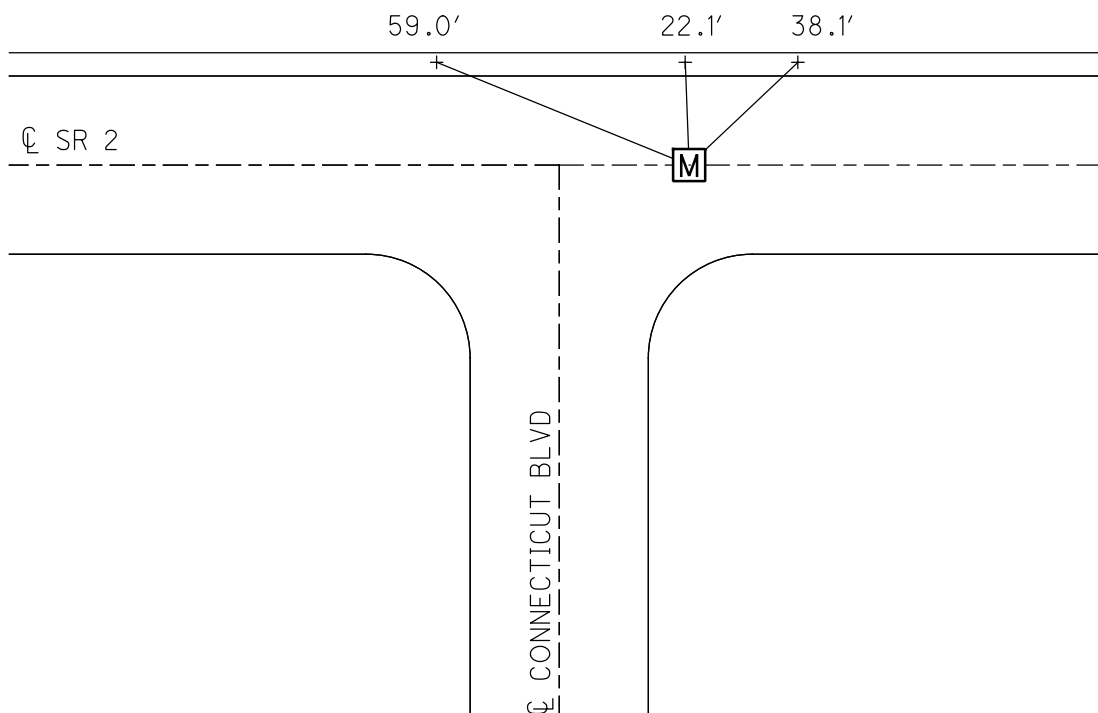

O.D.O.T. DISTRICT 2 SURVEY OFFICE (USE ONLY)

PERSONNEL _____ REFERENCE NO. 17 SHEET 30 OF 31
 NOTES LOHRKE DATE 3/30/94 ROUTE SR 2
 H.C. CANTERBURY WEATHER NICE COUNTY LUCAS
 R.C. VOGEL TEMP. 48° TOWNSHIP SPRINGFIELD
 _____ SECTION 20
 _____ T 7 N R 10 E

TYPE MONUMENT MON BOX
 ON SURFACE - ~~BELOW~~ ON _____
~~LEFT~~ - ☉ PAV'T - ~~RIGHT~~ ON _____
25' TO LT EDGE PAVEMENT
 S.L.M. 456+98.62
 GRID: NORTHING: 710468.385 EASTING: 1634109.371

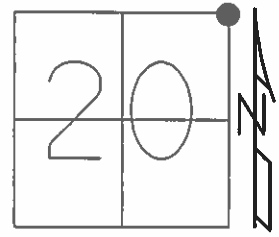

RECORD: P.I.
 STA. 457+54.39
 FD 3/4" IPIN IN BOX
 REF A17
 2/11/15

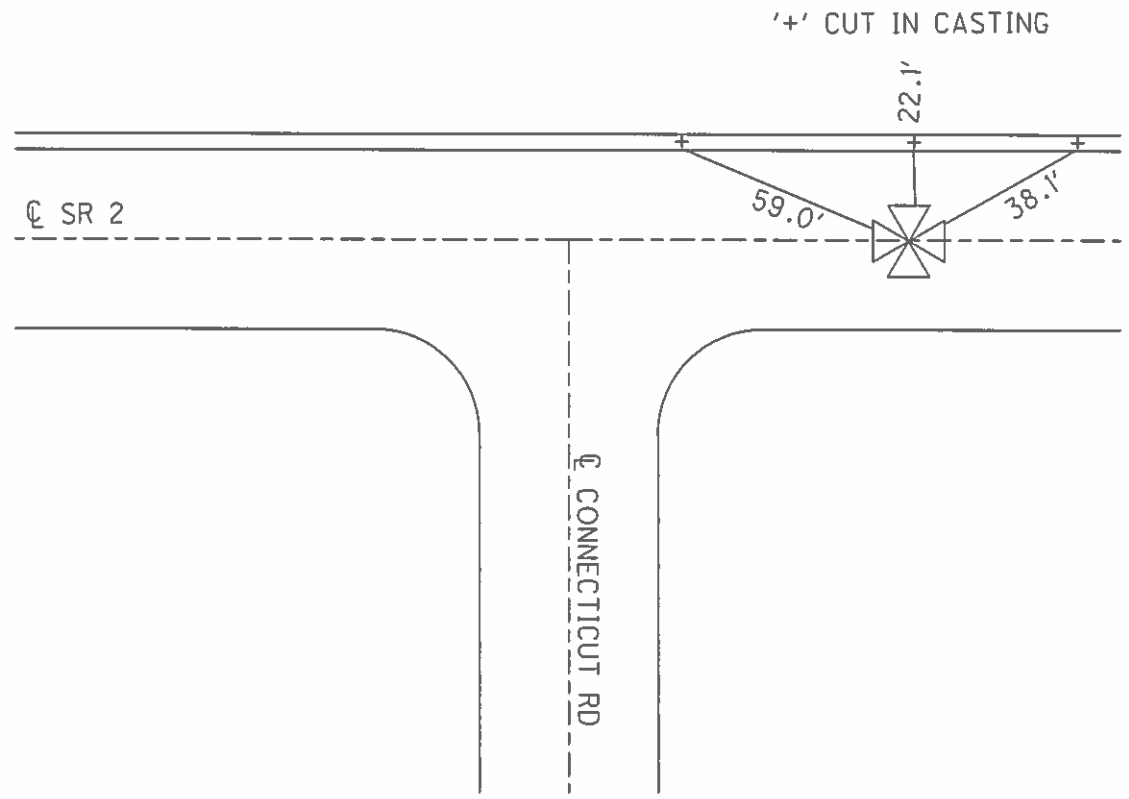

O.D.O.T. DISTRICT 2 SURVEY OFFICE

PERSONNEL

REFERENCE NO. 17

SHEET 17 OF 25

NOTES LOEHRKE

H.C. CANTERBURY

R.C. VOGEL

DATE 3-30-94

WEATHER Nice

TEMP. +48

ROUTE SRR

COUNTY LUCAS

TOWNSHIP SPRINGFIELD

SECTION 20

T. 7 N. R. 10 E.

TYPE MONUMENT MON BOX

ON SURFACE - ~~BELOW~~ YES

~~LEFT - & PAW'T.~~ - RIGHT Yes

25 TO Lt EDGE PAVEMENT

S.L.M. 456+70

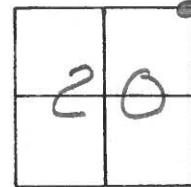

REC. 457+54.39 P.I.

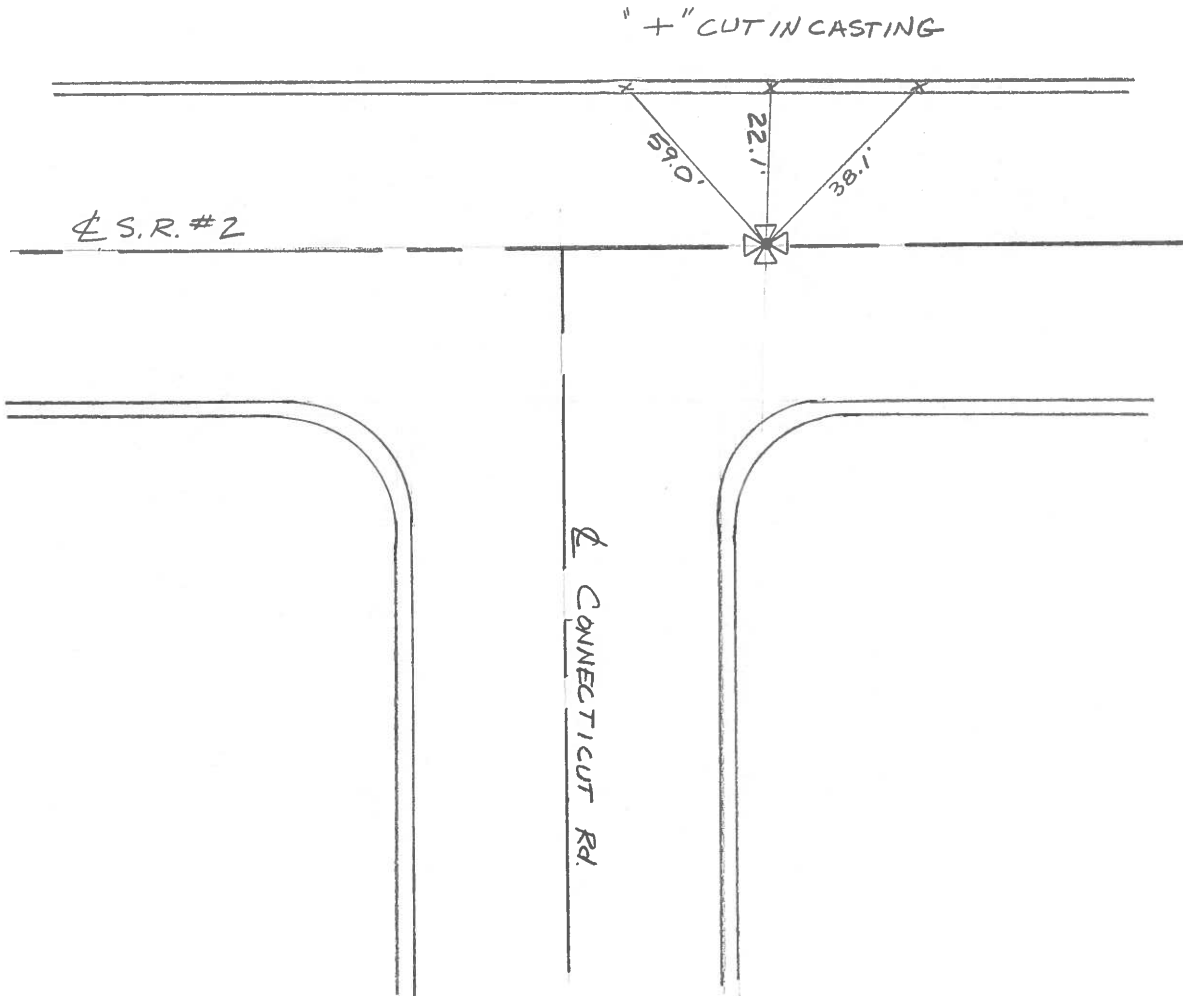

PERSONNEL	TITLE	PERSONNEL	TITLE	COUNTY	DATE
Stone		Bridley		Lucas	17 June 71
Michalak				S. R. #2	WEATHER Fair
Schroder				SEC. Crissey Rd. - East	TEMP. 66°
Farr					

DESCRIPTION References to Control Points JOB NO. _____

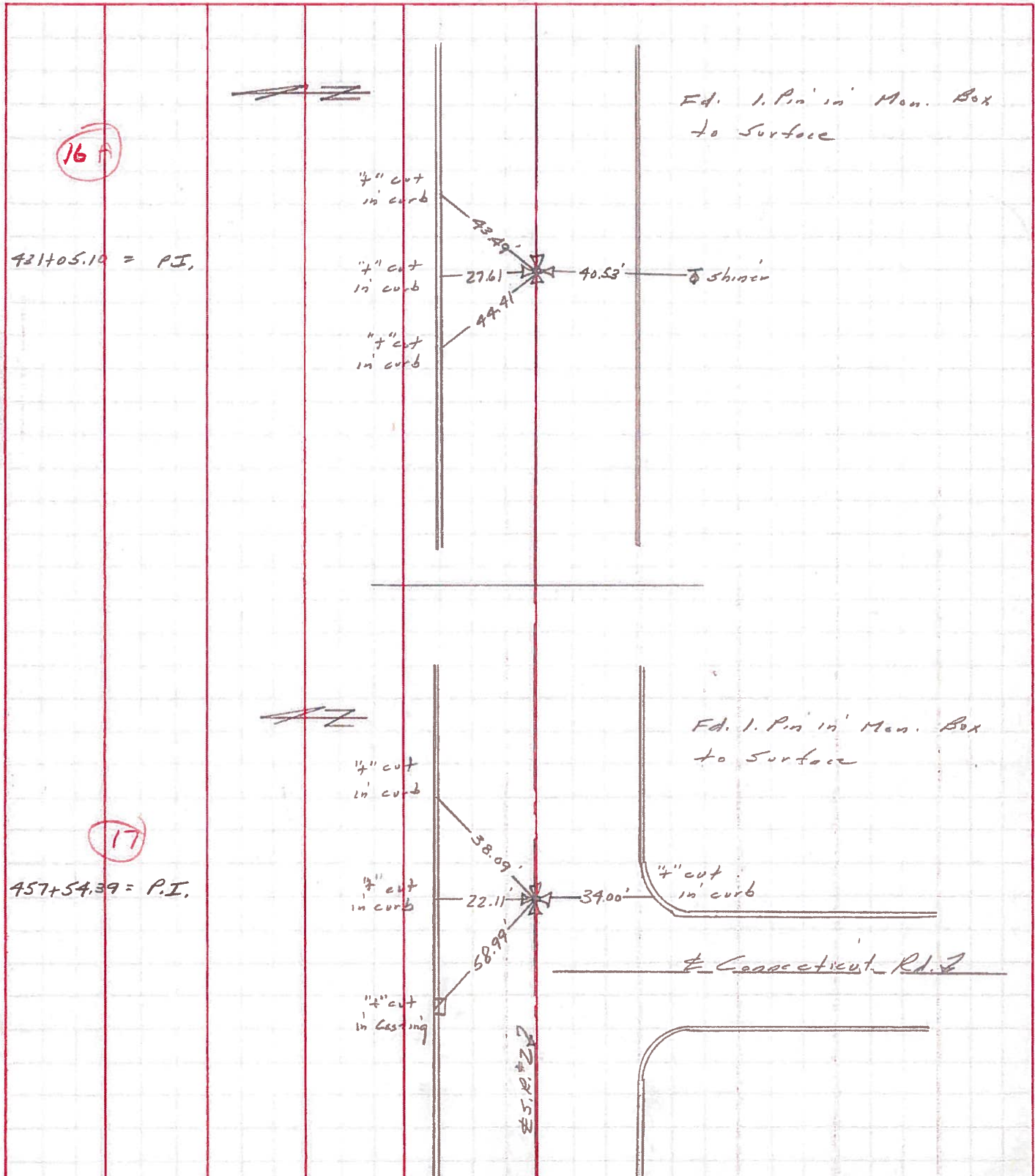

PERSONNEL	TITLE	PERSONNEL	TITLE

COUNTY Lucas DATE 9-20-57
Bowerman 5-1-58
 S. R. #2 WEATHER _____
 SEC. _____ TEMP. _____

DESCRIPTION	LEFT	CENTER LINE	RIGHT	JOB NO.
Sta. 99+34.30 man. - Rod in conc. - Set P.K.	#131 15		N.W. to near cor. top conc. blk. porch. 88.62' E.S.E. to P/W man. 72.13' E.N.E. to P/W man. 72.50' S.E. to shiner in 30" walnut 37.22' S.E. to witness man. 51.33' N.E. to witness man. 40.42'	
Sta. 124+80.00 Albon Rd. man. - Iron rod in conc. - Set P.K.	#132 16		N.E. to bot. conc. blk. store Pdn. 52.57' N.W. to point of V. in Co. B.M. 52.70' S.W. to + in East end pump island 79.94'	
Sta. 126+07.22 set shiner from ref. - Set P.K.	#133 16-A		N.W. to shiner in 24" maple 45.09' S. to shiner in P.P. 29.13' N. to shiner in T.P. 28.98'	
Sta. 152+58.77 man. - Set P.K. N.E. cor. sec. 20	#134 26 17		N.E. to iron A.P. West side of dr. 57.75' N.W. to iron A.P. East side of gate 76.24' N. to witness man. 30.85' S. to witness man. 28.38' N.E. to witness man. 50.85'	