

O.D.O.T. DISTRICT 2 SURVEY OFFICE (USE ONLY)

PERSONNEL _____

REFERENCE NO. 18

SHEET 2 OF 18

NOTES LOEHRKE

DATE 3/30/94

ROUTE SR 2

H.C. CANTERBURY

WEATHER NICE

COUNTY LUCAS

R.C. VOGEL

TEMP. 44°

TOWNSHIP SPRINGFIELD

SECTION 21

DWG BY JAMES PID 95717

T 7 N R 10 E

TYPE MONUMENT MONBOX W/1" IPIN

ON SURFACE - ~~BELOW~~ ON

OFFSET ☑ PAVEMENT ON _____ LT : RT

- TO - EDGE PAVEMENT

STATION: 483+22.51

HORZ.DATUM: NAD83 2011

GEOID: NAVD88 2012A

GRID: NORTHING: 710423.869

EASTING: 1636732.925

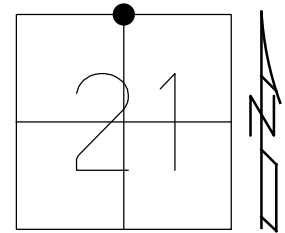

RECORD:
 STA. 483+78.28
 FD MONBOX
 6/14/71, IRS
 3-30-94, CL
 FD MONBOX
 W/ 1" IPIN
 REF18
 2/11/15, EBW
 6-23-16, JFO

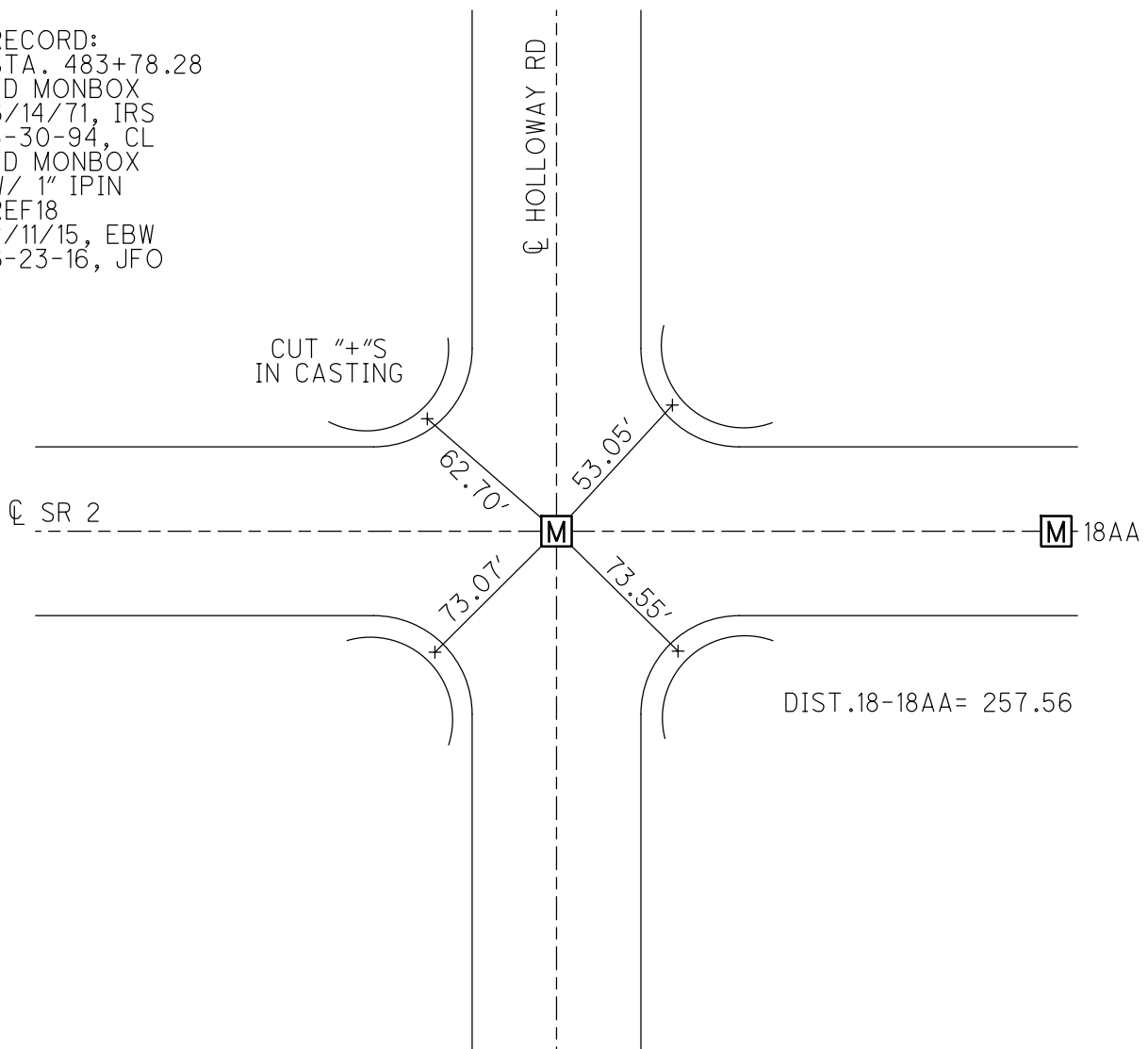

O.D.O.T. DISTRICT 2 SURVEY OFFICE (USE ONLY)

PERSONNEL

REFERENCE NO. 18

SHEET 2 OF 18

NOTES LOEHRKE DATE 3/30/94
 H.C. CANTERBURY WEATHER NICE
 R.C. VOGEL TEMP. 44°

ROUTE SR 2
 COUNTY LUCAS
 TOWNSHIP SPRINGFIELD
 SECTION 21

DWG BY JAMES PID 95717

T 7 N R 10 E

TYPE MONUMENT MONBOX

ON SURFACE - ~~BELOW~~ ON

OFFSET CL PAVEMENT ON LT : RT

- TO - EDGE PAVEMENT

STATION: 482+52.69

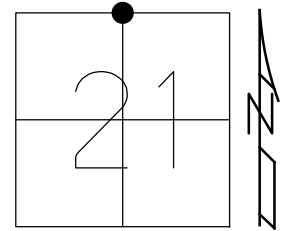

HORZ. DATUM: NAD83 2011

GEOID: NAVD88 2012A

GRID: NORTHING: 710423.869

EASTING: 1636732.925

RECORD:
 STA. 483+78.28
 FD MONBOX
 6/14/71, IRS
 3-30-94, CL
 FD MONBOX
 W/ 1" IPIN
 REF18
 6-23-16, JFO

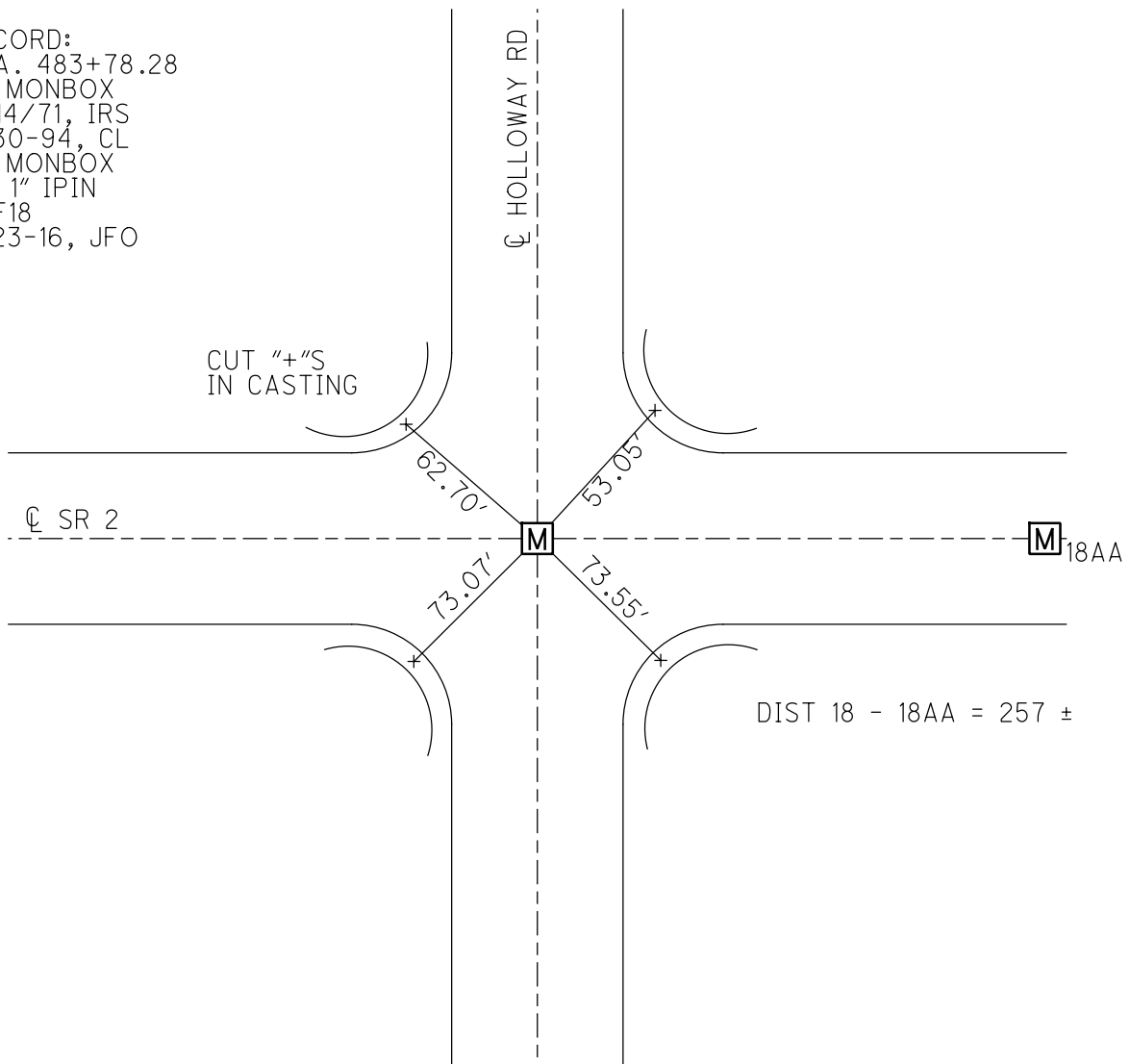

O.D.O.T. DISTRICT 2 SURVEY OFFICE (USE ONLY)

PERSONNEL _____ REFERENCE NO. 18 SHEET 31 OF 31
 NOTES LOEHRKE DATE 3/30/94 ROUTE SR 2
 H.C. CANTERBURY WEATHER NICE COUNTY LUCAS
 R.C. VOGEL TEMP. 44° TOWNSHIP SPRINGFIELD
 _____ SECTION 21
 _____ T 7 N R 10 E

TYPE MONUMENT MON BOX
 ON SURFACE - ~~BELOW~~ ON
~~LEFT~~ - ☉ PAV'T - ~~RIGHT~~ ON
25' TO LT. EDGE PAVEMENT
 S.L.M. 483+12.51
 GRID: NORTHING: 710423.888 EASTING: 1636732.878

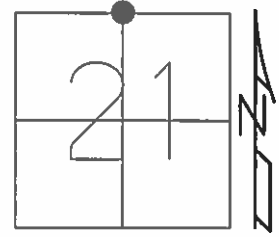

RECORD:
 STA. 483+78.28
 REF18,
 2/11/15

TOP CTR OF SOUTH BOLT
 OF LIGHT SUPPORT POLE

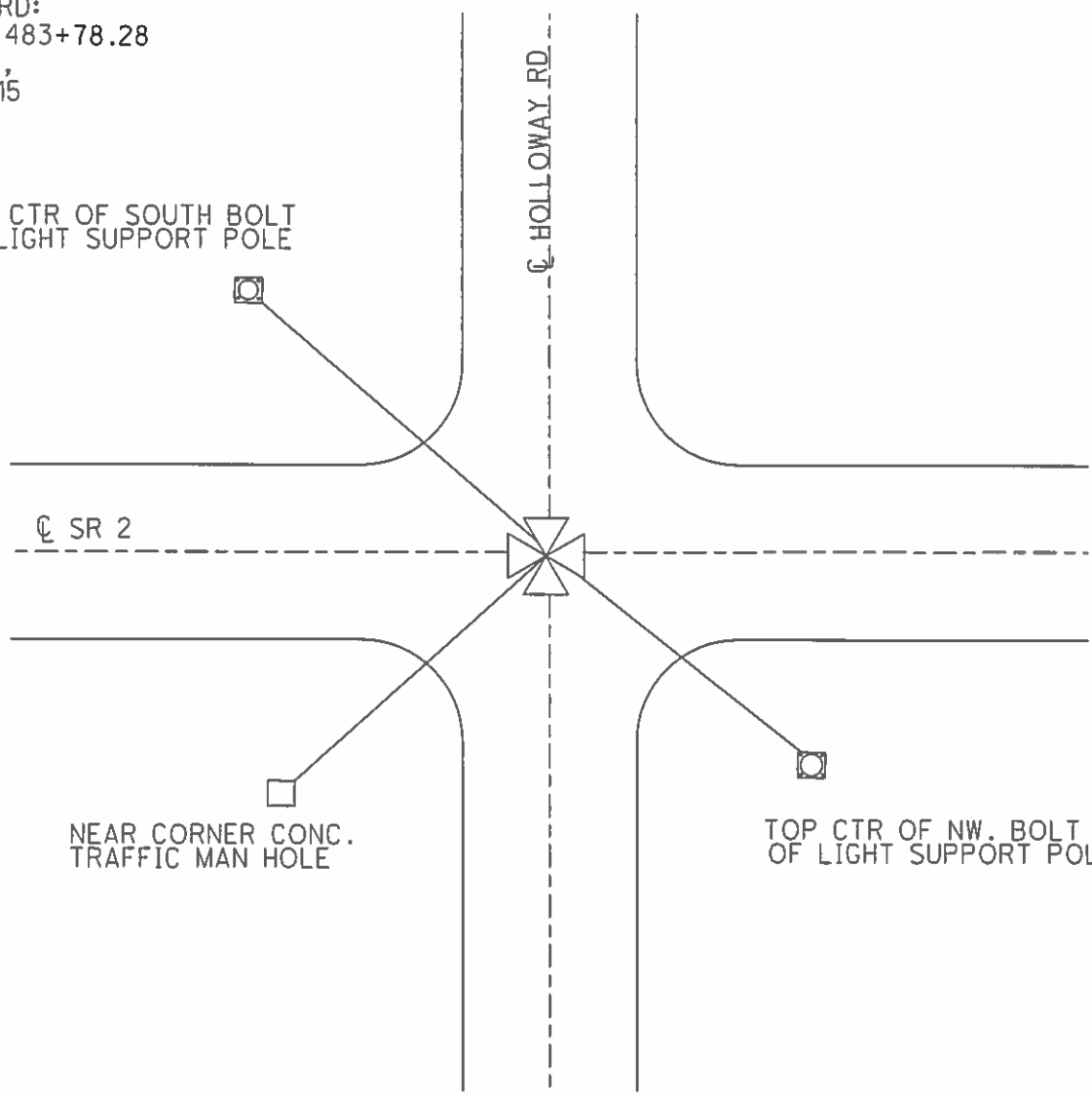

NEAR CORNER CONC.
 TRAFFIC MAN HOLE

TOP CTR OF NW. BOLT
 OF LIGHT SUPPORT POLE

O.D.O.T. DISTRICT 2 SURVEY OFFICE

PERSONNEL _____

REFERENCE NO. 18

SHEET 18 OF 25

NOTES LOEHARKE

H.C. CANTERBURY

R.C. VOGEL

DATE 3-30-94

WEATHER Nice

TEMP. +44

ROUTE SR2

COUNTY LUCAS

TOWNSHIP SPRINGFIELD

SECTION 21

T 7 N R 10 E

TYPE MONUMENT MON BOX

ON SURFACE - ~~BELOW~~ YES

LEFT - ☐ PAV'T. - RIGHT Both

 TO EDGE PAVEMENT

S.L.M. 482+95

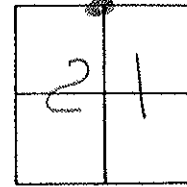

REC.
483+78.28

Box OPENED; Meas.
to IRON PIN

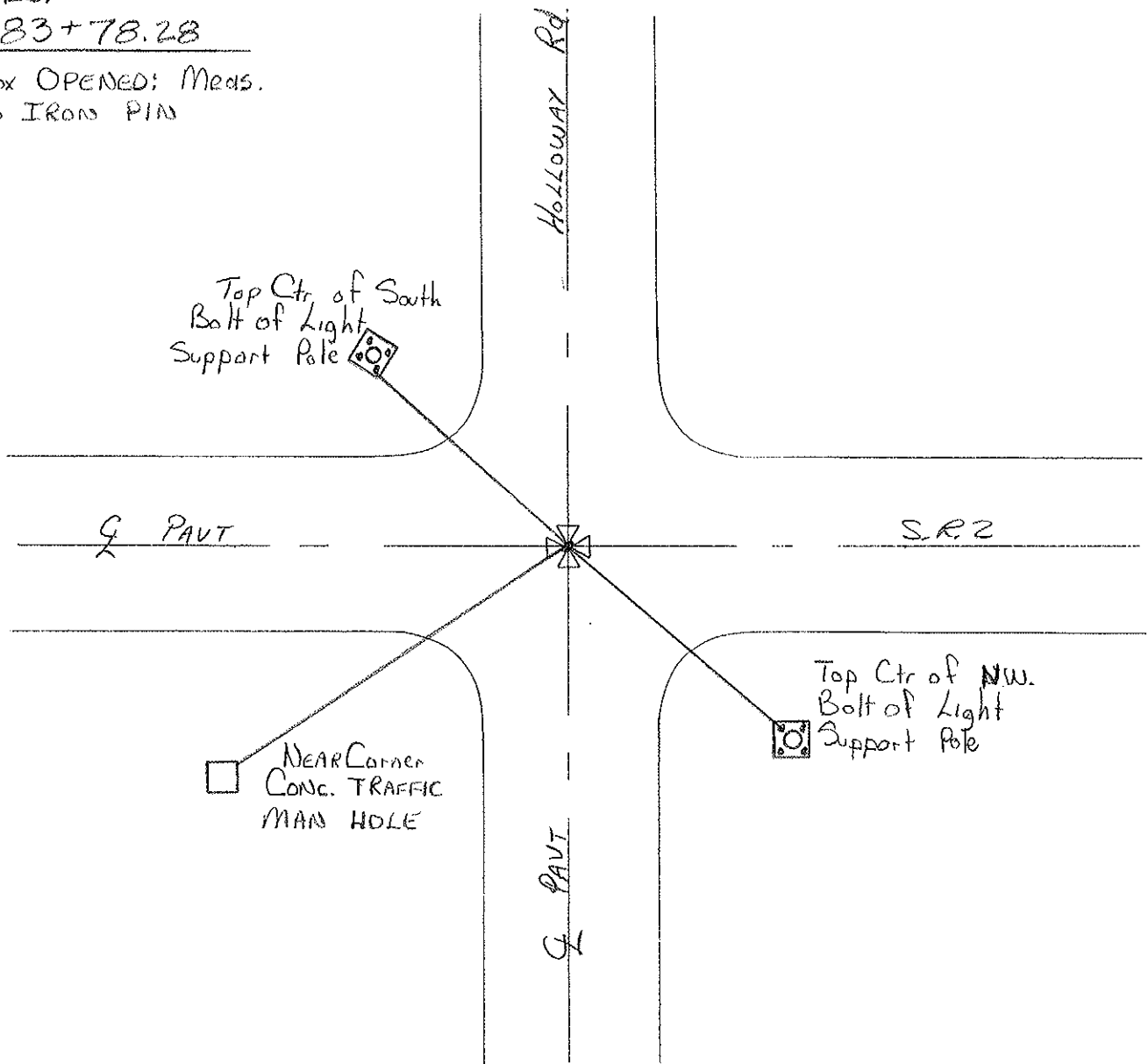

PERSONNEL	TITLE	PERSONNEL	TITLE	COUNTY	DATE	WEATHER	TEMP.
Stone		Bradley		Lucas	14 June 71	Fair	68°
Michalak				S. R. #2			
Schroder				SEC. Caissey Rd. East			
Farr							

DESCRIPTION: References to Control Points JOB NO. _____

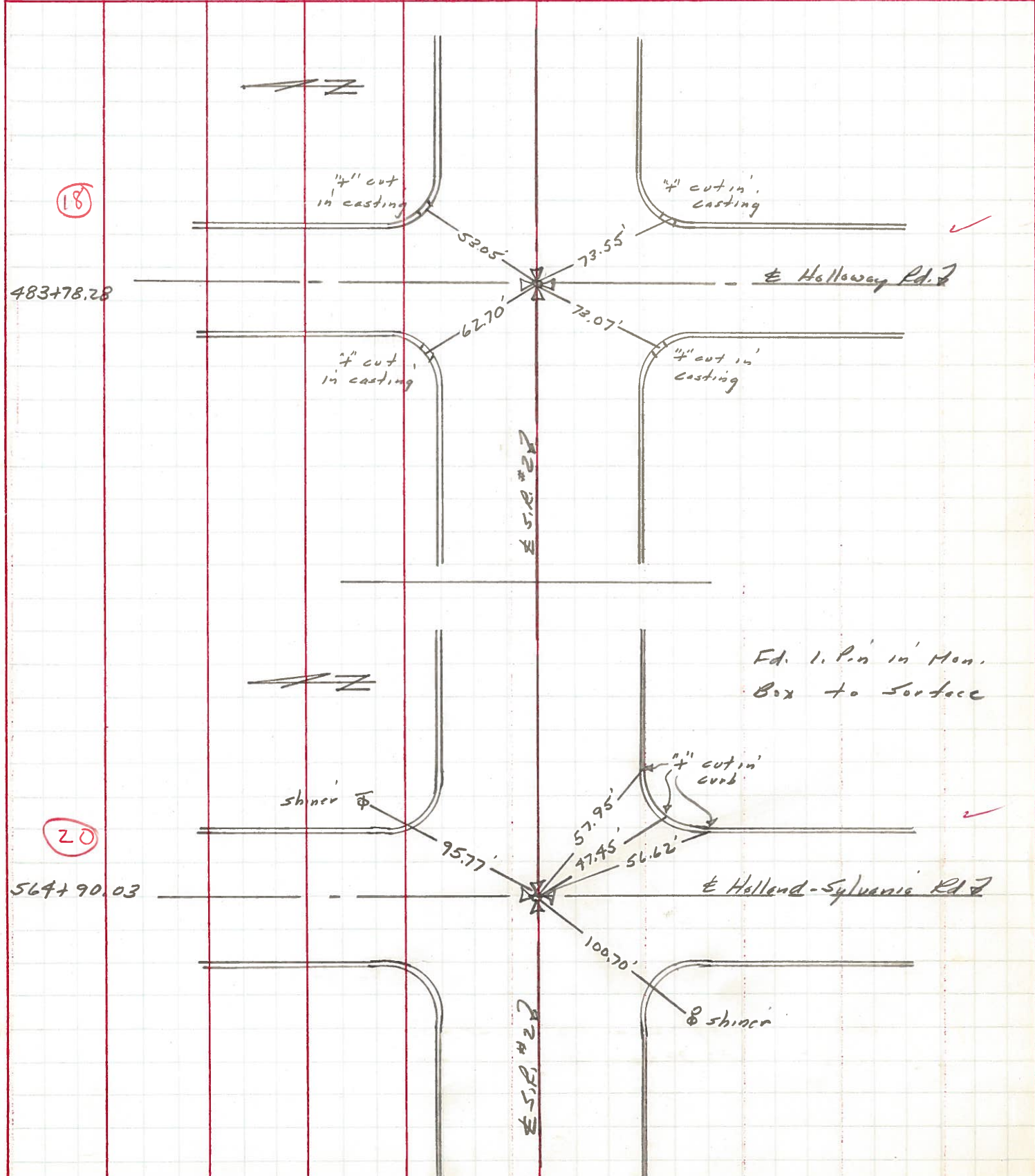

PERSONNEL TITLE PERSONNEL TITLE

COUNTY Lucas

DATE 9-20-57

S. R. #2

WEATHER

SEC.

TEMP.

DESCRIPTION

LEFT

CENTER LINE

RIGHT

JOB NO.

Sta. 178+83.15 Holloway Rd. Iron cap	#135 (18)	O.K.	S.W. to N.E. cor. conc. block Adn. S.E. to point of "V" in Pa. B.M. N.E. to S.W. cor. Gas Sta. bldg.	75.57' 44.06' 93.48'
Sta. 185+20.37 P.C. of curve Brass Cap	#136	O.K.	S. to R/W mon. N. to R/W mon. (Bent over) N.W. to witness mon. N.E. to witness mon.	30.03' 30.19' 41.72' 41.17'
Sta. 187+99.76 P.I. of curve Fd. old stake - Fd. Brass Plate.	#137		S.W. to shiner in 18" apple S.S.W. to shiner in 18" apple S.E. to shiner in 20' pine	28.68 28.94 16.17 16.07 44.10 43.90
Sta. 190+63.98 P.T. of curve Brass plate	#138 (18-A)	Could not Find Ties gone	N.N.W. to witness mon. S.E. to shiner in P.P. N. to shiner in T.P. N.W. to shiner in 20' apple	36.58' 29.89' 35.30' 75.17'
Sta. 193+52.76 P.C. curve Brass Cap.	#139	O.K.	E.N.E. to S.W. cor. of bridge rail E.S.E. to N.W. Cor. of bridge rail N.W. to shi. in Guard rail post S.W. to shi. in Guard rail post N.W. to witness mon. N.E. to witness mon. S.S.W. to witness mon.	74.85 73.40 31.58 32.78 40.63' 34.92' 25.37'