

O.D.O.T. DISTRICT 2 SURVEY OFFICE (USE ONLY)

PERSONNEL

REFERENCE NO. 19 A

SHEET 11 OF 18

NOTES HOMAN DATE 8-8-07
 H.C. ROUSOS WEATHER SUNNY
 R.C. HOUDSHELL TEMP. 85°
VIETH

ROUTE SR 2
 COUNTY LUCAS
 TOWNSHIP SPRINGFIELD
 SECTION 15

DWG BY JAMES PID 95717

T 8 N R 10 E

TYPE MONUMENT P.K. SHANK

ON SURFACE - ~~BELOW~~ ON

OFFSET CL PAVEMENT ON LT : RT

- TO - EDGE PAVEMENT

STATION: 563+36±

HORZ.DATUM: NAD83 2011

GEOID: NAVD88 2012A

GRID: NORTHING: 711569.827

EASTING: 1644698.442

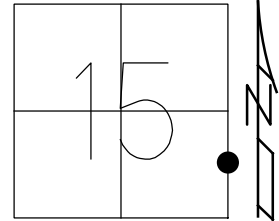

RECORD:
 FD CMON
 3/30/94
 SET P.K./WASHER
 5/9/94, CL
 FD P.K.SHANK
 8/8/07
 SET MAG/WASHER
 11/13/07, SAH
 FD MAG/WASHER
 REFA19
 6-23-16, JFO
 SET DRILL "+"
 W/ COORDS.
 1-2-19, JFO

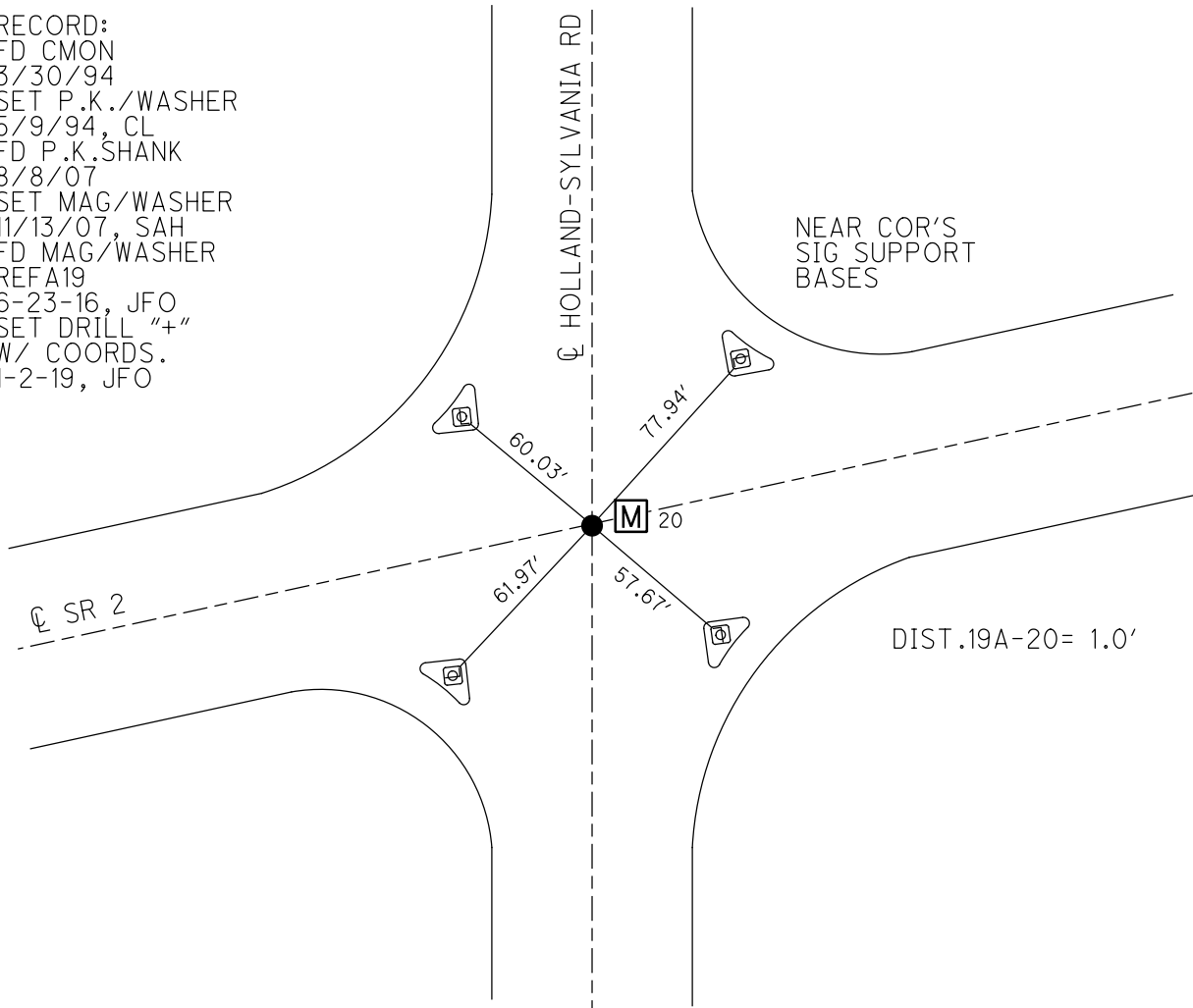

O.D.O.T. DISTRICT 2 SURVEY OFFICE (USE ONLY)

PERSONNEL _____

REFERENCE NO. 20

SHEET 4 OF 11

NOTES HOMAN

DATE 8/8/07

ROUTE SR 2

H.C. ROUSOS

WEATHER SUNNY

COUNTY LUCAS

R.C. HOUESHELL

TEMP. 85°

TOWNSHIP SPRINGFIELD

VIETH

DWG BY RHOADES

PID -

SECTION 15

T 2 USR

TYPE MONUMENT P.K.SHANK

ON SURFACE - ~~BELOW~~ ON

OFFSET ☉ PAVEMENT ON LT : RT

- TO - EDGE PAVEMENT

STATION: 564+89.03

HORZ.DATUM: _____

GEOID: _____

GRID: NORTHING: _____

EASTING: _____

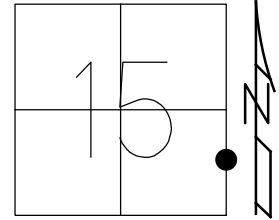

RECORDED: REF 19C
 FD CMON
 3/30/94
 SET P.K./WASHER
 5/9/94, CL
 FD P.K.SHANK 8/8/07
 SET MAG/WASHER
 11/13/07, SAH

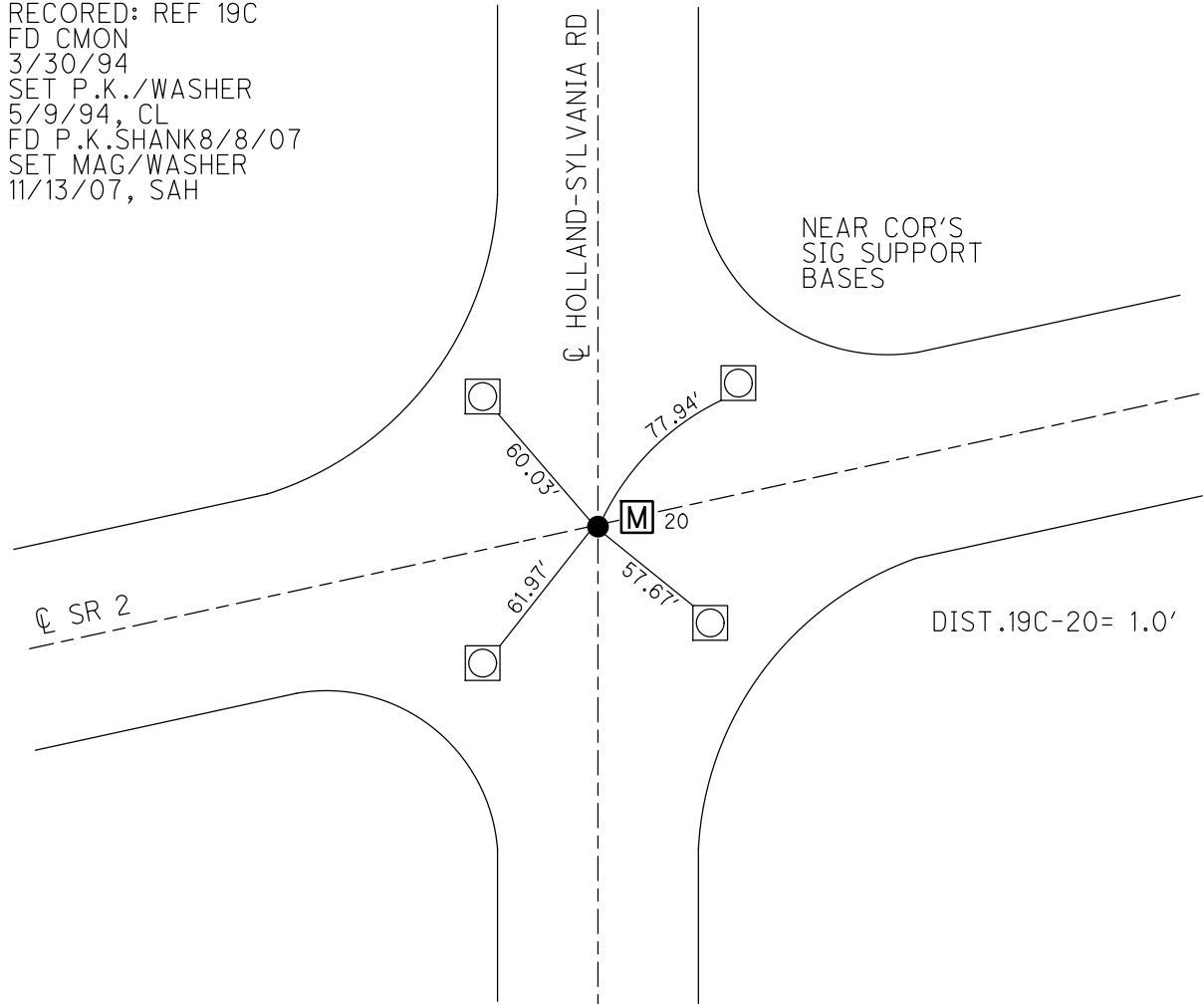

O.D.O.T. DISTRICT 2 SURVEY OFFICE (USE ONLY)

PERSONNEL	REFERENCE NO. <u>20</u>	SHEET <u>1</u> OF <u>5</u>
NOTES <u>HOMAN</u>	DATE <u>08-08-07</u>	ROUTE <u>SR 2</u>
H.C. <u>ROUSOS</u>	WEATHER <u>SUNNY</u>	COUNTY <u>LUCAS</u>
R.C. <u>HOUDSHELL</u>	TEMP. <u>+85°</u>	TOWNSHIP <u>SPRINGFIELD</u>
<u>VIETH</u>		SECTION <u>15</u>
		T <u>8</u> N R <u>10</u> E

TYPE MONUMENT "A"=PK SHANK, "B"=MON. BOX
 ON SURFACE - ~~BELOW~~ ON SURFACE
~~LEFT~~ - CL PAV'T - ~~RIGHT~~ "A" IS ON CL.
TO EDGE PAVEMENT
 S.L.M. 563+43 (SV9)
 GPS Northing=711569.996 Easting=1644699.396

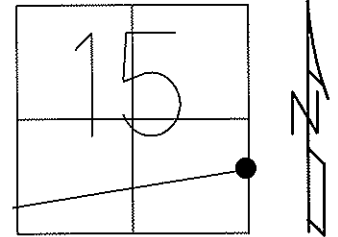

SET PK/WASHER @ "A"
 05-09-94 CL

SET MAG/WASHER @ "A"
 11-13-07 SAH

NOTE: ALL REFERENCES ARE FROM
 THE NEAR CORNER OF THE
 STEEL SIGNAL SUPPORT BASE.

"A" TO "B" = 1.0'

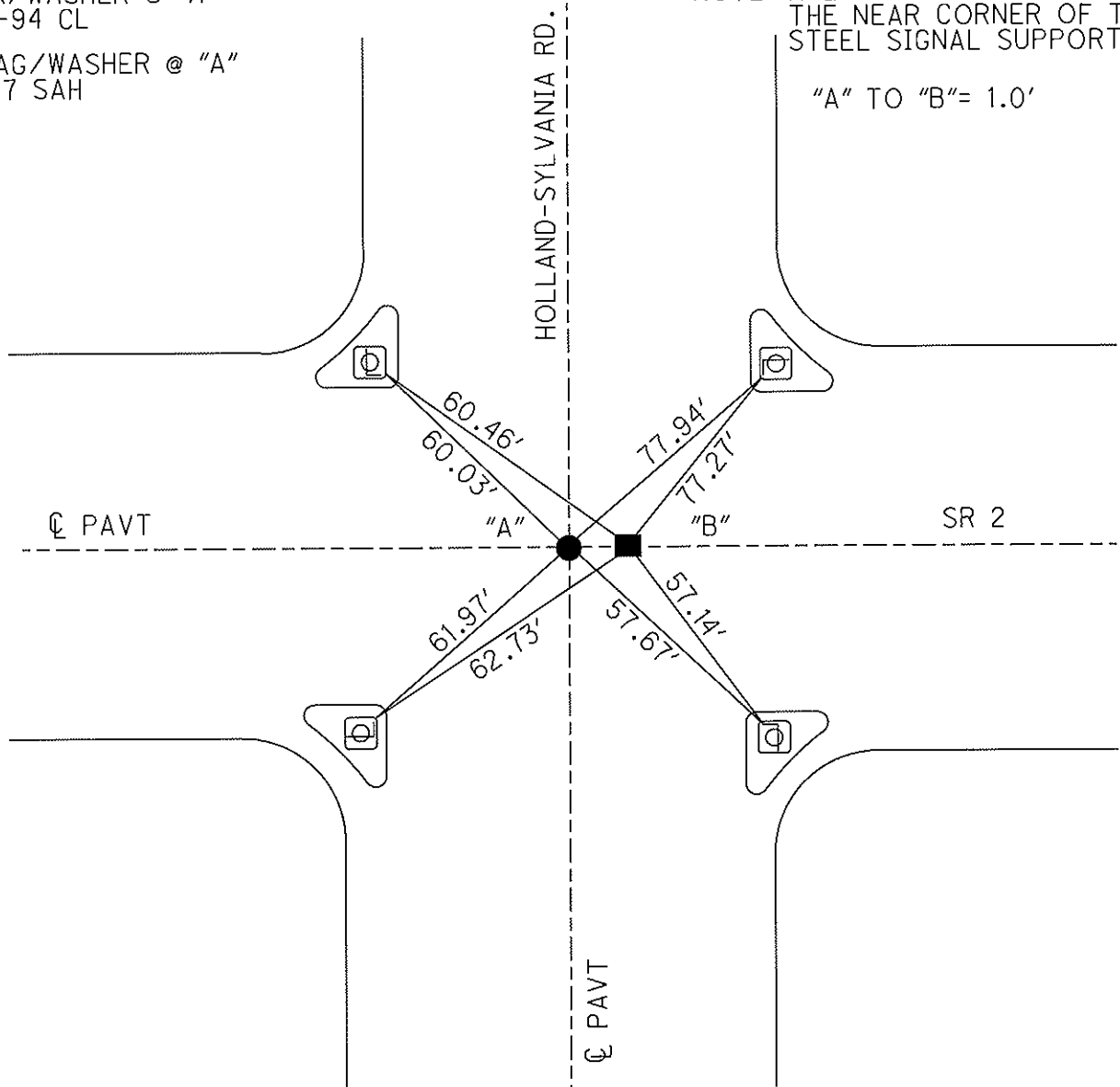

Resurvey 2007. PID 80509

O.D.O.T. DISTRICT 2 SURVEY OFFICE

PERSONNEL

REFERENCE NO. 20

SHEET 25 OF 25

NOTES LOEHRKE

H.C. CANTERBURY

DATE 3-30-94

ROUTE S.R. 2

R.C. VDGEL

WEATHER NICE

COUNTY LUCAS

HERMILLER

TEMP. +45

TOWNSHIP SPRINGFIELD

SECTION 15

T. & R. 10 E

TYPE MONUMENT A) I-PIN IN CONC., B) MON. BOX

ON SURFACE - ~~BELOW~~ YES - YES

LEFT-☉ PAV'T. - RIGHT A - YES

TO EDGE PAVEMENT

S.L.M. 563+43

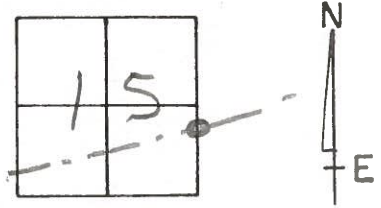

ALL REFERENCES ARE FROM THE NEAR CORNER OF THE STEEL SIGNAL SUPPORT BASE.

0.89 Btw.

* Pt. "A" Set P.K. / WASHER
5-9-94
C.L.

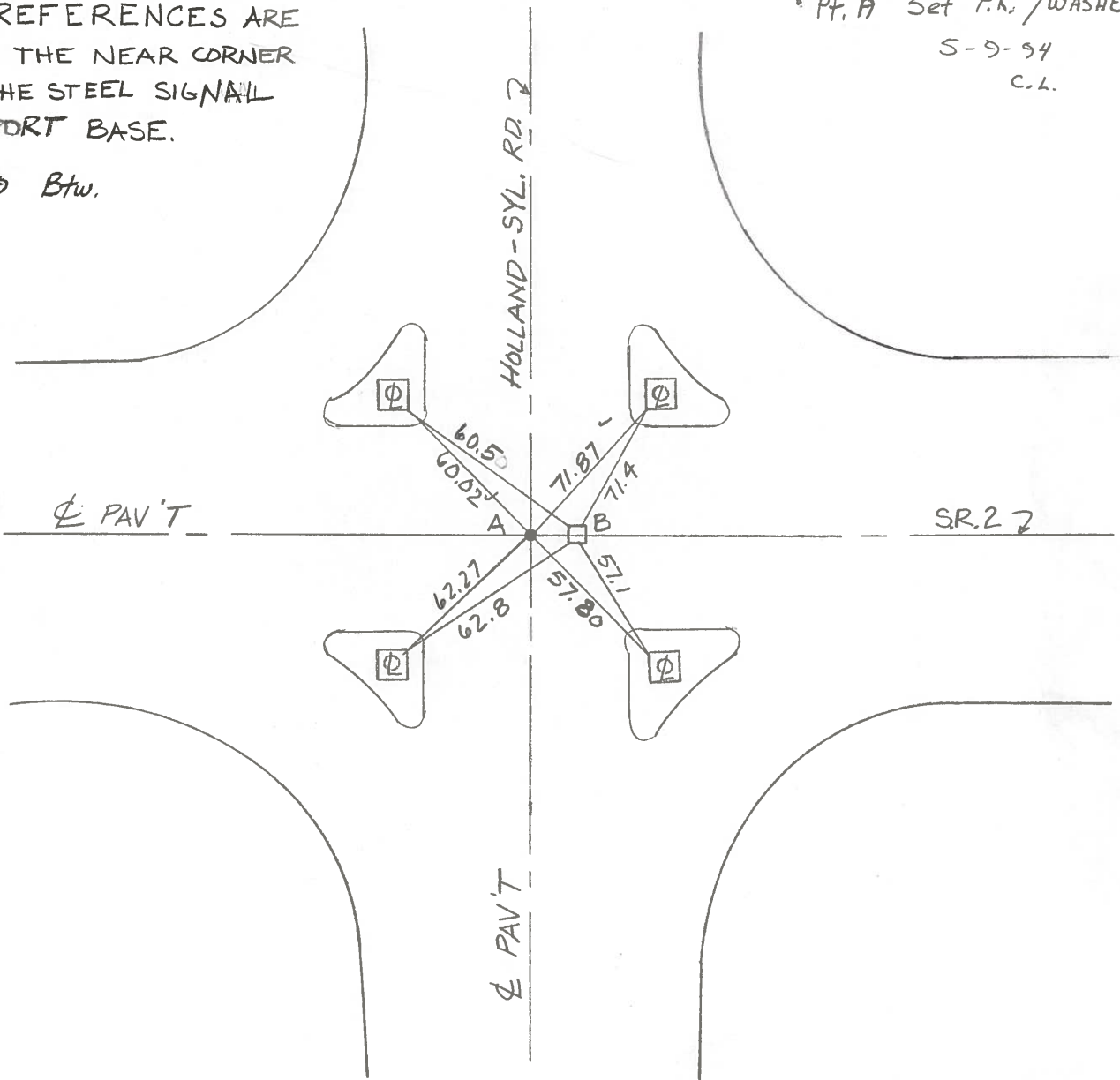

PERSONNEL TITLE PERSONNEL TITLE

Stone _____ Brindley _____ COUNTY Lucas DATE 14 June 71

Michalak _____ S. R. #2 WEATHER Fair

Schnoder _____

Farr _____ SEC. Cassico Rd. East TEMP. 68°

DESCRIPTION References to Control Points LEFT CENTER LINE RIGHT JOB NO. _____

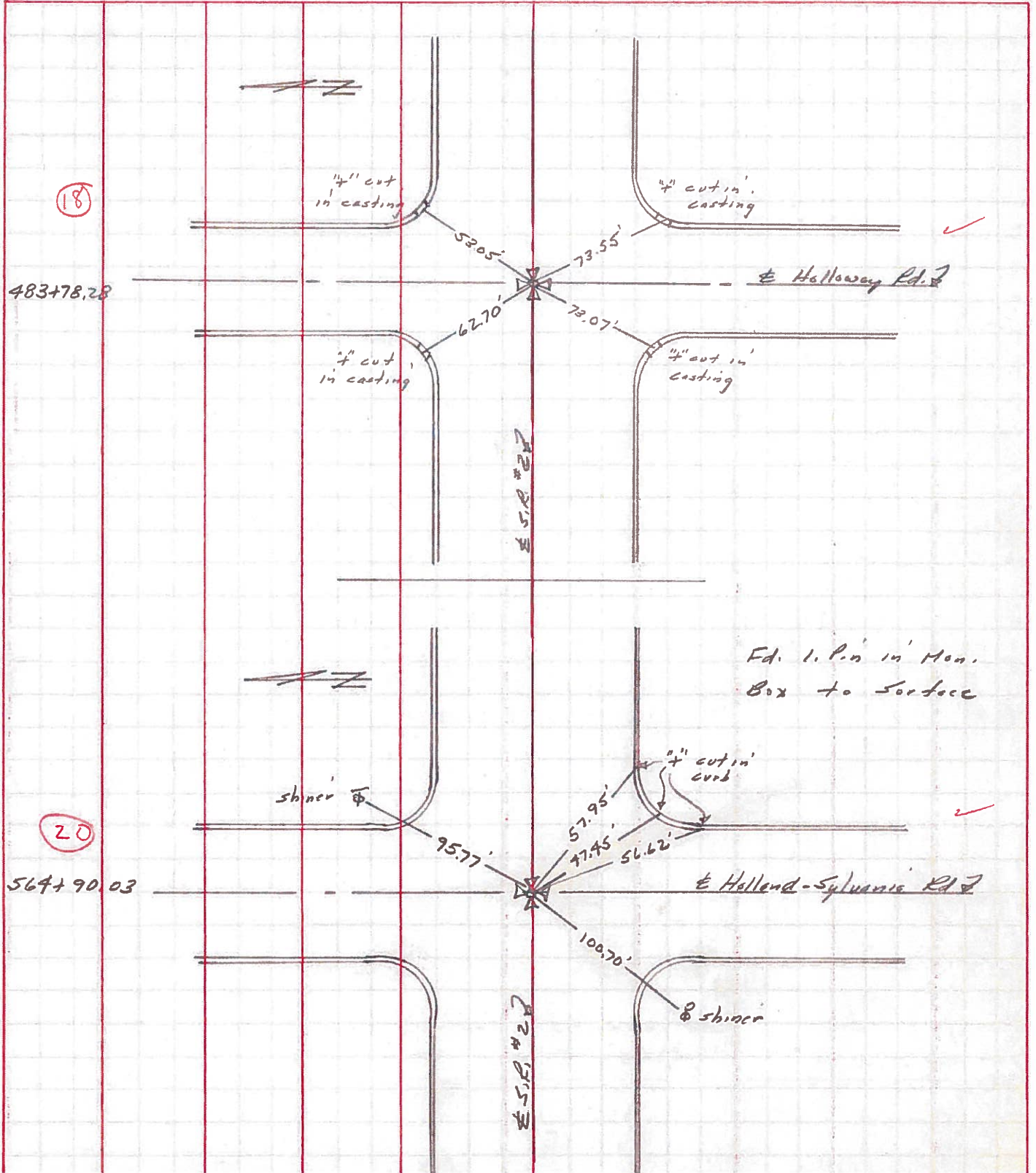

PERSONNEL	TITLE	PERSONNEL	TITLE
COUNTY <u>Lucas</u> DATE <u>3-18-53</u>			
S. R. <u>#2</u> WEATHER _____			
SEC. _____ TEMP. _____			

DESCRIPTION	LEFT	CENTER LINE	RIGHT	JOB NO.
Sta. 196+75.35 P.L. Curve	(Did not find)			
	#140			
Sta. 199+87.34 P.T. Curve Brass Cap.	Did not find		N.N.E. to R/W man. 32.61' E.N.E. to shiner in T.P. 77.25' S.W. to shiner in A.P. con post 41.95'	
	#141			
Sta. 206+87.61 Holland-Perrysburg Rd. Iron Cap.		a.k.	N.W. to <u>shiner in Tele. Pole</u> 56.29' 33.91' N.E. to <u>shiner in Tele. Pole</u> 74.30' 35.84' S.W. to shiner in P.P. 46.80' S.E. to Near cor. sign post 36.21'	
	#142 (19)			
Sta. 259+95.85 Holland-Sylvania Rd. Brass plate		a.k.	S.W. to witness man. 42.37' N.E. to shiner in T.P. 95.55' N.N.W. to shiner in T.P. 56.20' N.W. to witness man. 41.31' S.E. to Cor. B.M. # 223 42.48'	
	#143 (20)			
Sta. 273+95.17	(Did not find)			
	#144 (20)			