

O.D.O.T. DISTRICT 2 SURVEY OFFICE (USE ONLY)

PERSONNEL

REFERENCE NO. 23

SHEET 1 OF 13

NOTES CORDES

DATE 4/24/93

ROUTE SR 2

H.C. KUSZ

WEATHER NICE

COUNTY LUCAS

R.C. OTTO  
BARNHISEL

TEMP. 80°

TOWNSHIP ADAMS

DWG BY NIESE PID \_\_\_\_\_

SECTION 13

T 2 US R E

TYPE MONUMENT 1/2" IPIN

~~ON SURFACE~~ - BELOW 1"

OFFSET  $\odot$  PAVEMENT 10.0' ~~RT~~ : RT

3.5' TO RT EDGE PAVEMENT

STATION: 630+72

HORZ. DATUM: \_\_\_\_\_ GEOID: \_\_\_\_\_

GRID: NORTHING: \_\_\_\_\_ EASTING: \_\_\_\_\_

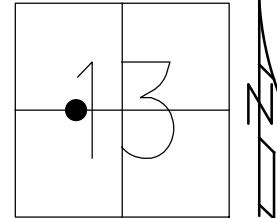

RECORD:  
FD 1/2" IPIN  
1" DOWN  
4/24/93, MB  
SET P.K./WASHER  
8/11/93, MB

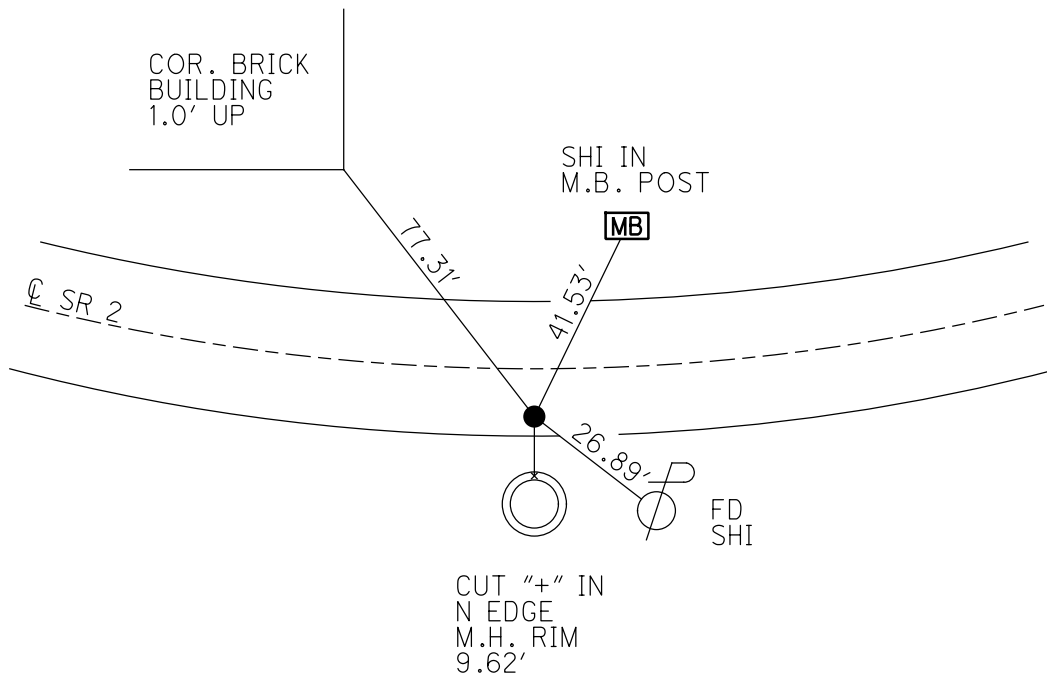

# O.D.O.T. DISTRICT 2 SURVEY OFFICE

PERSONNEL

REFERENCE NO. 23

SHEET 2 OF 7

NOTES CORDES

H.C. KUSE

R.C. OTTO

BARNHISEL

DATE JULY 24, 1993

WEATHER NICE

TEMP. +80°

ROUTE S.R. 2

COUNTY LUCAS

TOWNSHIP ADAMS

SECTION 13

T. 2 S. R.

Set P.K./WASHER  
8-11-93

TYPE MONUMENT 1/2" I-ROD

ON SURFACE - BELOW 1" BELOW

LEFT - C PAV'T. - RIGHT 10' RT. &

3.5 TO RT. EDGE PAVEMENT

S.L.M. 630 + 72

