

O.D.O.T. DISTRICT 2 SURVEY OFFICE (USE ONLY)

PERSONNEL \_\_\_\_\_

REFERENCE NO. 24

SHEET 2 OF 13

NOTES CORDES

DATE 4/24/93

ROUTE SR 2

H.C. KUSZ

WEATHER NICE

COUNTY LUCAS

R.C. OTTO

TEMP. 80°

TOWNSHIP ADAMS

BARNHISEL

SECTION 13

DWG BY NIESE PID \_\_\_\_\_

T 2 US R E

TYPE MONUMENT MONBOX

ON SURFACE - ~~BELOW~~ ON

OFFSET  $\varnothing$  PAVEMENT ON LT : RT

- TO - EDGE PAVEMENT

STATION: 636+33

HORZ.DATUM: \_\_\_\_\_ GEOID: \_\_\_\_\_

GRID: NORTHING: \_\_\_\_\_ EASTING: \_\_\_\_\_

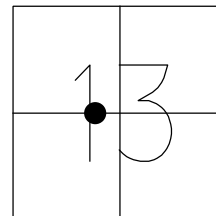

RECORD:  
FD MONBOX  
4/24/93, MB

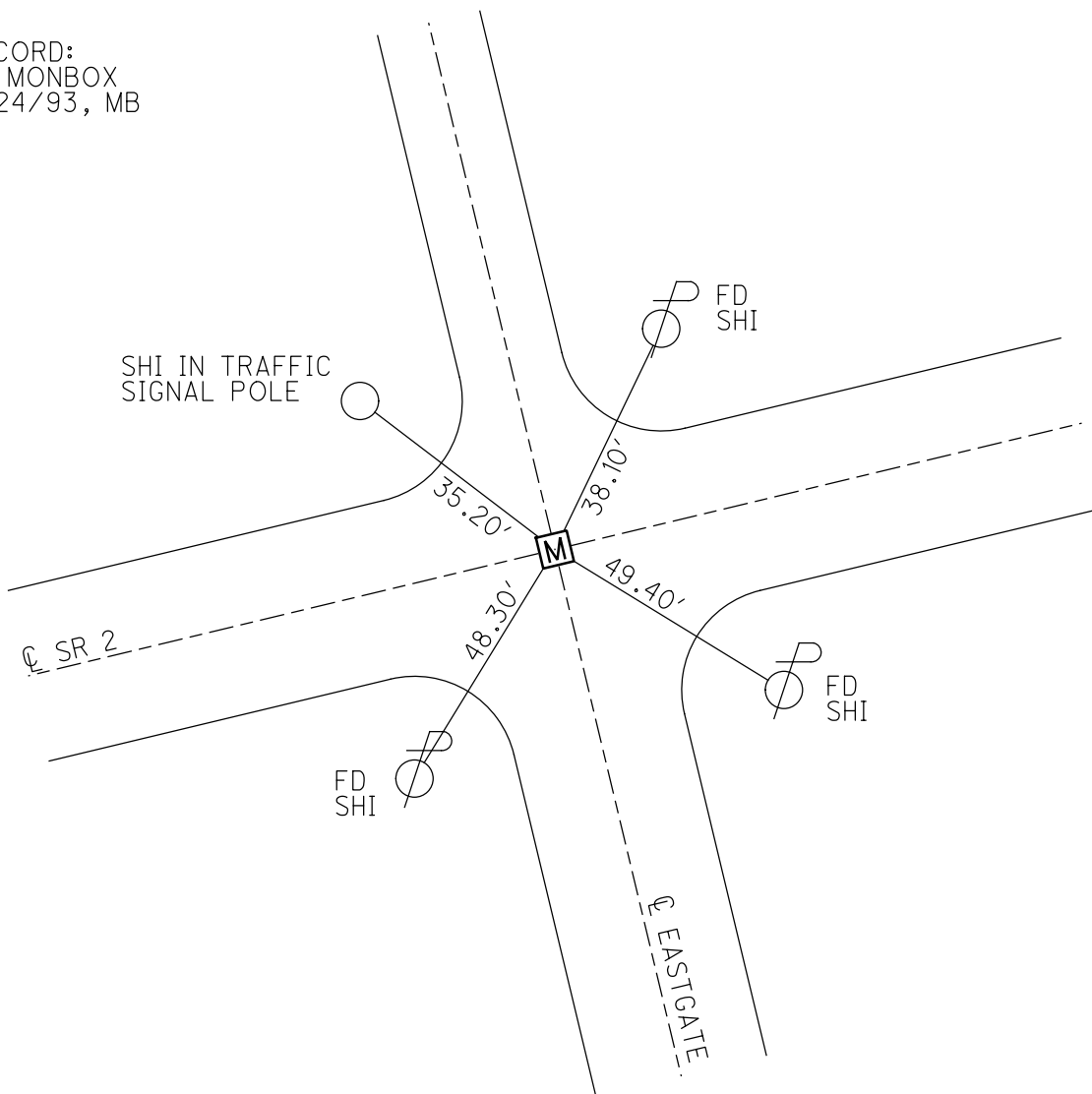

# O.D.O.T. DISTRICT 2 SURVEY OFFICE

PERSONNEL

REFERENCE NO. 24

SHEET 3 OF 7

NOTES CORDES

H.C. KUSE

DATE JULY 24, 1993

ROUTE S. R. 2

R.C. OTTO

WEATHER NICE

COUNTY LUCAS

BARNHISEL

TEMP. +80°

TOWNSHIP ADAMS

SECTION 13

T245R

TYPE MONUMENT Mon. Box

ON SURFACE - BELOW ON SURFACE

LEFT - & PAV'T. - RIGHT & BOTH PAV'T

TO / EDGE PAVEMENT

S.L.M. 636+33

