

O.D.O.T. DISTRICT 2 SURVEY OFFICE (USE ONLY)

PERSONNEL _____ REFERENCE NO. 29 SHEET 13 OF 13
 NOTES CURTIS DATE 5/26/88 ROUTE SR 2
 H.C. HOUSEHOLDER WEATHER MILD COUNTY LUCAS
 R.C. _____ TEMP. 70° TOWNSHIP _____
 DWG BY NIESE PID _____ SECTION 7
 T _ N _ R _ E

TYPE MONUMENT 1" IPIN IN CONCRETE

~~ON SURFACE~~ - BELOW 4"

OFFSET ☉ PAVEMENT ON LT : RT
- TO - EDGE PAVEMENT

STATION: 1081+88

HORZ. DATUM: _____ GEOID: _____

GRID: NORTHING: _____ EASTING: _____

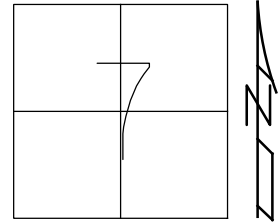

RECORD:
 FD 1" IPIN
 IN CONC.
 4" DOWN
 5/26/88
 SET SM R.R. SPIKE
 7/8/98, IRS

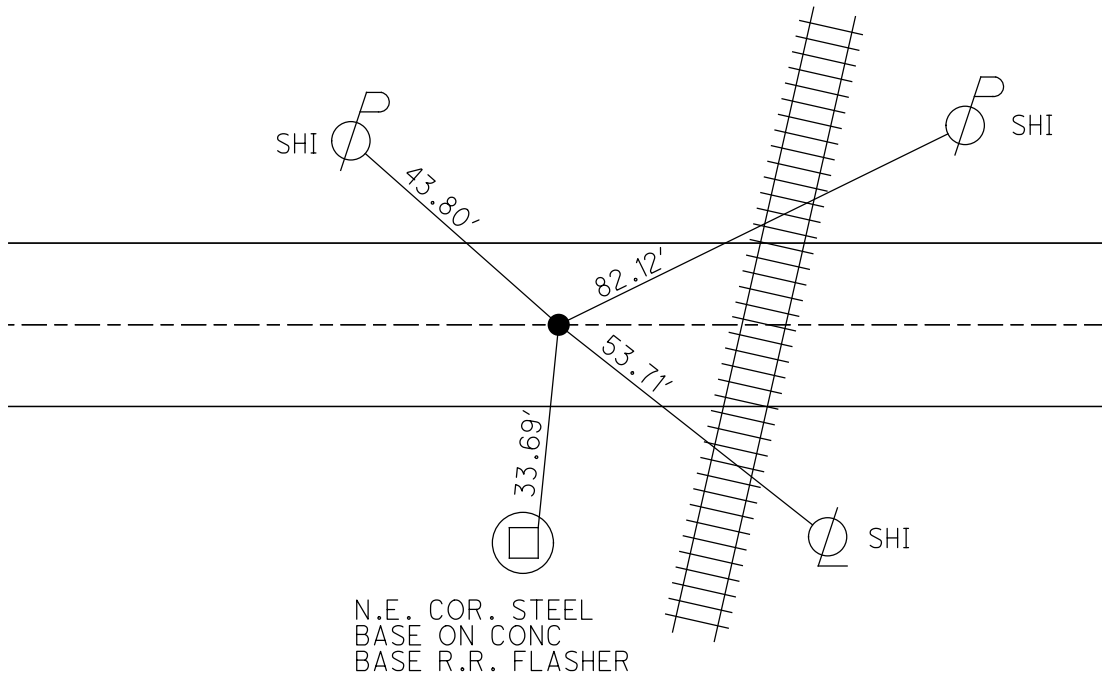

O.D.O.T. DISTRICT 2 SURVEY OFFICE

PERSONNEL _____

REFERENCE NO. 29

SHEET 1 OF 5

NOTES D. CURTIS

H.C. J. HOUSEHOLDER

DATE 5-26-88

ROUTE S.R. #2

R.C. _____

WEATHER MILD

COUNTY LUCAS

TEMP. 70° ±

TOWNSHIP _____

SECTION _____

T _____ R _____

TYPE MONUMENT 1" I. PIN IN CONC.

ON SURFACE - BELOW 4" BELOW SURFACE

LEFT- & PAV'T. - RIGHT & PAV'T

TO _____ EDGE PAVEMENT

S.L.M. 1081 + 88

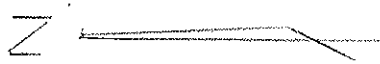
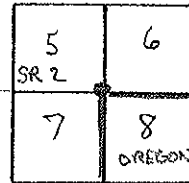

Set small RR spike 7/8/98 WS

