

STATE OF OHIO  
DEPARTMENT OF HIGHWAYS

FED. RD. DIVISION	STATE	PROJECT	
2	OHIO	STATE	

1  
7

DEC 6 1963  
GROUND PHOTOGRAPH

LUC-20-(15.91)(16.41)

LUC-20-(15.91)(16.41)

LUCAS COUNTY  
ADAMS TOWNSHIP  
CITY OF TOLEDO

1959 SPECIFICATIONS

The standard specifications of the State of Ohio, Department of Highways, including changes and supplemental specifications listed in the proposal shall govern this improvement.

The right of way for this improvement will be provided by the State of Ohio.

I hereby approve these plans and declare that the making of this improvement will not require the closing of the highway to traffic and that provisions for the maintenance and safety of traffic will be as set forth on the plans and estimates.

Approved: G. W. DeWitt  
Date 1-4-61 Division Deputy Director

Approved: W. C. Neff  
Date 3-1-61 Deputy Director of Planning and Programming

Approved: \_\_\_\_\_  
Date \_\_\_\_\_ Engineer of Bridges

Approved: W. H. Mason  
Date 2-7-61 Engineer of Location and Design

Approved: C. W. M. Engley  
Date 2-8-61 Deputy Director of Design and Construction

Approved: J. A. Berry  
Date 3-2-61 First Assistant Director

Approved: E. A. Preston  
Date 3-2-61 Director of Highways

CONVENTIONAL SIGNS

- Center Line \_\_\_\_\_
- Political Subdivision \_\_\_\_\_
- Boundary \_\_\_\_\_
- Right of Way \_\_\_\_\_
- Corporation Line \_\_\_\_\_

Begin Work  
Sta. 839+91.95

Suspend Work  
Sta. 847+87.95

Resume Work  
Sta. 866+57.54

End Work  
Sta. 874+53.54

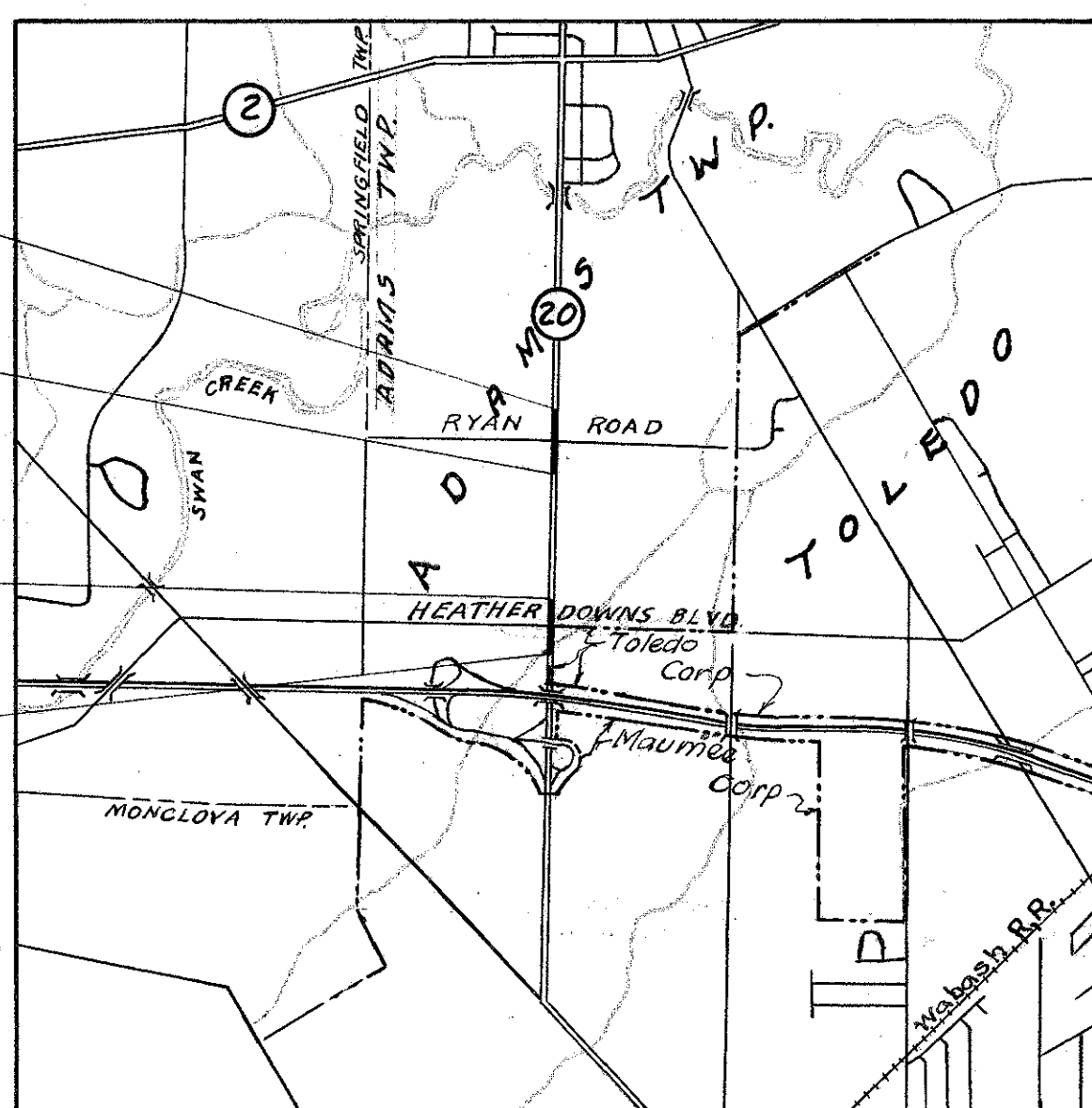

Delivery Point: Maumee Average Haul: 2 mi.

LOCATION PLAN

Scale: 1 in. = 0.5 mi

- Portion to be improved:
- State Highways
- Ohio Turnpike
- Other Roads & Streets

SCALE

- Plan - 1" = 30'
- Profile: Horizontal - 1" = 25'
- Vertical - 1" = 30'
- Vertical - 1" = 5'

INDEX OF SHEETS

- Title Sheet 1
- Typical Sections 2
- General Notes 3
- Sub-summaries 3
- General Summary 3
- Plan and Profile 4,5
- Cross Sections 6,7

LINE DATA

- Begin Work Sta 839+91.95
- Suspend Work Sta 847+87.95
- Resume Work Sta 866+57.54
- End Work Sta 874+53.54

Total Length-Project & Work 1592 Ft. = 0.301 mi.

STANDARD DRAWINGS		DRAWINGS	
I-12, 3, 4 & 5	4-24-58	I-15 No. 4	12-1-54
I-20 B No. 1-2 A & B	1-26-59	I-21-23	8-1-56
I-20 C No. 3-A	1-26-59	2-3	4-1-50
I-20 C No. 6	1-26-59	7-35	1-2-56
I-8, MHA No. 1	1-26-59	I-8 MH No. 1-A	1-26-59
I-12	7-1-54	L-3-A	4-1-50

SUPPLEMENTAL SPECIFICATIONS	
I-112	9-15-56

FILE NO.	LUCAS COUNTY	LUC-20-(15.91)(16.41)
DATE OF LETTING	_____	
CONTRACT NO.	_____	

DEC 6 1963  
GROUND PHOTOGRAPH

FED. RD. DIVISION	STATE	PROJECT
2	OHIO	

LUC 20-(15.91)(16.41)

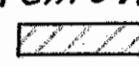
1P- Remove wearing surface from existing pavement areas to be occupied by proposed Traffic Island.  
Remove wearing surface from areas shown thus . Replace to elevations shown. Build new pavement as follows: Traffic Island Sta. 842+41.95 to Sta. 843+41.95; full width pavement between traffic lanes (except that occupied by traffic island) Sta. 842+41.95 to Sta. 843+73.45; tapered section 2' surface width at Sta. 839+91.95 to 10' surface width at Sta. 842+41.95.

N  
SCALE: 1/IN.=30 FT

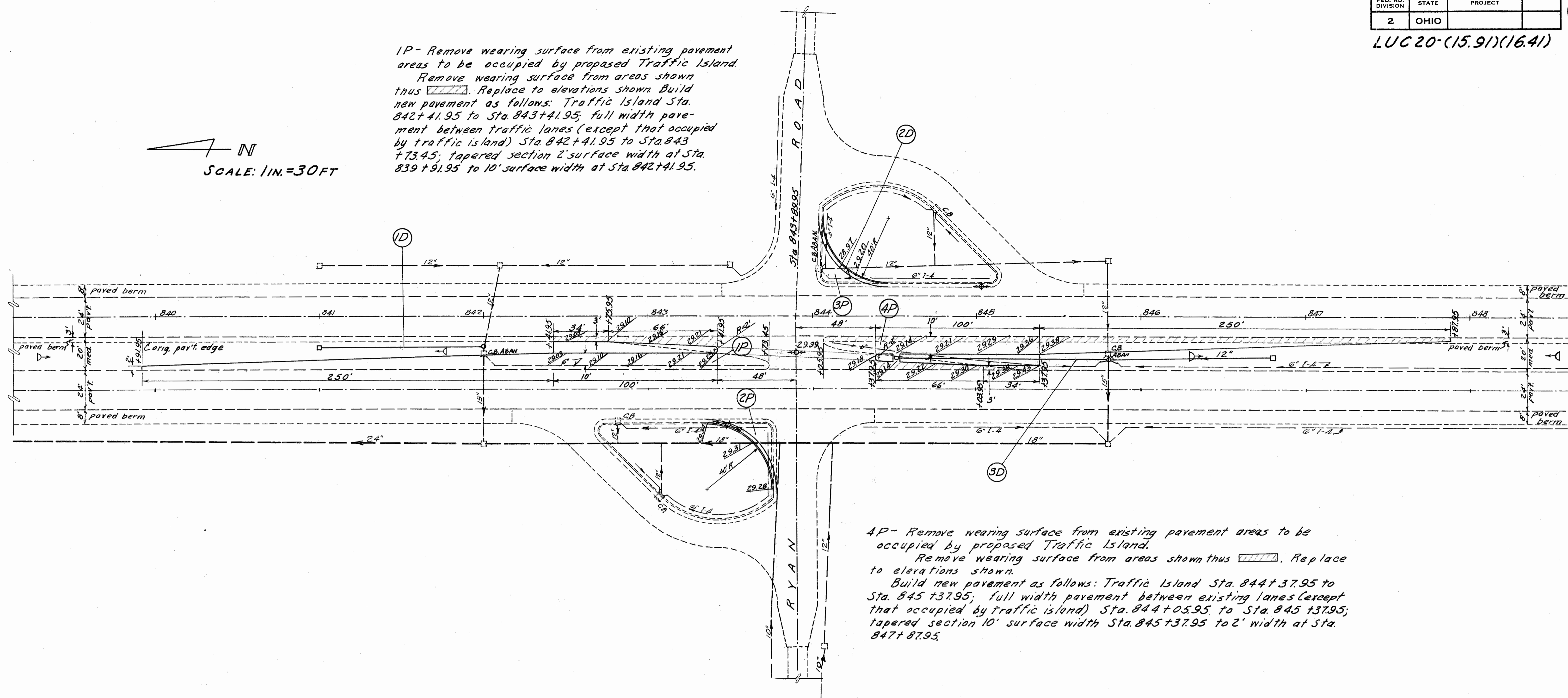

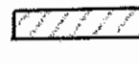
4P- Remove wearing surface from existing pavement areas to be occupied by proposed Traffic Island.  
Remove wearing surface from areas shown thus . Replace to elevations shown.  
Build new pavement as follows: Traffic Island Sta. 844+37.95 to Sta. 845+37.95; full width pavement between existing lanes (except that occupied by traffic island) Sta. 844+05.95 to Sta. 845+37.95; tapered section 10' surface width Sta. 845+37.95 to 2' width at Sta. 847+87.95.

PROFILE SCALE:  
"H": 1/IN.=30 FT  
"V": 1/IN.=5 FT

B.M. 629.46  
"x" base of "Pay Less" gas station sign, NE. cor. Ryan & Reynolds

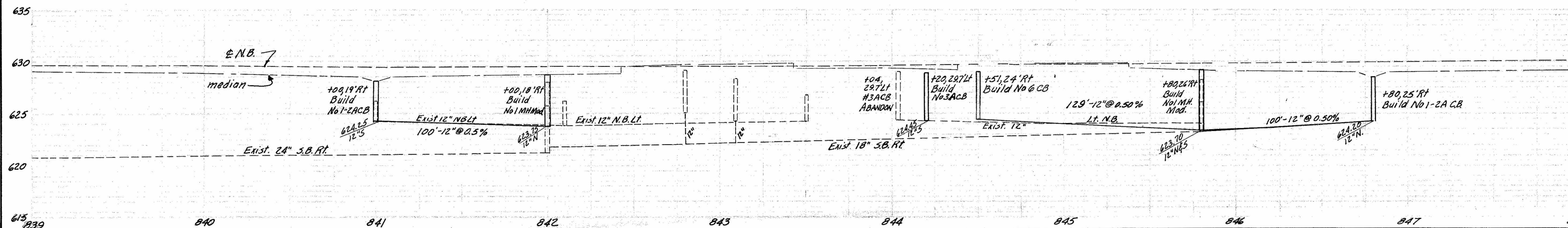

STA 839+00 TO STA 848+00



FED. RD. DIVISION	STATE	PROJECT	
2	OHIO		

5  
7

LUC 20(15.91)(16.41)

N  
SCALE: 1IN.=30 FT

5P- Remove wearing surface from existing pavement areas to be occupied by proposed Traffic Island. Remove wearing surface from areas shown thus . Replace to elevations shown. Build new pavement as follows: Traffic Island Sta. 869+07.54 to Sta. 870+07.54; full width pavement between traffic lanes (except that occupied by traffic island) Sta. 869+07.54 to Sta. 870+39.54; tapered section 2' width at Sta. 866+57.54 to 10' surface width at Sta. 869+07.54.

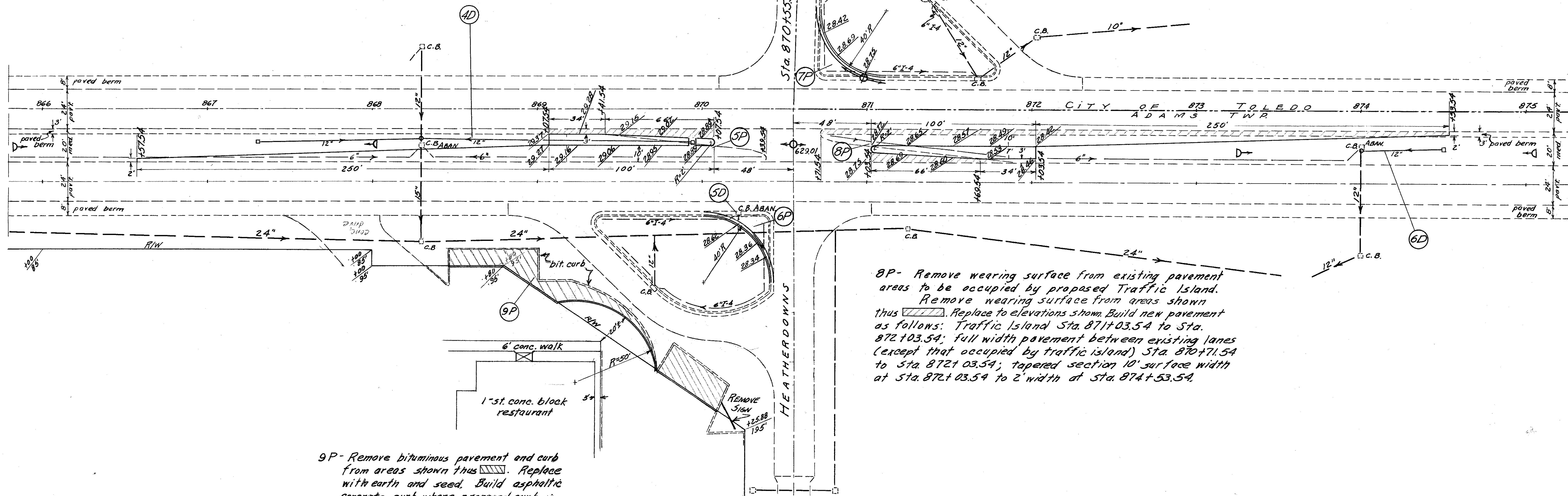

8P- Remove wearing surface from existing pavement areas to be occupied by proposed Traffic Island. Remove wearing surface from areas shown thus . Replace to elevations shown. Build new pavement as follows: Traffic Island Sta. 871+03.54 to Sta. 872+03.54; full width pavement between existing lanes (except that occupied by traffic island) Sta. 870+71.54 to Sta. 872+03.54; tapered section 10' surface width at Sta. 872+03.54 to 2' width at Sta. 874+53.54.

9P- Remove bituminous pavement and curb from areas shown thus . Replace with earth and seed. Build asphaltic concrete curb where proposed curb is shown. For quantities see p.3.

PROFILE SCALE:  
"H": 1IN.=25 FT  
"V": 1IN.=5 FT

B.M. 624.19  
"a" N.E. corner of  
Culvert headwall  
Lt. Sta. 873

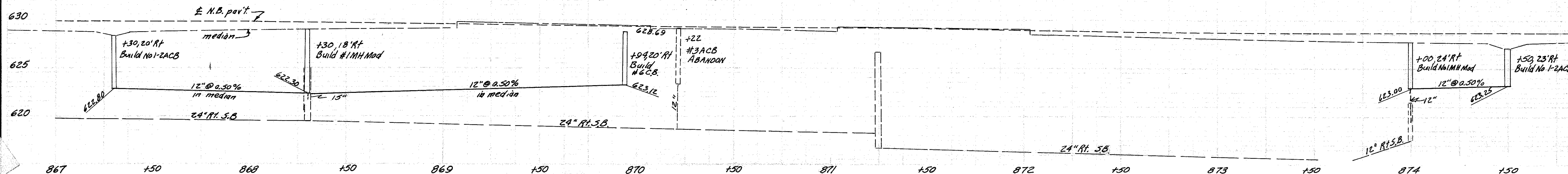

STA 866+00 TO STA 875+00