

O.D.O.T. DISTRICT 2 SURVEY OFFICE (USE ONLY)

PERSONNEL	REFERENCE NO. <u>33</u>	SHEET <u>9</u> OF <u>15</u>
NOTES <u>NUHFER</u>	DATE <u>8/14/07</u>	ROUTE <u>US 20</u>
H.C. <u>HUSS</u>	WEATHER <u>CLOUDY</u>	COUNTY <u>LUCAS</u>
R.C. <u>MOSER</u>	TEMP. <u>70°</u>	TOWNSHIP <u>SYLVANIA</u>
		SECTION <u>21</u>
DWG BY <u>MILLER</u>	PID <u>102808</u>	T <u>9</u> N R <u>6</u> E
TYPE MONUMENT <u>MONBOX W/3/4" IPIN</u>		
ON SURFACE - <del>BELOW</del> <u>ON</u>		
OFFSET <u>Q</u> PAVEMENT <u>17.5'</u> LT : <del>RT</del>		
<u>22.1'</u> TO <u>LT</u> EDGE PAVEMENT		
STATION: <u>460+78</u>		
HORZ. DATUM: <u>NAD83(2011)</u>		GEOID: <u>2012A</u>
GRID: NORTHING: <u>733666.708</u>		EASTING: <u>1637837.078</u>

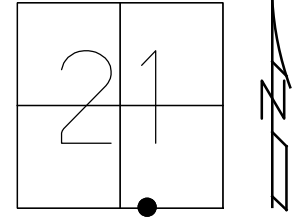

RECORD:  
 FD MONBOX  
 W/ 1" IPIN  
 7-08-98, CAL  
 FD MONBOX  
 W/3/4" IPIN  
 8-14-07, RGN  
 FD MONBOX  
 W/5/8" W-DIMPLE  
 REF33  
 4-24-18, JFO  
 RAISED BOX  
 10-1-18, JFO

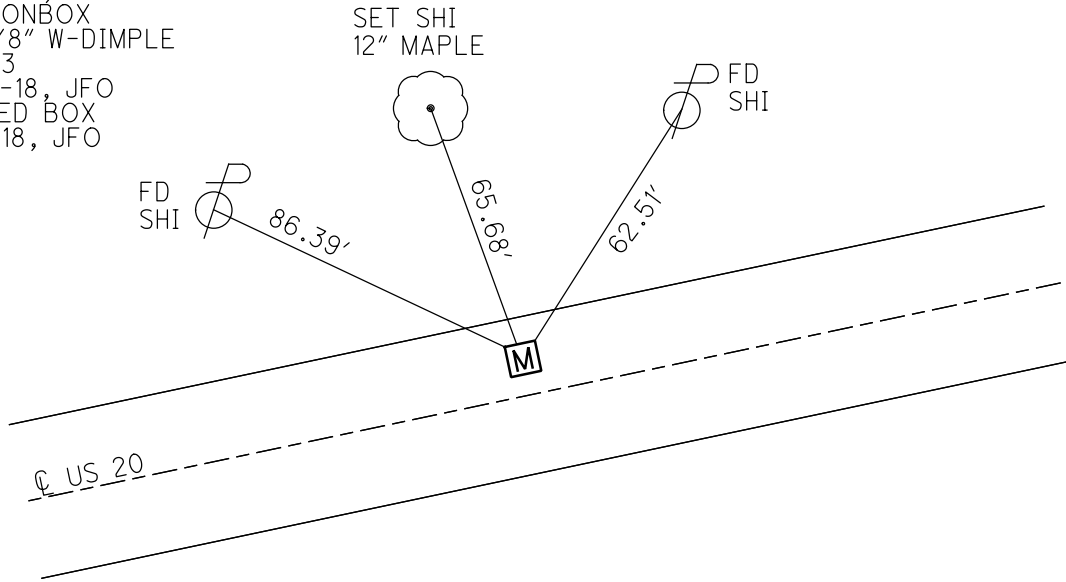

O.D.O.T. DISTRICT 2 SURVEY OFFICE (USE ONLY)

PERSONNEL \_\_\_\_\_ REFERENCE NO. 33 SHEET 9 OF 11  
 NOTES NUHFER DATE 8/14/07 ROUTE US 20  
 H.C. HUSS WEATHER CLOUDY COUNTY LUCAS  
 R.C. MOSER TEMP. 70° TOWNSHIP SYLVANIA  
 \_\_\_\_\_ SECTION 21  
 \_\_\_\_\_ T 9 S R 6 E

TYPE MONUMENT 1" IPIN MON. BOX  
 ON SURFACE - BELOW ON  
 LEFT - ☉ PAV'T - RIGHT 17.5'  
22.1' TO LT EDGE PAVEMENT  
 S.L.M. 460+78

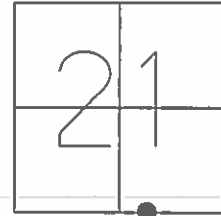

GRID: NORTHING: 733666.63 EASTING: 1637837.02

RECORD:  
 FD 1" IPIN MON. BOX  
 7/08/98, CAL

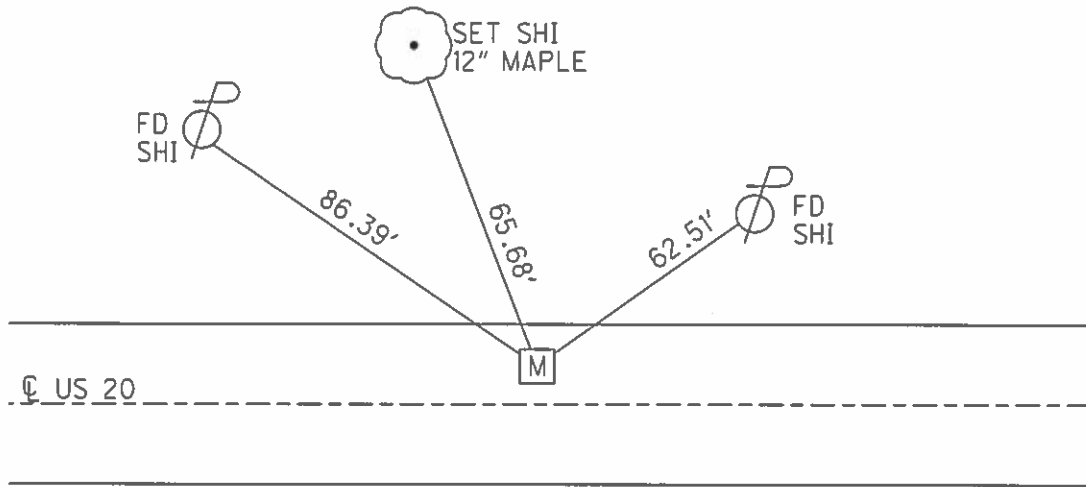

O.D.O.T. DISTRICT 2 SURVEY OFFICE (USE ONLY)

PERSONNEL \_\_\_\_\_

REFERENCE NO. 33

SHEET 9 OF 11

NOTES NUHFER

DATE 08-14-07

ROUTE SR 20

H.C. HUSS

WEATHER CLOUDY

COUNTY LUCAS

R.C. MOSER

TEMP. +70°

TOWNSHIP SYLVANIA

SECTION 21

T 9 S R 6 E

TYPE MONUMENT 1" I.P. MON. BOX

ON SURFACE - ~~BELOW~~ ON SURFACE

LEFT - C PAV'T - RIGHT 17.5' LT.

22.1' TO LT. EDGE PAVEMENT

S.L.M. 460+78

GPS Northing=733666.63 Easting=1637837.02

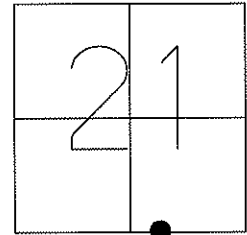

FD. 1" I.P. MON. BOX  
07-08-98 CAL

