

**O.D.O.T. DISTRICT 2 SURVEY OFFICE (USE ONLY)**

PERSONNEL	REFERENCE NO. <u>34 B</u>	SHEET <u>13</u> OF <u>15</u>
NOTES <u>LOEHRKE</u>	DATE <u>7/8/98</u>	ROUTE <u>US 20</u>
H.C. <u>CANTERBURY</u>	WEATHER <u>DAMP</u>	COUNTY <u>LUCAS</u>
R.C. <u>HELM</u>	TEMP. <u>78°</u>	TOWNSHIP <u>SYLVANIA</u>
		SECTION <u>21</u>
DWG BY <u>MILLER</u>	PID <u>102808</u>	T <u>9</u> N R <u>6</u> E
TYPE MONUMENT <u>MONBOX</u>		
<del>ON SURFACE</del> - <del>BELOW</del> <u>ON</u>		
OFFSET <u>18'</u> <del>LT</del> : <del>RT</del>		
<u>12.7</u> TO <u>LT</u> EDGE PAVEMENT		
STATION: <u>473+00</u>		
HORIZ. DATUM: <u>NAD83(2011)</u>	GEOID: <u>2012A</u>	
GRID: NORTHING: <u>733917.136</u>	EASTING: <u>1639033.135</u>	

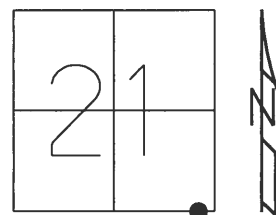

RECORD:  
 FD MONBOX  
 7-8-98, CL  
 FD MONBOX  
 W/1" IPIN  
 REFB34  
 4-24-18, JFO  
 10-1-18, JFO

PNC BANK

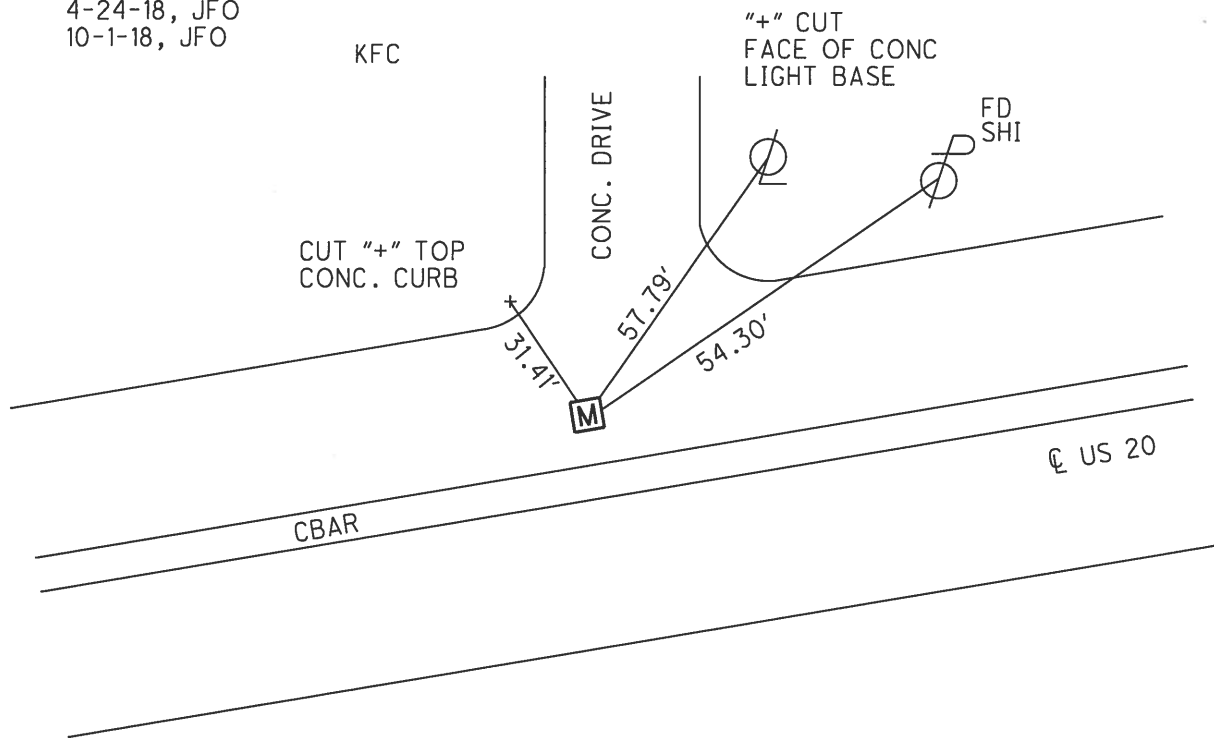

O.D.O.T. DISTRICT 2 SURVEY OFFICE

PERSONNEL

REFERENCE NO. 34B

SHEET 21 OF 27

NOTES LOEHRKE

H.C. CANTERBURY

R.C. Helm

DATE 7-8-98

WEATHER DAMP

TEMP. +78

ROUTE US 20

COUNTY LUCAS

TOWNSHIP SYLVANIA

SECTION 21

T     R    

TYPE MONUMENT Mon Box

ON SURFACE - ~~BELOW~~ Yes

LEFT- & PAV'T. - ~~RIGHT~~ +18' Lt

12.7 TO Lt EDGE PAVEMENT

S.L.M. 473 +00 ± 800' West of McCord Rd.

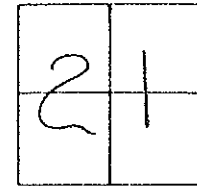

Sterling  
Store

