

O.D.O.T. DISTRICT 2 SURVEY OFFICE (USE ONLY)

PERSONNEL

REFERENCE NO. 34 C

SHEET 14 OF 15

NOTES LOEHRKE

DATE 7/8/96

ROUTE US 20

H.C. CANTERBURY

WEATHER DAMP

COUNTY LUCAS

R.C. HELM

TEMP. 80

TOWNSHIP SYLVANIA

SECTION 21

DWG BY MILLER PID 102808

T 9 N R 6 E

TYPE MONUMENT MONBOX

ON SURFACE - ~~BELOW~~ ON

OFFSET \varnothing PAVEMENT 17.5' LT : ~~RT~~

11.8' TO LT EDGE PAVEMENT

STATION: 477+47

HORZ. DATUM: NAD83(2011)

GEOID: 2012A

GRID: NORTHING: 734008.643

EASTING: 1639470.500

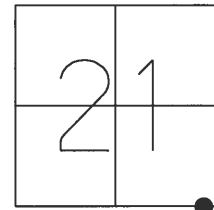

RECORD:
FD MONBOX
7-8-96, CL
FD MONBOX
W/1" IPIN
REFC34
4-24-18, JFO
10-1-18, JFO

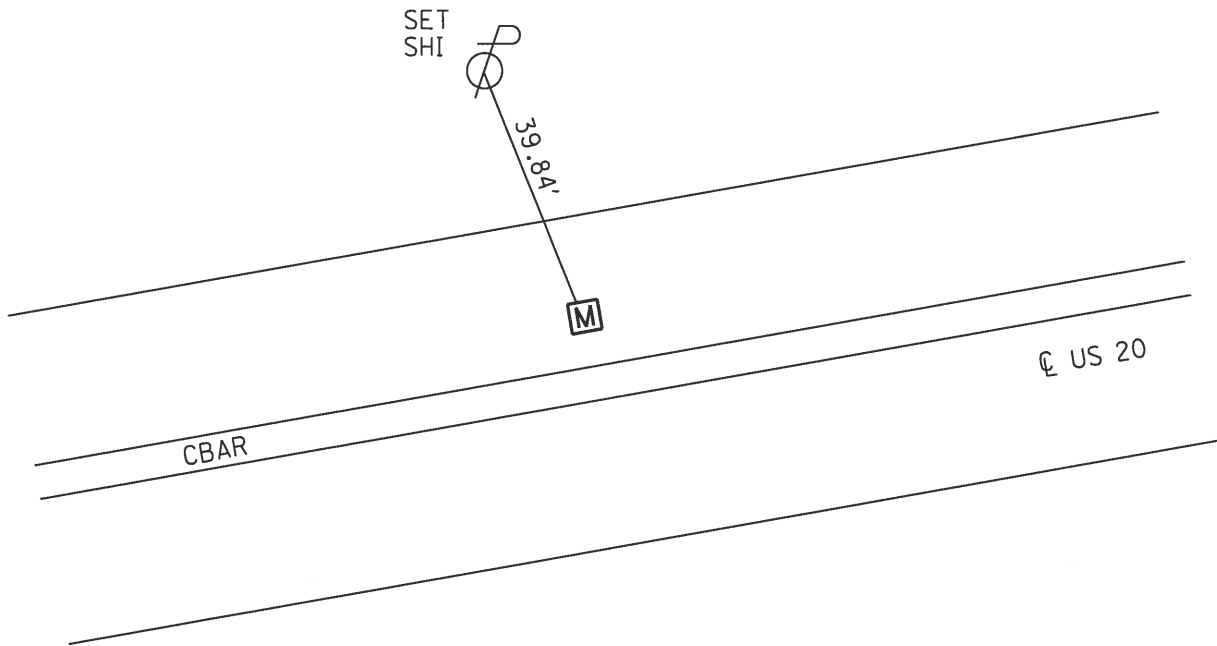

O.D.O.T. DISTRICT 2 SURVEY OFFICE

PERSONNEL _____

REFERENCE NO. 84C

SHEET 20 OF 27

NOTES LOEHRKE

H.C. CANTERBURY

DATE 7-8-96

ROUTE U.S. 20

R.C. HELM

WEATHER DAMP

COUNTY Lucas

TEMP. +80

TOWNSHIP Sylvania

SECTION 21

T____R____

TYPE MONUMENT Mon Box

ON SURFACE - ~~BELOW~~ Yes

LEFT - ~~Q~~ PAV'T. - ~~RIGHT~~ ± 17.5' Lt

11.8 ft TO 4 EDGE PAVEMENT

S.L.M. 477+47 Just West of 9 mile Post

