

O.D.O.T. DISTRICT 2 SURVEY OFFICE (USE ONLY)

PERSONNEL _____ REFERENCE NO. 40 SHEET 20 OF 20
 NOTES LOEHRKE DATE 1/8/98 ROUTE US 20
 H.C. CANTERBURY WEATHER HUMID COUNTY LUCAS
 R.C. HELM TEMP. 82° TOWNSHIP SYLVANIA
 SECTION 22
 DWG BY NIESE PID _____ T 9 S R 6 E

TYPE MONUMENT P.K. NAIL
 ON SURFACE - ~~BELOW~~ ON
 OFFSET CL PAVEMENT ON LT : RT
29.5' TO RT ~~EDGE PAVEMENT~~ CURB
 STATION: 530+45

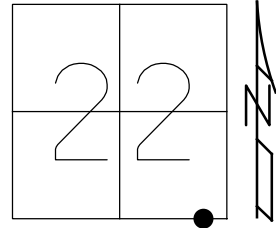

HORZ. DATUM: _____ GEOID: _____
 GRID: NORTHING: _____ EASTING: _____

RECORD:
 FD P.K. NAIL
 ORIGIN UNKNOWN
 1/8/98, CL

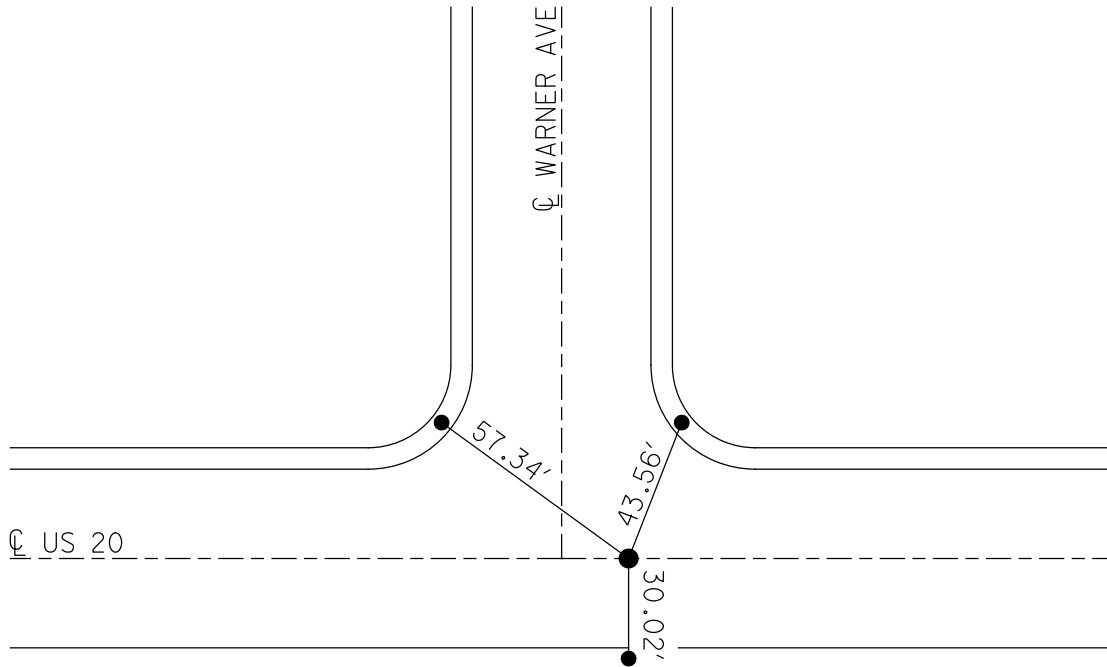

DRILL HOLES
 TOP CONC CURB

PERSONNEL	TITLE	PERSONNEL	TITLE	COUNTY	Lucas	DATE	June 15, 1971
W. Denna				S. R.	20	WEATHER	Sunny-mild
D. Curtis				SEC.		TEMP.	75° ±
R. Branham							
D. Stevens							

DESCRIPTION References To Control Points JOB NO. _____

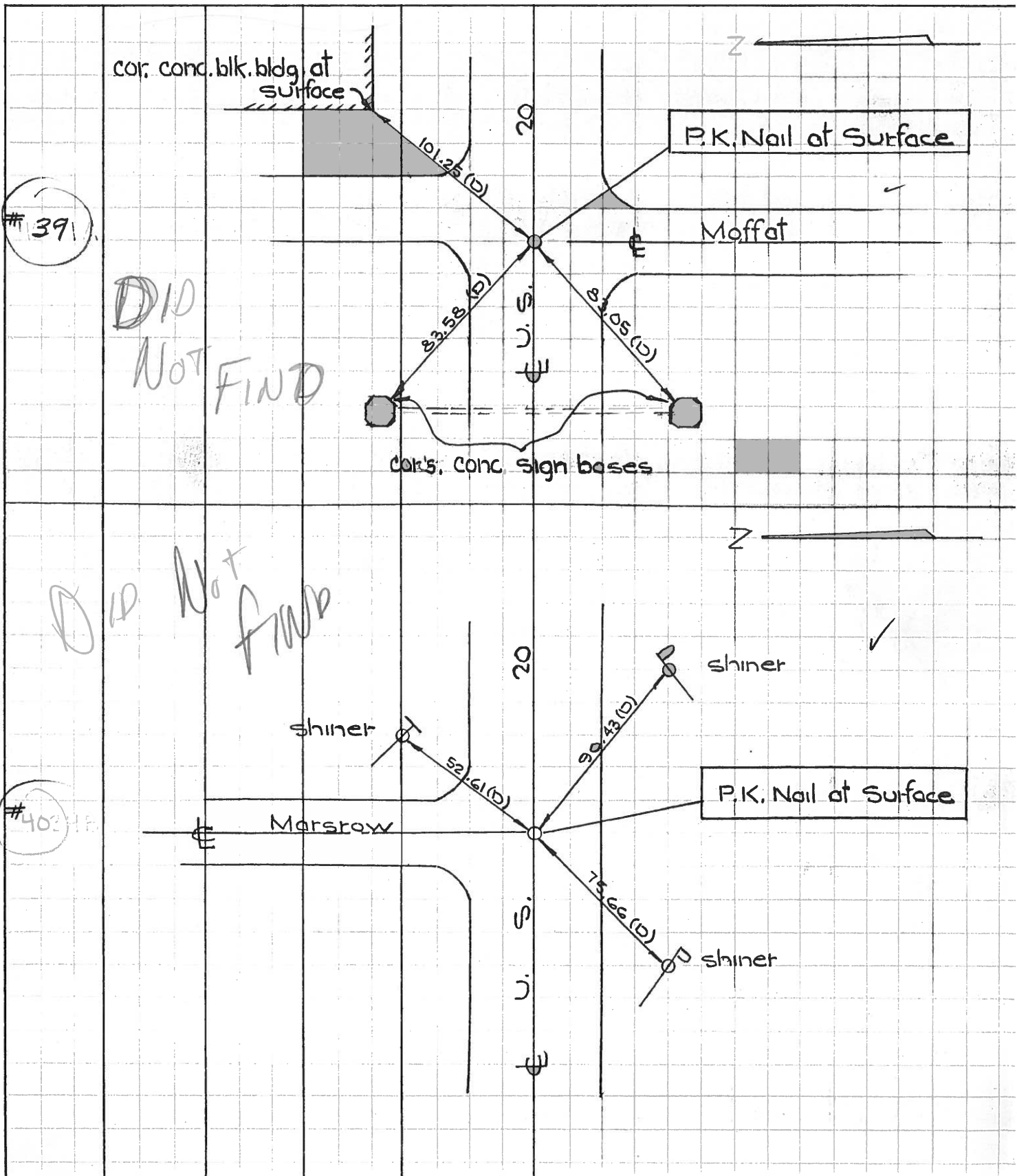

PERSONNEL TITLE PERSONNEL TITLE COUNTY Lucas DATE June 15, 1971
 W. Denna _____
 D. Curtis _____
 R. Brannan _____
 D. Stevens _____
 S. R. 20 WEATHER Sunny-mild
 SEC. _____ TEMP. 75° ±

DESCRIPTION References To Control Points LEFT CENTER LINE RIGHT JOB NO. _____

39

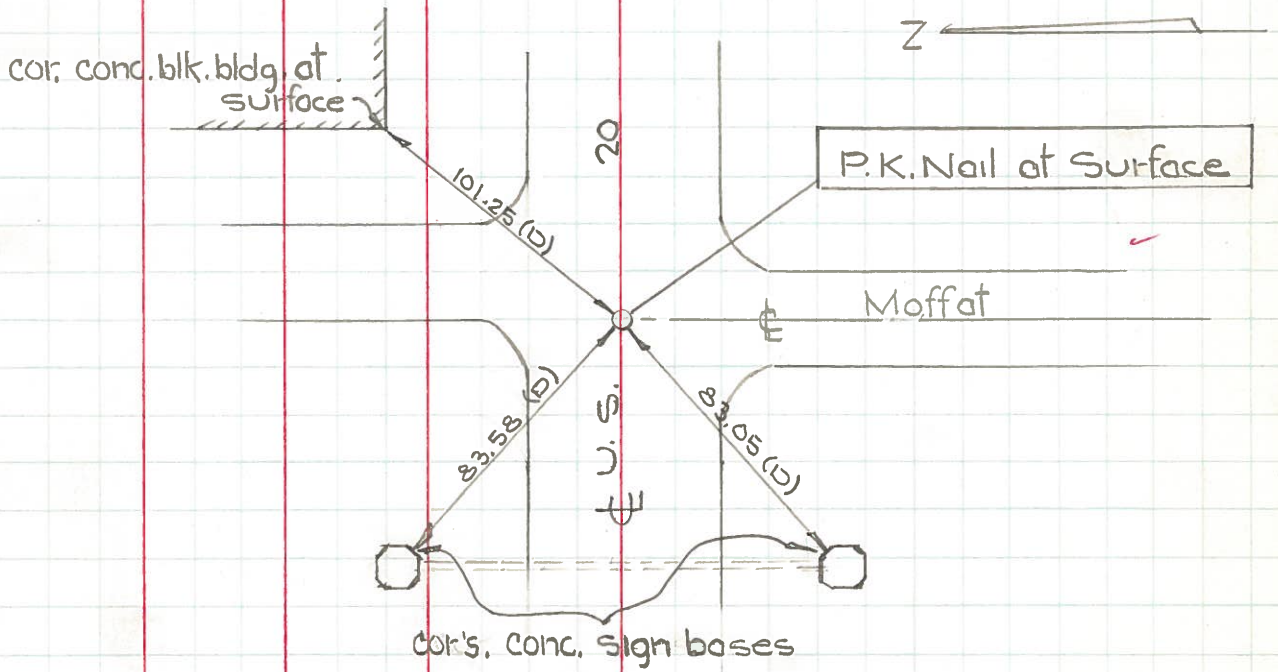

40

