

O.D.O.T. DISTRICT 2 SURVEY OFFICE (USE ONLY)

PERSONNEL _____

REFERENCE NO. 74

SHEET 28 OF 55

NOTES CURTIS

DATE 8/12/71

ROUTE US 20

H.C. STEVENS

WEATHER SUNNY

COUNTY LUCAS

R.C. BRANNAN

TEMP. 75°

TOWNSHIP 12 MILE RESERVE

SECTION 13

DWG BY NIESE PID _____

T 2 US R E

TYPE MONUMENT R.R. SPIKE

ON SURFACE - ~~BELOW~~ ON

OFFSET ☐ PAVEMENT ON LT : RT

- TO - EDGE PAVEMENT

STATION: 782+14

HORZ. DATUM: _____

GEOID: _____

GRID: NORTHING: _____

EASTING: _____

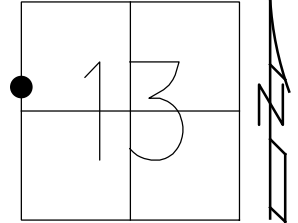

RECORD:
FD R.R. SPIKE
8/12/71, DC

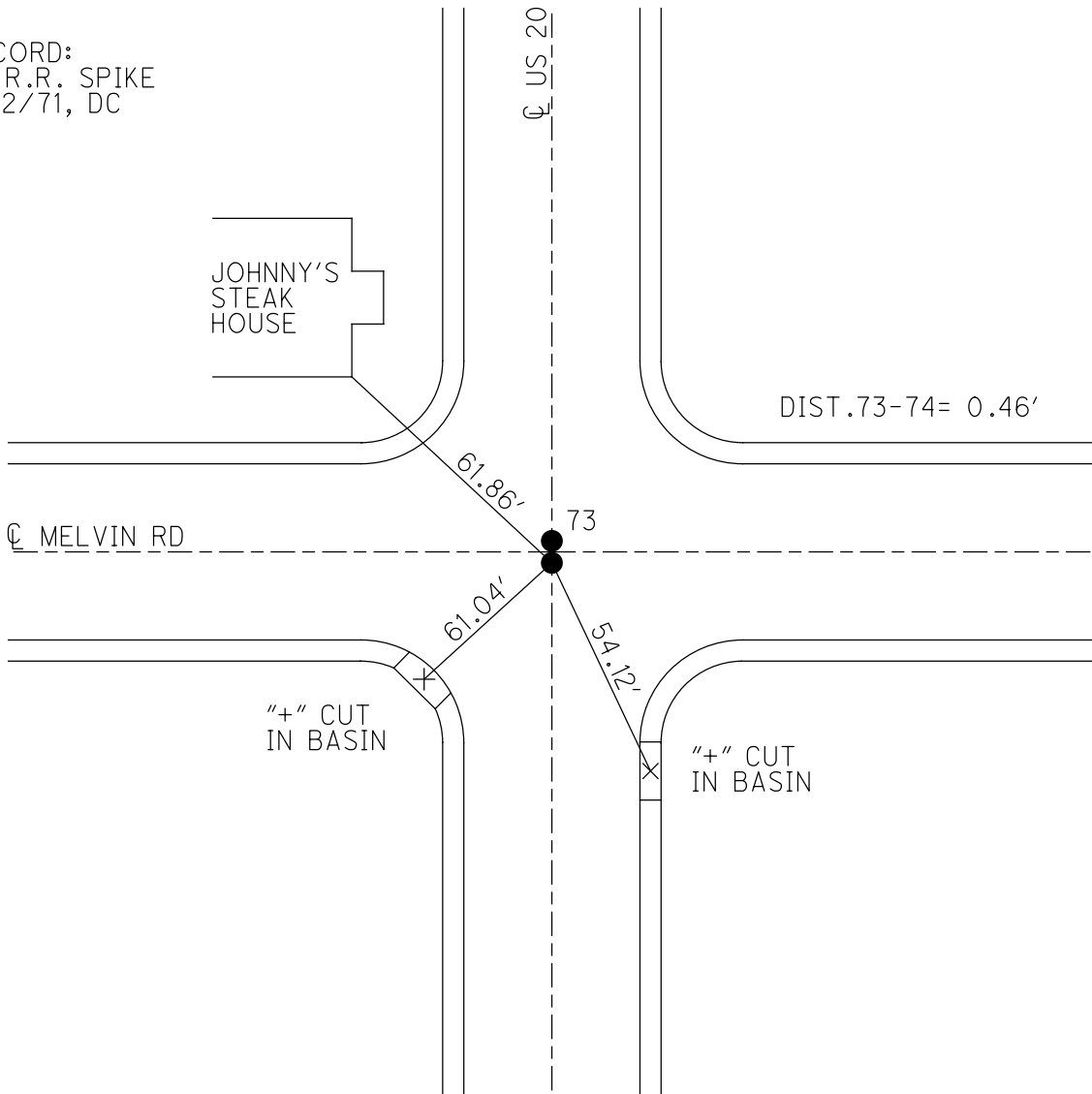

PERSONNEL	TITLE	PERSONNEL	TITLE
D. CURTIS			
D. STEVENS			
R. BRANNAN			

COUNTY LUCAS DATE AUGUST 12, 1971
 S. R. U.S. 20 WEATHER SUNNY
 SEC. _____ TEMP. 75°±

DESCRIPTION REFERENCES TO CONTROL POINTS JOB NO. _____
 LEFT CENTER LINE RIGHT

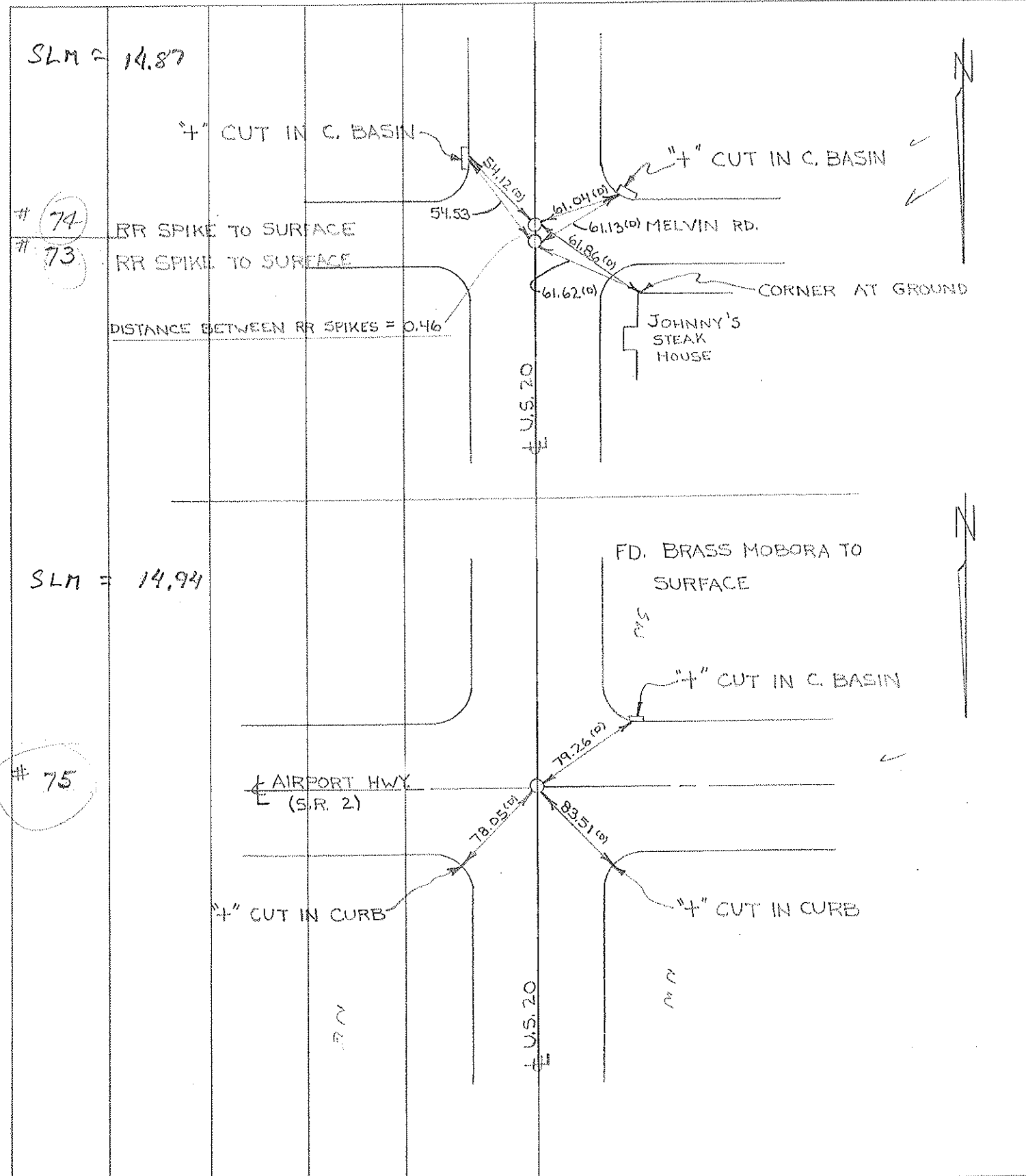

SLM = 14.87

74
73

RR SPIKE TO SURFACE
RR SPIKE TO SURFACE

DISTANCE BETWEEN RR SPIKES = 0.46

U.S. 20

JOHNNY'S STEAK HOUSE

CORNER AT GROUND

FD. BRASS MOBORA TO SURFACE

SLM = 14.94

75

AIRPORT HWY
(S.R. 2)

U.S. 20

"4" CUT IN CURB

"4" CUT IN CURB

"4" CUT IN C. BASIN

"4" CUT IN C. BASIN

"4" CUT IN C. BASIN

54.12 (el)

54.53

61.04 (el)

61.13 (el)

61.86 (el)

61.62 (el)

79.26 (el)

78.05 (el)

83.51 (el)

PERSONNEL TITLE PERSONNEL TITLE
 D. Curtis _____
 J. Teal _____
 J. Brindley _____

COUNTY Lucas DATE May 23, 1966
 S. R. 20 WEATHER mild
 SEC. _____ TEMP. 50°±

DESCRIPTION U.S. 20 (Reynolds Rd) - Ref. Mon. & Control Points JOB NO. 02994 (0)

