

O.D.O.T. DISTRICT 2 SURVEY OFFICE (USE ONLY)

PERSONNEL _____

REFERENCE NO. 78

SHEET 32 OF 55

NOTES CURTIS DATE 8/12/71

H.C. STEVENS WEATHER SUNNY

R.C. BRANNAN TEMP. 75°

ROUTE US 20

COUNTY LUCAS

TOWNSHIP 12 MILE RESERVE

SECTION 24

DWG BY NIESE PID _____

T 2 US R E

TYPE MONUMENT R.R. SPIKE

ON SURFACE - ~~BELOW~~ ON

OFFSET ☉ PAVEMENT ON LT : RT

- TO - EDGE PAVEMENT

STATION: 832+13

HORZ.DATUM: _____ GEOID: _____

GRID: NORTHING: _____ EASTING: _____

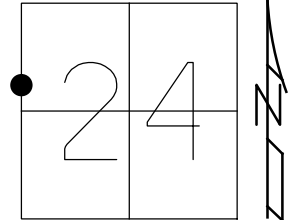

RECORD:
FD R.R. SPIKE
8/12/71, DC

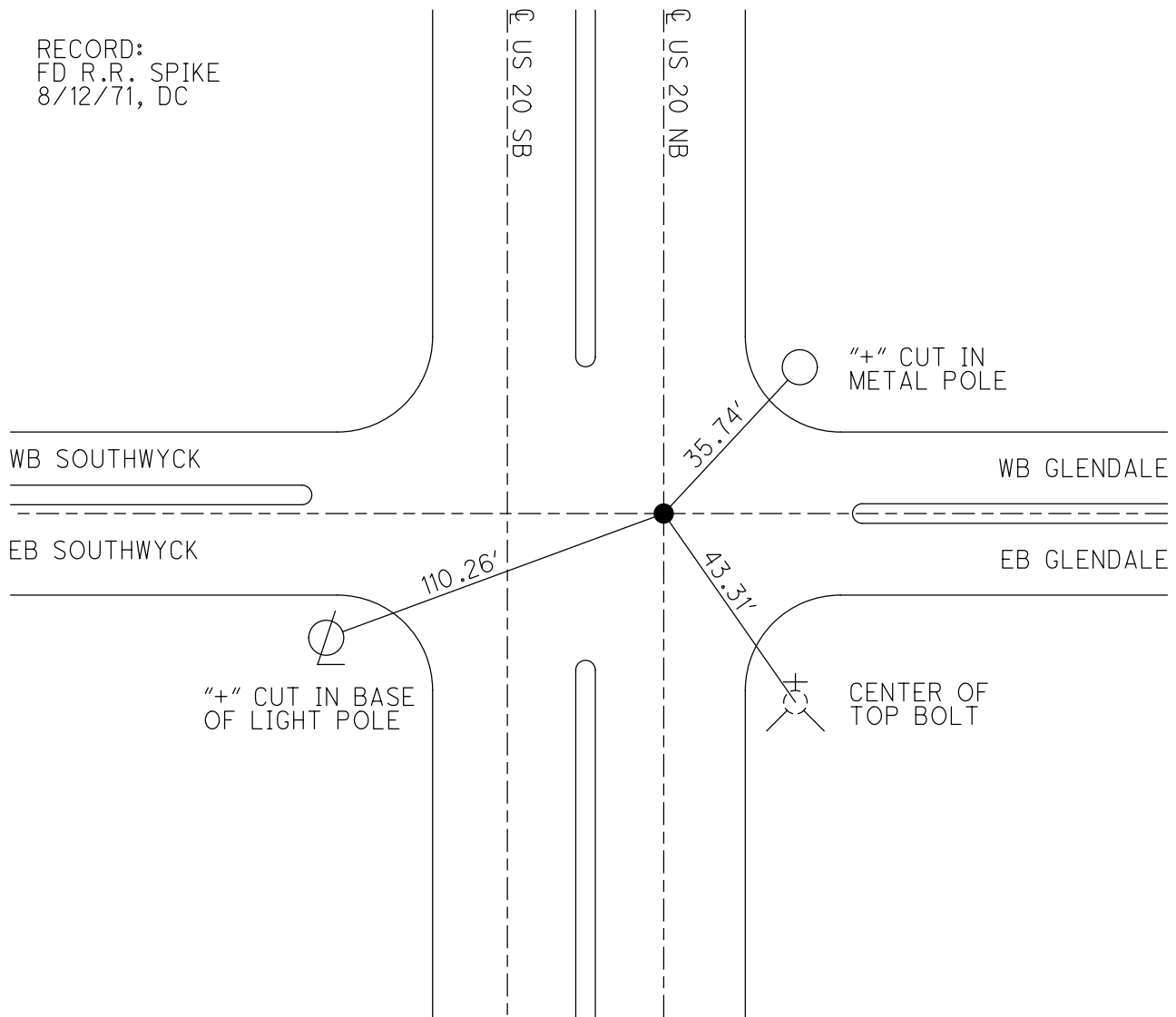

PERSONNEL TITLE PERSONNEL TITLE

D. CURTIS _____

COUNTY LUCAS

DATE AUGUST 12, 1971

D. STEVENS _____

S. R. U.S. 20

WEATHER SUNNY

R. BRANNAN _____

SEC. _____

TEMP. 75°±

DESCRIPTION

LEFT

CENTER LINE

RIGHT

JOB NO. _____

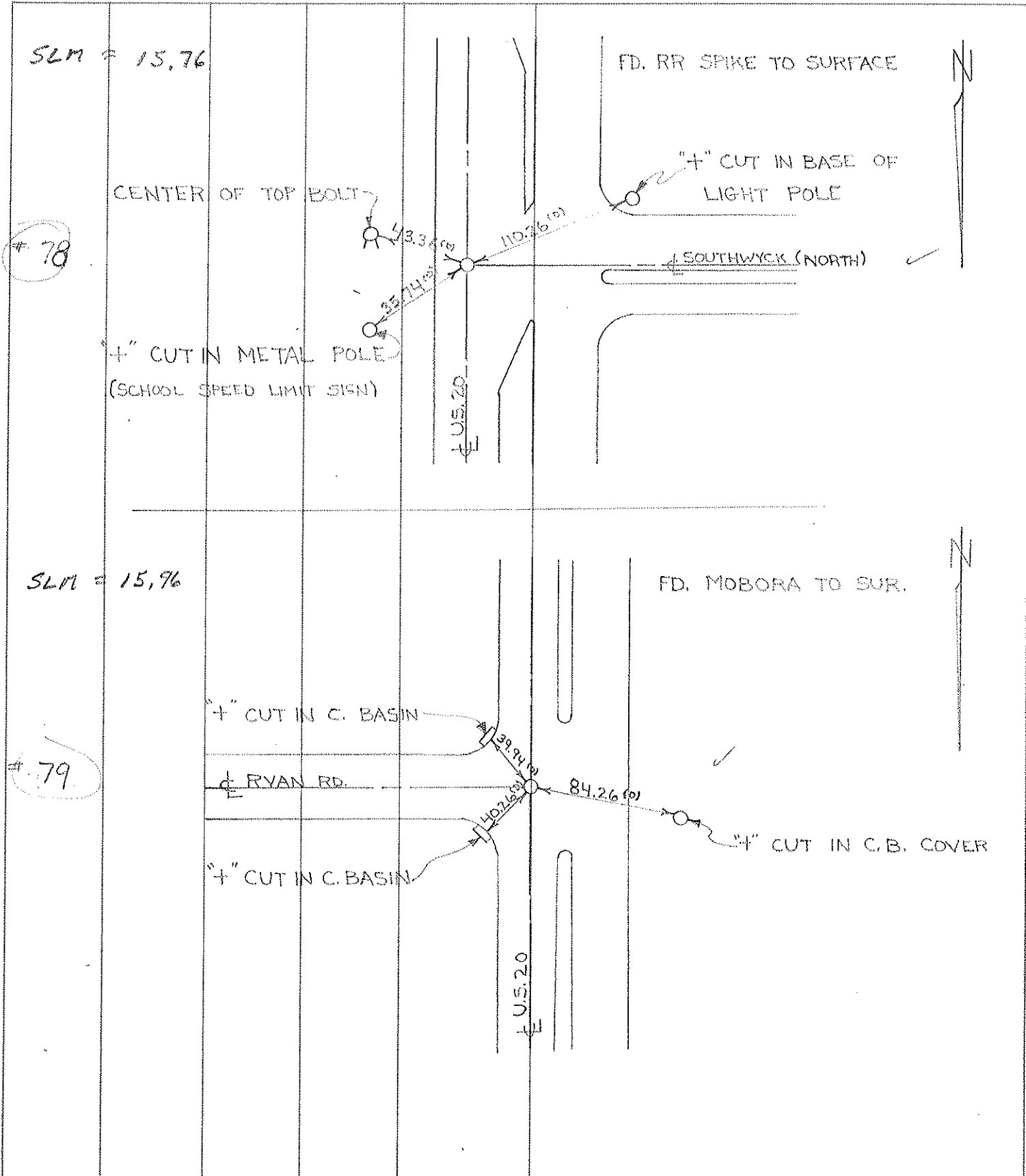

Personnel

Title

Date 8-1-55
(monit)

County

Sheet No. 2/3

Weather

S. R. No.

Section

Job No. 02103

Δ @ 817+15.35
Δ = 0°-28' Lt
Brass plate

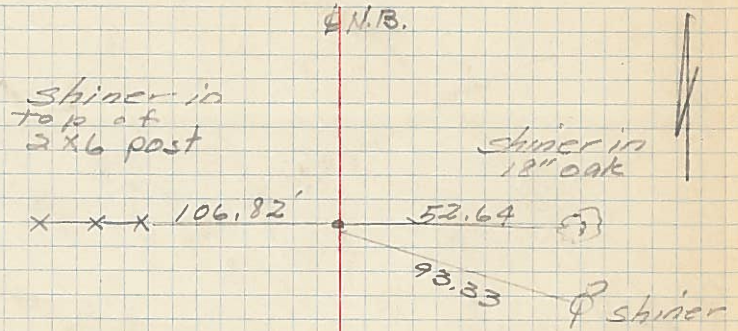

P.I. - N.B. and Ryan Rd.
(E. Sun)

843+89.95
Δ = 0°-17' Rt.

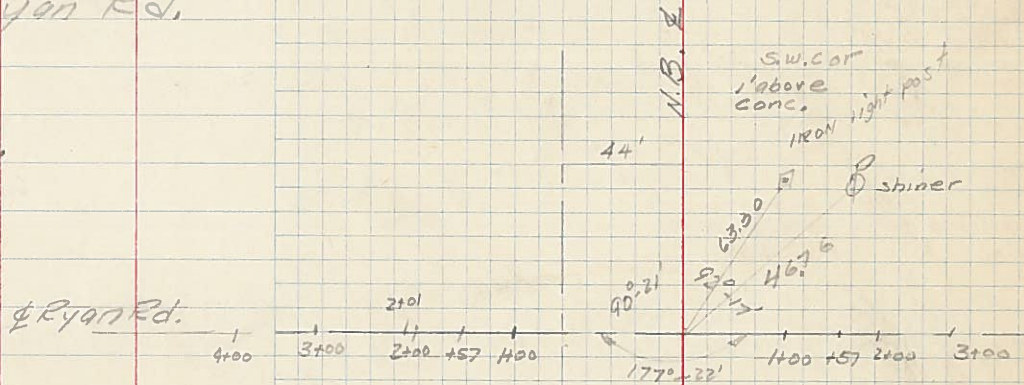

P.I. @ Survey and Heather downs

870+55.54
Δ = 0°-20' Rt.
Brass Plate

