

O.D.O.T. DISTRICT 2 SURVEY OFFICE (USE ONLY)

PERSONNEL

REFERENCE NO. 85

SHEET 39 OF 55

NOTES HUSS

DATE 7/24/97

ROUTE US 20

H.C. LOEHRKE

WEATHER CLOUDY/HUMID

COUNTY LUCAS

R.C. HUSS

TEMP. 74°

TOWNSHIP 12 MILE RESERVE

COX

SECTION 36

DWG BY NIESE PID _____

T 2 US R E

TYPE MONUMENT MONBOX

ON SURFACE - ~~BELOW~~ ON

OFFSET ☉ PAVEMENT ON LT : RT

27.00' TO LT ~~EDGE PAVEMENT~~ FACE OF CURB

STATION: 932+23

HORIZ.DATUM: _____ GEOID: _____

GRID: NORTHING: _____ EASTING: _____

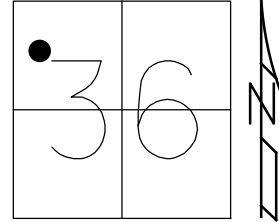

RECORD:
S.L.M. 28+414.5
FD MONBOX
7/24/97, CL

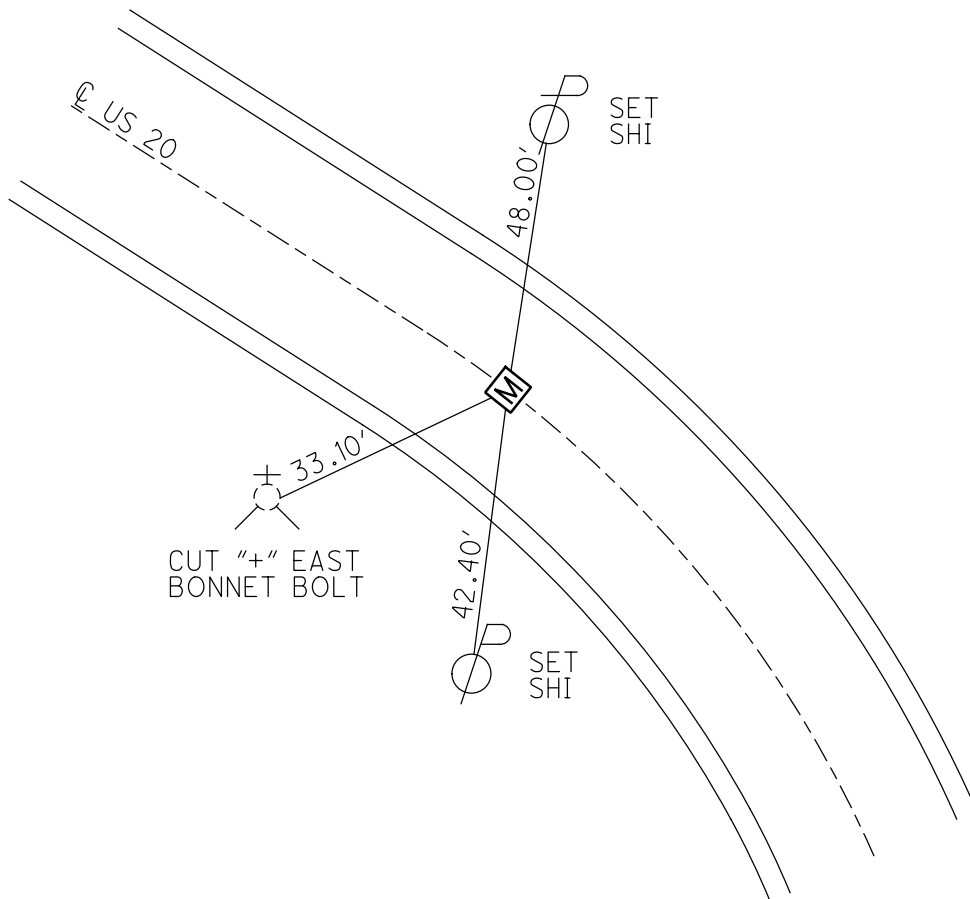

O.D.O.T. DISTRICT 2 SURVEY OFFICE

PERSONNEL

REFERENCE NO. 85

SHEET 2 OF

NOTES Huss

H.C. Lochler

DATE 7-24-97

ROUTE U.S. 20

R.C. Huss

WEATHER Cldy - humid

COUNTY LUCAS

#1 Cox

TEMP. +74°F

TOWNSHIP City of MAUMEE

SECTION

T R

TYPE MONUMENT Mon Box

ON SURFACE - ~~BELOW~~ yes

LEFT - ~~CL~~ PAV'T. - RIGHT yes

27.0 TO Lt. EDGE PAVEMENT Face of Curb

S.L.M. 20 +414.5'

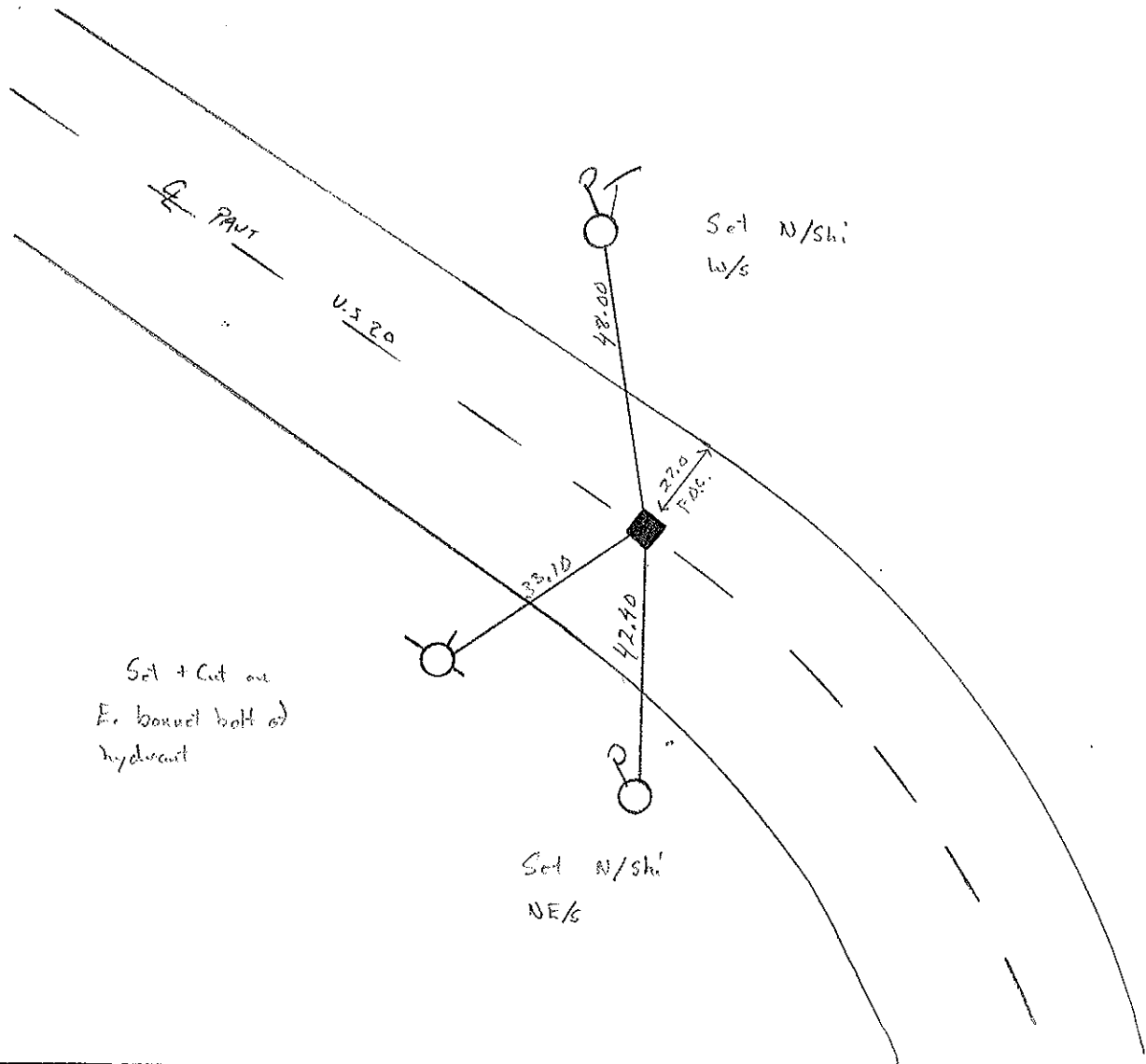
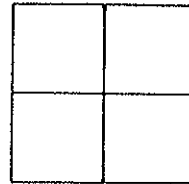

PERSONNEL	TITLE	PERSONNEL	TITLE	COUNTY	DATE	S. R.	WEATHER	TEMP.
D. CURTIS				LUCAS	13 AUG 71	U.S. 20	SUNNY	75±
D. STEVENS								
R. BRANNAN								

DESCRIPTION REFERENCES TO CONTROL POINTS JOB NO.

LEFT CENTER LINE RIGHT

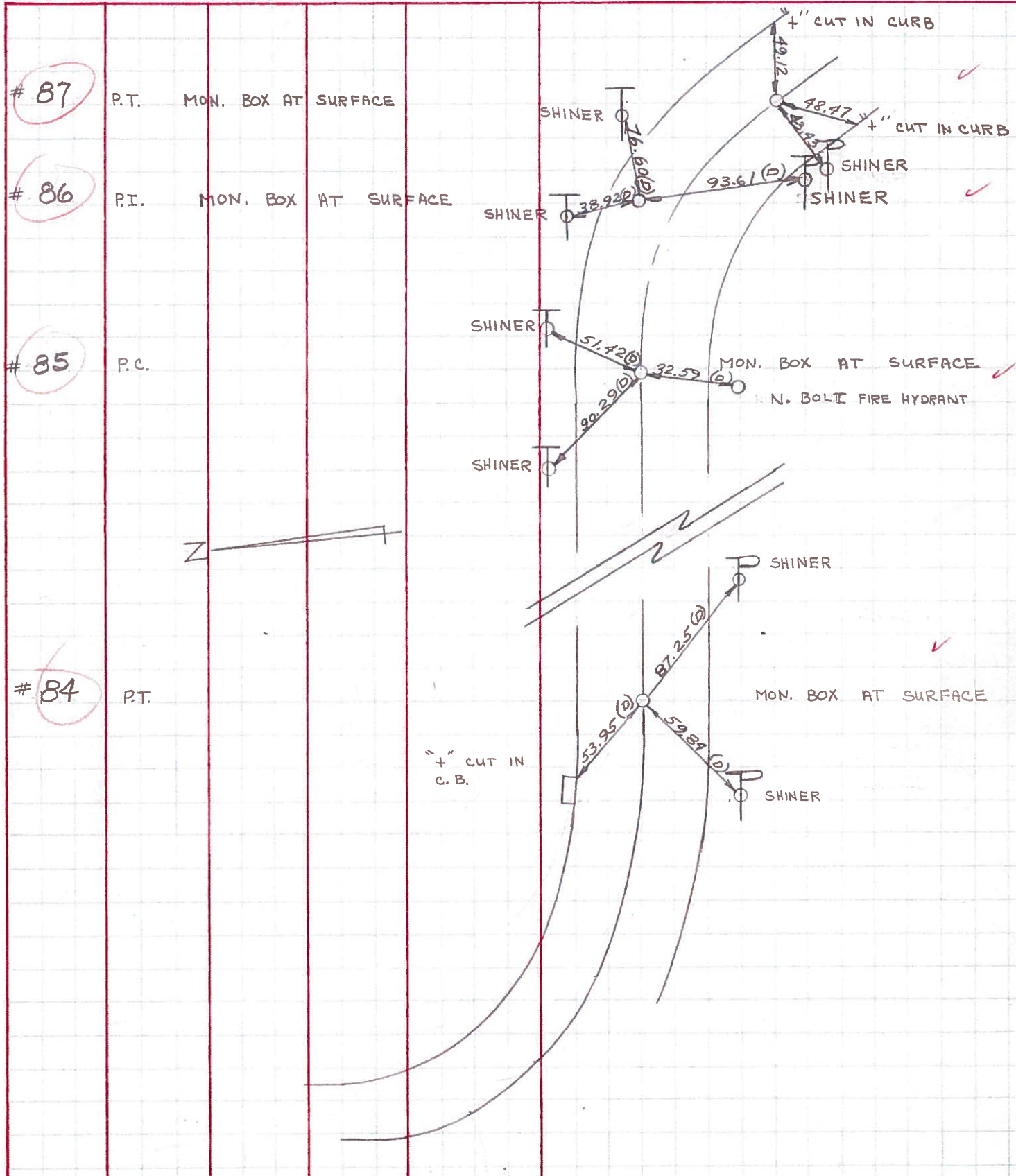

PERSONNEL TITLE PERSONNEL TITLE COUNTY Lucas DATE May 28, 1968
 J. Curtis _____
 J. Teal _____ S. R. 20 WEATHER mild
 J. Brindley _____ SEC. _____ TEMP. 55°±

DESCRIPTION U.S. 20 (Reynolds Rd) - Ref. Mon. & Control Points LEFT CENTER LINE RIGHT JOB NO. 02994(0)

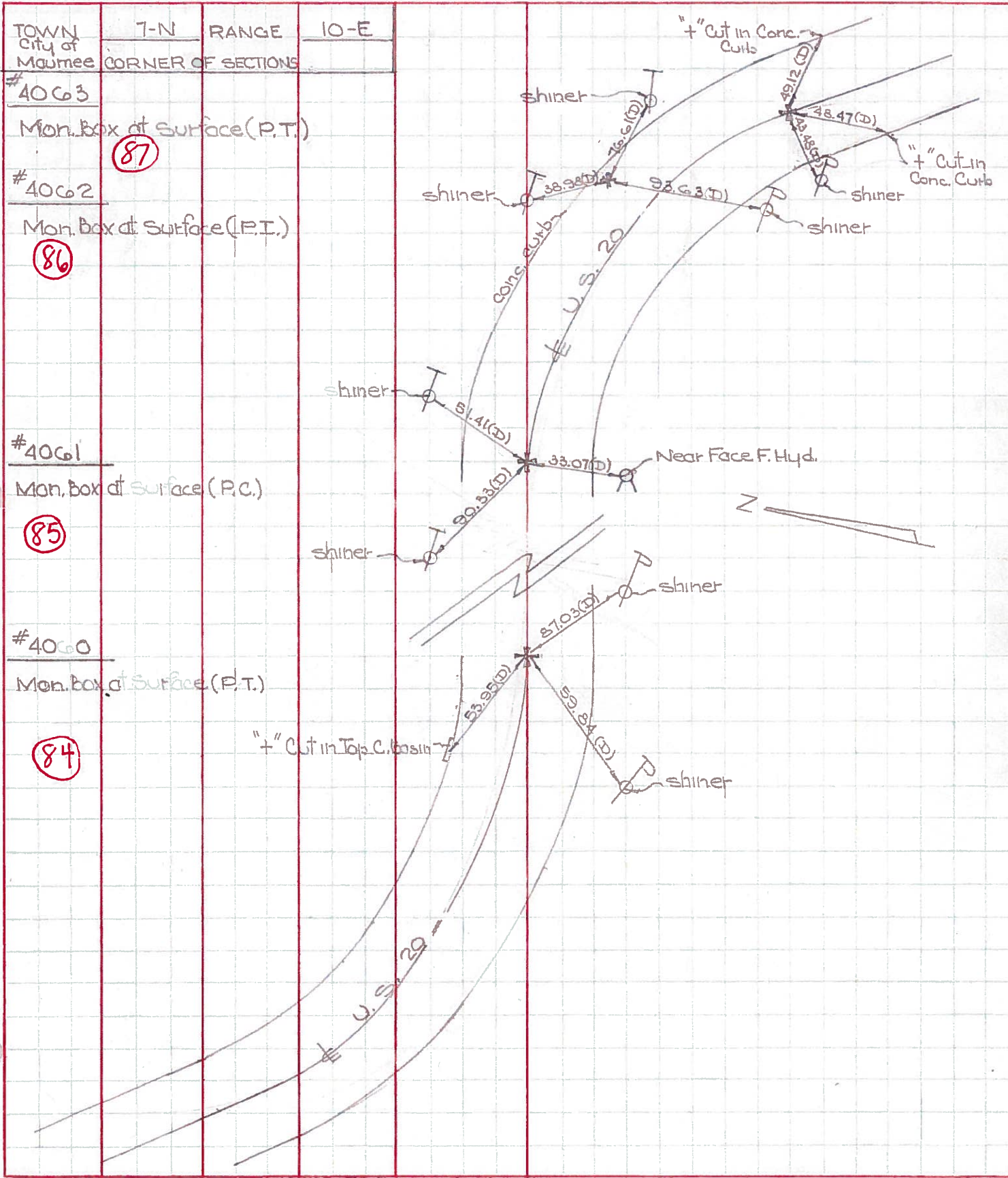

PERSONNEL Stang **TITLE** _____ **PERSONNEL** _____ **TITLE** _____
COUNTY Lucas **DATE** 7 April 6
S. R. #20 **WEATHER** Cool
SEC. _____ **TEMP.** 37°

DESCRIPTION Pkgs. To Cas **LEFT** _____ **CENTER LINE** _____ **RIGHT** _____ **JOB NO.** _____

DESCRIPTION	LEFT	CENTER LINE	RIGHT	JOB NO.
✓ 87 Fd. Mon. Box P.T. Curve		41.72' E.N.E. To Shiner in T.P. 43.48' W.N.W. To Shiner in P.P. 49.12' S.E. To Chisled "4" on curb 78.47' S.W. To Chisled "4" on curb		
✓ 86 Fd. Mon. Box P.I. Curve		38.98' N.E. To Shiner in P.P. 78.18' N.W. To Shiner in T.P. 76.61' S.E. To Shiner in P.P. 93.60' S.W. To Shiner in T.P.		
✓ 85 Fd. Mon. Box P.C. Curve		075' N.W. To Shiner in T.P. 90.33' N.E. To Shiner in P.P. 51.41' S.E. To Shiner in P.P. (D) 33.07' S.W. To Near Fore F. Hydrant (D)		
✓ Fd. Mon. Box P.T. Curve		59.84' N.W. To Shiner in P.P. (D) 87.03' S.W. To Shiner in P.P. (D) 53.95' N.E. To Chisled "4" in Metal Curb of		
✓ P.I. Curve In Field				
✓ #466 83 Int. Holland Rd. Fd. Mon. Box To Surface		59.21' N.W. T 5.27' S.W. T 45.23' N.E. T 8.8' S.E. T		