

O.D.O.T. DISTRICT 2 SURVEY OFFICE (USE ONLY)

PERSONNEL

REFERENCE NO. 92

SHEET 46 OF 55

NOTES HUSS

DATE 7/24/97

ROUTE US 20

H.C. LOEHRKE

WEATHER CLOUDY/HUMID

COUNTY LUCAS

R.C. HUSS

TEMP. 73°

TOWNSHIP 12 MILE RESERVE

COX

SECTION 1

DWG BY NIESE PID _____

T 1 US R E

TYPE MONUMENT MONBOX

ON SURFACE - ~~BELOW~~ ON

OFFSET ☉ PAVEMENT ON LT : RT

32.7' TO RT ~~EDGE PAVEMENT~~ FACE OF CURB

STATION: 980+57

HORIZ.DATUM: _____ GEOID: _____

GRID: NORTHING: _____ EASTING: _____

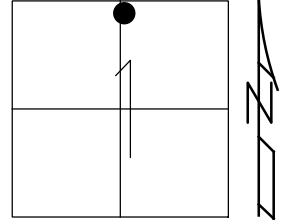

RECORD:
S.L.M. 29+887.8
FD MONBOX
7/24/97, CL

CUT "+"
0.3m UP 

CUT "+" TOP
N.E. BOLT
OVERHEAD
SIGN BASE

CUT "+" TOP
N.W. BOLT
OVERHEAD
SIGN BASE

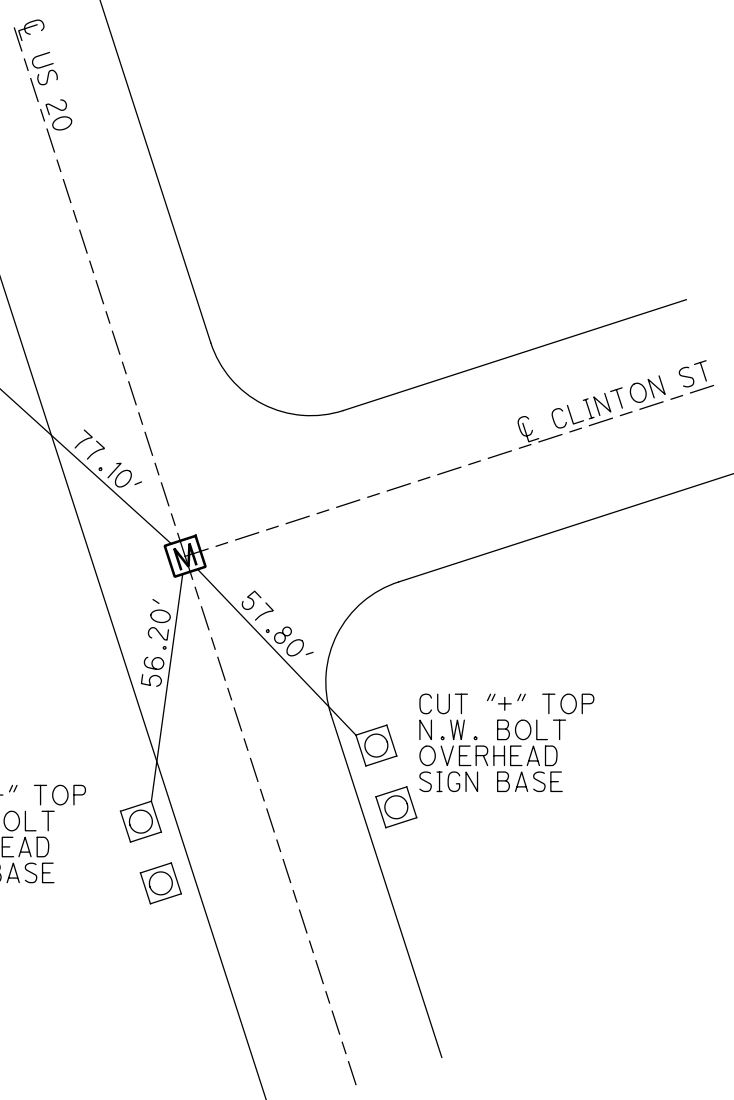

O.D.O.T. DISTRICT 2 SURVEY OFFICE

PERSONNEL

REFERENCE NO. 92

SHEET OF

NOTES Huss

H.C. hoehvke

R.C. Huss

F Cox

DATE 7-24-97

WEATHER Clidy - humid

TEMP. +73°F

ROUTE U.S. 20

COUNTY LUCAS

TOWNSHIP City of Maurice

SECTION

T R

TYPE MONUMENT Mon Box

ON SURFACE - BELOW Yes

LEFT - & PAV'T. - RIGHT Yes

32.7 TO RT. EDGE PAVEMENT Face of Curb

S.L.M. 29 + 887.8

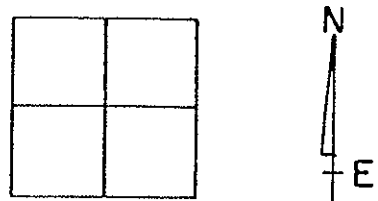

Cut "4" Near
Face, 0.3m
up

Cut "4" Top NE.
Bolt, overhead
TRUSS SIGN Base

Cut "4" Top NW. Bolt
overhead TRUSS SIGN BASE

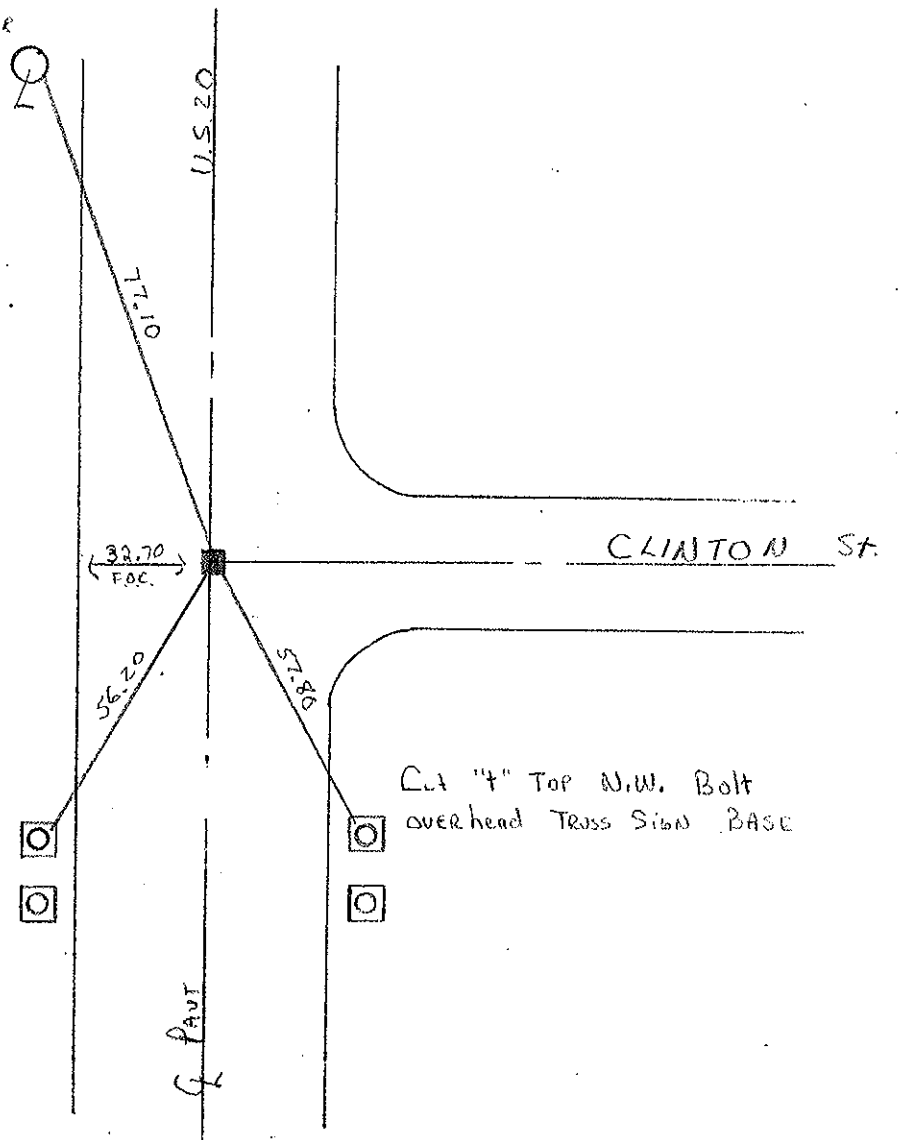

PERSONNEL	TITLE	PERSONNEL	TITLE	COUNTY	DATE	WEATHER	TEMP.
D. CURTIS				LUCAS	17 AUG 71	CLOUDY	65±
D. STEVENS				U.S. 20			
R. BRANNAN							

DESCRIPTION	REFERENCES TO CONTROL POINTS	JOB NO.
	LEFT CENTER LINE RIGHT	

