

O.D.O.T. DISTRICT 2 SURVEY OFFICE

PERSONNEL

REFERENCE NO. 53-C

SHEET 61 OF 68

NOTES HUSS

H.C. YAN DUSEN

DATE 6-10-97

ROUTE U.S. 24

R.C. MOSEK

WEATHER Sunny

COUNTY LUCAS

TEMP. +67°F

TOWNSHIP WATERVILLE

SECTION _____

T 6 NR 10 E

TYPE MONUMENT P.K. NAIL/W

ON SURFACE - BELOW Surface

LEFT - & PAV'T. - RIGHT YES

12.1' TO RT EDGE PAVEMENT

S.L.M. 520 + 62

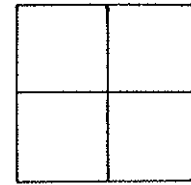

SET PK/WASHER
10-22-97
JAH

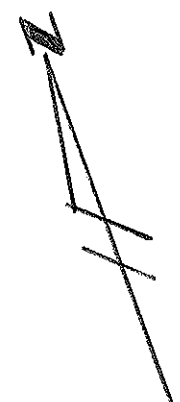

HYD.
SET & CUT
SW BONNET BOLT



SET SHI

80.40'

49.02'

86.11'

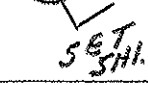

SET SHI

U.S. 24

CE PAV'T

E. SURVEY
OLD RIVER Rd.

SET SHI. FENCE POST
2' UP

55.43'

REC. FD. PK NAIL
2" DEEP
9-19-84

County Lucas S.R. 05#24

Date 26 June 84

Township Waterville

Weather Fair

Section _____

Temp. 66°

T N, R E

Personnel I. Stone

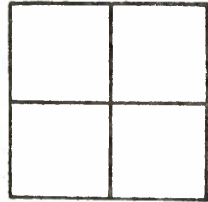

P. Neuse

53C

R. Michalak

D. Curtis

56 M Sta. 520+95

Ref No. 53-C

12.2

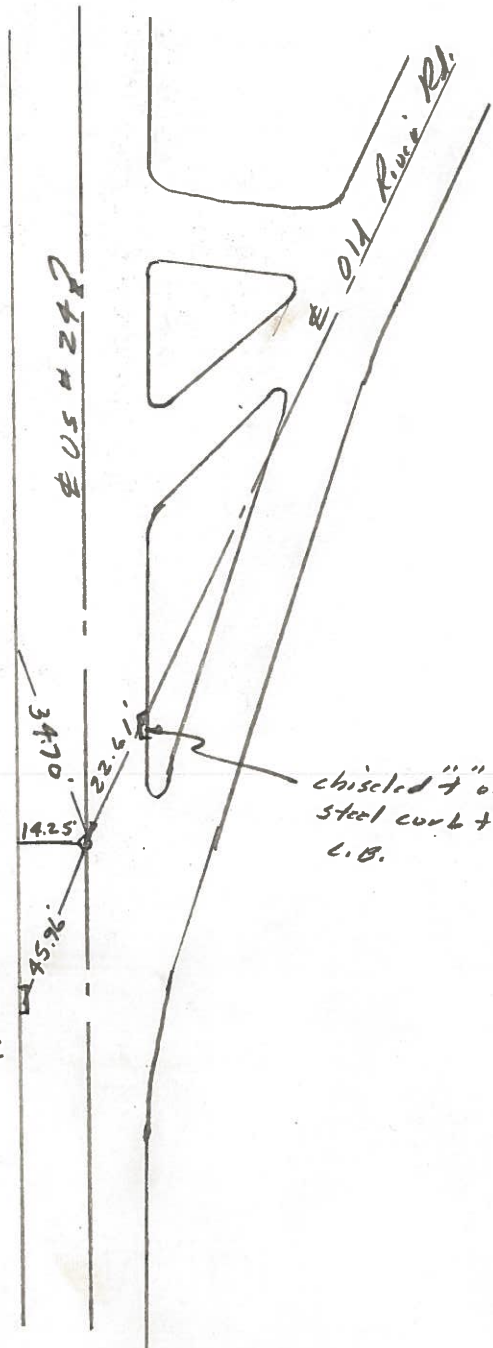

chiseled "+" on
con. curb

Ed. PK Nail to Surface
14.0' to N. edge put,
Set PK Nail

chiseled "+"
on con. curb

chiseled "+" on
steel curb to
C.B.

Fel. P.K. Nail 2" deep -
9-19-84

chiseled "+"
on steel
curb to C.B.