

PERSONNEL TITLE PERSONNEL TITLE

COUNTY Lucas

DATE June 1957

S. R. # 24

WEATHER

SEC. Maumee

TEMP.

DESCRIPTION

Anthony Wayne Trail

JOB NO.

LEFT

CENTER LINE

RIGHT

White st. & Anthony Wayne.
Brass Mon. in Conc.

71

42.14' S.S.E. Shiner in st. light Pole
46.61' N.W. Shiner in A. Pole.
20.82' W. face of steel Traffic
light Pole.

Michigan & Anthony Wayne

73

41.92' E. To Shiner in Guy Pole for
st. light.
53.42' N.W. Face steel Traffic
light Pole
57.34' N.N.W. Face steel Traffic
light Pole. (Mich. Ave)

Key & Anthony Wayne

72

53.09' W. Face steel Traffic
light Pole. (Anthony Wayne)
41.39' N.W. Face steel Traffic
light Pole (Key st.)
50.75' N.N.W. P.R. spike in
Cable Pole.

PERSONNEL	TITLE	PERSONNEL	TITLE	COUNTY	DATE
Mennitt				Lucas	1958
+				#24	WEATHER
Crew				SEC. Anthony-Wayne Trail	TEMP.

DESCRIPTION	LEFT	CENTER LINE	RIGHT	JOB NO.
Sta. 338+12		Brass (MBM) Mon. S. Side of N. lane 14' N @ Michigan St.		
	73	41.92' S.E. To shiner in ϕ on ϕ 67.14' N.W. To shiner in ϕ 39.41' S.W. To shiner in ϕ on ϕ		
Sta. 359+39		19' N. - Brass Plate (MBM) 70.98' N.E. To shiner in 10" Elm 72.42' N.N.W. To "+" in Curb ^{50'± 7th St.} 53'± W. of Tree 81.34' N.W. To "+" in Curb 90'± W. of Tree		
Sta. 362+84		19.7 N. (Brass MBM) Plumbed 74.75' N.N.E. To shiner in ϕ " 70.53' N.W. To "+" in curb 37'± W. ϕ " 80.03' W.N.W. To "+" in Curb 76'± W. ϕ		
Sta. 382+73		43.8 N. Brass (MBM) Key St. 31.46 N.E. To shiner in ϕ 50.61 N.W. To shiner in ϕ 63.49 S.W. To shiner in ϕ		72
Sta. 404+00		40.5 N. Brass (MBM) White St 46.61 N.W. shiner in ϕ 20.83 W. "+" in steel T. Lt. Pole 41.60 S.E. shiner in ϕ		71
Sta. 405+35		25' N. Brass (MBM) 82.69' W. To shiner in ϕ 35.44 N. To shiner in 36" Elm 49.05 N.E. To Tacked Hub @ Fence line		

PERSONNEL TITLE PERSONNEL TITLE

COUNTY Lucas

DATE 3-16-53

S. R. #24

WEATHER

SEC.

TEMP.

DESCRIPTION

LEFT

CENTER LINE

RIGHT

JOB NO.

No
 760+87.24 P.I.
 $\Delta = 13^{\circ}-11'$
 $D = 1^{\circ}-16'$
 $T = 522.67$
 $E = 30.10'$
 $L = 1040.79$

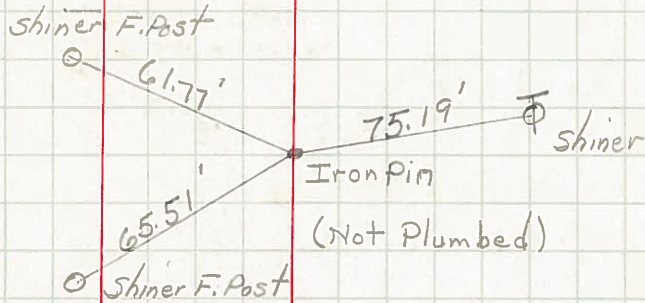

No
 755+64.57 P.C.

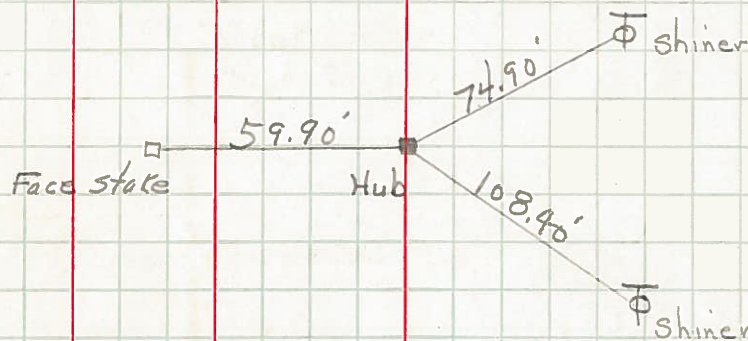

No
 766+05.36 P.T.

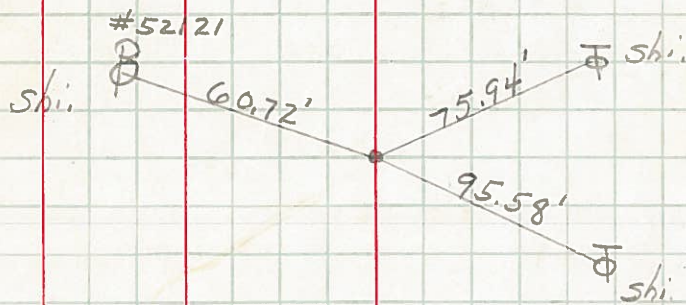

770+71.90 P.I.
 $\Delta = 0^{\circ}-04' Lt.$

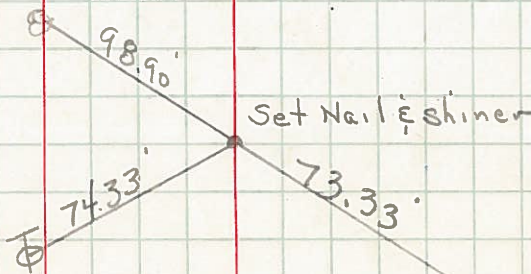

Base block Foundation
 S.W. Coe. Res.

PERSONNEL

TITLE

PERSONNEL

TITLE

Mangitt

COUNTY Lucas

DATE 1958

Crew

S. R. # 24

WEATHER

SEC. Anthony Wayne Trail

TEMP.

DESCRIPTION

From Logan st. To white st.

JOB NO.

LEFT

CENTER LINE

RIGHT

Sta. 4+08 S.W. Brass plate & Logan st.
 30.48 N.W. To "T" in Curb @ S.W. cor.
 15.11 W. To "T" in Curb @ S.W. cor.
 20.14 S.W. To "T" in Curb @ S.W. cor.

Sta. 11+11 S. Brass Plate
 16.94 S.W. To "T" in S. Curb S. lane
 10.53 S. To "T" in S. Curb S. lane
 20.53 S.E. To "T" in S. Curb S. lane

Sta. 27+22 S. Brass Plate
 11.34 S.E. To "T" in Curb on S.E. cor.
 3.34 E. To "T" in Curb on S.E. cor.
 12.04 N.E. To "T" in Curb on S.E. cor.

Sta. 27+31 S. Brass Plate
 16.87 S.E. To "T" in Curb on S.E. cor.
 12.53 E. To "T" in Curb on S.E. cor.
 18.01 N.E. To "T" in Curb on S.E. cor.

Sta. 35+44 S. Brass Plate
 5.48 S.W. To "T" in S. Curb S. lane
 1.53 S. To "T" in S. Curb S. lane
 15.04 S.E. To "T" in S. Curb S. lane

Sta. 49+34 S. Brass Plate & Western.
 33.19 W. To "T" in curb on S.W. cor.
 21.47 S.W. To "T" in curb on S.W. cor.
 35.53 S.E. To "T" in curb on S.W. cor.

PERSONNEL	TITLE	PERSONNEL	TITLE	COUNTY	DATE
Mennitt				LUCAS	1958
CREW				#24	WEATHER
				SEC. Anthony-Wayne Trail	TEMP.

DESCRIPTION	LEFT	CENTER LINE	RIGHT	JOB NO.
Sta. 119+25				
		S. Brass Plate		
	17.55	S.W. To "T" in	S. Curb S. lane	
	14.80	S. To "T" in	S. Curb S. lane	
	16.61	S.E. To "T" in	S. Curb S. lane	
Sta. 135+25				
		S. Brass Plate		
	13.60	S.W. To "T" in	S. Curb S. lane	
	10.14	S. To "T" in	S. Curb S. lane	
	14.33	S.E. To "T" in	S. Curb S. lane	
Sta. 144+36				
		S. Brass Plate		
	58.36	W. To "T" on	Curb @ S.W. COR.	
	47.09	S. To "T" on	Curb @ S.W. COR.	
	31.09	N.W. To "T" on	N. Curb of S. lane	
Sta. 155+25				
		S. Brass Plate		
	9.40	S.W. To "T" in	S. Curb S. lane	
	4.98	S. To "T" in	S. Curb S. lane	
	11.09	S.E. To "T" in	S. Curb S. lane	
Sta. 169+41				
		S. Brass Plate & Glendale (S)		
	43.51	W. To "T" in	Curb on S.W. COR.	
	21.68	S. To "T" in	Curb on S.W. COR.	
	31.59	S.E. To "T" in	Curb on S.W. COR.	
Sta. 171+81				
		S. Brass Plate		
	30.55	S.W. To Nail in	Ø	
	2.19	S.S.W. To "T" in		
	6.68	S.E. To "T" in	S. Curb S. lane	

PERSONNEL	TITLE	PERSONNEL	TITLE	COUNTY	DATE	WEATHER
Mennitt				Lucas	1958	
#				#24		
Crew				SEC. Anthony-Wayne Trail		TEMP.

DESCRIPTION	LEFT	CENTER LINE	RIGHT	JOB NO.
-------------	------	-------------	-------	---------

Sta. 175+36	S. Brass Plate			
	13.11 S.W. To "T" in S. Curb S. lane			
	11.48 S. To "T" in S. Curb S. lane			
	13.75 S.E. To "T" in S. Curb S. lane			
Sta. 193+82	S. Brass Plate			
	18.94 S. To "T" in S. Curb S. lane			
	21.45 S.E. To "T" in S. Curb S. lane			
	34.83 W.S.W. Nail in Pole			
Sta. 201+54	S. Brass Plate			
	11.57 N. To "T" in N. Curb S. lane			
	10.04 N.N.E. To "T" in N. Curb S. lane			
	17.85 N.E. To "T" in N. Curb S. lane			
Sta. 213+22	S. Brass Plate	N. Side S. lane		
	12.00 N.W. To "T" in N. Curb of S. lane			
	7.27 N. To "T" in N. Curb of S. lane			
	11.99 N.E. To "T" in N. Curb of S. lane			
Sta. 213+22	S. Brass Plate	S. Side S. lane		
	11.30 S.W. To "T" in S. Curb S. lane			
	5.00 S.S.W. To "T" in S. Curb S. lane			
	9.53 S.E. To "T" in S. Curb S. lane			
Sta. 216+47	S. Brass Plate	McAly H.S.		
	9.98 S.W. To "T" in S. Curb S. lane			
	5.50 S.S.W. To "T" in S. Curb S. lane			
	6.18 S.E. To "T" in S. Curb S. lane			