

O.D.O.T. DISTRICT 2 SURVEY OFFICE (USE ONLY)

PERSONNEL

REFERENCE NO. 78 E

SHEET 13 OF 18

NOTES HOHENBERGER

DATE 10/31/77

ROUTE US 24

H.C. WILLIAMS

WEATHER _____

COUNTY LUCAS

R.C. GERDZINSKI

TEMP. _____

TOWNSHIP USR

SECTION 27

DWG BY RHOADES

PID _____

T 9 N R 7 E

TYPE MONUMENT MONBOX

ON SURFACE - ~~BELOW~~ ON _____

OFFSET \odot PAVEMENT ON _____ LT : RT

_____ TO _____ EDGE PAVEMENT

STATION: 1337+95

HORZ.DATUM: _____

GEOID: _____

GRID: NORTHING: _____

EASTING: _____

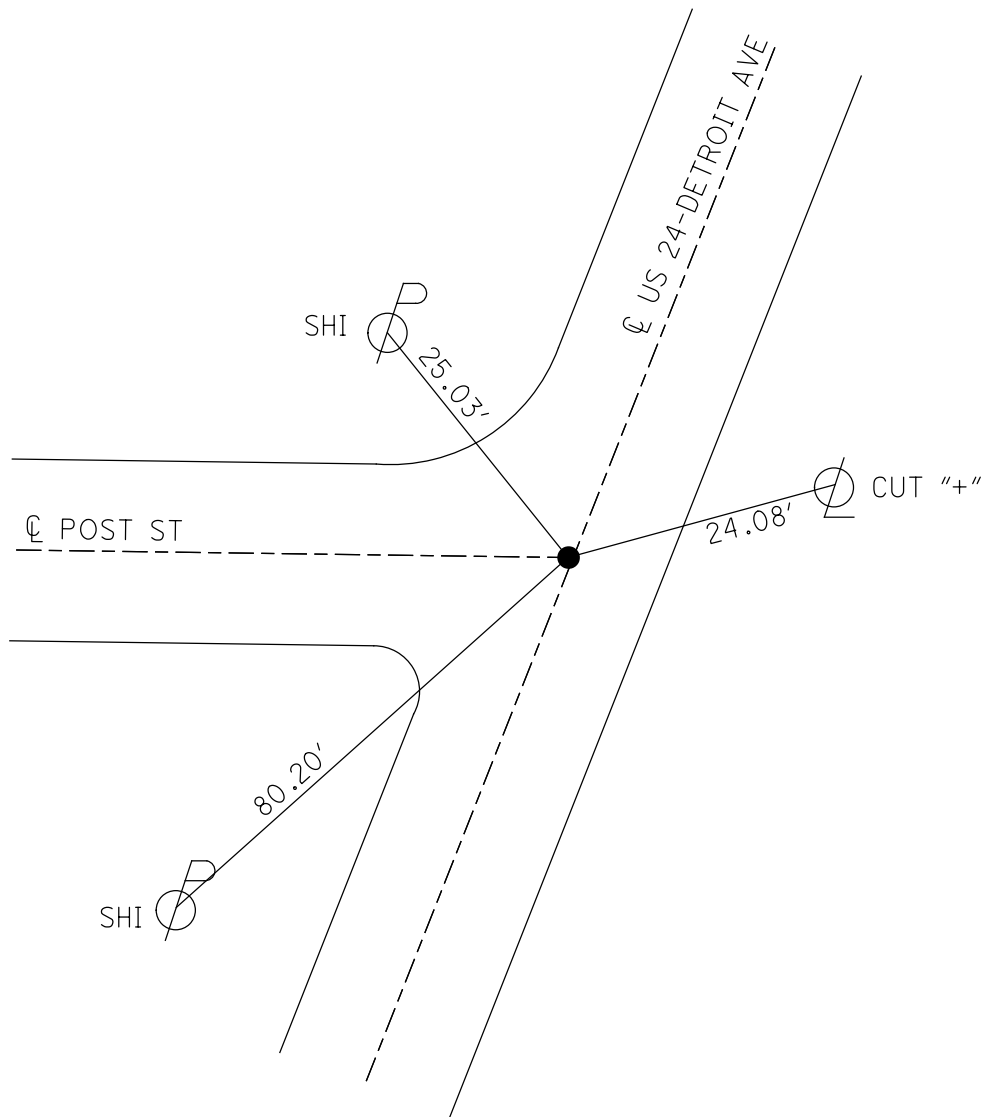
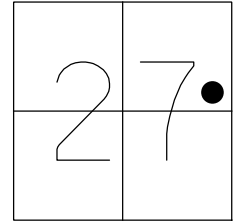

PERSONNEL TITLE PERSONNEL TITLE

PROJECT _____ DATE _____

PROJECT LIMITS _____ WEATHER _____

FROM STA. _____ TO STA. _____ TEMP _____

DESCRIPTION REF. MON. DETROIT AVE RESURF. CAMSON TO CENTRA

