

O.D.O.T. DISTRICT 2 SURVEY OFFICE (USE ONLY)

PERSONNEL \_\_\_\_\_

REFERENCE NO. 79 A

SHEET 15 OF 18

NOTES HOHENBERGER

DATE 10/31/77

ROUTE US 24

H.C. WILLIAMS

WEATHER \_\_\_\_\_

COUNTY LUCAS

R.C. GERDZINSKI

TEMP. \_\_\_\_\_

TOWNSHIP USR

DWG BY RHOADES

PID \_\_\_\_\_

SECTION 26

T 9 N R 7 E

TYPE MONUMENT MONBOX

ON SURFACE - ~~BELOW~~ ON \_\_\_\_\_

OFFSET  $\odot$  PAVEMENT ON \_\_\_\_\_ LT : RT

\_\_\_\_\_ TO \_\_\_\_\_ EDGE PAVEMENT

STATION: 1343+76

HORZ. DATUM: \_\_\_\_\_

GEOID: \_\_\_\_\_

GRID: NORTHING: \_\_\_\_\_

EASTING: \_\_\_\_\_

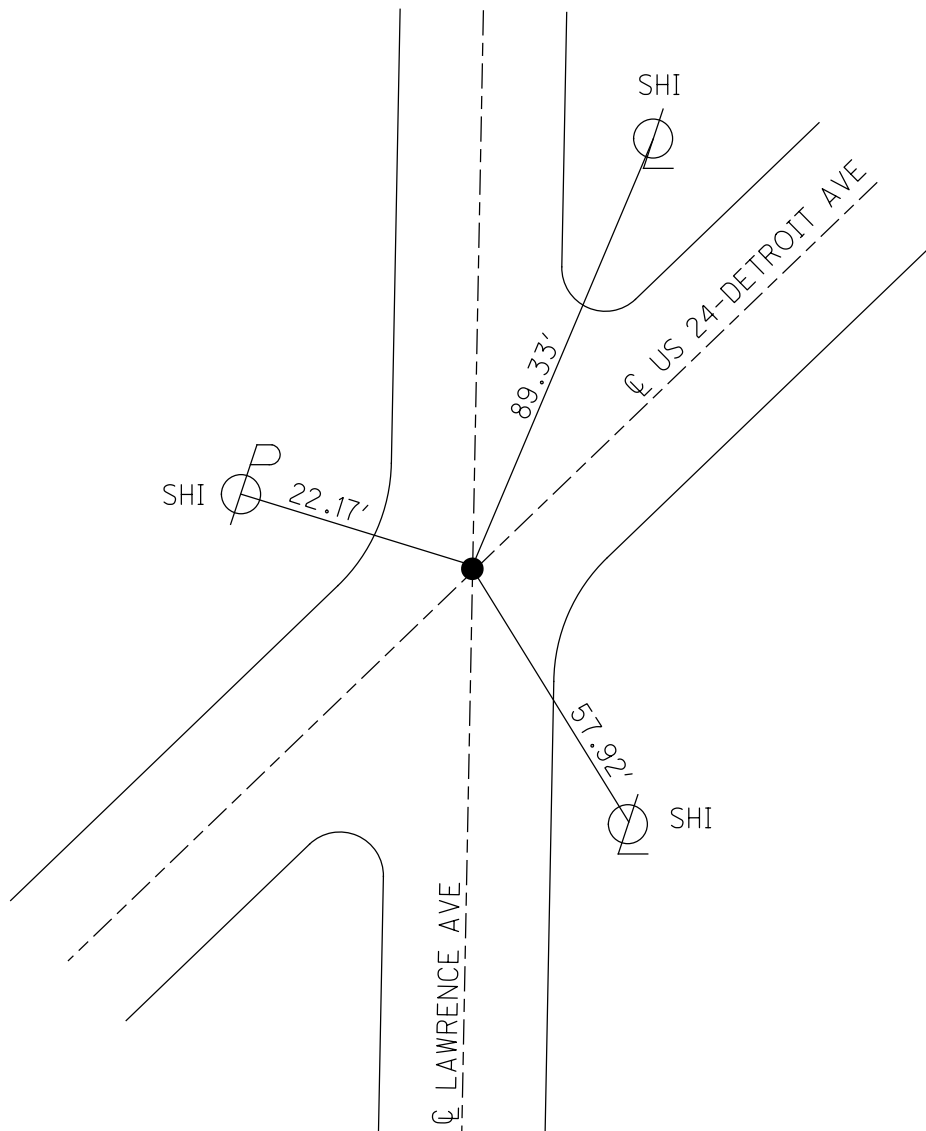
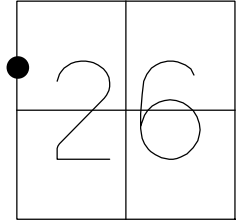

PERSONNEL TITLE PERSONNEL TITLE

PROJECT \_\_\_\_\_ DATE \_\_\_\_\_

PROJECT LIMITS \_\_\_\_\_ WEATHER \_\_\_\_\_

FROM STA. \_\_\_\_\_ TO STA. \_\_\_\_\_ TEMP. ② \_\_\_\_\_

DESCRIPTION MON. REF. DETROIT AVE RESURF. (LAWSON TO CENTRAL)

