

O.D.O.T. DISTRICT 2 SURVEY OFFICE (USE ONLY)

PERSONNEL \_\_\_\_\_ REFERENCE NO. 85 SHEET 6 OF 6  
 NOTES CITY OF TOLEDO DATE 1/15/92 ROUTE SR 24  
 H.C. \_\_\_\_\_ WEATHER \_\_\_\_\_ COUNTY LUCAS  
 R.C. \_\_\_\_\_ TEMP. \_\_\_\_\_ TOWNSHIP \_\_\_\_\_  
 SECTION 23  
 T 9 S R 7 E

TYPE MONUMENT MON BOX  
 ON SURFACE - ~~BELOW~~ ON \_\_\_\_\_  
 LEFT - ☉ PAV'T - ~~RIGHT~~ 3.55'  
25.9' TO RT EDGE PAVEMENT  
 S.L.M. 1437+24.63  
 Grid: Northing: \_\_\_\_\_ Easting: \_\_\_\_\_

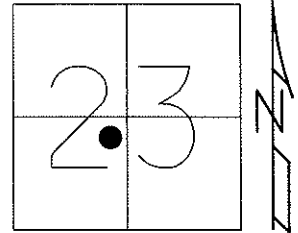

TOLEDO PLAN LUC-SR-24-26.70  
 PLAN STA. = 27+48.63

NOTE: 3.55' LT OF ☉ SURVEY  
 ON CENTERLINE OF CONSTRUCTION.  
 SEE 13/23 LUC25-10.31, R/W

SET 5/8" IPIN IN MONBOX.  
 1/6/1997, M.R.C.

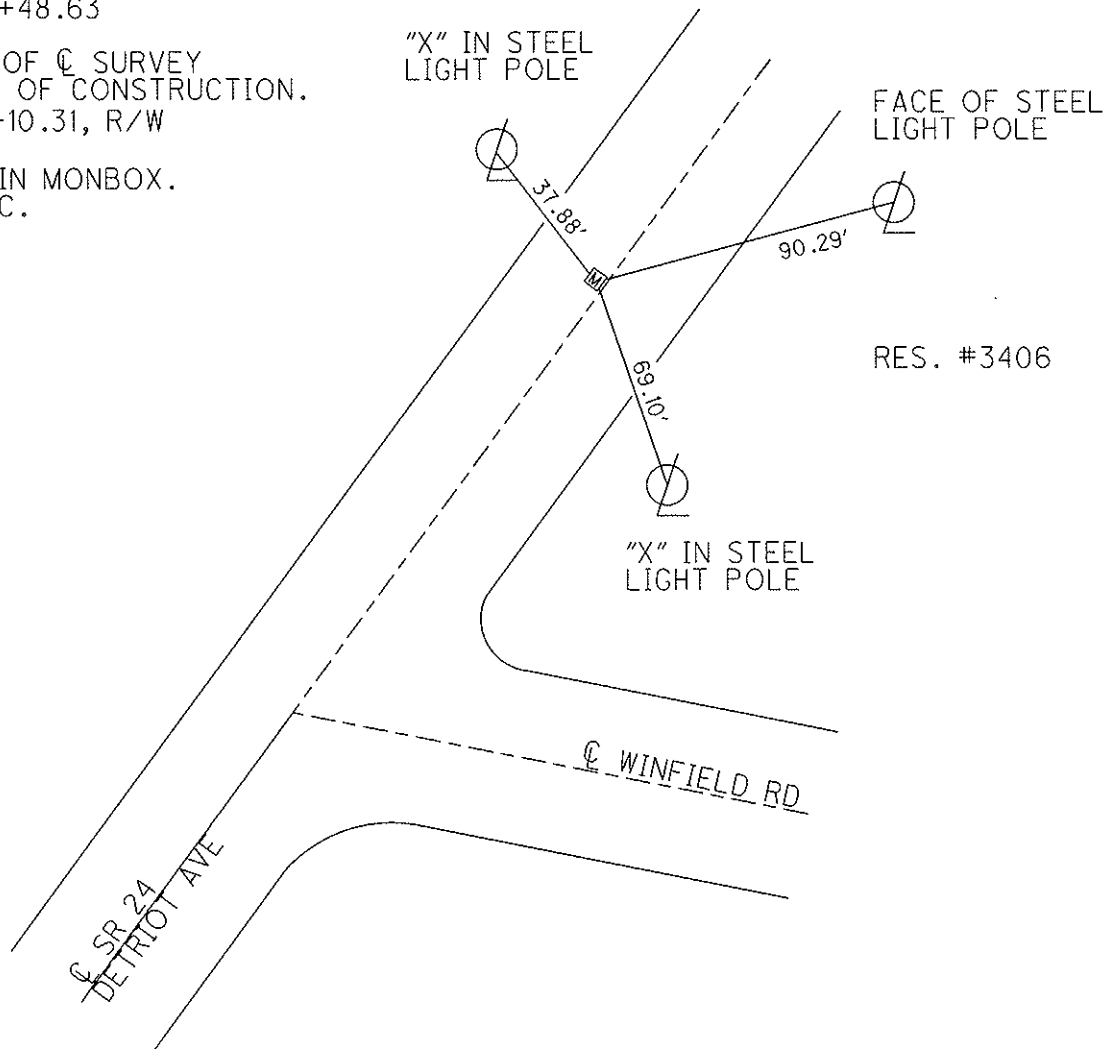

RES. #3406

# O.D.O.T. DISTRICT 2 SURVEY OFFICE

PERSONNEL \_\_\_\_\_

REFERENCE NO. 85

SHEET 6 OF 6

NOTES CITY

H.C. OF

R.C. TOLEDO

DATE 1-15-92

WEATHER \_\_\_\_\_

TEMP. \_\_\_\_\_

ROUTE 24

COUNTY LUCAS

TOWNSHIP \_\_\_\_\_

SECTION \_\_\_\_\_

T \_\_\_\_\_ R \_\_\_\_\_

TYPE MONUMENT MON

ON SURFACE - BELOW 2 SURFACE

LEFT - 0 PAV'T. - RIGHT \_\_\_\_\_

TO \_\_\_\_\_ EDGE PAVEMENT

S.L.M. 1437+24.63

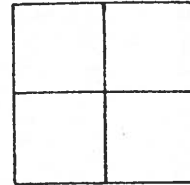

TOLEDO PLAN LUC-SR-24-26.70

DRAWN BY WM LUCE

PLAN STA. = 27+48.63

"X" IN STEEL LIGHT POLE



FACE OF STEEL LIGHT POLE

RES 3406  
BRICK PORCH

STUCCO  
GARAGE

"X" IN STEEL LIGHT POLE